

City of Columbia, Missouri

Department of Public Works



KEENE STREET & I-70 DRIVE SOUTHEAST ROUNDAABOUT

INTERSECTION IMPROVEMENTS 30% PLANS

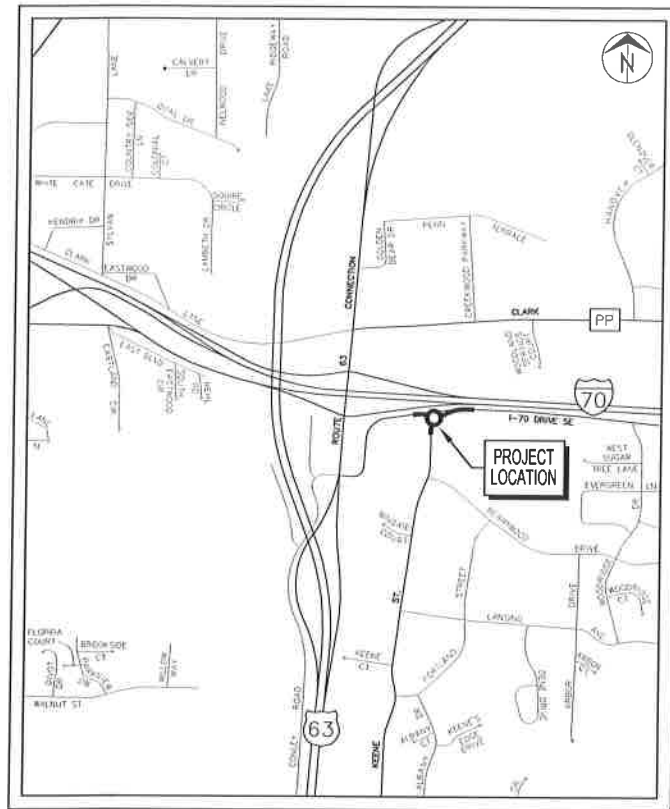

LOCATION MAP

LEGEND OF SYMBOLS

POWER POLE	
TELEPHONE POLE	
GUY ANCHOR	
GUY POLE	
STREET LIGHT POLE	
YARD LIGHT (SOLAR)	
WATER METER	
GAS METER	
GAS VALVE	
WATER VALVE	
FIRE HYDRANT	
PIPE BREAKLINE	
SANITARY MANHOLE	
SANITARY CLEANOUT	
SANITARY LATERAL CLEANOUT	
TRAVERSE POINT	
MoDOT ROW MARKER	
BENCHMARK	
SIGN	
MAIL BOX	
PROPERTY IRON	
BUSH	
STUMP	
TREE REMOVAL	
TREE	
TREE LINE	
SILT FENCE/TREE PROTECT	
EXISTING PUBLIC SANITARY SEWER	
EXISTING SANITARY SEWER LATERAL	
EXISTING SANITARY SEWER TO BE ABANDONED	
PROPOSED SEWER MAIN AND LATERALS	
FENCE	
CABLE TELEVISION	
TELEPHONE	
ELECTRIC	
TELEPHONE OR ELECTRIC MANHOLE	
WATER MAIN	
GAS MAIN	
FIBER OPTIC	
FLOW LINE	
PROPERTY LINE	
LOT LINE	
EXISTING RIGHT OF WAY LINE	
EXISTING EASEMENT	
PERMANANT UTILITY EASEMENT	
PROPOSED SANITARY SEWER EASEMENT	
PROPOSED PERMANENT DRAINAGE EASEMENT	
PROPOSED RIGHT OF WAY	
TEMPORARY ACCESS EASEMENT	
TEMPORARY CONSTRUCTION EASEMENT	
GRADING LIMIT	

GENERAL NOTES

- All construction to be in accordance with "City of Columbia Street, Storm and Sanitary Specifications" (Current edition).
- Known underground utilities are shown in their approximate locations. Other utilities may exist.
- All removal of driveway pavements should be verified by field engineer.
- All excavation to be in accordance with Sections 319.010-319.050, Revised Statutes of the State of Missouri. Such compliance shall not, however, excuse any person making any excavation from doing so in a careful and prudent manner, nor shall it excuse such person from liability for any damage or injury to underground utilities resulting from the excavation.
- All RCP is Class III unless otherwise indicated.
- All disturbed earth areas shall be restored as per TS-___ Seeding and TS-___ Erosion Control.
- Remove all pavement surfaces, inlets, pipes and sidewalks within the construction limits as per TS-___, except those noted to remain. The field inspector shall verify removal of all driveway pavement.
- Removal of trees and bushes shall be verified by field inspectors. Exercise caution when working near the construction limits to minimize disturbance to adjacent trees and shrubs that are not being removed by construction activities.
- Backfill of reinforced concrete pipe shall be 1 inch clean rock or soil compacted to 95 percent of standard proctor density as per TS-___.
- No open trenches will be allowed overnight outside of the "road closed" area. Asphaltic "cold mix" shall be used as a temporary patch overnight. Temporary patching shall be considered incidental to the work.

UTILITY COMPANIES:

TELEPHONE
CenturyLink
825 Cherry Street
Columbia, MO 65205
573-886-3505

NATURAL GAS
Ameren Missouri
2001 Maguire Boulevard
Columbia, MO 65201
573-876-3063

CABLE TELEVISION
Mediacom
901 N. College Avenue
Columbia, MO 65201
573-443-1536 ext 354

LOCATES
Missouri One Call Inc.
1022 B Northeast Drive
Jefferson City, MO 65109
1-800-344-7483

WATER
City of Columbia
P.O. Box 6015
Water & Light Department
Columbia, MO 65205
573-874-7301

ELECTRIC
City of Columbia
P.O. Box 6015
Water & Light Department
Columbia, MO 65205
573-874-7301

SANITARY SEWER
City of Columbia
P.O. Box 6015
Public Works Department
Columbia, MO 65205
573-874-7250

ELECTRIC (county)
Boone Electric Cooperative
1413 Range Line Street
Columbia, MO 65201
573-449-4181 ext 231

INDEX OF SHEETS	
Description	Sheet No.
Cover Sheet	1
Typical Sections	2
Plan / Profile Sheets	3-4

City of Columbia, Missouri Department of Public Works			
No.	Date	By	Revision
File No. 32-01-14	Des. A.N.H.	Sheet	David Allen Nichols Registered Professional Engineer E-24212
Scale: None	Dwn. J.L.H.	1 of 4	
Date: 6/09/17	Chk. A.A.A.		
KEENE ST. & I-70 DR. SE ROUNDAABOUT			
Approved By _____			
Director of Public Works		Date _____	

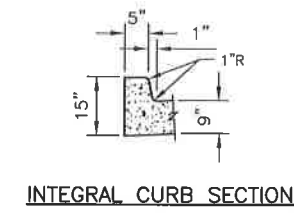
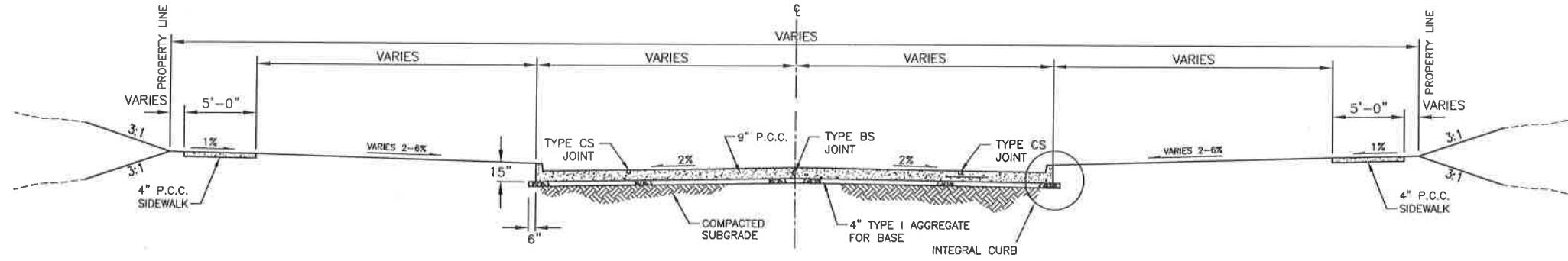

**KEENE STREET AND I-70 SE
TYPICAL CROSS SECTION
(NOT TO SCALE)**

NOTE:
SEE PLAN AND CROSS SECTION SHEETS FOR SPECIFIC
LOCATIONS OF PAVEMENT AND SIDEWALKS, AND VARIATIONS.

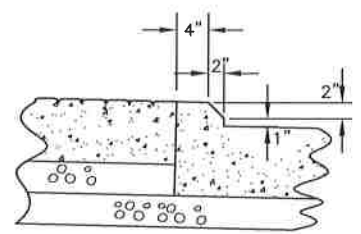
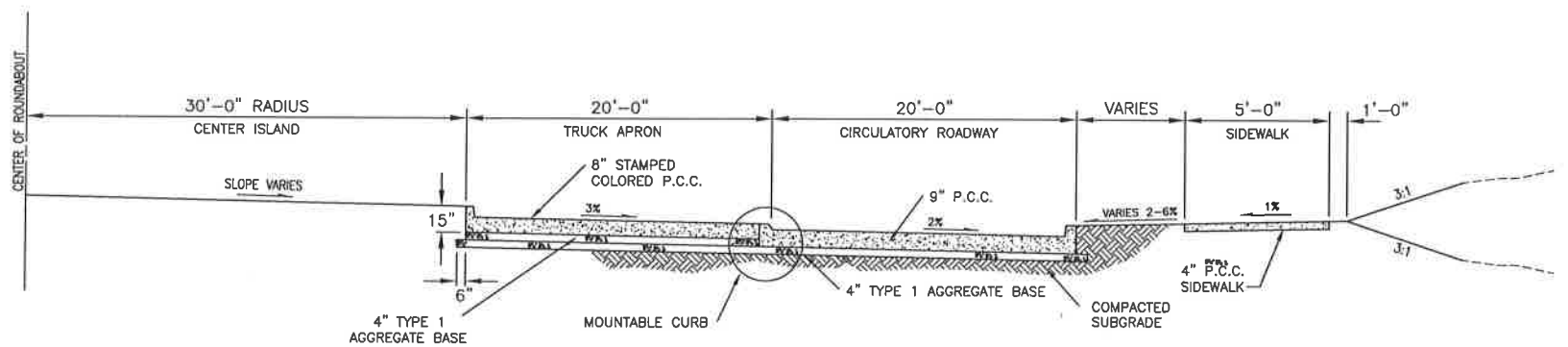

**ROUNDBOUT CIRCULATORY ROADWAY
TYPICAL CROSS SECTION
(NOT TO SCALE)**

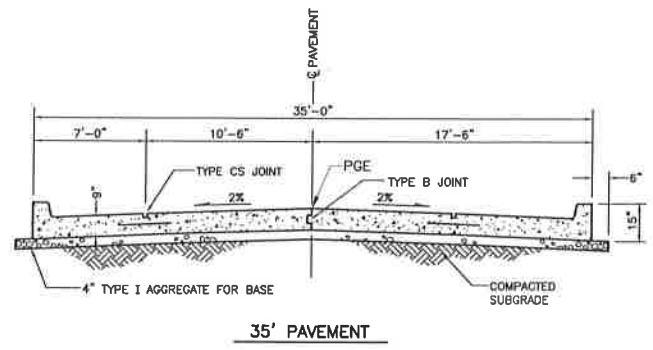

- NOTES:**
1. ALL P.C. CONCRETE SHALL BE CLASS A.
 2. INSTALL TYPE A EXPANSION JOINTS AT MAXIMUM 500 FT. SPACING AND AT INTERSECTIONS AS SHOWN ON THE JOINT DETAILS.
 3. SEE DETAIL 200.01 FOR JOINT DETAILS.

**9" P.C. CONCRETE PAVEMENT
(NOT TO SCALE)**

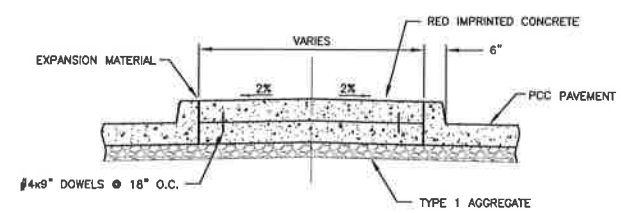

**SPLITTER ISLAND BARRIER CURB
(NOT TO SCALE)**

Revision	By	Date	No.

KEENE ST. & I-70 DR. SE ROUNDABOUT
Typical Sections

City of Columbia, Missouri
Department of Public Works

David Allen Nichols
Registered Professional Engineer
E-24212

File No. 32-01-14
Scale: 1" = 20'
Date: 6/09/17
Des. AN.H.
Dwn. J.L.H.
Chk. A.A.A.

o:\addb\01\res\veve & i-70 drive to intersection 220114\asph\asph.dwg

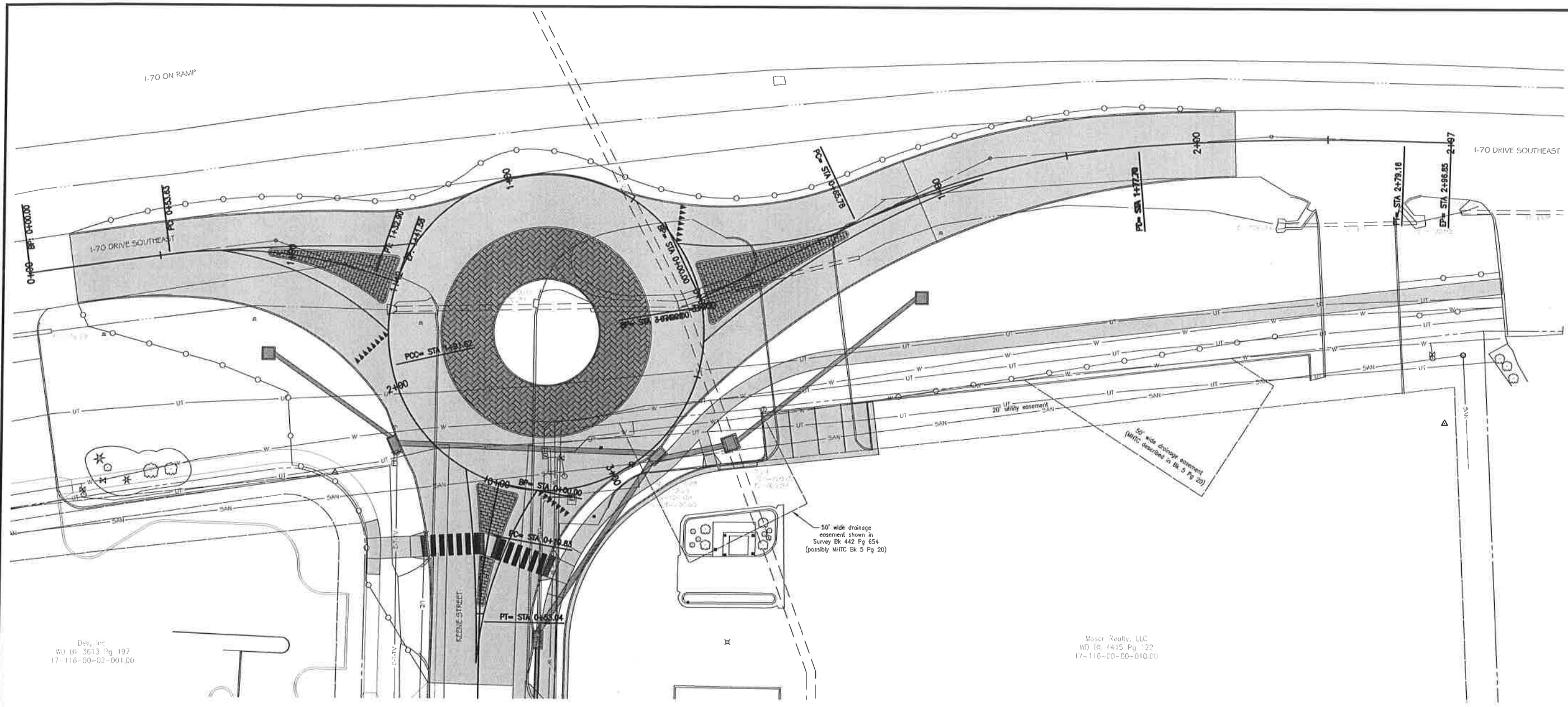

Dev, Inc
 WD BK 3613 Pg 197
 17-116-00-02-001.00

Moser Realty, LLC
 WD BK 4415 Pg 122
 17-116-00-00-010.00

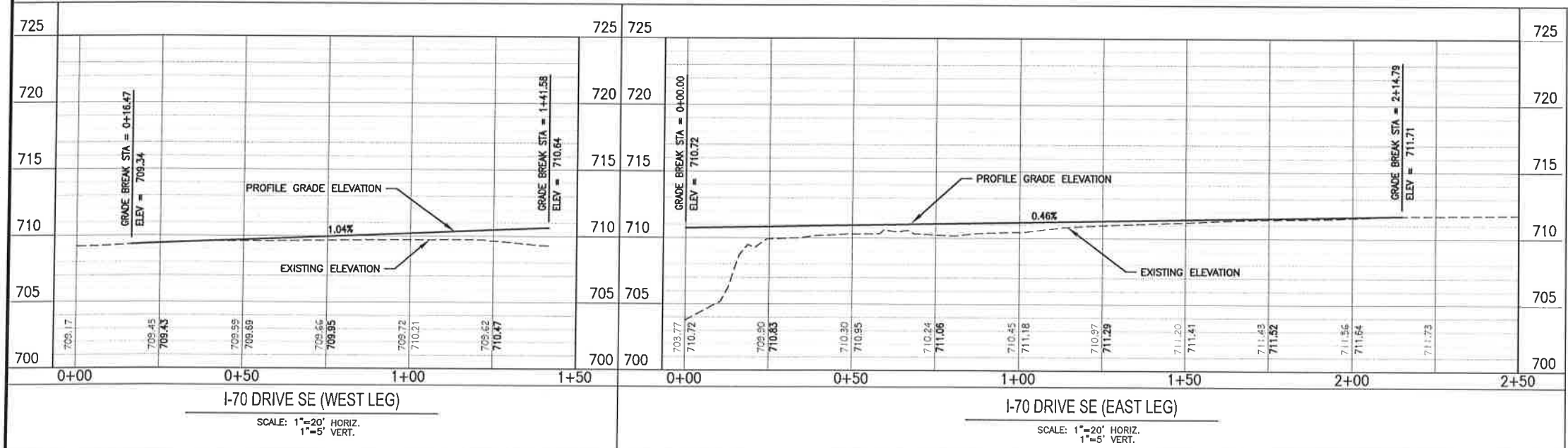

CONTRACTOR TO VERIFY
 UNDERGROUND UTILITIES
 DEPTH & LOCATION

ALL TREES, BUSHES AND SHRUBS LOCATED WITHIN THE GRADING LIMITS CAN BE REMOVED ONLY IF NECESSARY TO FACILITATE CONSTRUCTION. CHECK THE PLAN SHEETS FOR TREES AND SHRUBS SPECIFICALLY NOTED EITHER "DO NOT DISTURB" OR MARKED WITH A BOLD "X" TO BE REMOVED. THE CONTRACTOR SHALL USE CARE TO MINIMIZE THE IMPACT TO AND THE REMOVAL OF TREES. THE CONSTRUCTION INSPECTOR SHALL VERIFY ALL REMOVALS.

No.	Date	By	Revision

KEENE ST. & I-70 DR. SE ROUNDABOUT
 Plan & Profile - Sta. XX+XX to Sta. XX+XX

City of Columbia, Missouri
 Department of Public Works

David Allen Nichols
 Registered Professional Engineer
 E-24212

File No. 32-01-14
 Scale: 1" = 20'
 Date: 6/09/17
 Des. A.N.H.
 Dwn. J.L.H.
 Chk. A.A.A.

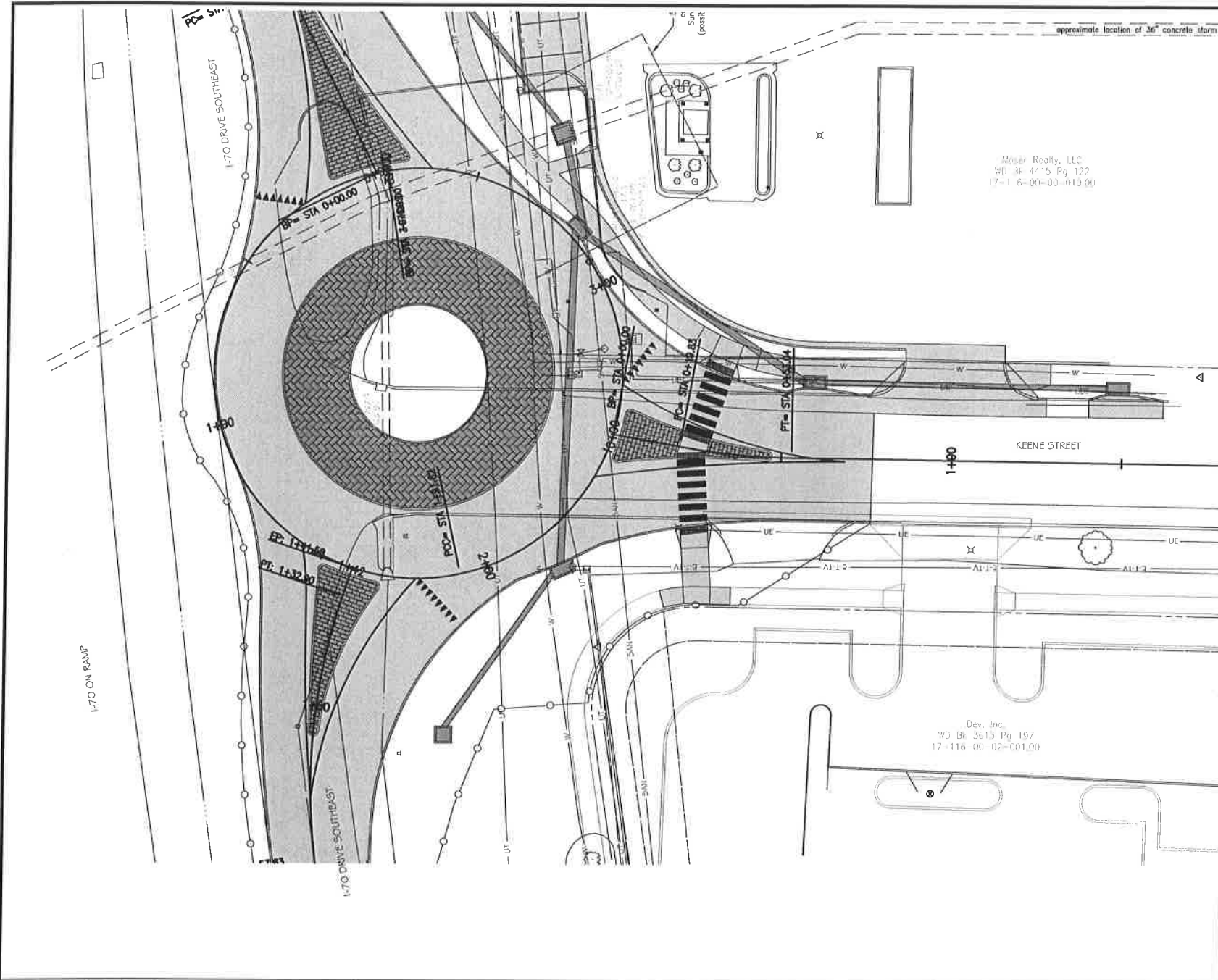

Moser Realty, LLC
 WD Bk 4415 Pg 122
 17-116-00-00-010.00

Dev. Inc.
 WD Bk 3613 Pg 197
 17-116-00-02-001.00

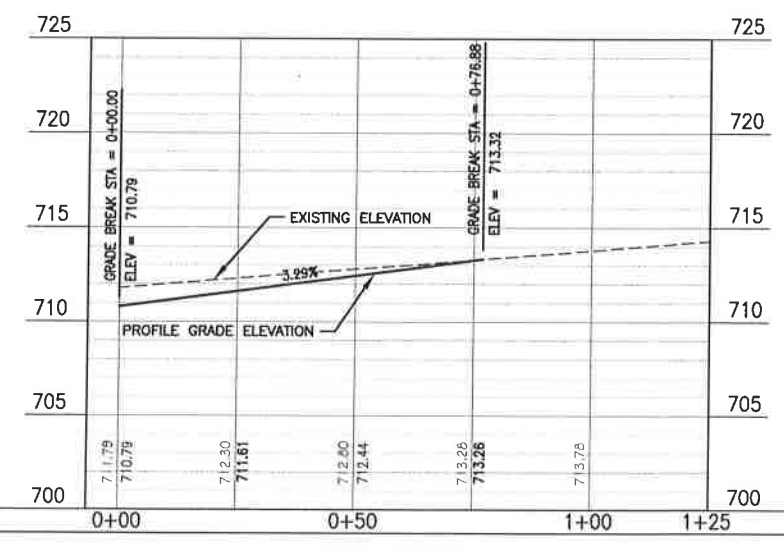

KEENE STREET
 SCALE: 1" = 20' HORIZ.
 1" = 5' VERT.

No.	Date	By	Revision

KEENE ST. & I-70 DR. SE ROUNDABOUT
 Plan & Profile - Sta. XX+XX to Sta. XX+XX

City of Columbia, Missouri
 Department of Public Works

David Allen Nichols
 Registered Professional Engineer
 E-24212

File No. 32-01-14
 Scale: 1" = 20'
 Date: 6/09/17
 Des. A.N.H.
 Dwn. J.L.H.
 Chk. AAA.