

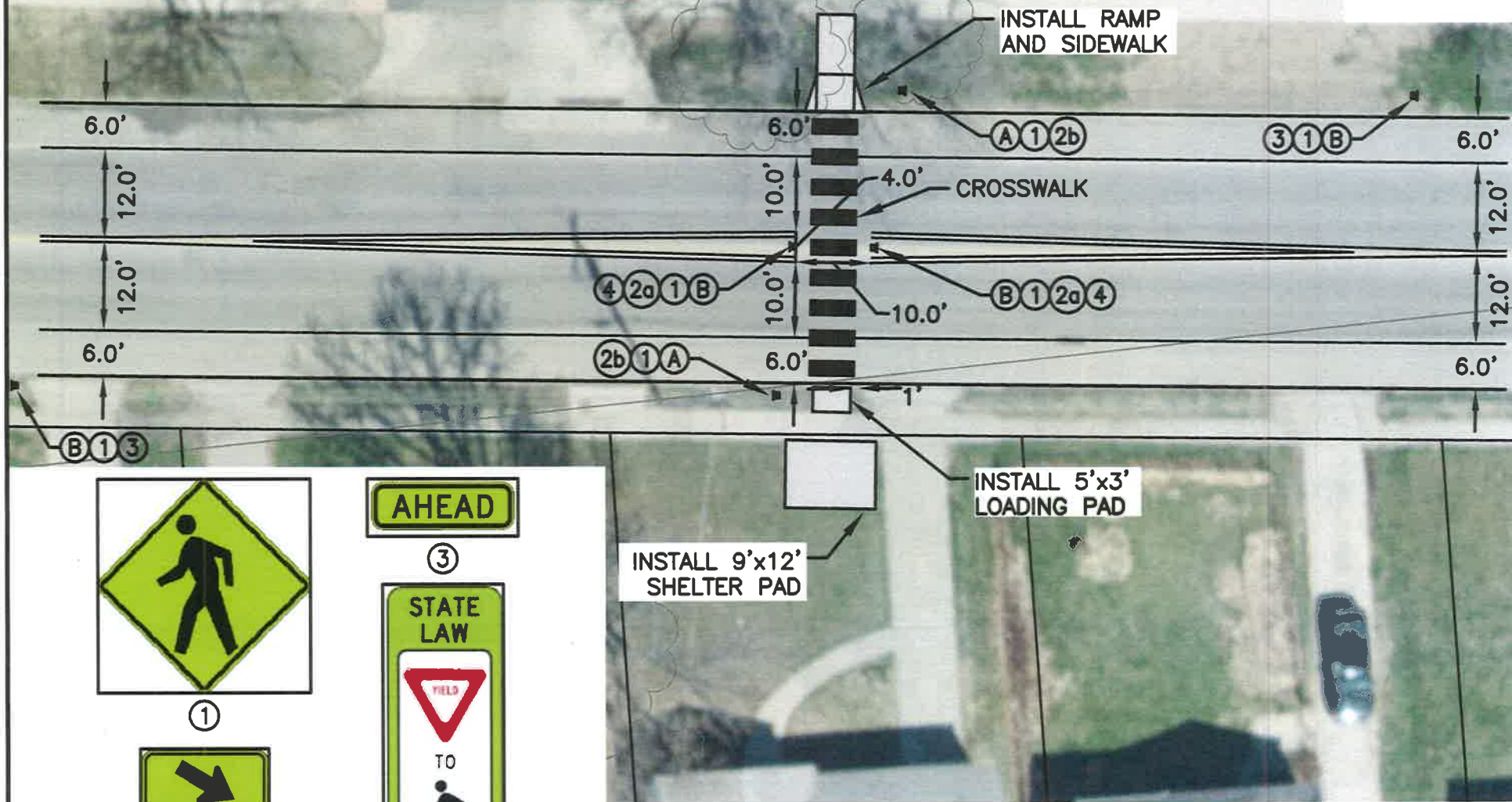

SCALE: 1"=20'



①



②a



②b



③



④

- A. INSTALL POST, SIGNS AND RAPID FLASHING BEACON WITH PUSHBUTTON
- B. INSTALL POST WITH SIGNS



City of Columbia, Missouri
Department of Public Works

1104 W. WORLEY ST.
BUS SHELTER PAD

Scale: 1" = 20' Dwn: J.L.H. Date: 3/10/17