



DRAWN BY: JRS
CHECKED BY: TDC

REVISIONS

NO.	DESCRIPTION	DATE

CE10

PEDESTRIAN CONTROL PLAN

GENERAL NOTES

TRAFFIC CONTROL DEVICES SHALL COMPLY WITH THE MUTCD.

CONTRACTOR SHALL REFER TO THE CURRENT EDITION OF THE MODOT MANUAL OF TRAFFIC CONTROL FOR FIELD OPERATIONS FOR INFORMATION ON THE PROPER DEPLOYMENT OF TRAFFIC CONTROL DEVICES.

ALL SIDEWALK CLOSURES ALONG PROVIDENCE SHALL REQUIRE ROW PERMIT APPROVAL FROM BOTH MODOT AND THE CITY OF COLUMBIA AT TIMES AND DATES TO BE APPROVED BY BOTH AGENCIES.

CONTRACTOR SHALL NOTIFY MODOT AND APPLY FOR A NOTICE OF INTENT PURSUANT TO THEIR MODOT ROW PERMIT A MINIMUM OF THREE DAYS PRIOR TO ANY SIDEWALK CLOSURE ALONG PROVIDENCE.

CONTRACTOR SHALL APPLY FOR A SHORT TERM SIDEWALK CLOSURE WITH THE CITY OF COLUMBIA COMMUNITY DEVELOPMENT 10 DAYS PRIOR TO ANY SIDEWALK CLOSURE MADE ACCORDING TO THIS PLAN.

REGULARLY SCHEDULED WORK SHALL BE COMPLETED BETWEEN 7:00AM AND 7:00PM ON WEEKDAYS AND 9:00AM TO 5:00PM ON SATURDAYS. APPLICATION FOR EXTENDED WORK HOURS SHALL BE COMPLETED AND APPROVED BY THE DIRECTOR OF PUBLIC WORKS FOR ANY TIMES OTHER THAN THESE.

THE CONTRACTOR IS RESPONSIBLE FOR NOTIFYING CITY OF COLUMBIA SITE DEVELOPMENT AT LEAST ONE WEEK PRIOR TO THE START OF ANY CLOSURE ONCE CLOSURE APPROVAL HAS BEEN GIVEN.

FOR ANY CLOSURES REQUIRED LONGER THAN 30 DAYS, CONTRACTOR SHALL APPLY FOR LONG-TERM CLOSURE TO BE APPROVED BY COLUMBIA CITY COUNCIL.

CONTRACTOR IS RESPONSIBLE FOR NOTIFYING THE FOLLOWING AGENCIES, AS REQUIRED, IMMEDIATELY PRIOR TO CLOSURE OF STREET, DURING CONSTRUCTION FOR INSPECTIONS AND AGAIN WHEN WORK IS COMPLETE AND STREET IS REOPENED:

- MODOT (ROW INSPECTIONS - JOHN KUHLMAN) 522-6806
- SITE DEVELOPMENT (ROW INSPECTIONS) 874-7250
- BUILDING SAFETY (PLUMBING/BUILDING INSPECTIONS) 874-7474
- JOINT COMMUNICATIONS (EMERGENCY SERVICES) 874-8471
- COLUMBIA TRANSIT (CITY BUSES) 874-7282
- PARKING ENFORCEMENT (PARKING METERS) 874-7674
- PUBLIC WORKS STREET DIVISION (STREET PATCHING) 874-6289

TRAFFIC CONTROL DEVICE LEGEND

	PLACE STANDARD HIGHWAY SIGN (MUTCD SIGN # R9-11 SHOULD READ "SIDEWALK CLOSED AHEAD CROSS HERE"). SIGN SHALL BE 24" X 24" MIN.
	PLACE STANDARD HIGHWAY SIGN (MUTCD SIGN # R9-9 SHOULD READ "SIDEWALK CLOSED"). SIGN SHALL BE 24" X 24" MIN.

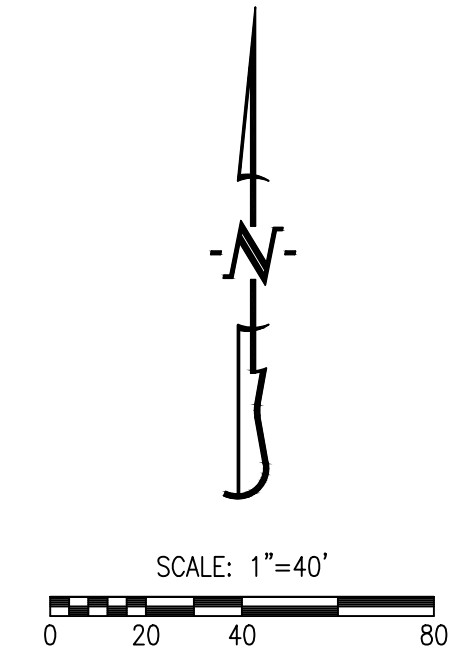

SITE/CIVIL ENGINEER:
CROCKETT
ENGINEERING CONSULTANTS
2008 North Stadium Boulevard
Columbia, Missouri 65202
(573) 447-0292
www.crockettengineering.com
Crockett Engineering Consultants, LLC
Missouri Certificate of Authority
#2000151301