

# LOCATION MAP

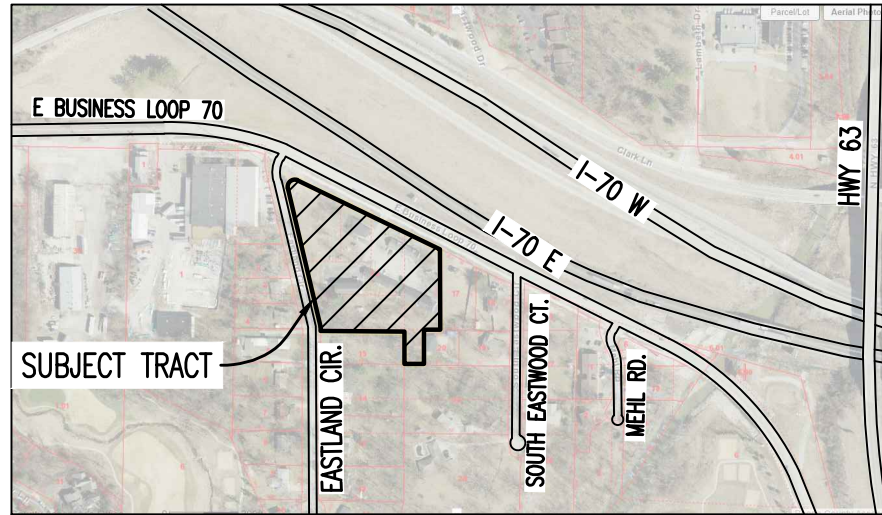

NOT TO SCALE

## OWNER

CJCA DEVELOPMENT  
2013 WILLIAM ST.  
JEFFERSON CITY, MO 65109

### SIGNIFICANT TREE COMPLIANCE:

EXISTING SIGNIFICANT TREES: 14 TREES



SIGNIFICANT TREE (20" DIAMETER OR LARGER & LOCATED OUTSIDE OF STREAM BUFFER)

## EASTWOOD MOTEL

SIGNIFICANT TREE SURVEY  
SECTION 8, TOWNSHIP 48 NORTH, RANGE 12 WEST  
COLUMBIA, BOONE COUNTY, MISSOURI

CORPORATE NUMBER: 2000151304



1000 W. Nifong Blvd., Building 1  
Columbia, Missouri 65203  
(573) 447-0292

www.crockettengineering.com

DATE:  
05/21/2021

SCALE:  
1" = 60'

PROJECT:  
200469

DRAWN BY:  
NMD

# EASTWOOD MOTEL SIGNIFICANT TREE SURVEY

SCALE: 1" = 60'

