

# Case # 59-2024 - NW Cor. Veterans United Drive & State Farm Parkway



## Preliminary Plat

Parcel Data Source: Boone County Assessor  
 Created by The City of Columbia - Community Development Department

- Columbia City Limit
- City Zoning
- City Property
- Parcels

2022 Imagery: NearMap

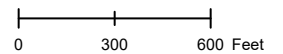

Source: Nearmap: <https://www.nearmap.com/us/en>



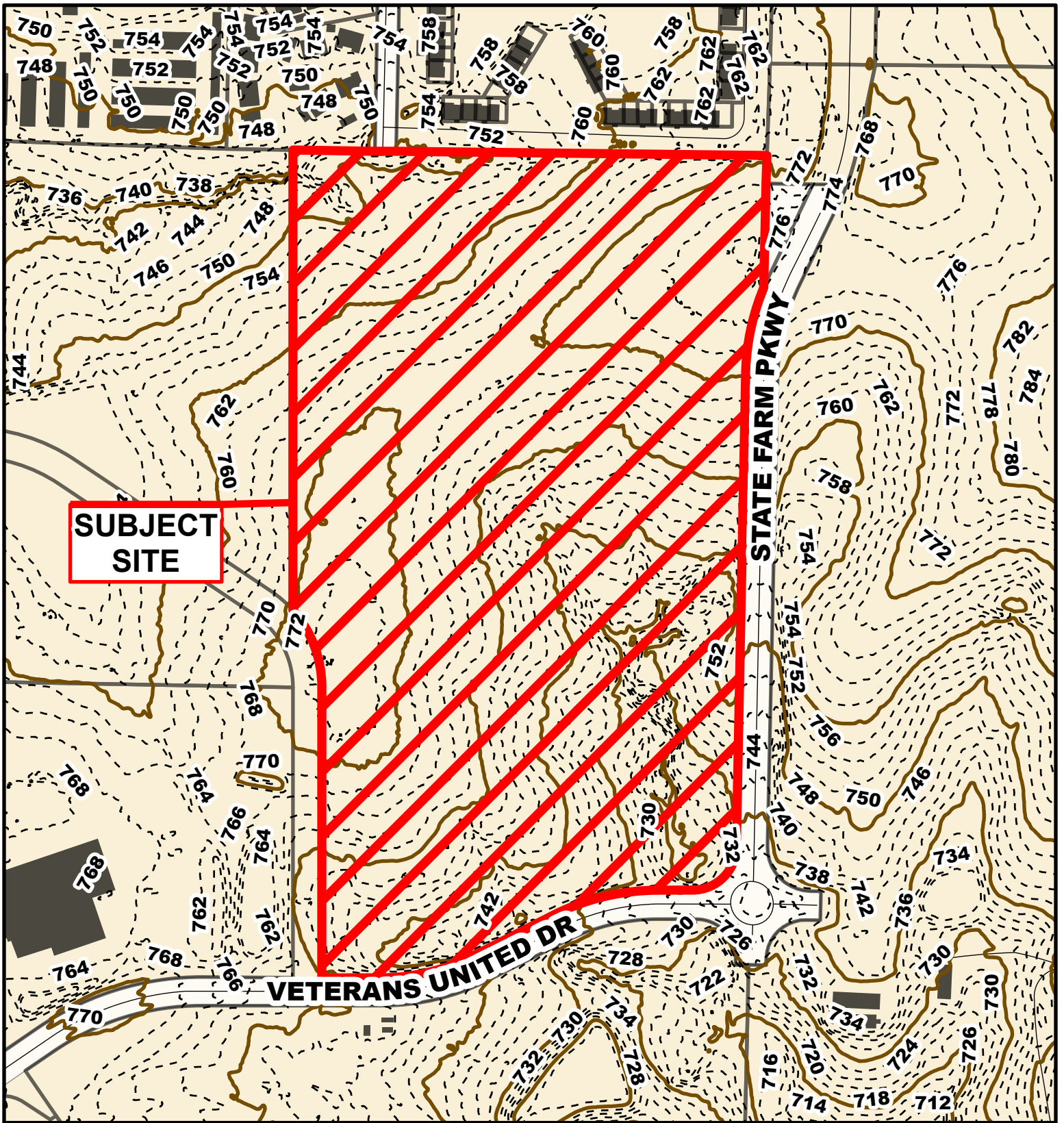

# Case # 59-2024 - NW Cor. Veterans United Drive & State Farm Parkway

## Preliminary Plat



- 10 Foot Contour Lines
- - - 2 Foot Contour Lines
- City of Columbia
- Parcels

Parcel Data Source: Boone County Assessor

Created by The City of Columbia - Community Development Department

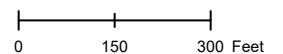

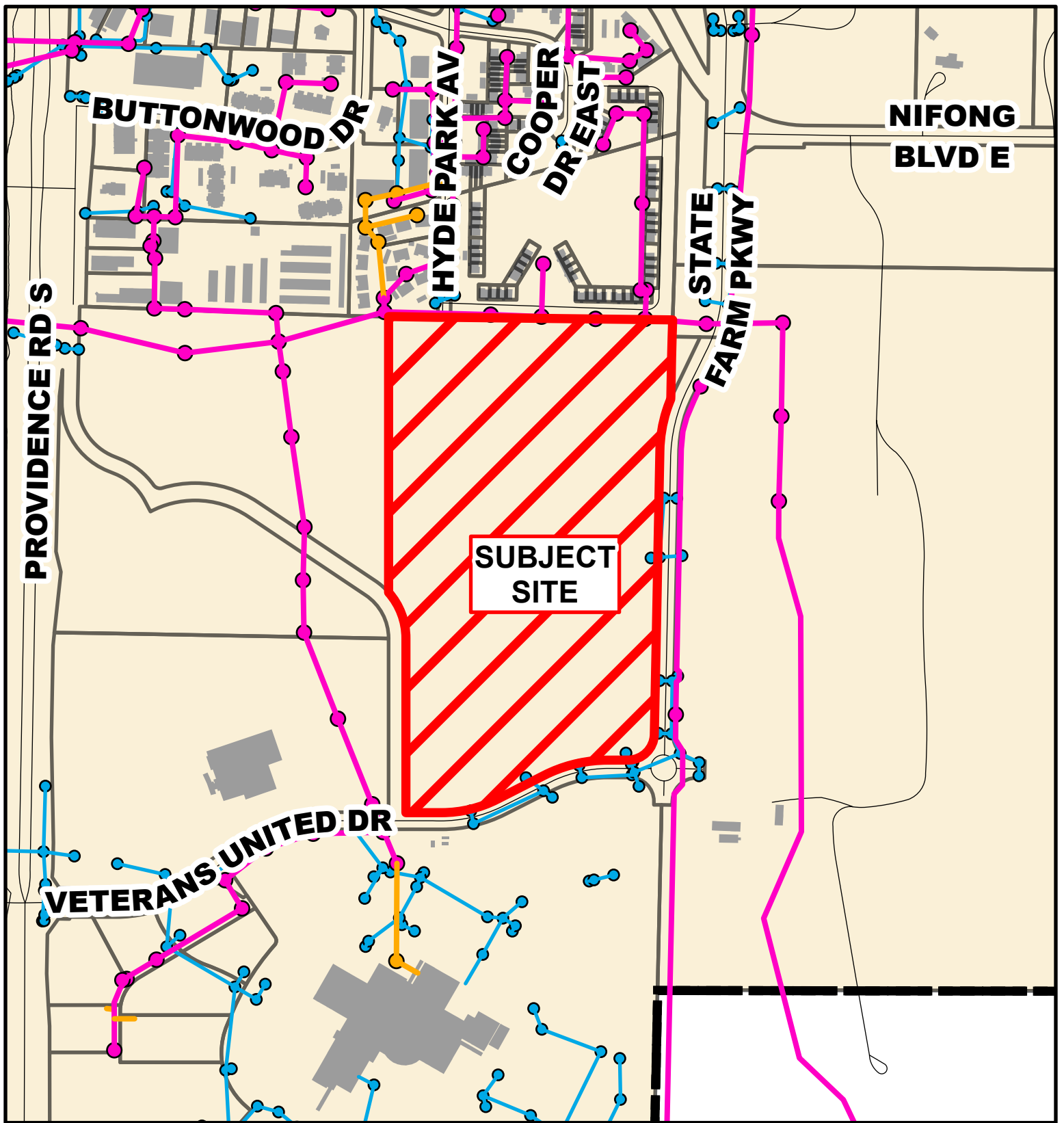

**Case # 59-2024 - NW Cor. Veterans United Drive  
& State Farm Parkway**

**Preliminary Plat**



Parcel Data Source: Boone County Assessor

Created by The City of Columbia - Community Development Department

- City Sanitary Line
- City Storm Lines
- Private Sanitary Line
- Parcels
- Columbia City Limits

