

LOCATION MAP
NOT TO SCALE

LEGEND:

- E EXISTING
- S SET
- SET 1/2" IRON PIPE (UNLESS NOTED OTHERWISE)
- (M) MEASURED DISTANCE
- (REC) RECORDED DISTANCE
- DH x DRILL HOLE
- W/ CHISELED X
- (R) RADIAL
- P.O.B. POINT OF BEGINNING

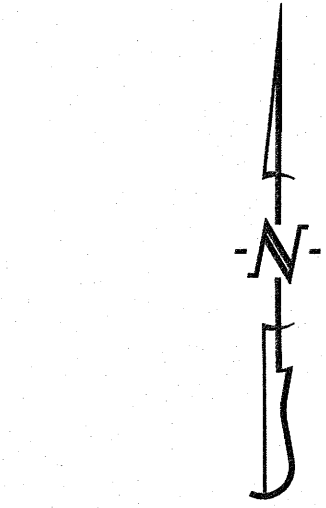

SCALE: 1"=50'
0 25 50 100

BEARINGS ARE REFERENCED TO GRID NORTH, OF THE MISSOURI STATE PLANE COORDINATE SYSTEM (CENTRAL ZONE), OBTAINED FROM GPS OBSERVATION.

KNOW ALL MEN BY THESE PRESENTS:

THAT MILLER LEASING COMPANY, LLC, IS THE SOLE OWNER OF THE HEREOF DESCRIBED TRACT AND THAT THEY HAVE CAUSED SAID TRACT TO BE SURVEYED, SUBDIVIDED, AND PLATTED AS SHOWN ON THE ABOVE DRAWING. THE EASEMENTS AS SHOWN, ARE HEREBY DEDICATED TO THE CITY OF COLUMBIA FOR THE PUBLIC USE FOREVER. THE ABOVE DRAWING AND DESCRIPTION SHALL HEREAFTER BE KNOWN AS "EAST POINTE, PLAT NO. 2-E"

IN WITNESS WHEREOF, RICHARD G. MILLER HAS CAUSED THESE PRESENTS TO BE SIGNED.

MILLER LEASING COMPANY, LLC.

Richard G. Miller
RICHARD G. MILLER, MANAGING PARTNER

STATE OF MISSOURI } SS
COUNTY OF BOONE }

SUBSCRIBED AND AFFIRMED BEFORE ME THIS 11th DAY OF March, 2020.

Kenneth Farris
KENNETH FARRIS
NOTARY PUBLIC
MY COMMISSION EXPIRES APRIL 22, 2022
COMMISSION NUMBER 14965667

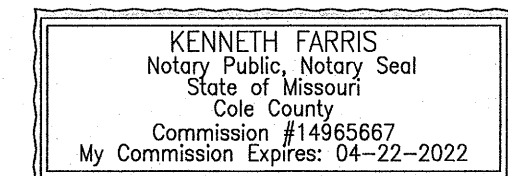

NOTES:

1. THIS TRACT IS LOCATED IN ZONE X-AREAS DETERMINED TO BE OUTSIDE THE 0.2% ANNUAL CHANCE FLOOD AS SHOWN BY THE F.E.M.A. F.I.R.M. PANEL NO. 290036C0291E, DATED: APRIL 19, 2017.
2. THIS SURVEY CONFORMS TO THE ACCURACY STANDARDS FOR URBAN PROPERTY AS DEFINED BY CODE OF STATE REGULATIONS 2 CSR 90-60.040(2).
3. A CURRENT TITLE COMMITMENT WAS NOT PROVIDED FOR THIS SURVEY
4. THERE ARE NO REGULATED STREAMS ON THIS SITE AS DETERMINED BY THE USGS MAP FOR THE COLUMBIA QUADRANGLE, BOONE COUNTY, MISSOURI AND ARTICLE X OF CHAPTER 12A OF THE CITY OF COLUMBIA CODE OF ORDINANCES

FINAL PLAT EAST POINTE, PLAT NO. 2-E

A REPLAT OF LOT 201 OF EAST POINTE PLAT NO. 2-D LOCATED IN THE WEST HALF OF SECTION 20, TOWNSHIP 48 NORTH, RANGE 12 WEST COLUMBIA, BOONE COUNTY, MISSOURI
FEBRUARY 12, 2020

CERTIFICATION:

I HEREBY CERTIFY THAT IN JANUARY OF 2019, I COMPLETED A SURVEY AND SUBDIVISION FOR MILLER LEASING COMPANY, LLC, OF A TRACT OF LAND LOCATED IN THE WEST HALF OF SECTION 20, TOWNSHIP 48 NORTH, RANGE 12 WEST, COLUMBIA, BOONE COUNTY, MISSOURI AND BEING ALL OF LOT 201 OF EAST POINTE PLAT 2-D RECORDED IN PLAT BOOK 34, PAGE 25 AND DESCRIBED BY THE WARRANTY DEED RECORDED IN BOOK 1599, PAGE 25 AND BEING MORE PARTICULARLY DESCRIBED AS FOLLOWS:

BEGINNING AT THE SOUTHWEST CORNER OF SAID LOT 201 AND WITH THE WEST LINE THEREOF, N 1°27'05"E, 251.12 FEET; THENCE N 58°32'20"W, 330.00 FEET; THENCE 47.13 FEET ALONG A 30.00-FOOT RADIUS CURVE TO THE LEFT, SAID CURVE HAVING A CHORD, S 76°27'40"W, 42.43 FEET TO THE WESTERMOST CORNER OF SAID LOT 201 SAID POINT ALSO BEING ON THE EASTERLY RIGHT-OF-WAY LINE OF EAST POINTE DRIVE; THENCE WITH SAID RIGHT-OF-WAY LINE N 31°27'40"E, 312.77 FEET; THENCE 105.73 FEET ALONG A 1533.00-FOOT RADIUS CURVE TO THE LEFT, SAID CURVE HAVING A CHORD OF N 29°29'05"E, 105.71 FEET; THENCE 45.91 FEET ALONG A 30.00-FOOT RADIUS CURVE TO THE RIGHT, SAID CURVE HAVING A CHORD OF N 71°21'15"E, 41.56 FEET; THENCE LEAVING SAID RIGHT-OF-WAY LINE AND WITH THE SOUTHERLY RIGHT-OF-WAY LINE OF BLUFF CREEK BOULEVARD, S 64°48'05"E, 249.10 FEET; THENCE 449.37 FEET ALONG A 427.00-FOOT RADIUS CURVE TO THE RIGHT, SAID CURVE HAVING A CHORD OF S 34°39'10"E, 428.92 FEET; THENCE S 4°30'15"E, 220.07 FEET TO THE SOUTHEAST CORNER OF SAID LOT 201; THENCE LEAVING SAID RIGHT-OF-WAY LINE AND WITH THE SOUTH LINE OF SAID LOT 201, S 78°17'40"W, 359.67 FEET; THENCE S 64°47'40"W, 80.28 FEET TO THE POINT OF BEGINNING AND CONTAINING 7.54 ACRES.

I FURTHER CERTIFY THAT I SURVEYED THE ABOVE DESCRIBED PROPERTY AND SUBDIVIDED IT AS SHOWN ON THE PLAT IN ACCORDANCE WITH THE CURRENT MISSOURI STANDARDS FOR PROPERTY BOUNDARY SURVEYS.

SURVEY AND PLAT BY:

CROCKETT ENGINEERING CONSULTANTS, LLC
1000 W. NIFONG BLVD. BUILDING 1
COLUMBIA, MO 65203

CORPORATE NUMBER: 2000151304

David W. Borden
DAVID W. BORDEN, PLS-2002000244
3-11-2020
DATE

STATE OF MISSOURI } SS
COUNTY OF BOONE }

SUBSCRIBED AND AFFIRMED BEFORE ME THIS 11th DAY OF March, 2020.

Kenneth Farris
KENNETH FARRIS
NOTARY PUBLIC
MY COMMISSION EXPIRES APRIL 22, 2022
COMMISSION NUMBER 14965667

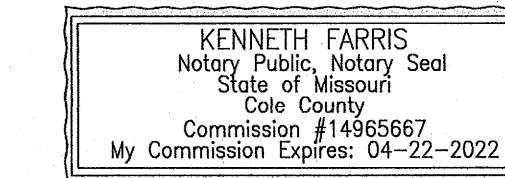

APPROVED BY CITY COUNCIL PURSUANT TO ORDINANCE # _____
ON THE _____ DAY OF _____, 2020.

BRIAN TREECE, MAYOR

ATTEST:

SHEELA AMIN, CITY CLERK

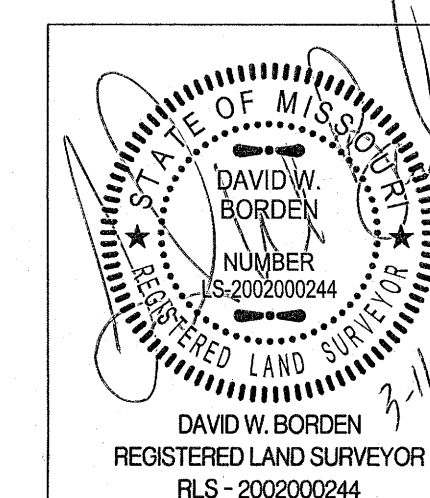

EAST POINTE, PLAT NO. 2-E	
WEST HALF OF SECTION 20, TOWNSHIP 48 NORTH, RANGE 12 WEST COLUMBIA, BOONE COUNTY, MISSOURI	
CORPORATE NUMBER: 2000151304	
DATE: 2/12/2020	SCALE: 1" = 50'
PROJECT: 140257	DRAWN BY: EWD/DWB

