



**Case # 218-2024 - 210 Bourn Avenue
STR Conditional Use Permit**



City Zoning Parcels

Parcel Data Source: Boone County Assessor

Created by The City of Columbia - Community Development Department

2022 Imagery: NearMap

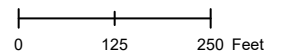

N



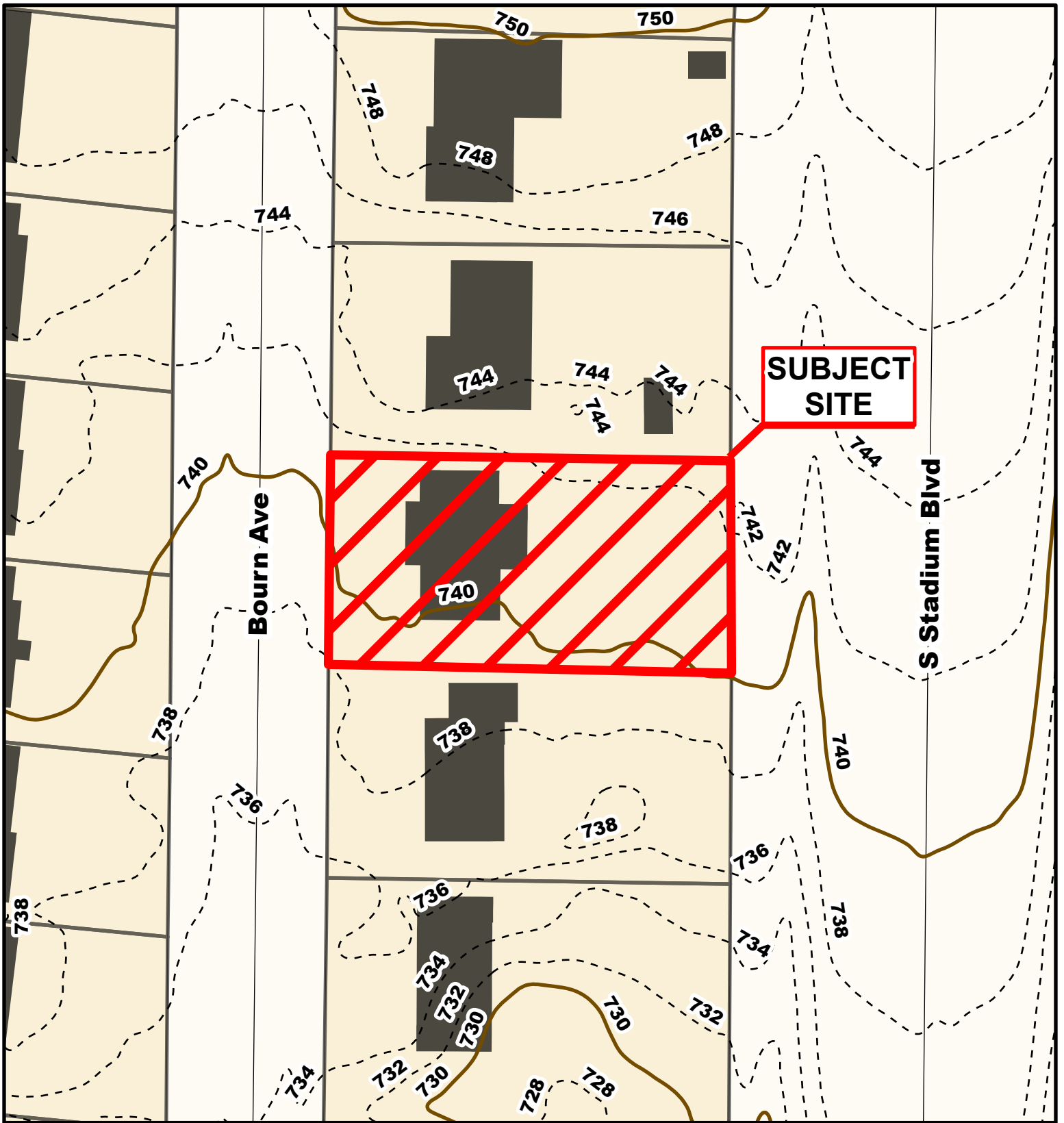

Case # 218-2024 - 210 Bourn Avenue STR Conditional Use Permit



— 10 Foot Contour Lines □ Parcels
- - - 2 Foot Contour Lines



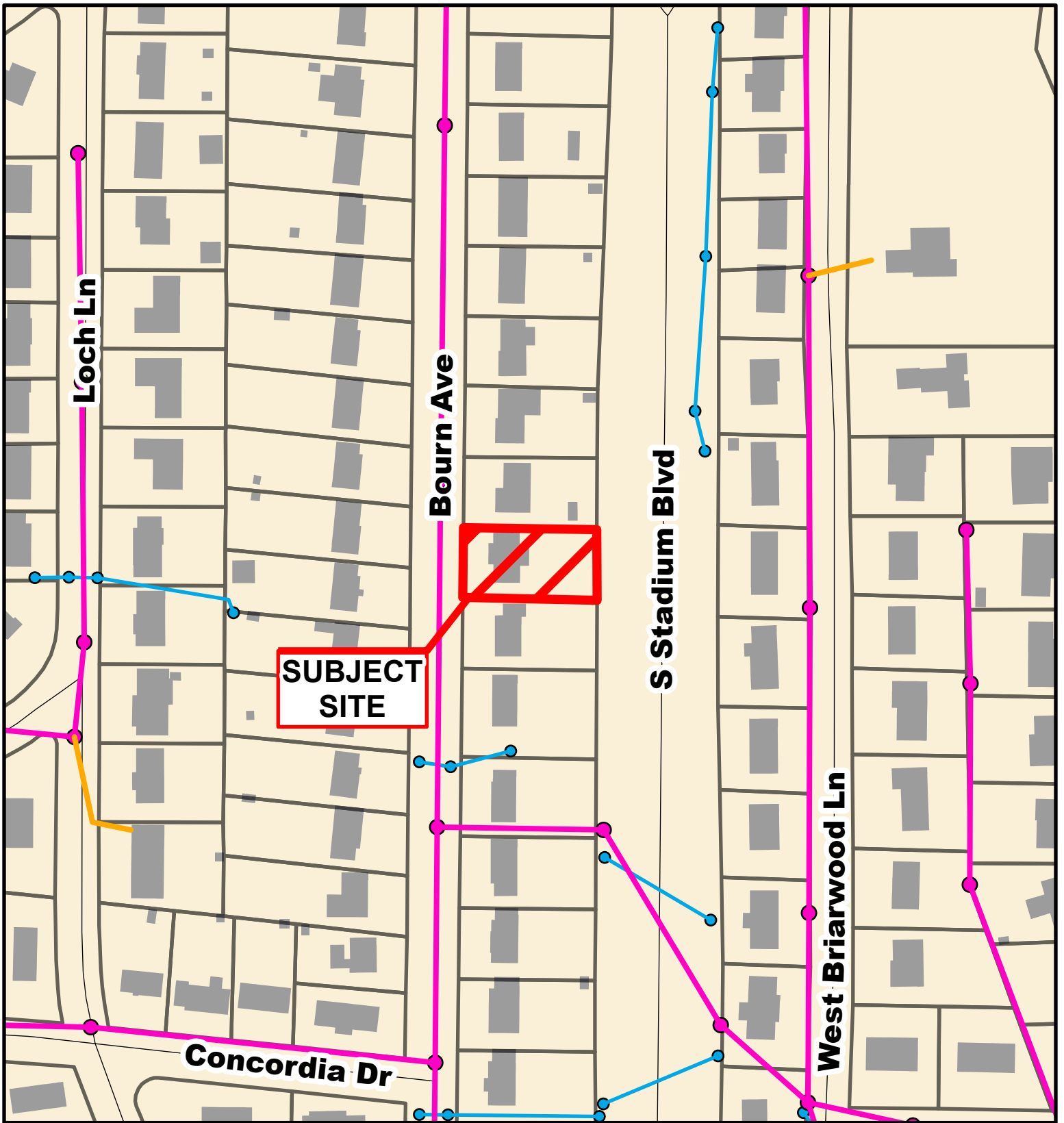

Case # 218-2024 - 210 Bourn Avenue
STR Conditional Use Permit



- City Sanitary Line
- City Storm Lines
- Private Sanitary Line
- Parcels

