



#17-207 Renaissance - Plat 3 Final Plat



Roads	Columbia City Limit
City Zoning	CityViewparcels
Parcels	



Created by The City of Columbia - Community Development Department

Parcel Data Source: Boone County Assessor

2015 Imagery: Boone County Assessor's Office

Hillshade Data: Boone County GIS Office

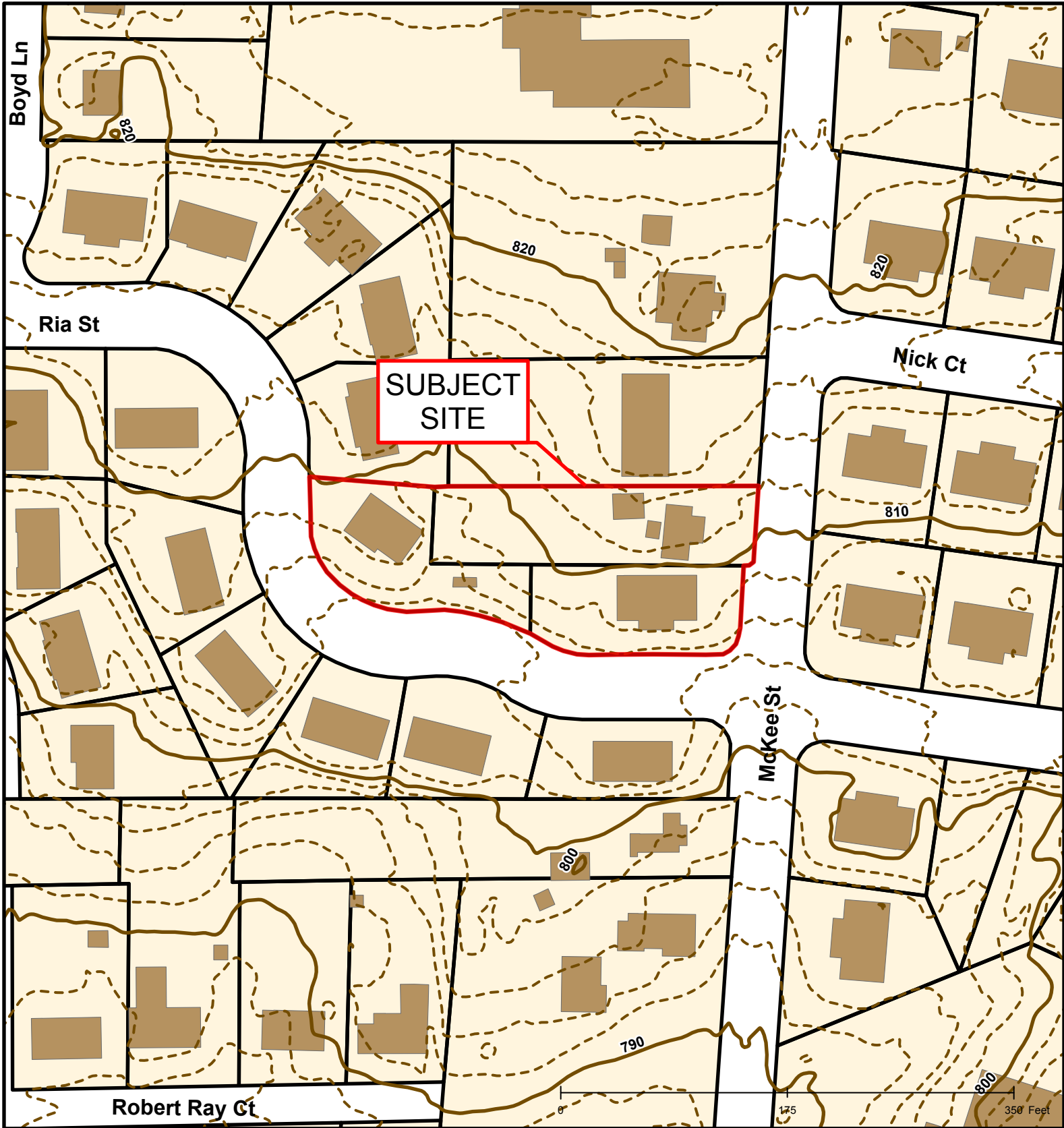

#17-207 Renaissance - Plat 3 Final Plat

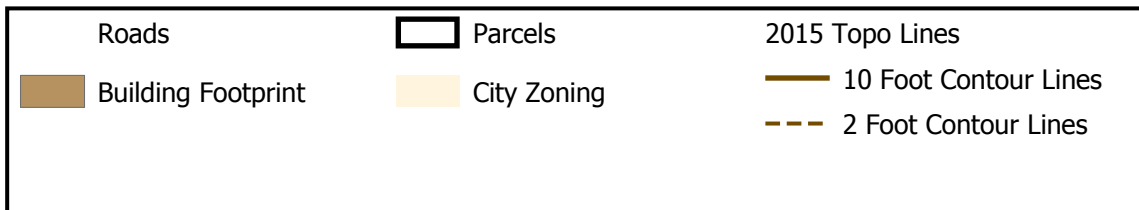

Created by The City of Columbia - Community Development Department

Parcel Data Source: Boone County Assessor

2015 Imagery: Boone County Assessor's Office

Hillshade Data: Boone County GIS Office

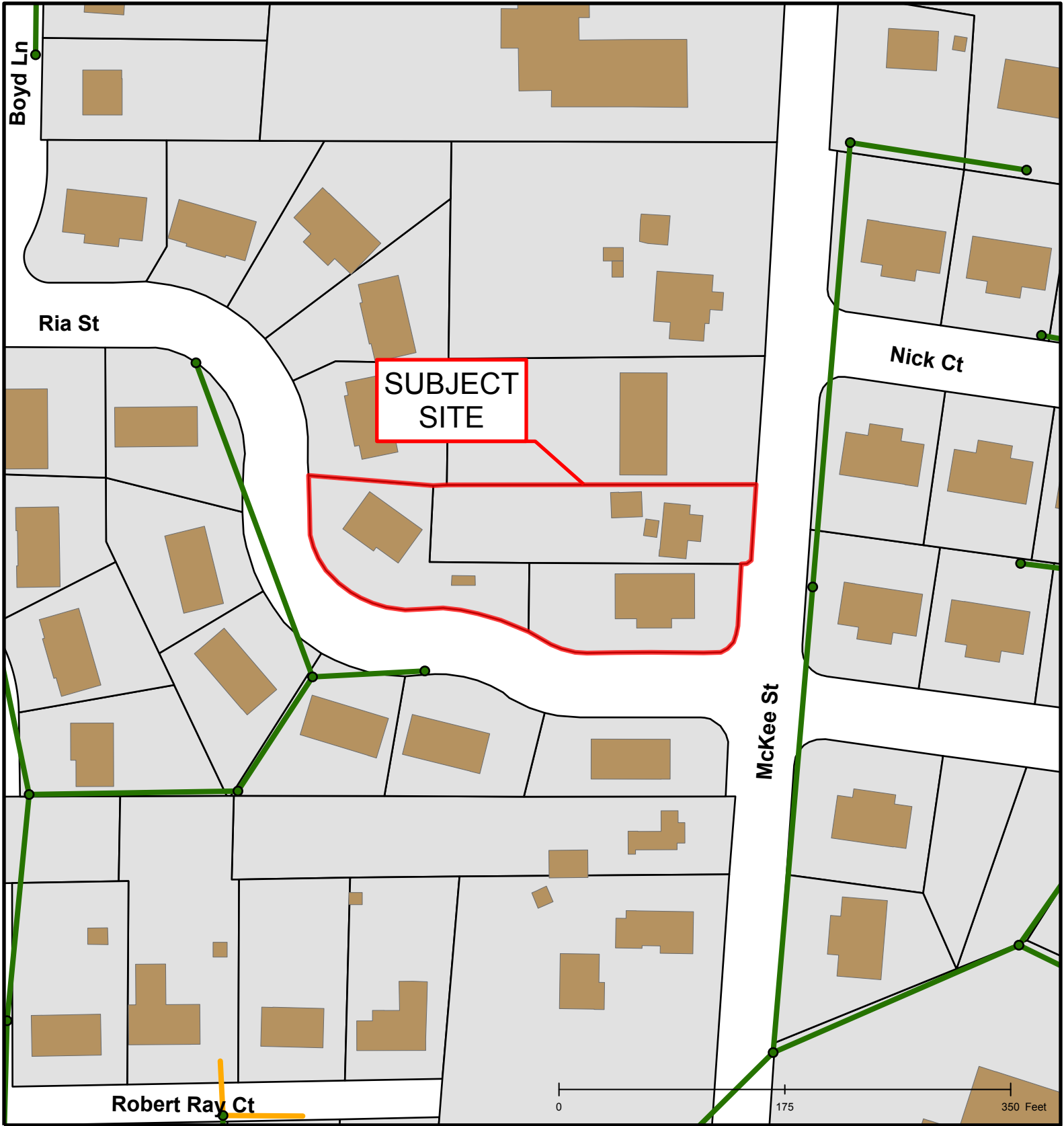

#17-207 Renaissance - Plat 3 Final Plat

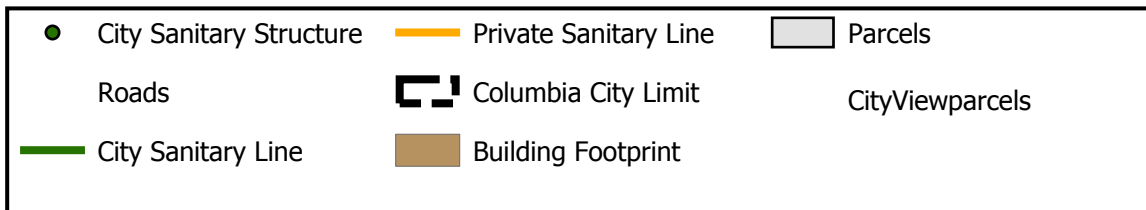

Created by The City of Columbia - Community Development Department

Parcel Data Source: Boone County Assessor

2015 Imagery: Boone County Assessor's Office

Hillshade Data: Boone County GIS Office