

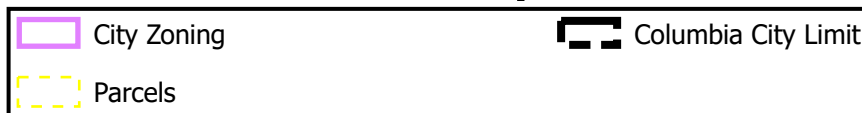

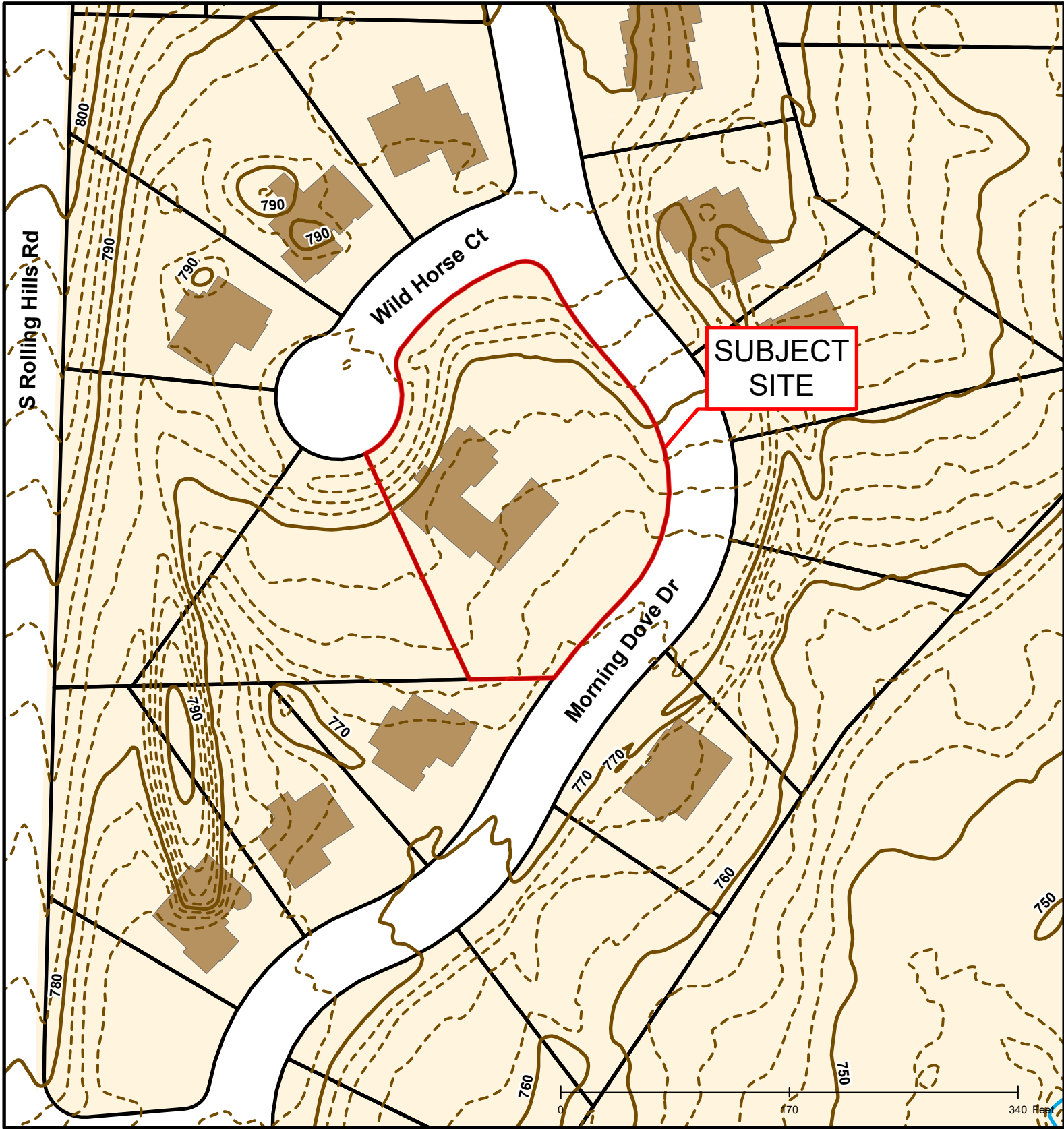





#71-20: Old Hawthorne Plat 14 Replat





#71-20: Old Hawthorne Plat 14 Replat

| | | |
|---|---|---|
|  Building Footprint |  Parcels | 2015 Topo Lines |
|  10 Foot Contour Lines |  Streams | CODE |
|  2 Foot Contour Lines |  City Zoning |  10 Foot Contour Lines |



Created by The City of Columbia - Community Development Department

Parcel Data Source: Boone County Assessor

2017 Imagery: Boone County Assessor's Office

Hillshade Data: Boone County GIS

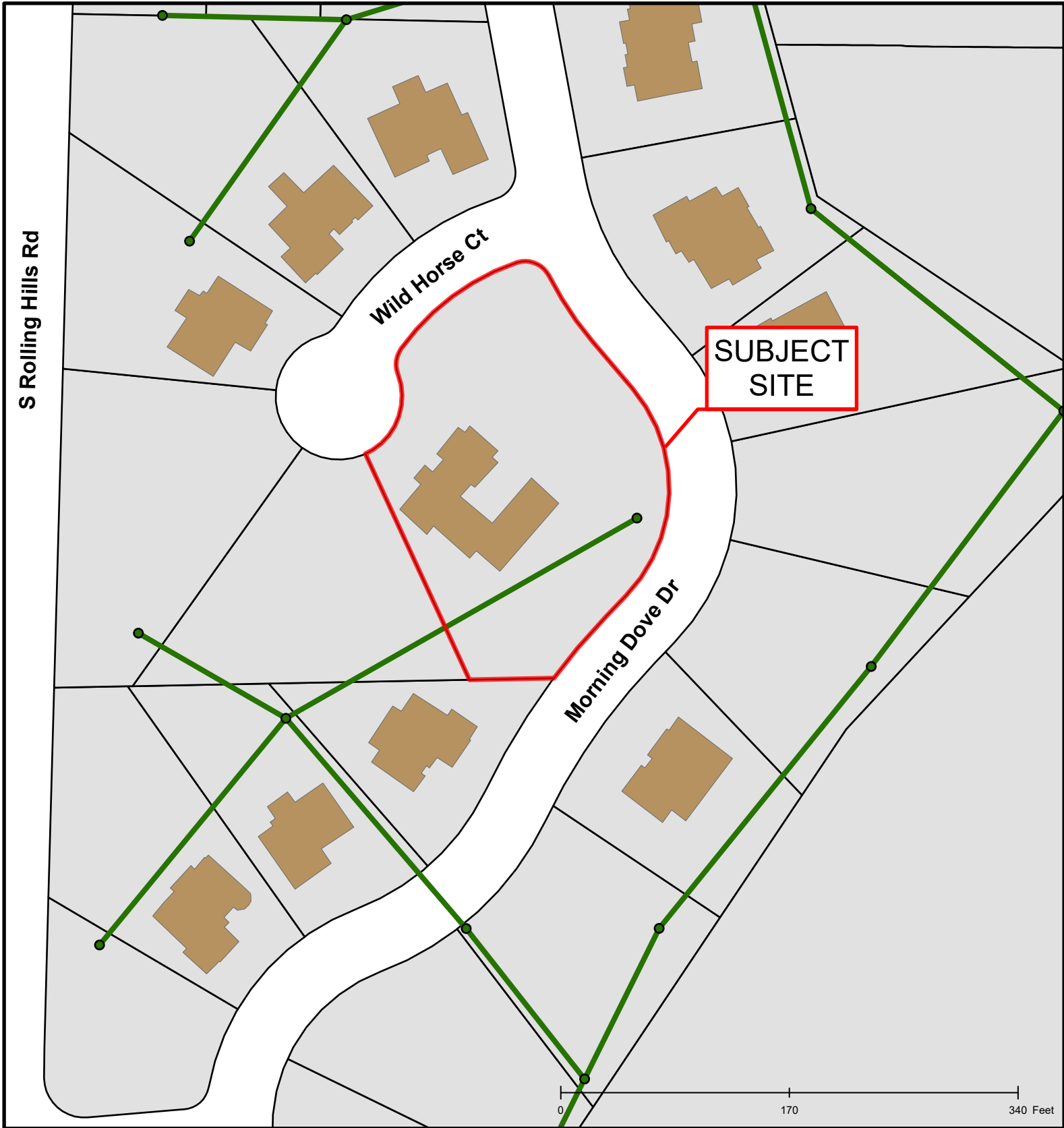

#71-20: Old Hawthorne Plat 14 Replat



| | |
|-------------------------|---------------------|
| City Sanitary Structure | Columbia City Limit |
| City Sanitary Line | Building Footprint |
| | Parcels |

