

**SITE OF PROPOSED RE-ZONING**

**LOUISVILLE PARK**

**SMITH DRIVE**

**SCOTT BLVD**

**CONCEPTUAL DEVELOPMENT  
& REZONING EXHIBIT  
WESTBURY VILLAGE**

COLUMBIA, MISSOURI  
APRIL 20, 2018

SCALE: 1" = 300'

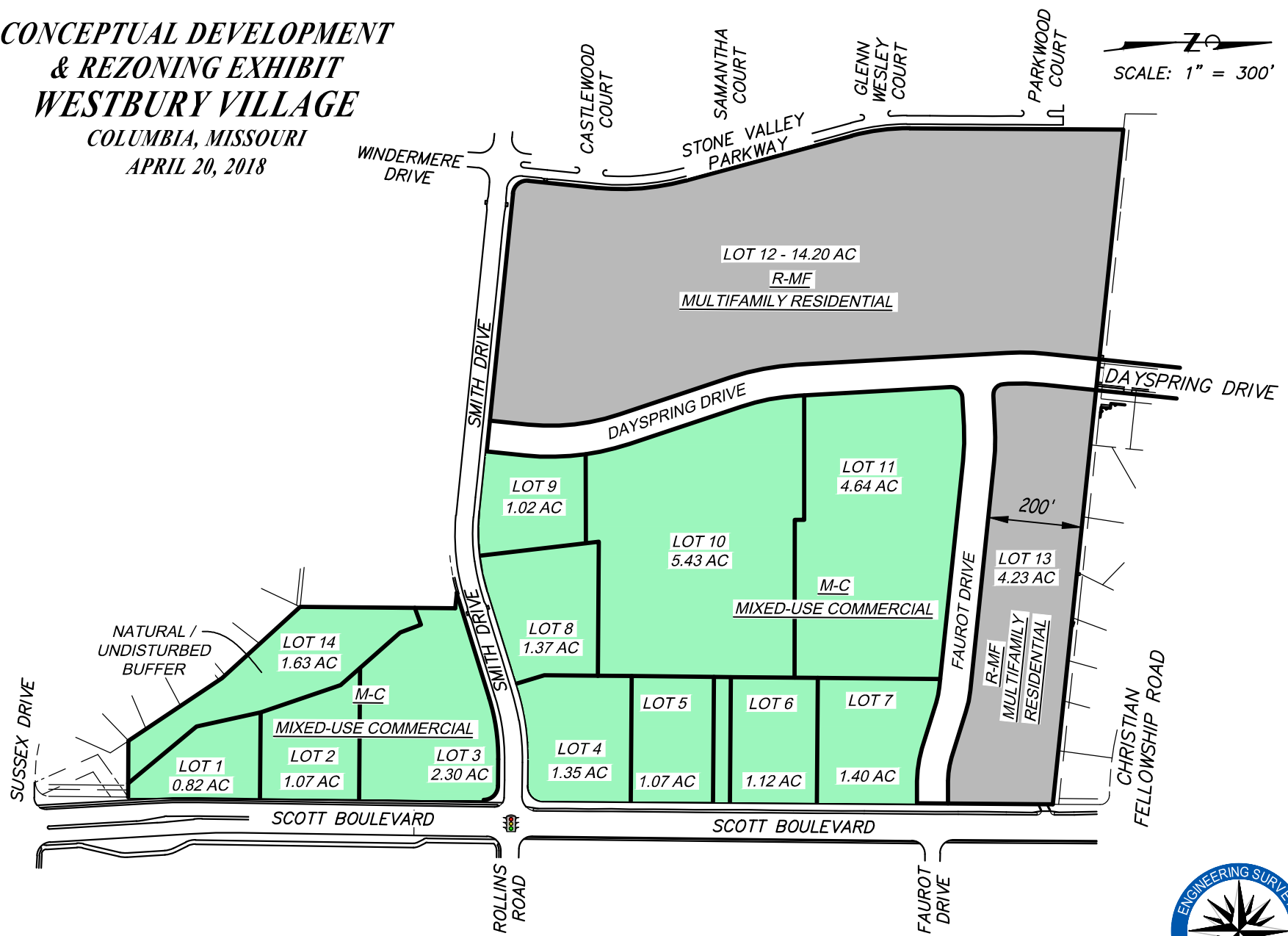

**Engineering Surveys & Services**

1113 Fay Street, Columbia, Missouri 65201  
573 - 449 - 2646 | www.ess-inc.com

Missouri Engineering Corporation # 2004005018

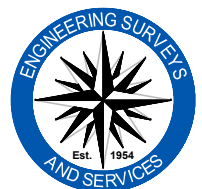

ES&S NO. 13751