

BEARINGS ARE REFERENCED TO GRID NORTH, OF THE MISSOURI STATE PLANE COORDINATE SYSTEM (CENTRAL ZONE), OBTAINED FROM GPS OBSERVATION.

CROCKETT ENGINEERING CONSULTANTS 1000 W. Nifong Blvd., Building 1 Columbia, Missouri 65203 (573) 447-0292 www.crockettengineering.com		CORPORATE NO: 2000151304		CHESTER EDWARDS TRACT REZONING TRACT EXHIBIT SEC. 30, T48N, R12W COLUMBIA, BOONE COUNTY, MISSOURI	
		DATE: 07/06/2023	SCALE: 1" = 200'		
PROJECT: TDC		DRAWN BY: CMS			

A TRACT OF LAND LOCATED IN THE SOUTHWEST QUARTER OF SECTION 30, TOWNSHIP 48 NORTH, RANGE 12 WEST, COLUMBIA, BOONE COUNTY, MISSOURI AND BEING THE WEST FOUR HUNDRED FIFTY (450) FEET OF A TRACT OF LAND AS DESCRIBED IN WARRANTY DEED (A) RECORDED IN BOOK 3028, PAGE 55 AND BEING MORE PARTICULARLY DESCRIBED AS FOLLOWS:

BEGINNING AT A POINT 601.92 FEET NORTH AND 905 FEET EAST OF THE SOUTHWEST CORNER OF SAID QUARTER SECTION ON THE COUNTY ROAD; THENCE NORTH ALONG THE EAST LINE OF COUNTY SURVEY 7738, 970.40 FEET TO THE NORTHEAST CORNER OF SAID SURVEY NO. 7738; THENCE EAST 1438.00 FEET TO THE WEST LINE OF COUNTY SURVEY NO. 7796; THENCE SOUTH ALONG THE WEST LINE OF SAID SURVEY NO. 7796, 963.50 FEET TO THE COUNTY ROAD; THENCE WEST 1438.00 FEET TO THE BEGINNING.

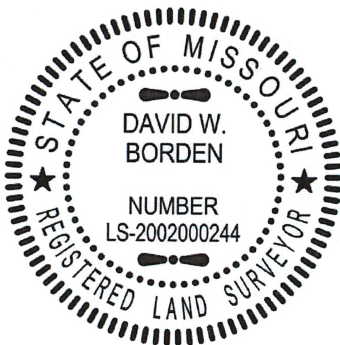

DAVID W. BORDEN, PLS-2002000244

6-8-2023

DATE

CROCKETT ENGINEERING CONSULTANTS 1000 W. Nifong Blvd. Building 1 Columbia, Missouri 65203 (573) 447-0292 www.crockettengineering.com	CORPORATE NUMBER 2000151304	REZONING TRACT DESC.
	DATE: 6/8/2023 PROJECT: 230252	LOCATED IN S30-T48N-R12W COLUMBIA, BOONE COUNTY, MISSOURI