

## #136-19: Broadway Shops Major PD Amendment

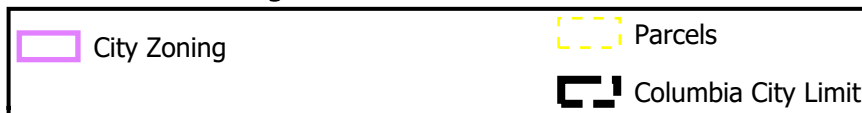

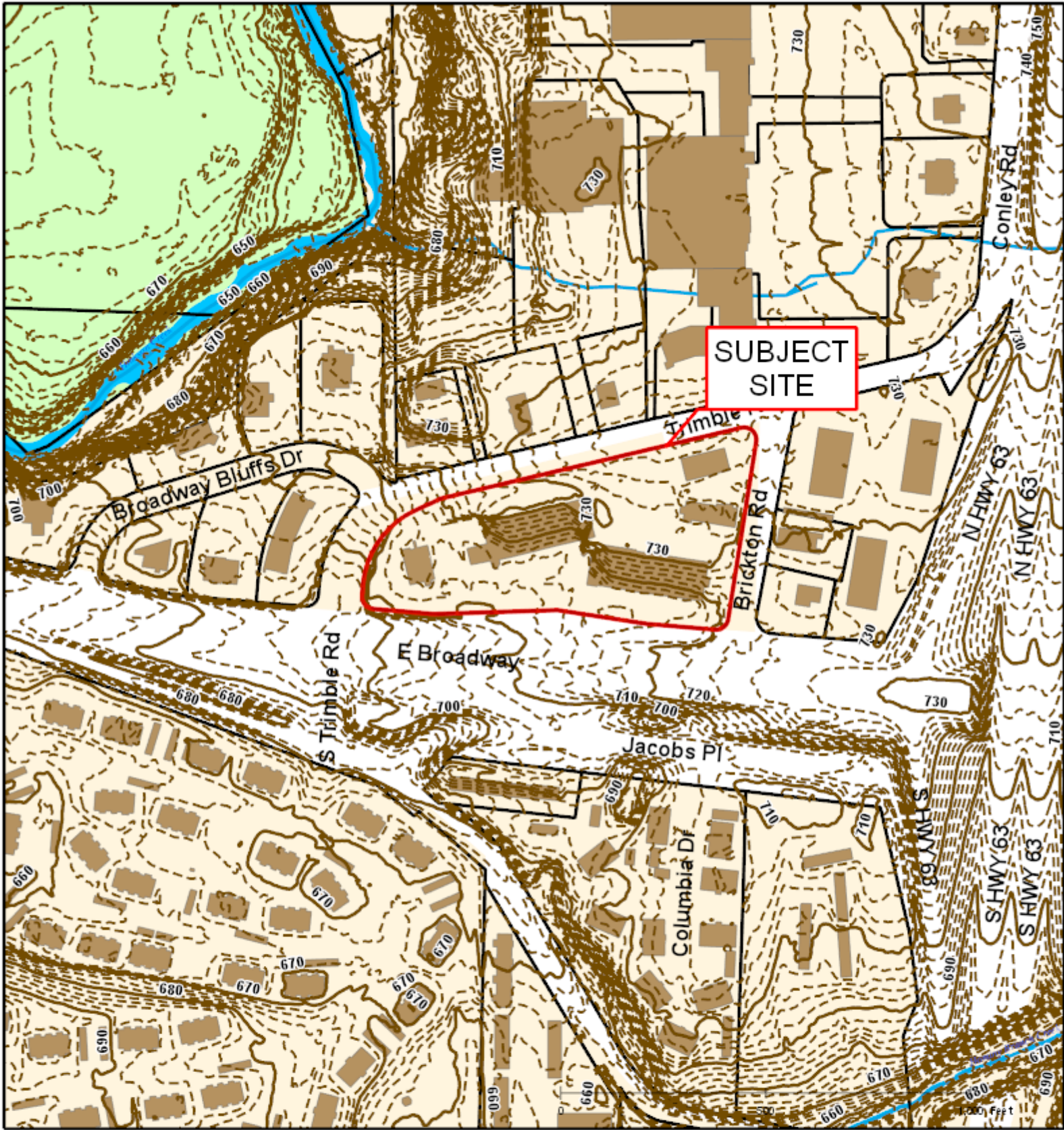



## #136-19: Broadway Shops Major PD Amendment



Created by The City of Columbia - Community Development Department

Parcel Data Source: Boone County Assessor

2017 Imagery: Boone County Assessor's Office

Hillshade Data: Boone County GIS

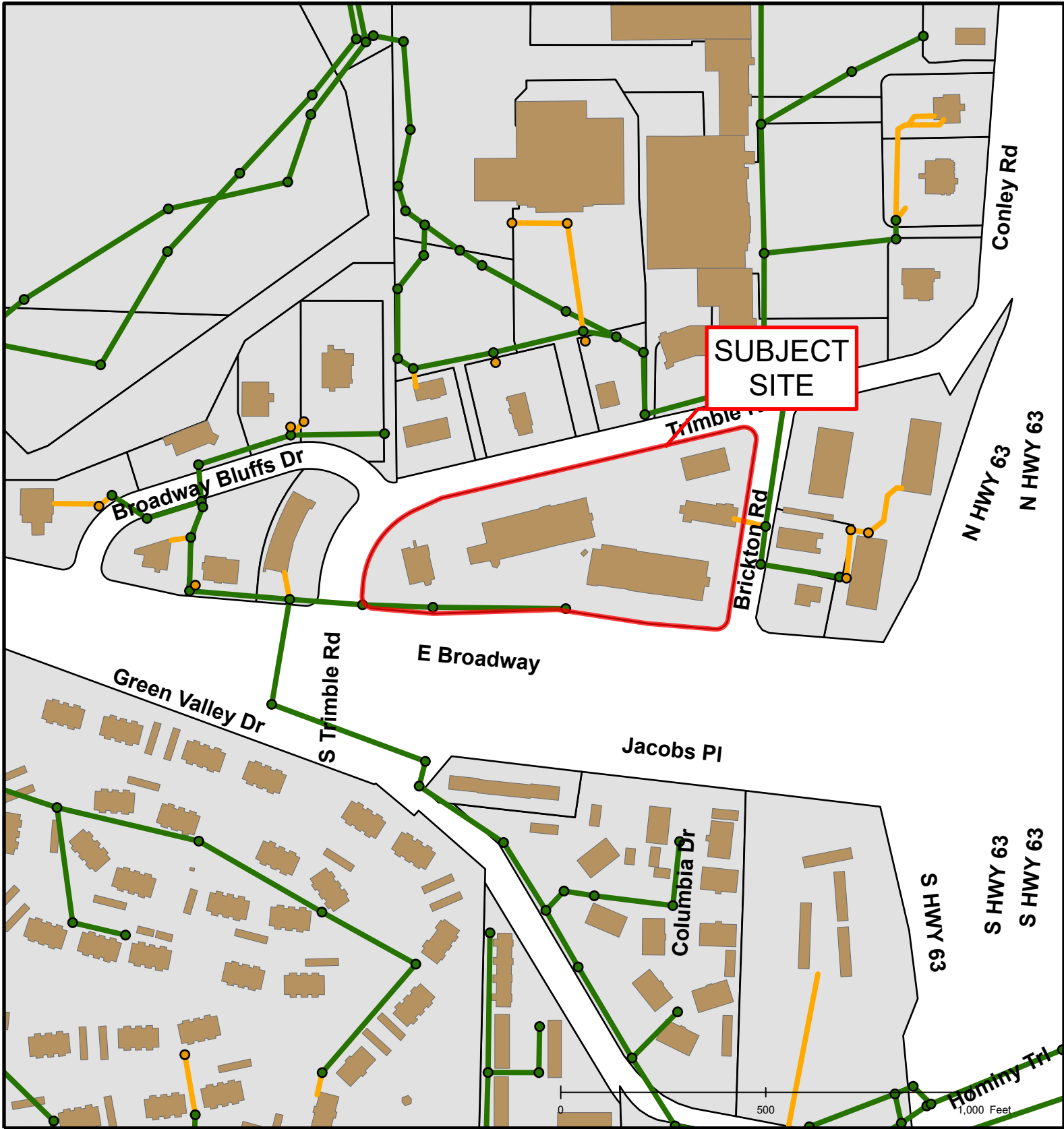

## #136-19: Broadway Shops Major PD Amendment

