

#92-2019: BCJ Investments, LLC Permanent Zoning



Created by The City of Columbia - Community Development Department

Parcel Data Source: Boone County Assessor

2017 Imagery: Boone County Assessor's Office

Hillshade Data: Boone County GIS

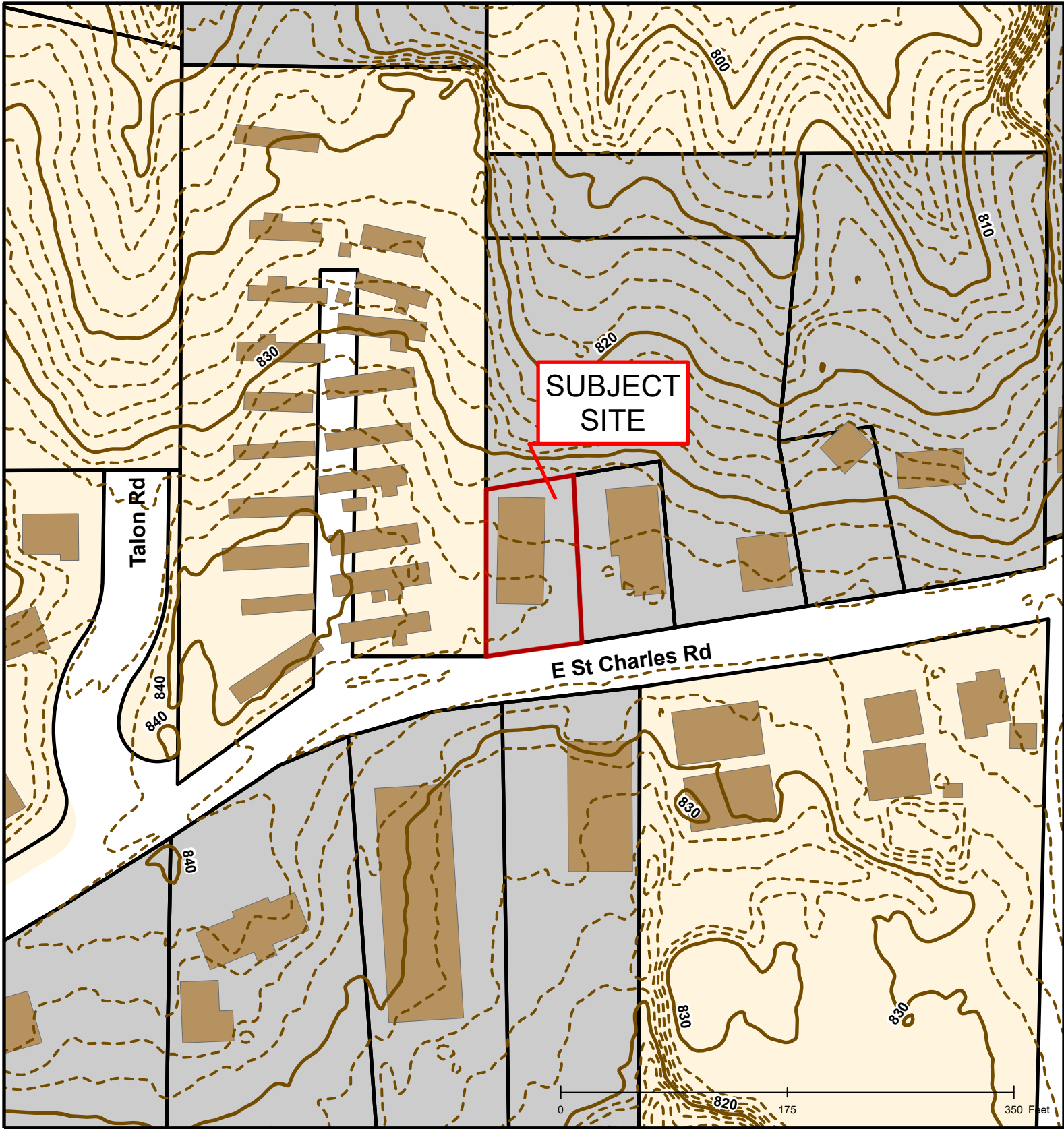

#92-2019: BCJ Investments, LLC Permanent Zoning

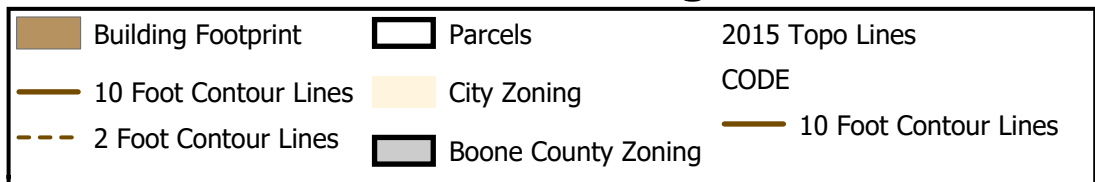

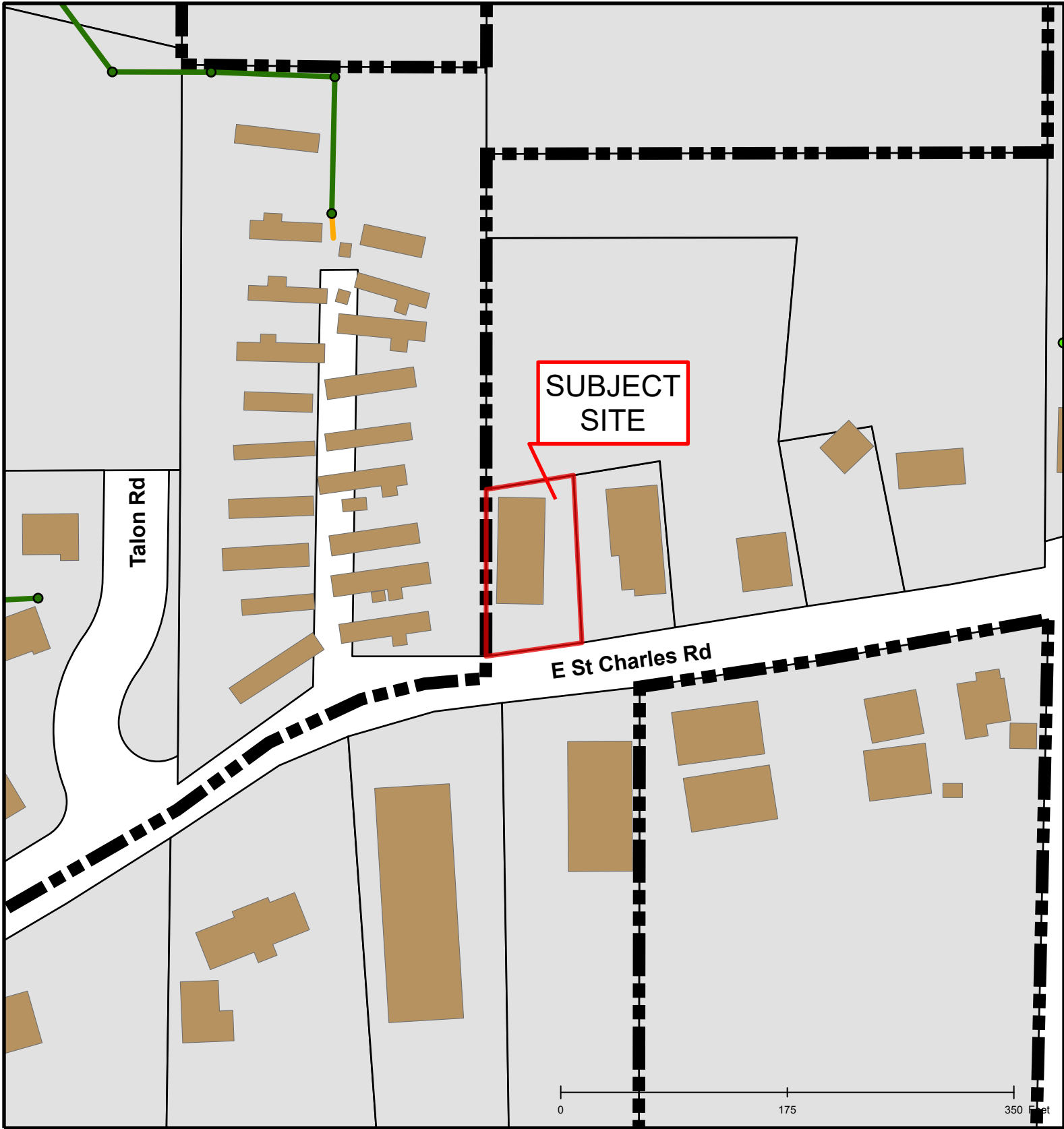

#92-2019: BCJ Investments, LLC Permanent Zoning

