

Case # 78-2024 - 4190 W. Vawter School Road PD Plan & Design Exceptions



- Columbia City Limit
- City Zoning
- City Property
- Parcels



Parcel Data Source: Boone County Assessor

Created by The City of Columbia - Community Development Department

2022 Imagery: NearMap

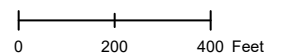

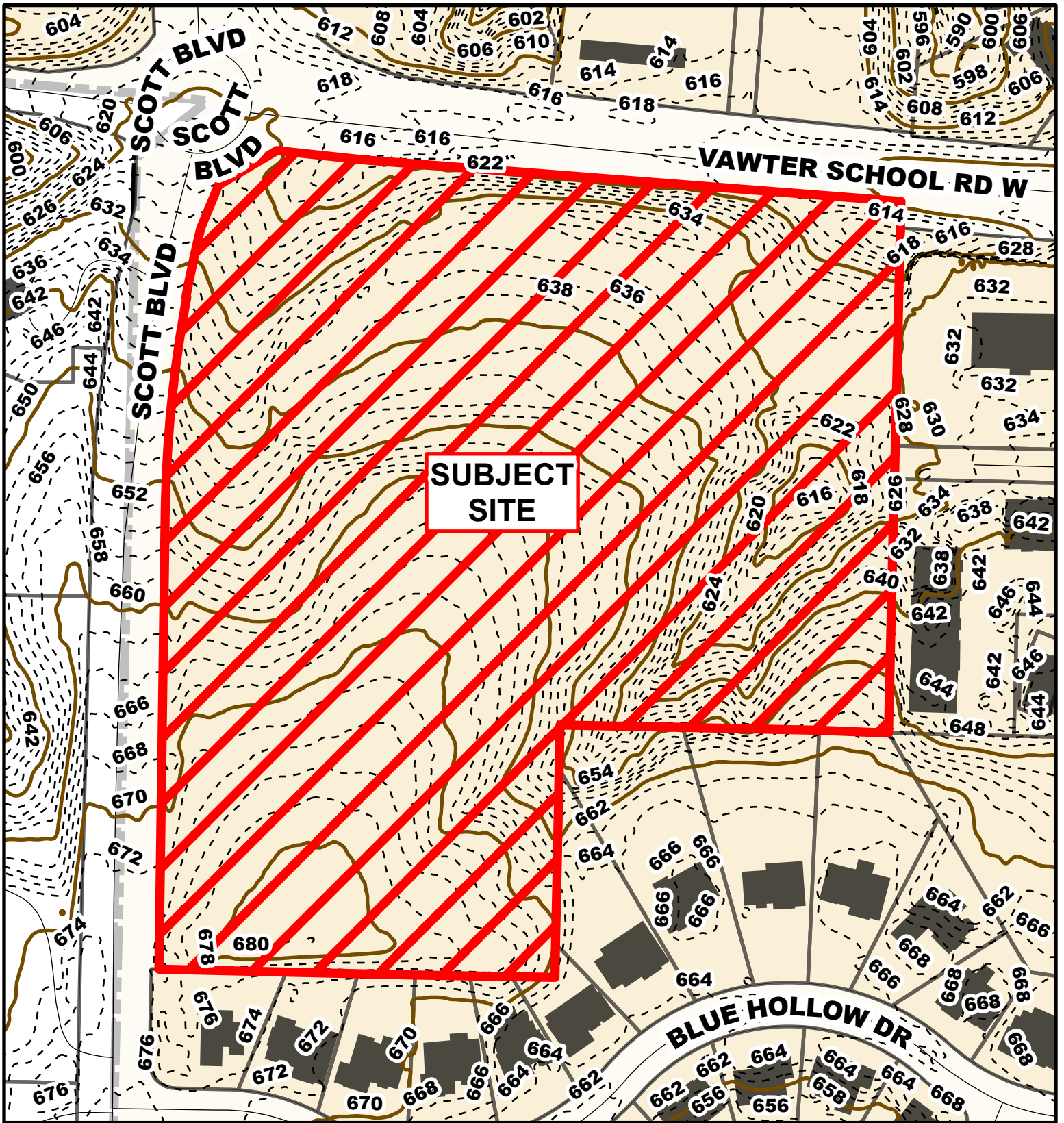

Case # 78-2024 - 4190 W. Vawter School Road

PD Plan & Design Exceptions



- 10 Foot Contour Lines
- - - 2 Foot Contour Lines
- City of Columbia
- Parcels

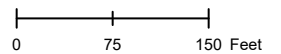

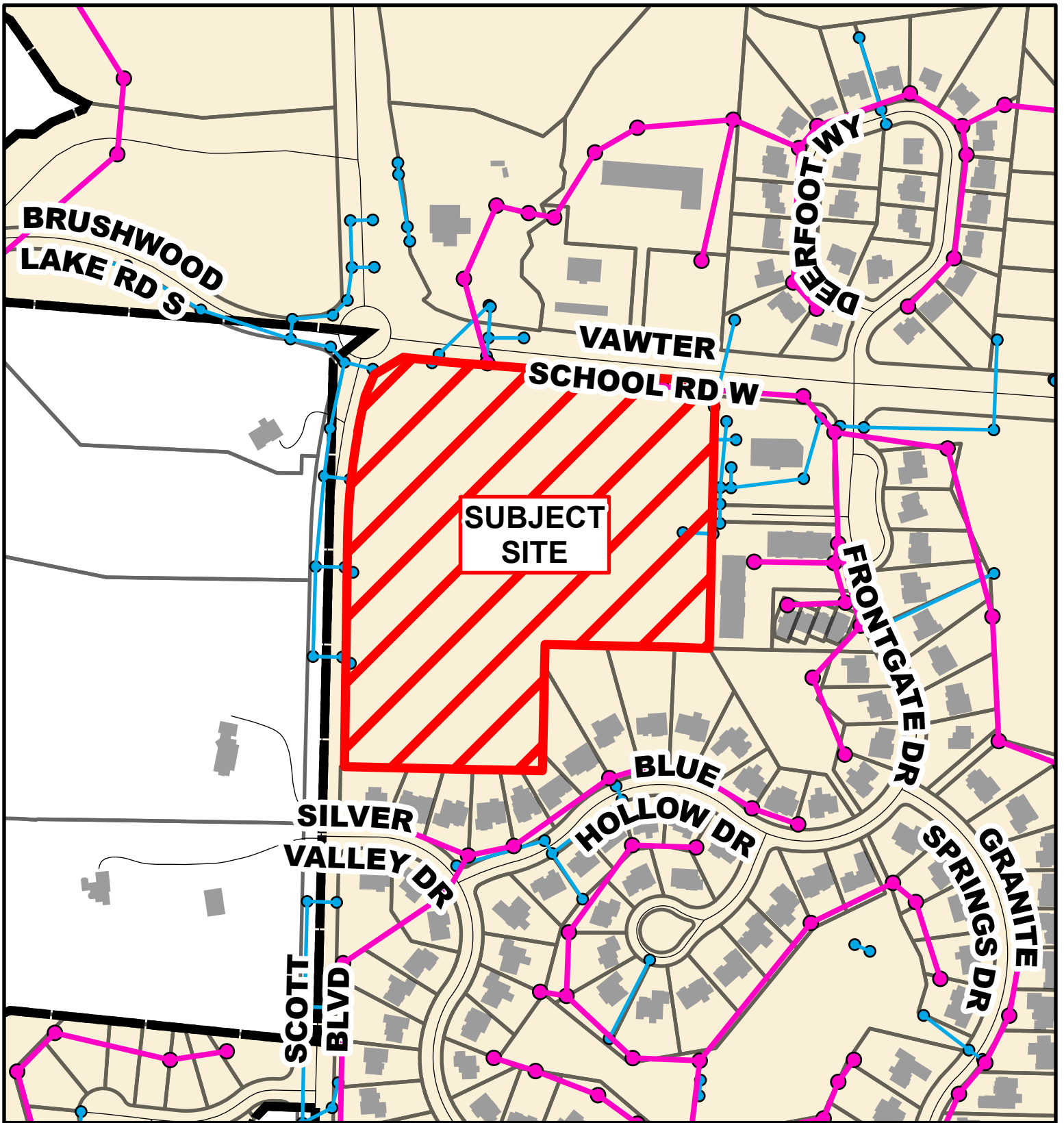

Case # 78-2024 - 4190 W. Vawter School Road
PD Plan & Design Exceptions



- City Sanitary Line
- City Storm Lines
- Parcels
- Columbia City Limits

