

#117-2020: Reliable Community Bancshares, Inc Annexation

 City Zoning	 Boone County Zoning
 Parcels	 Columbia City Limit

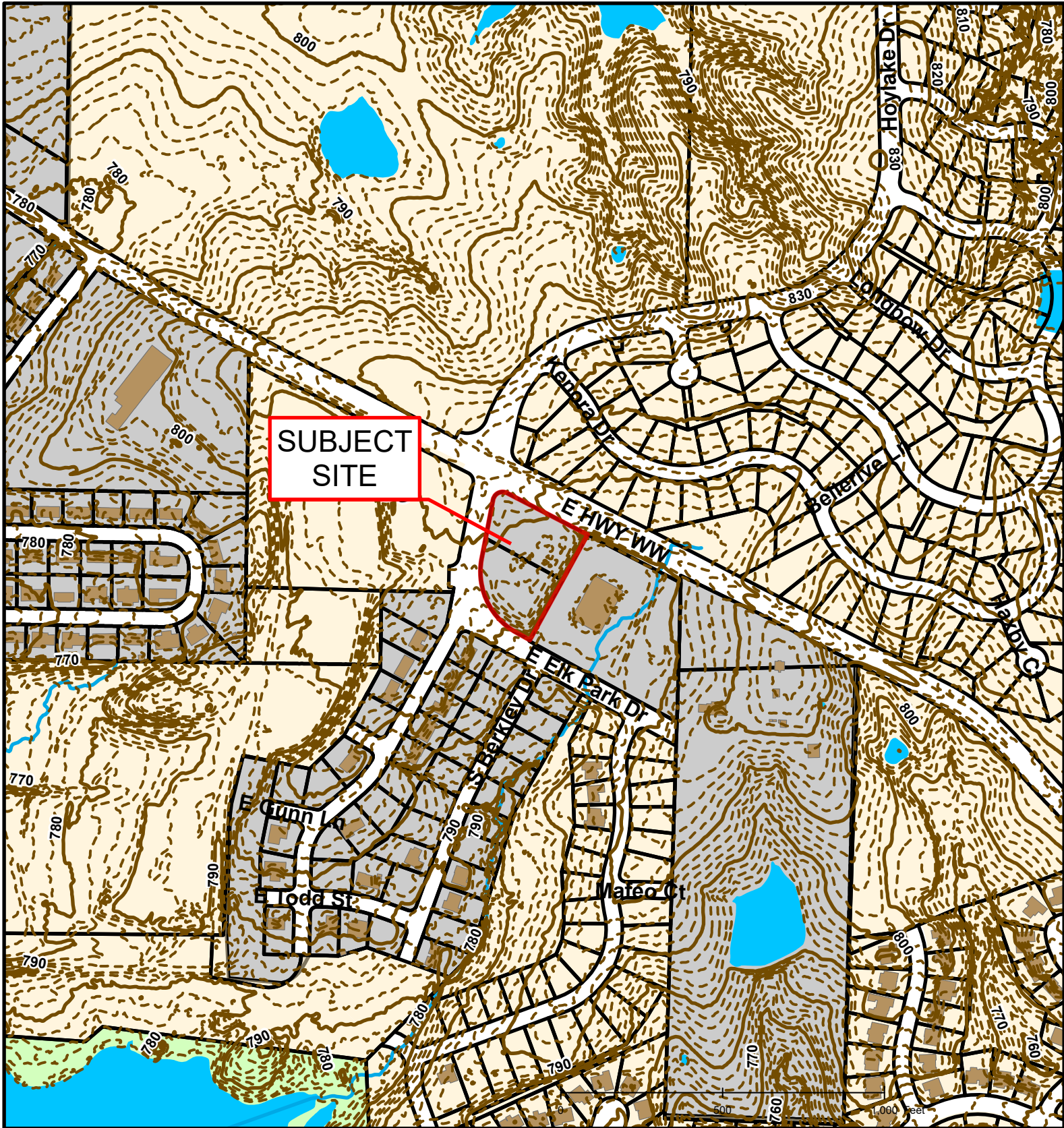



#117-2020: Reliable Community Bancshares, Inc Annexation



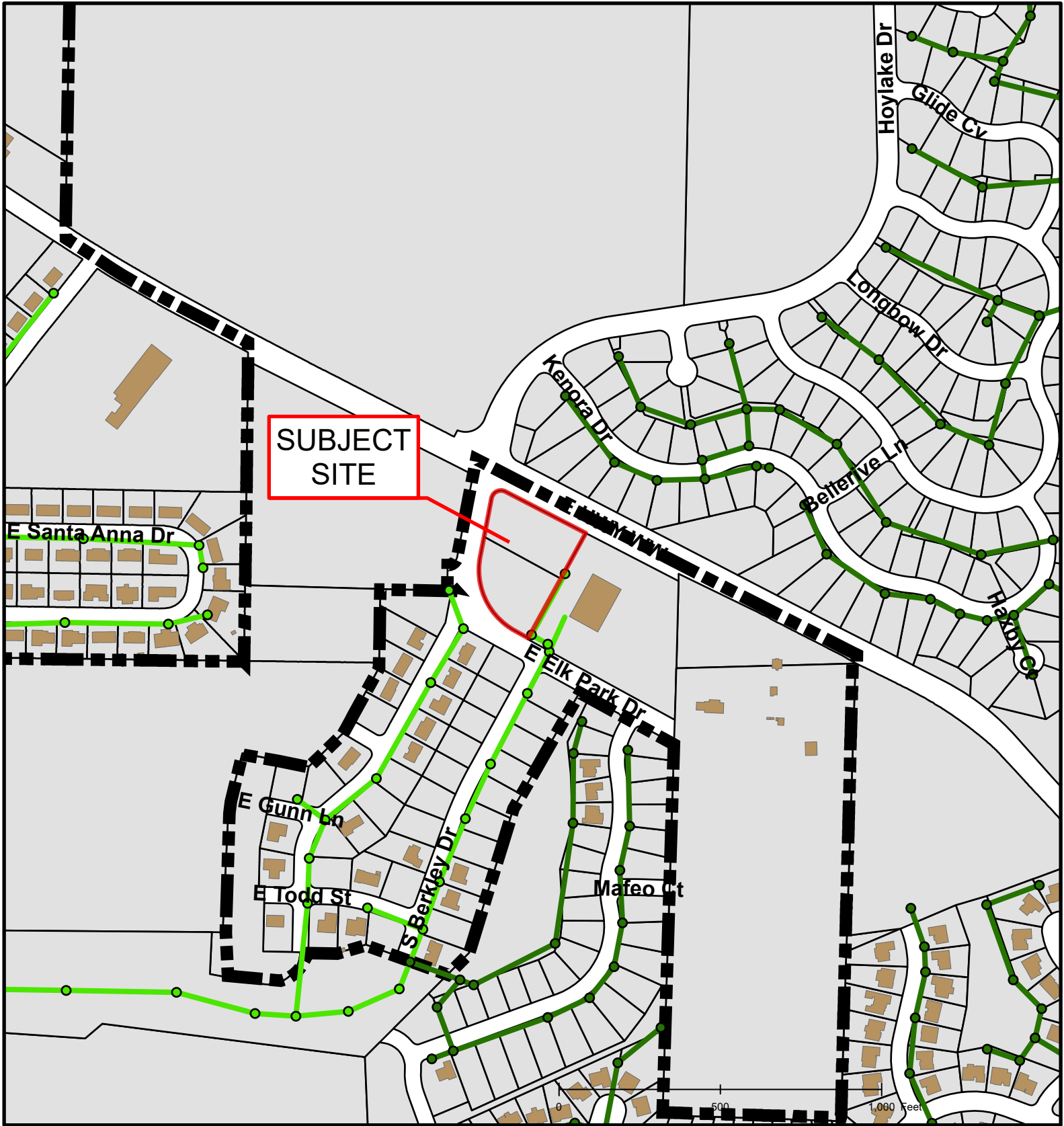

#117-2020: Reliable Community Bancshares, Inc Annexation

	BCRSD		City Sanitary Line		Building Footprint
	City Sanitary Structure		Columbia City Limit		Parcels
	BCRSD				



Created by The City of Columbia - Community Development Department

Parcel Data Source: Boone County Assessor

2017 Imagery: Boone County Assessor's Office

Hillshade Data: Boone County GIS