

# ROLLINS ROAD Calming Devices

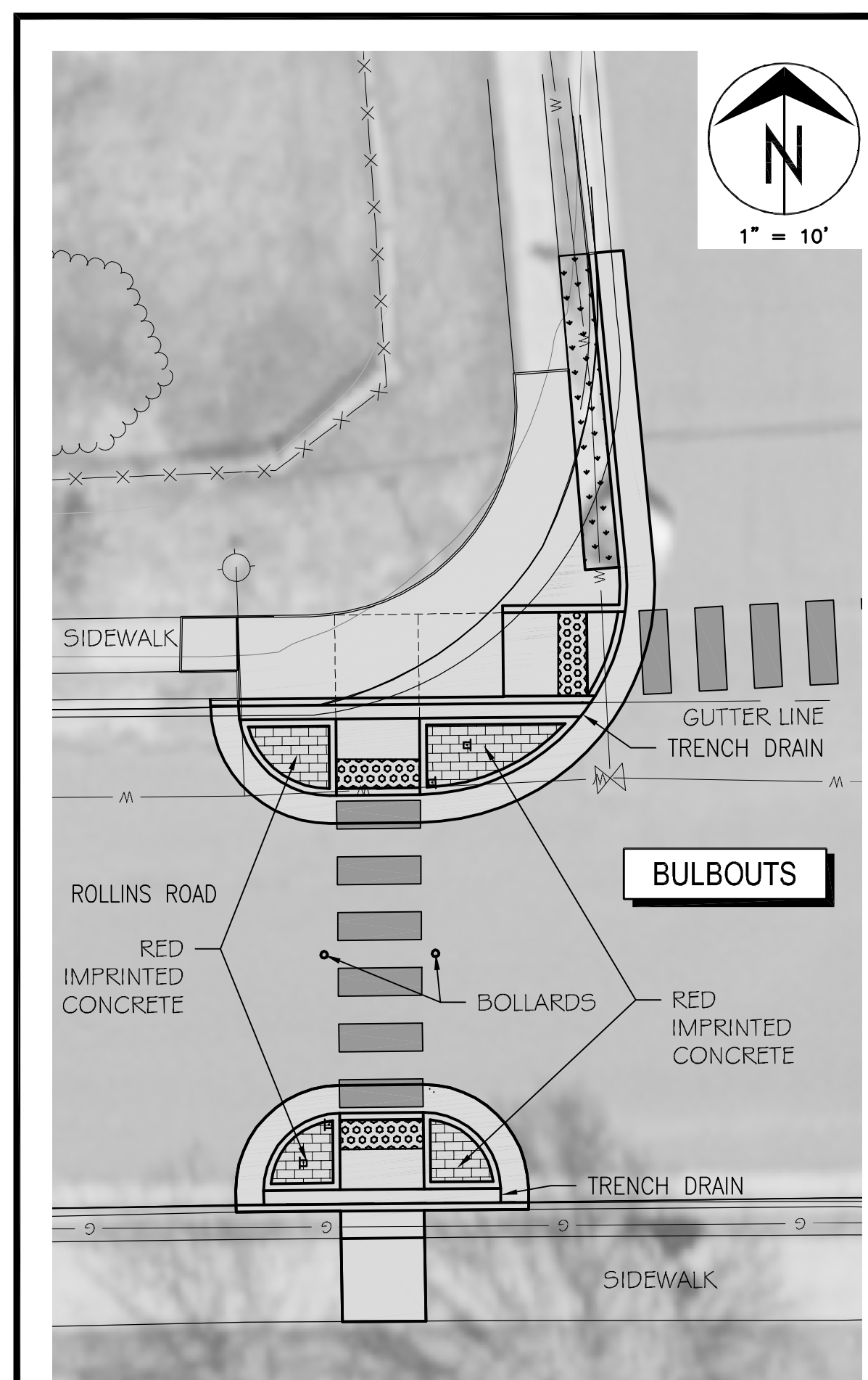
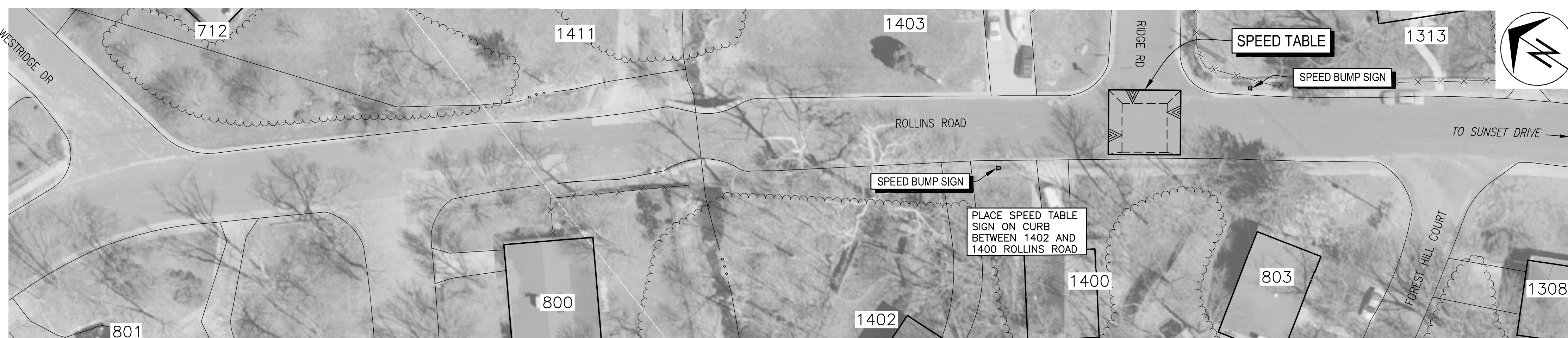
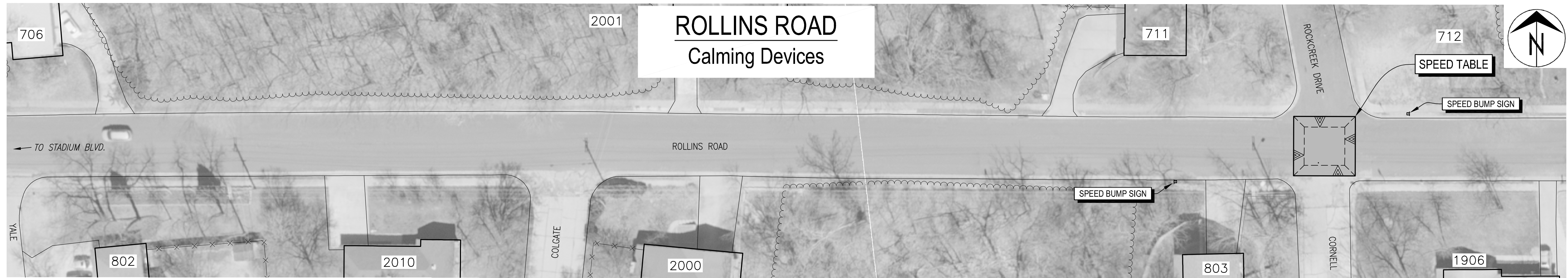

| Revision | By | Date | No. |
|----------|----|------|-----|
|          |    |      |     |
|          |    |      |     |
|          |    |      |     |
|          |    |      |     |

## ROLLINS ROAD TRAFFIC CALMING Calming Devices

City of Columbia, Missouri  
Department of Public Works

David Allen Nichols  
Registered Professional Engineer  
E-24212

File No. .  
Scale: 1" = 20'  
Date: 3/30/2018  
Des. D.G.W.  
Dwn. D.G.W.  
Chk. J.D.R.

c:\cadd\p\traffic\calming\rollins overview 2013.dwg

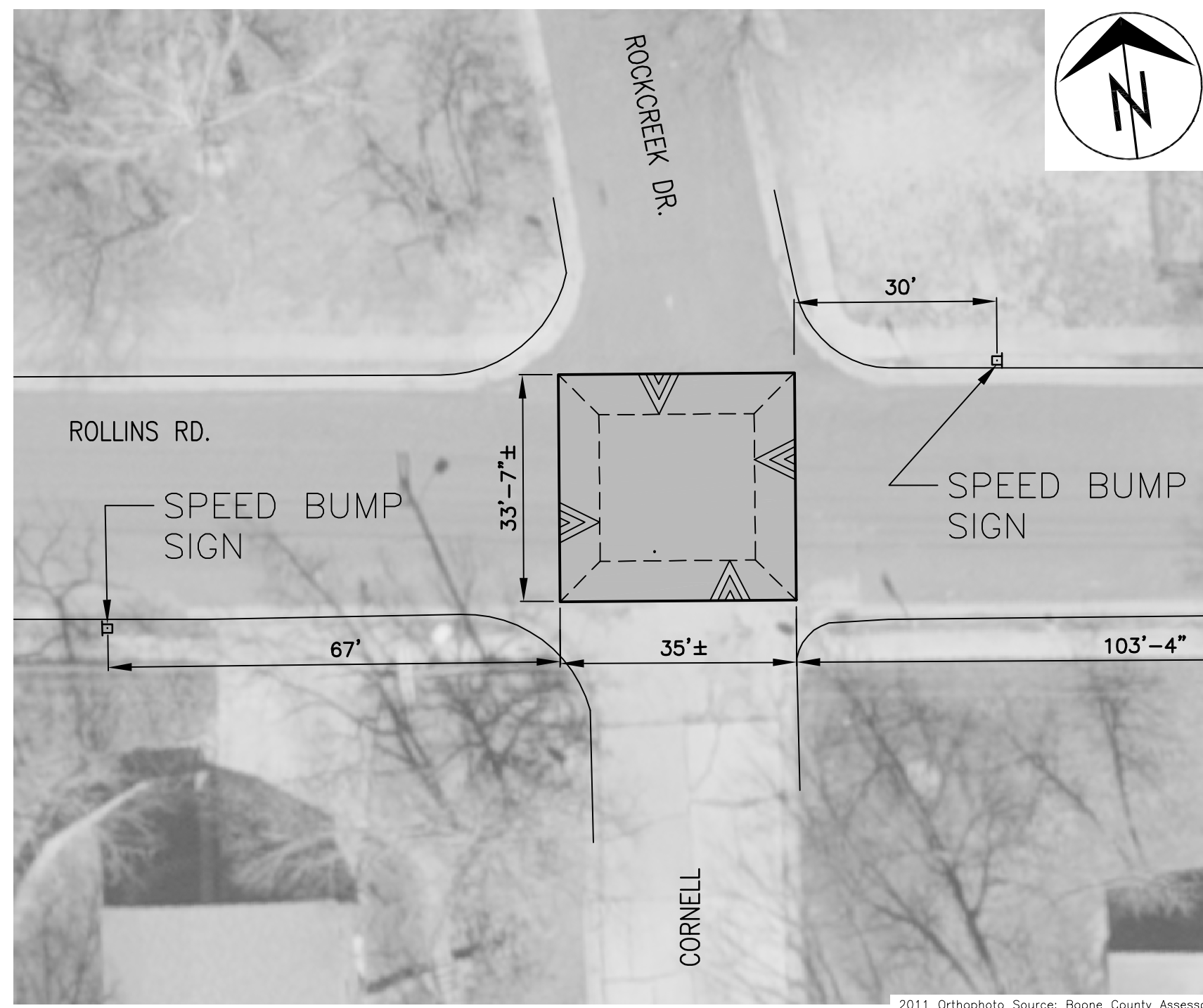

ROLLINS ROAD — ROCKCREEK DRIVE  
NOT TO SCALE

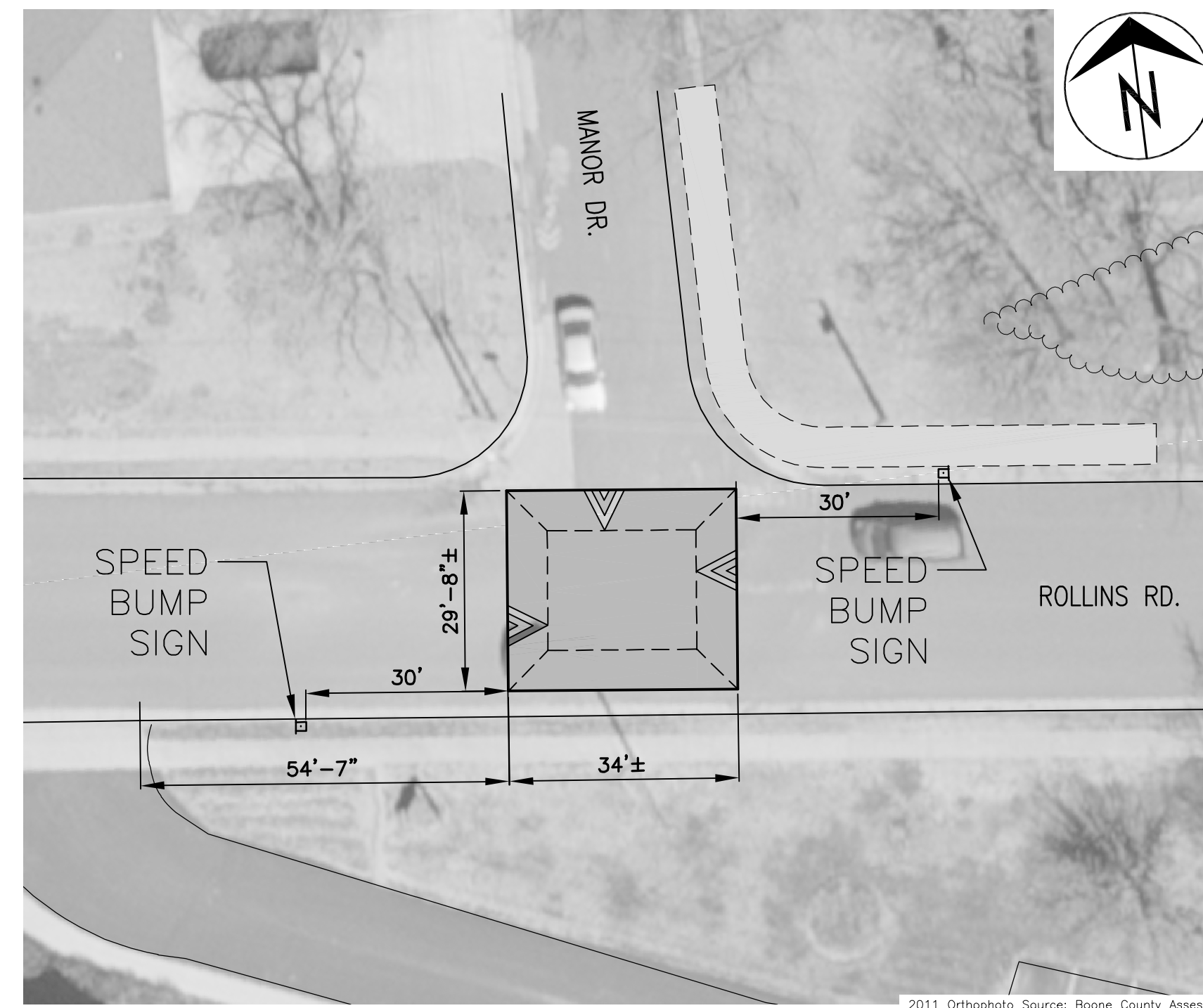

ROLLINS ROAD — MANOR DRIVE  
NOT TO SCALE



ROLLINS ROAD — RIDGE ROAD  
NOT TO SCALE

| Existing Street Width<br>(Back of Curb<br>to Back of Curb) | A     |
|--|-------|
| 38' & wider  | 5'-3" |
| between 32' & 38'  | 3'-9" |
| 32' & narrower   | 3'-2" |

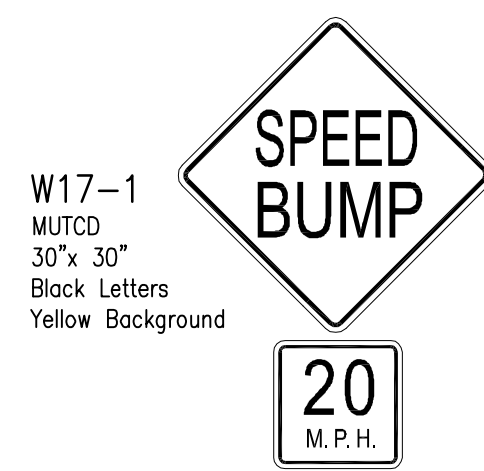

PLACED APPROX. 100'  
BEFORE TABLE OR AS  
DIRECTED BY INSPECTOR.

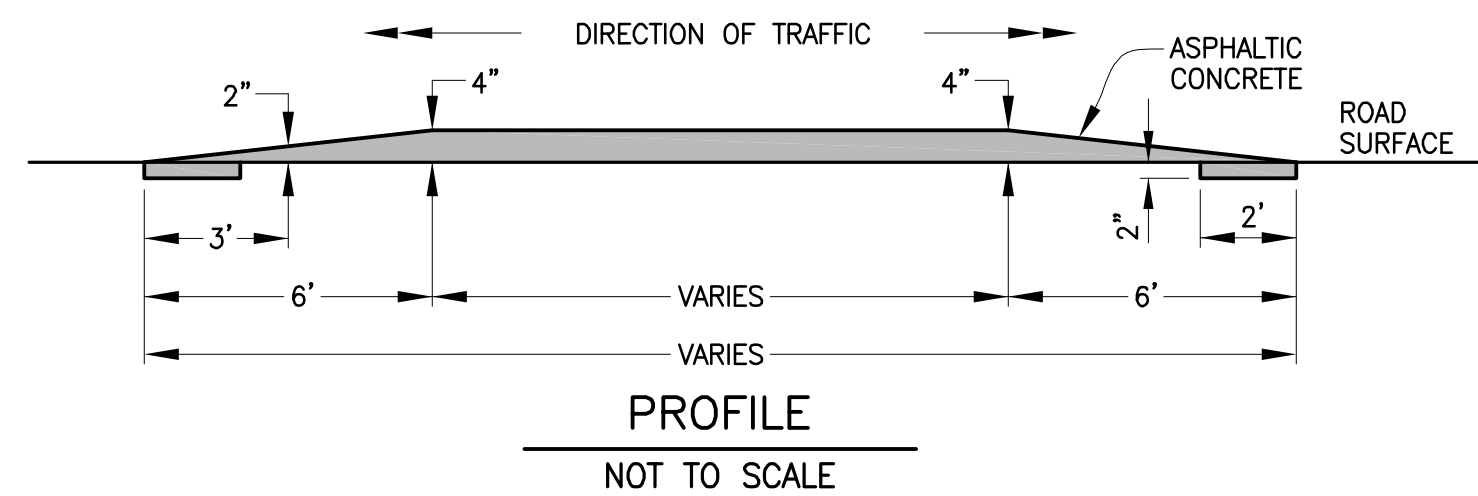
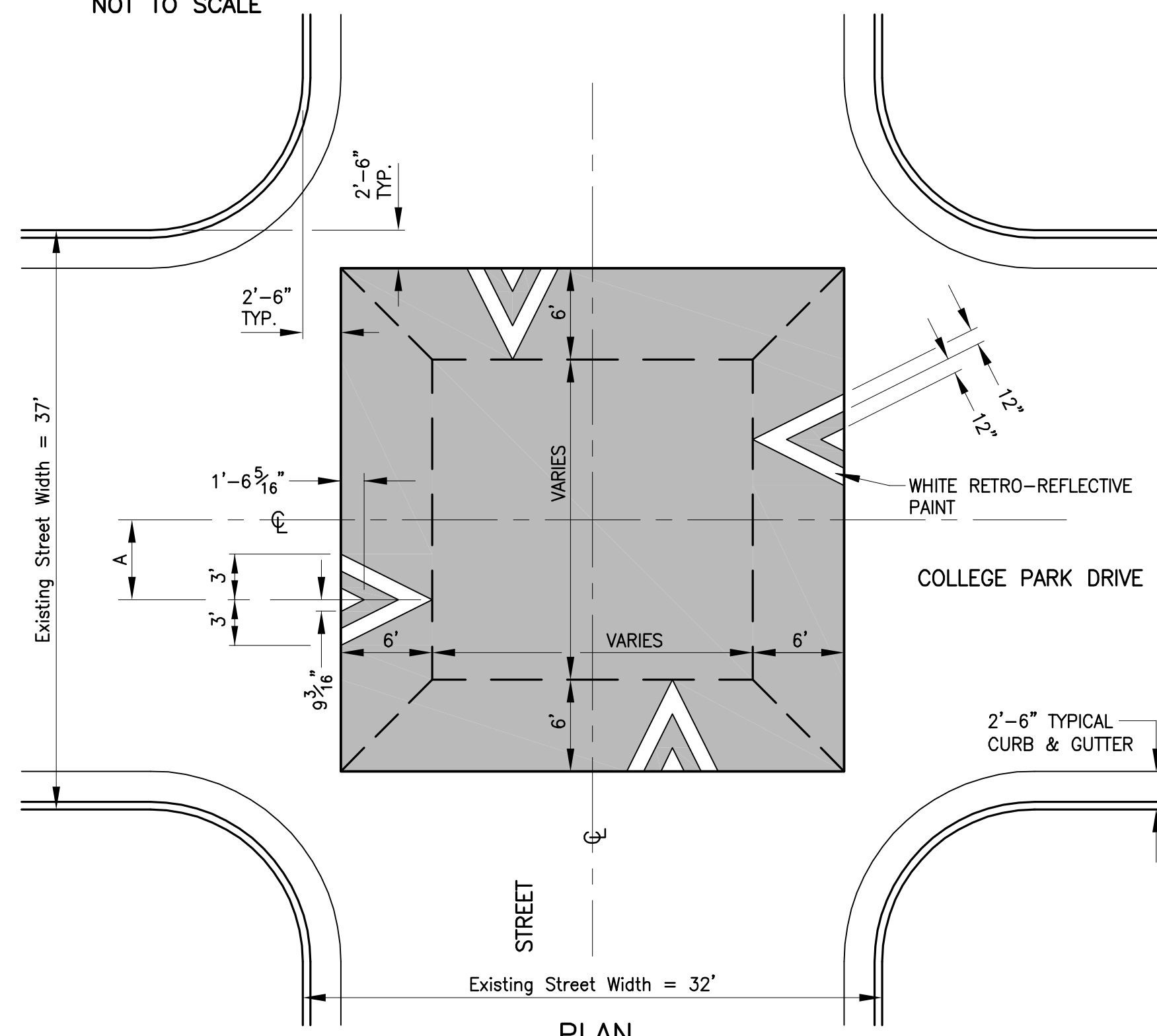

SPEED TABLE

| Existing Street Width<br>(Back of Curb<br>to Back of Curb) | A     |
|--|-------|
| 38' & wider  | 5'-3" |
| between 32' & 38'  | 3'-9" |
| 32' & narrower   | 3'-2" |

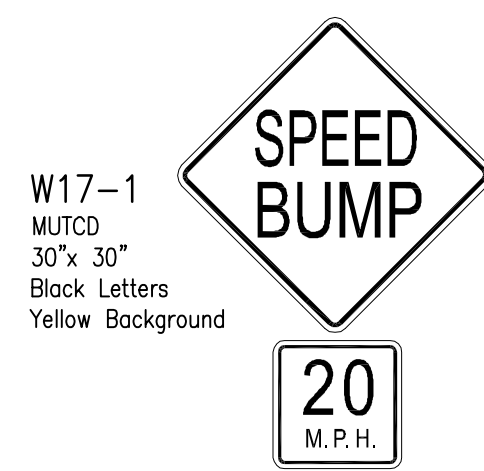

PLACED APPROX. 100'  
BEFORE TABLE OR AS  
DIRECTED BY INSPECTOR.

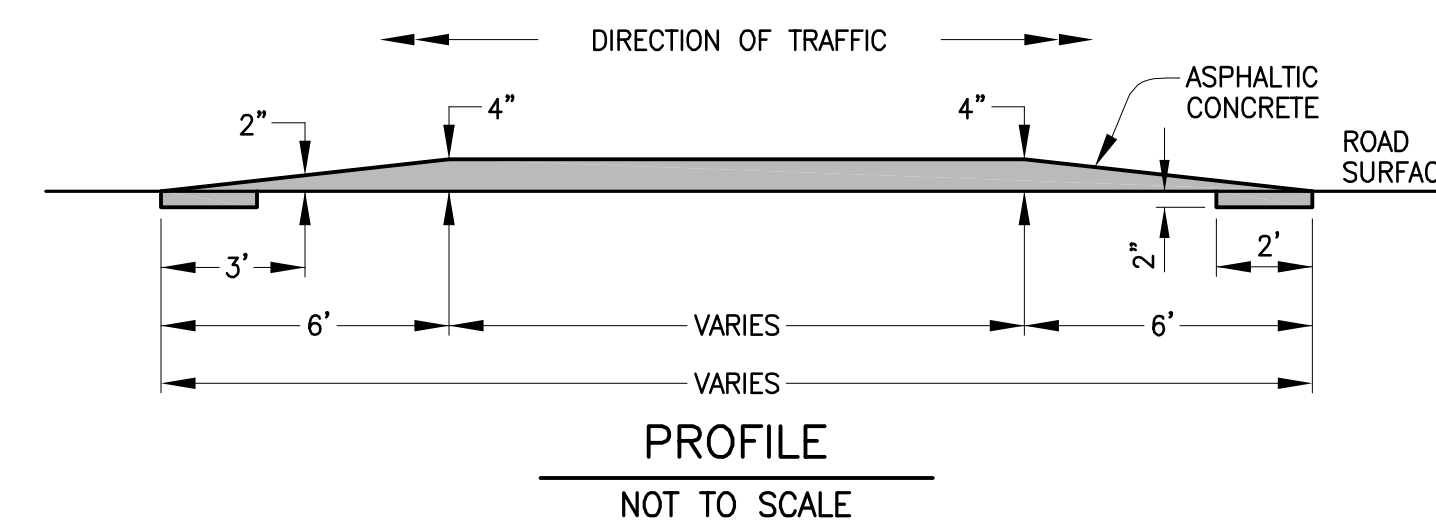
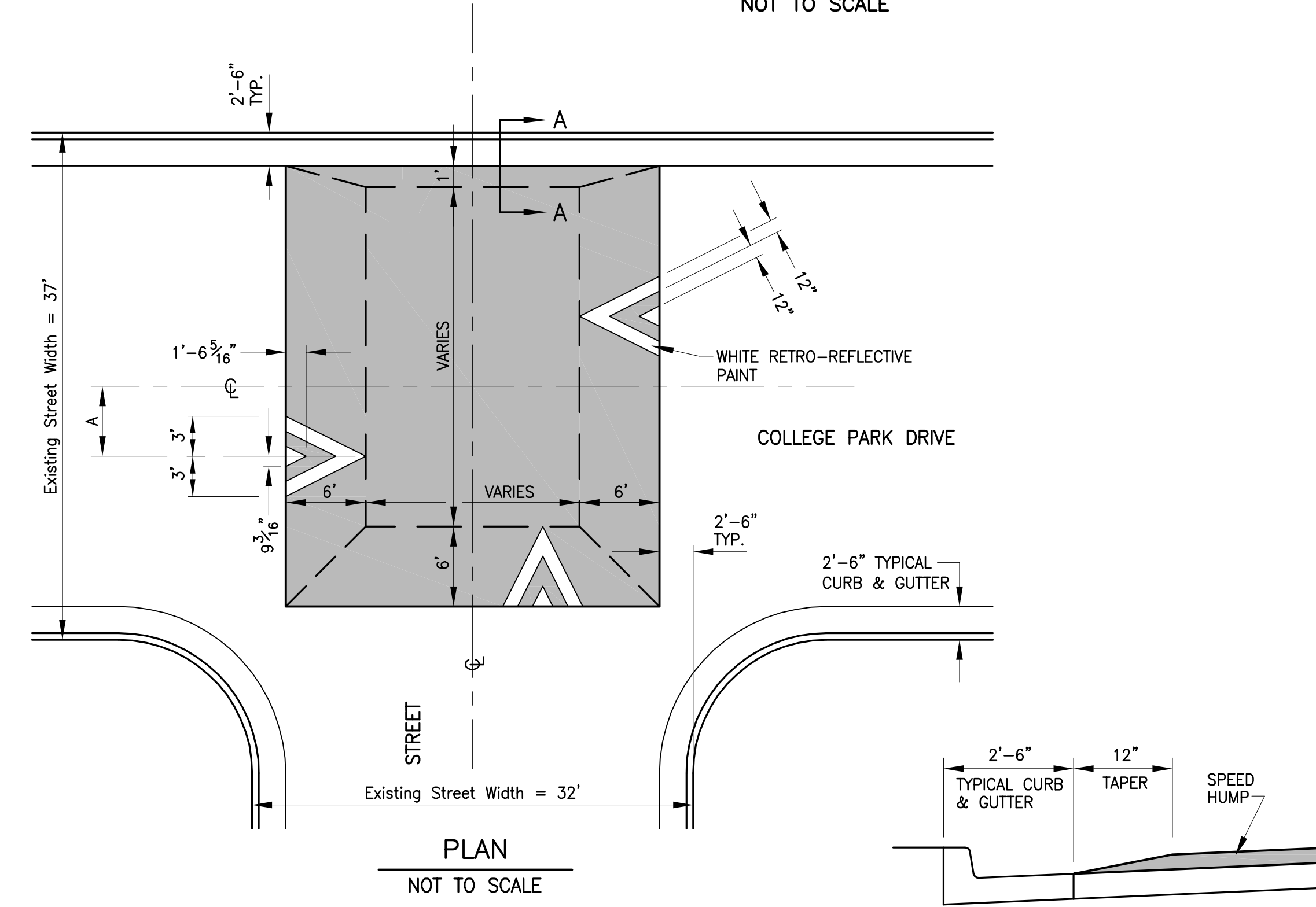

SPEED TABLE — T-INTERSECTION

| No. | Date | By | Revision |
|-----|------|----|----------|
|     |      |    |          |
|     |      |    |          |
|     |      |    |          |

# ROLLINS ROAD TRAFFIC CALMING

Speed Tables

City of Columbia, Missouri

Department of Public Works



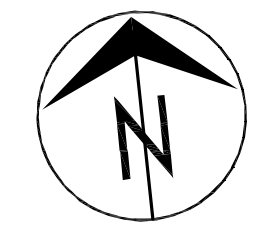
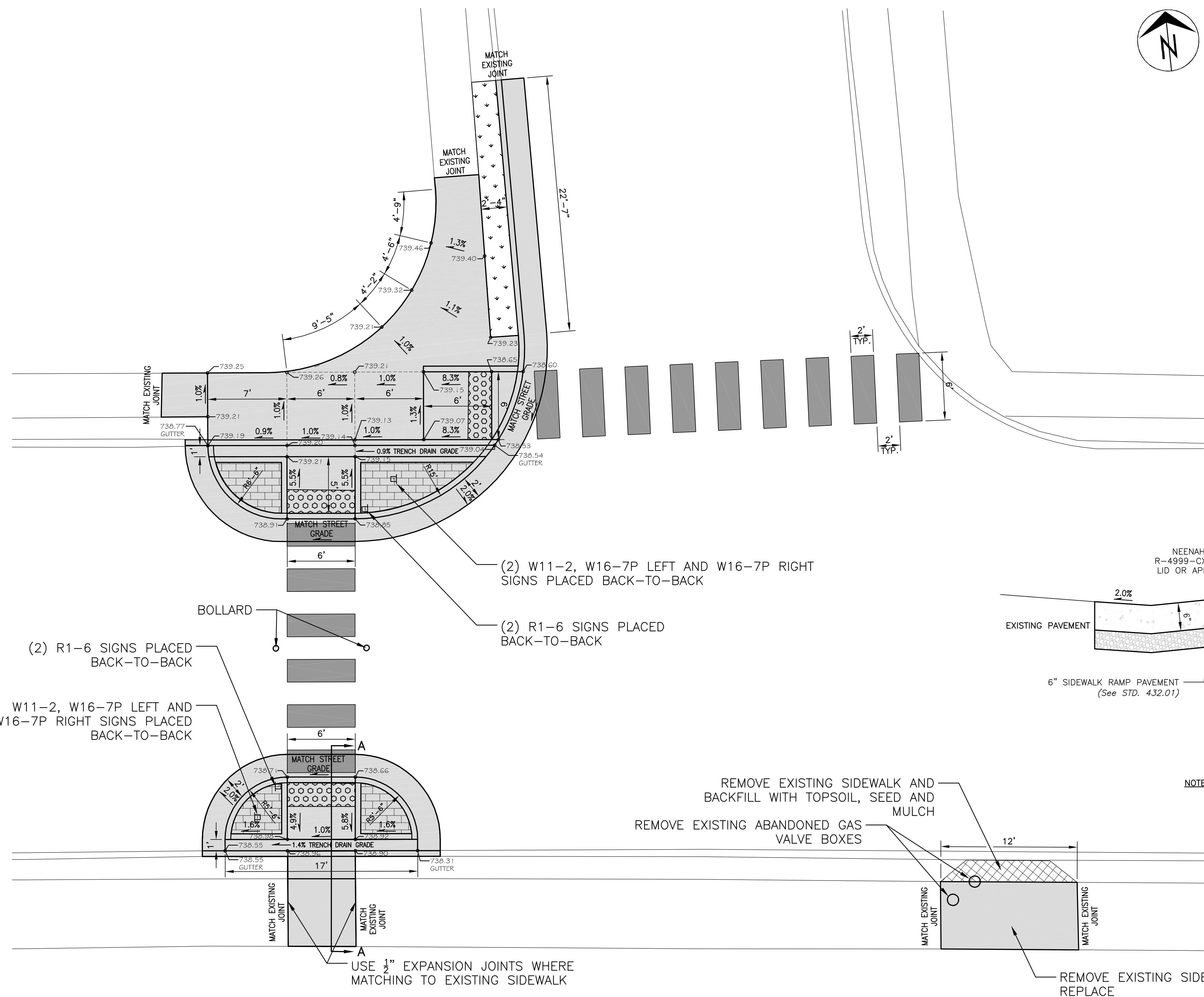

David Allen Nichols  
Registered Professional  
Engineer  
E-24212

|          |           |
|----------|-----------|
| File No. |           |
| Scale:   | 1" = 20'  |
| Date:    | 3/30/2018 |
| Des.     | D.G.W.    |
| Dwn.     | D.G.W.    |
| Chk.     | J.D.R.    |

c:\cadd\proj\traffic\calming\rollins\_avenue\overview\_2013.dwg



**SIGN LEGEND**

-  W11-2 FYG
-  W16-7P FYG (LEFT)
-  W11-2 FYG
-  W16-7P FYG (RIGHT)
-  R1-6 FYG

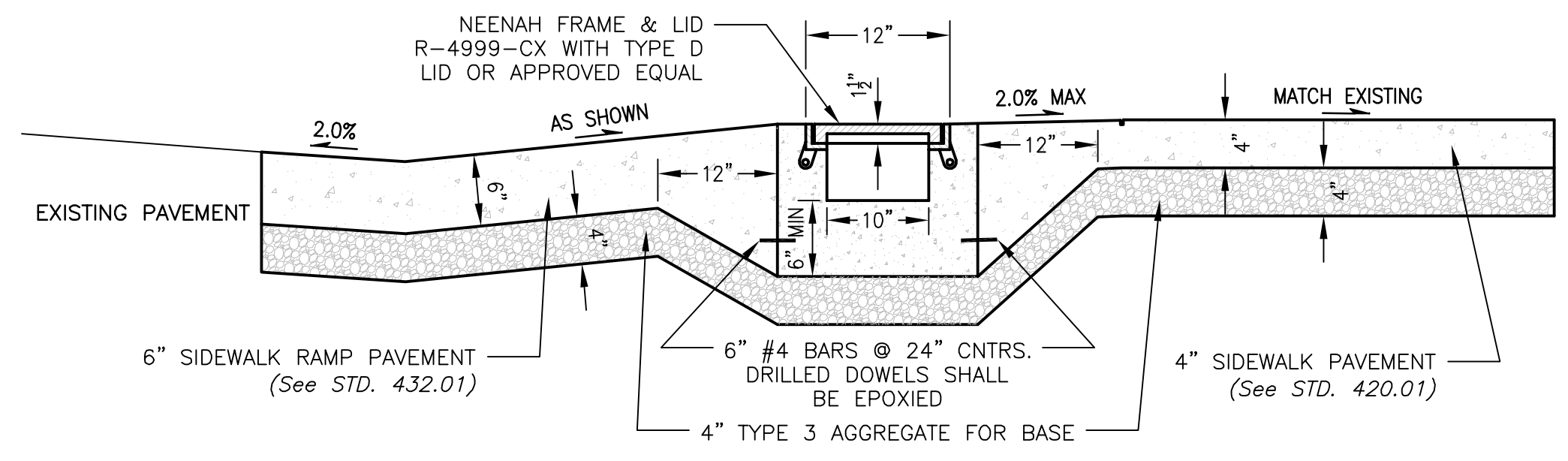

**SECTION A-A**  
NOT TO SCALE

NOTE: BOTH BULBOUTS SHALL BE CONSTRUCTED IN SIMILAR FASHION

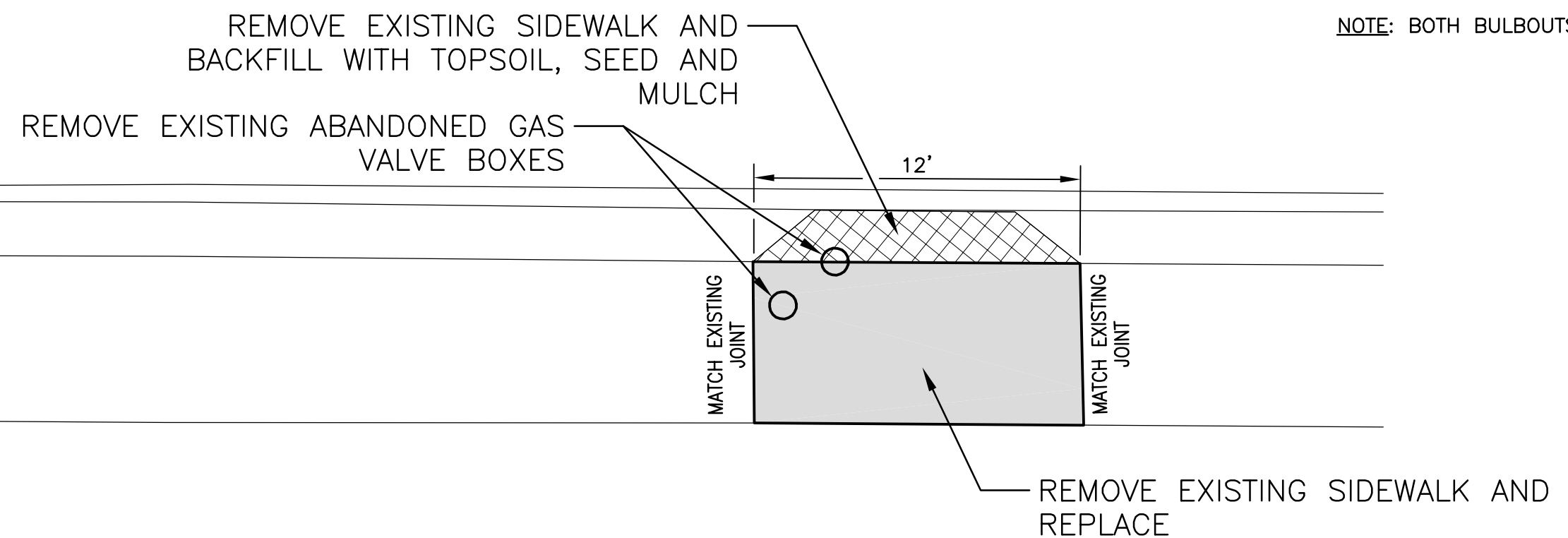

- (2) W11-2, W16-7P LEFT AND W16-7P RIGHT SIGNS PLACED BACK-TO-BACK
- (2) R1-6 SIGNS PLACED BACK-TO-BACK
- (2) R1-6 SIGNS PLACED BACK-TO-BACK
- (2) W11-2, W16-7P LEFT AND W16-7P RIGHT SIGNS PLACED BACK-TO-BACK
- (2) R1-6 SIGNS PLACED BACK-TO-BACK

USE 1/2" EXPANSION JOINTS WHERE MATCHING TO EXISTING SIDEWALK

**BULBOUTS**  
**ROLLINS ROAD AND RUSSELL AVENUE**  
1"=5'

| Revision | By | Date | No. |
|----------|----|------|-----|
|          |    |      |     |
|          |    |      |     |
|          |    |      |     |

**ROLLINS ROAD TRAFFIC CALMING**  
Bulbouts and Crosswalk Signing and Marking

City of Columbia, Missouri  
Department of Public Works

David Allen Nichols  
Registered Professional Engineer  
E-24212

File No. .  
Scale: 1" = 20'  
Date: 3/30/2018  
Des. D.G.W.  
Dwn. D.G.W.  
Chk. J.D.R.

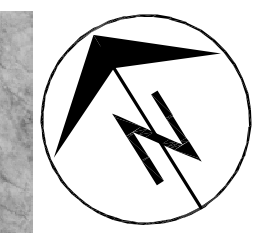
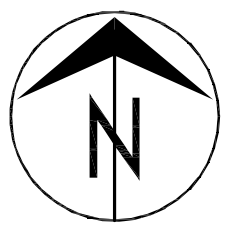

| No. | Date | By | Revision |
|-----|------|----|----------|
|     |      |    |          |
|     |      |    |          |
|     |      |    |          |

# ROLLINS ROAD TRAFFIC CALMING

Traffic Control Plan Sheet

City of Columbia, Missouri  
Department of Public Works

David Allen Nichols  
Registered Professional Engineer  
E-24212

File No. \_\_\_\_\_  
Scale: 1" = 100'  
Date: 3/30/2018  
Des. D.G.W.  
Dwn. D.G.W.  
Chk. J.D.R.

**TRAFFIC CONTROL NOTES:**

1. IT IS THE RESPONSIBILITY OF THE CONTRACTOR TO INSURE THAT ALL BARRICADES, SIGNS, OTHER TRAFFIC CONTROL DEVICES AND PLACEMENT THEREOF SHALL CONFORM TO THE CURRENT EDITION OF THE MANUAL ON UNIFORM TRAFFIC CONTROL DEVICES (MUTCD).
2. THE CONTRACTOR SHALL NOTIFY THE CITY JOINT COMMUNICATIONS OFFICE OF ALL ROAD CLOSURES OR LANE REDUCTIONS IN ADVANCE. JOINT COMMUNICATIONS PHONE NUMBER IS 874-7400.
3. TRAFFIC CONTROL DEVICES TO BE IN PLACE PRIOR TO BEGINNING CONSTRUCTION. ACTUAL QUANTITIES WILL DEPEND ON THE CONTRACTOR'S CONSTRUCTION SEQUENCE AND PROGRESS. NO MEASUREMENT WILL BE MADE OF ACTUAL QUANTITIES. QUANTITIES SHOWN ARE APPROXIMATE.
4. CONTRACTOR SHALL MAINTAIN ACCESS TO ALL PROPERTIES IN THE CONSTRUCTION ZONE TO THE MAXIMUM EXTENT PRACTICABLE.
5. WARNING LIGHTS SHALL FLASH WHEN PLACED ON CHANNELIZING DEVICES USED ALONE OR IN A CLUSTER TO WARN OF A CONDITION. THESE SHALL BE TYPE B.
6. WARNING LIGHTS PLACED ON CHANNELIZING DEVICES USED IN A SERIES TO CHANNELIZE ROAD USERS SHALL BE STEADY-BURN. THESE SHALL BE TYPE C.

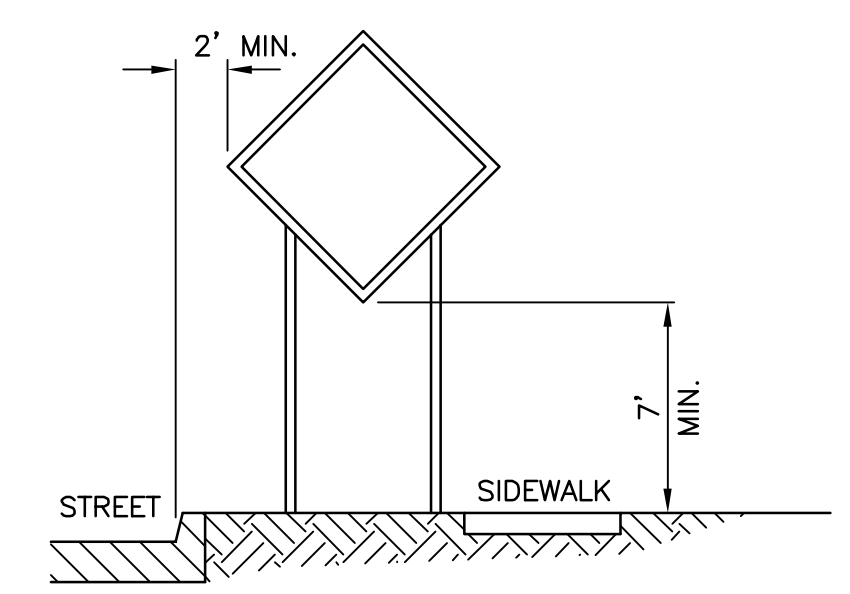

NOTE: SUPPORT POSTS SHALL NOT EXTEND ABOVE SIGN UNLESS DISTANCE PLAQUE OR WARNING LIGHTS ARE SPECIFIED.

SIGN MOUNTING

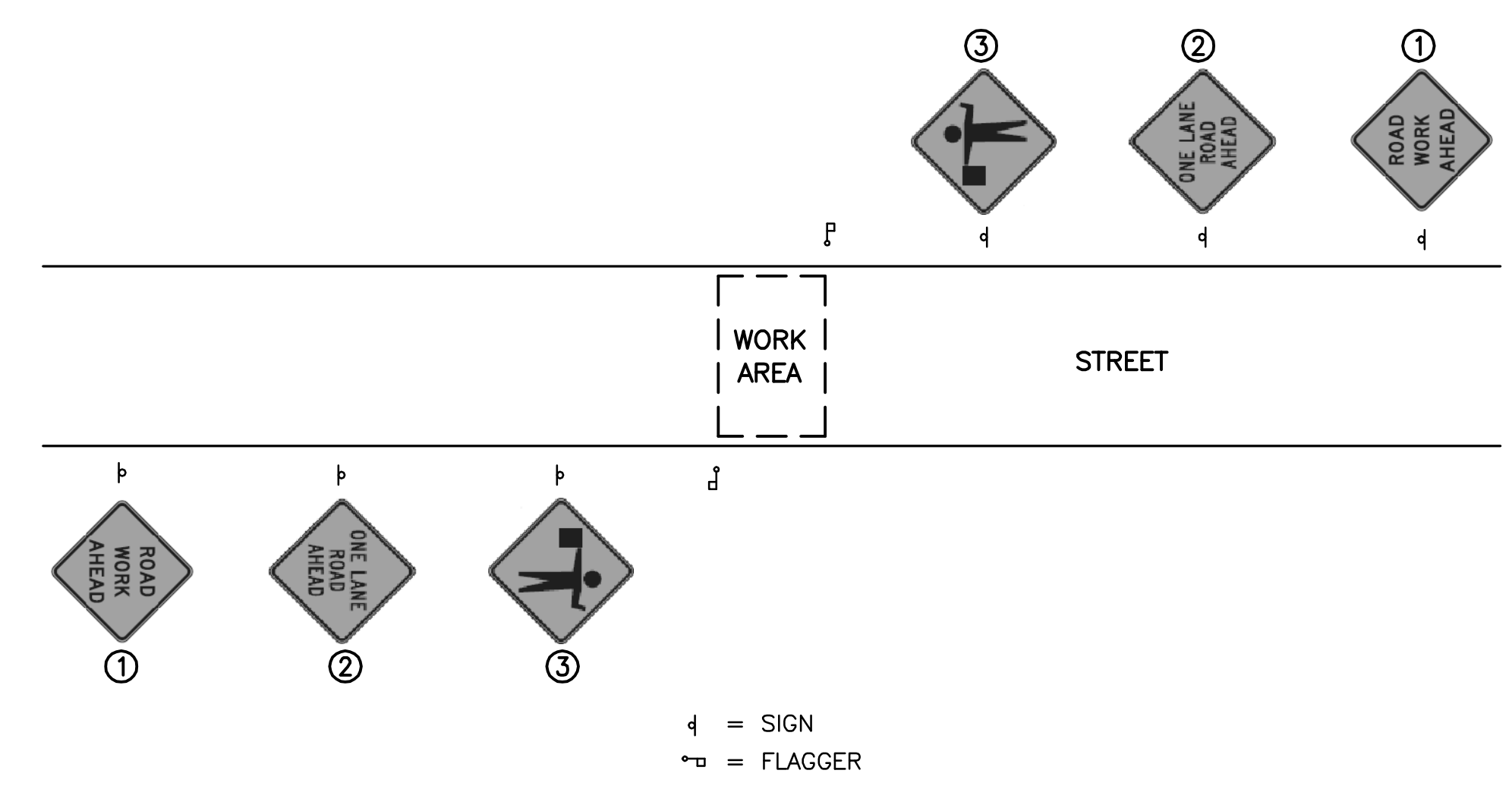

TYPICAL TEMPORARY TRAFFIC CONTROL FOR LANE DROP  
NOT TO SCALE

| TRAFFIC CONTROL |                       |           |        |
|-----------------|-----------------------|-----------|--------|
| MUTCD CODE      | SIGN                  | SIZE      | QUANT. |
| ① W20-1         | "ROAD WORK AHEAD"     | 36" x 36" | 2      |
| ② W20-4         | "ONE LANE ROAD AHEAD" | 36" x 36" | 2      |
| ③ W20-7A        | FLAGGER (SYMBOL)      | 36" x 36" | 2      |