

# #154-2020: City of Columbia Corrective C-2 Rezoning (909 Lowry Mall)

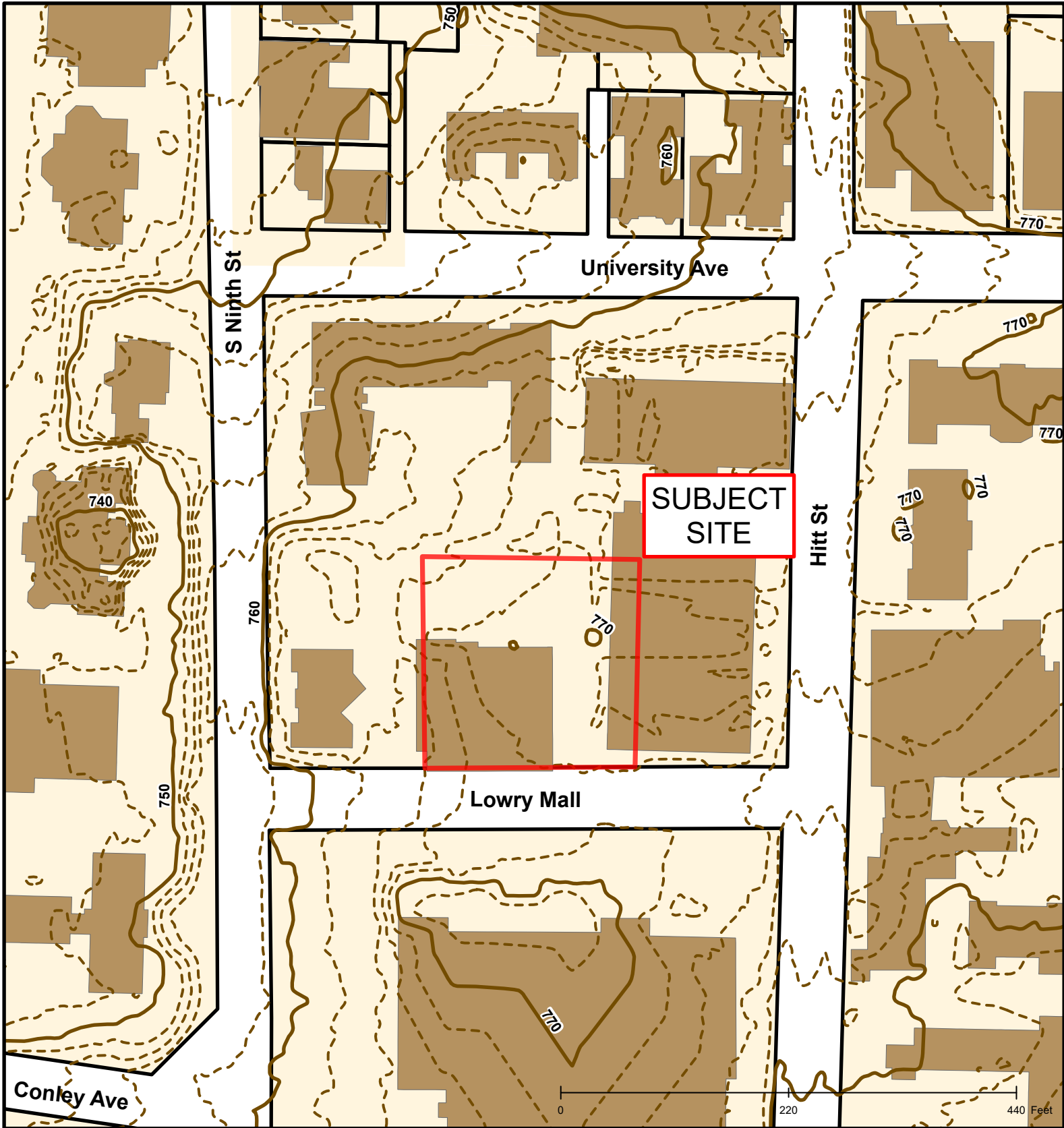





## #154-2020: City of Columbia Corrective C-2 Rezoning (909 Lowry Mall)

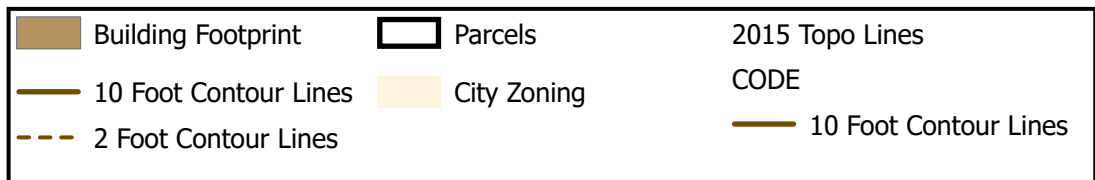

Created by The City of Columbia - Community Development Department

Parcel Data Source: Boone County Assessor

2017 Imagery: Boone County Assessor's Office

Hillshade Data: Boone County GIS

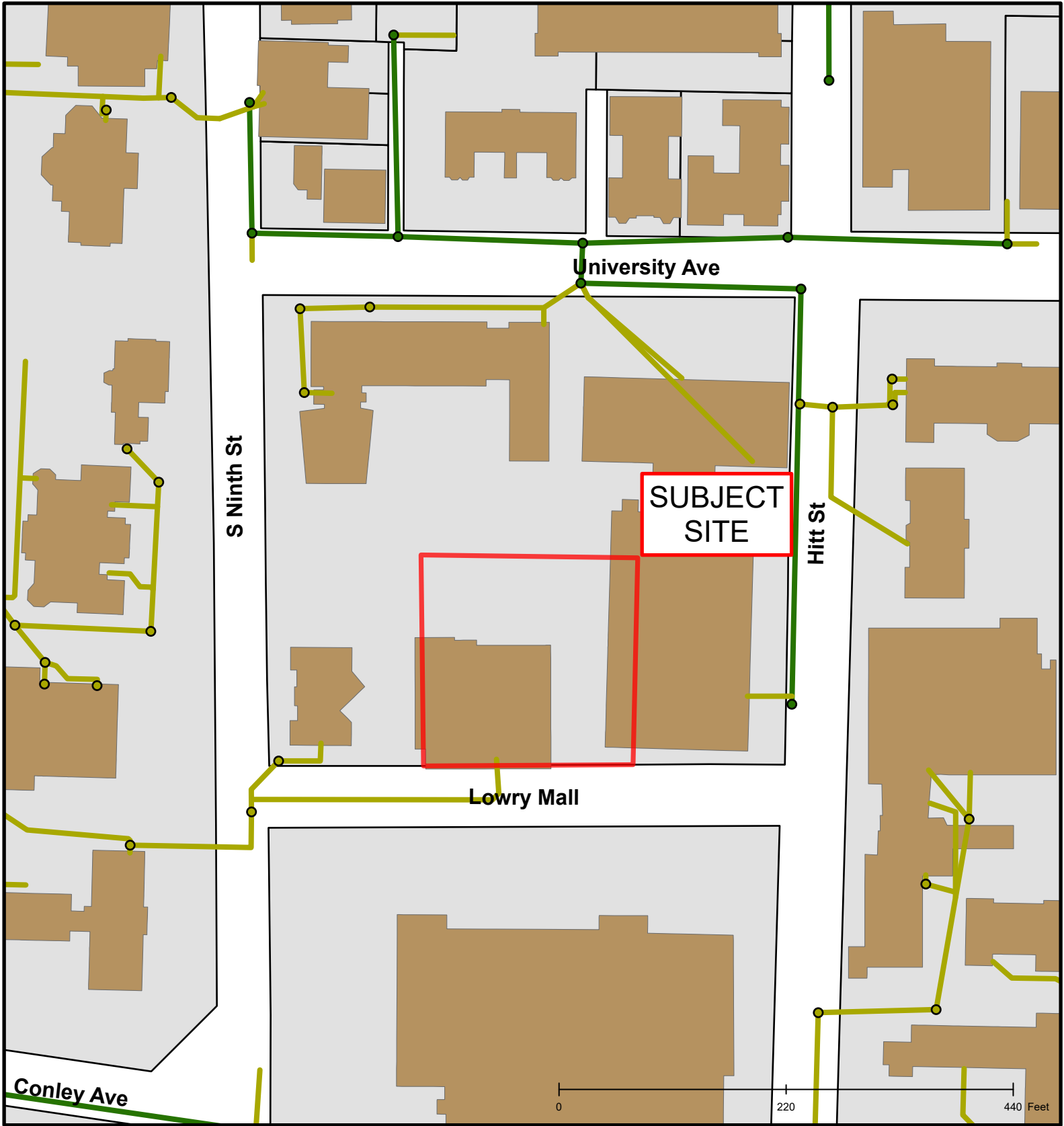

## #154-2020: City of Columbia Corrective C-2 Rezoning (909 Lowry Mall)

