

CONCEPTUAL SITE PLAN 5.9

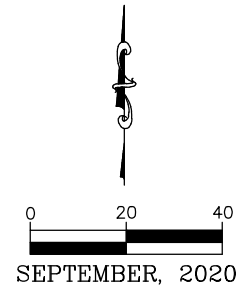
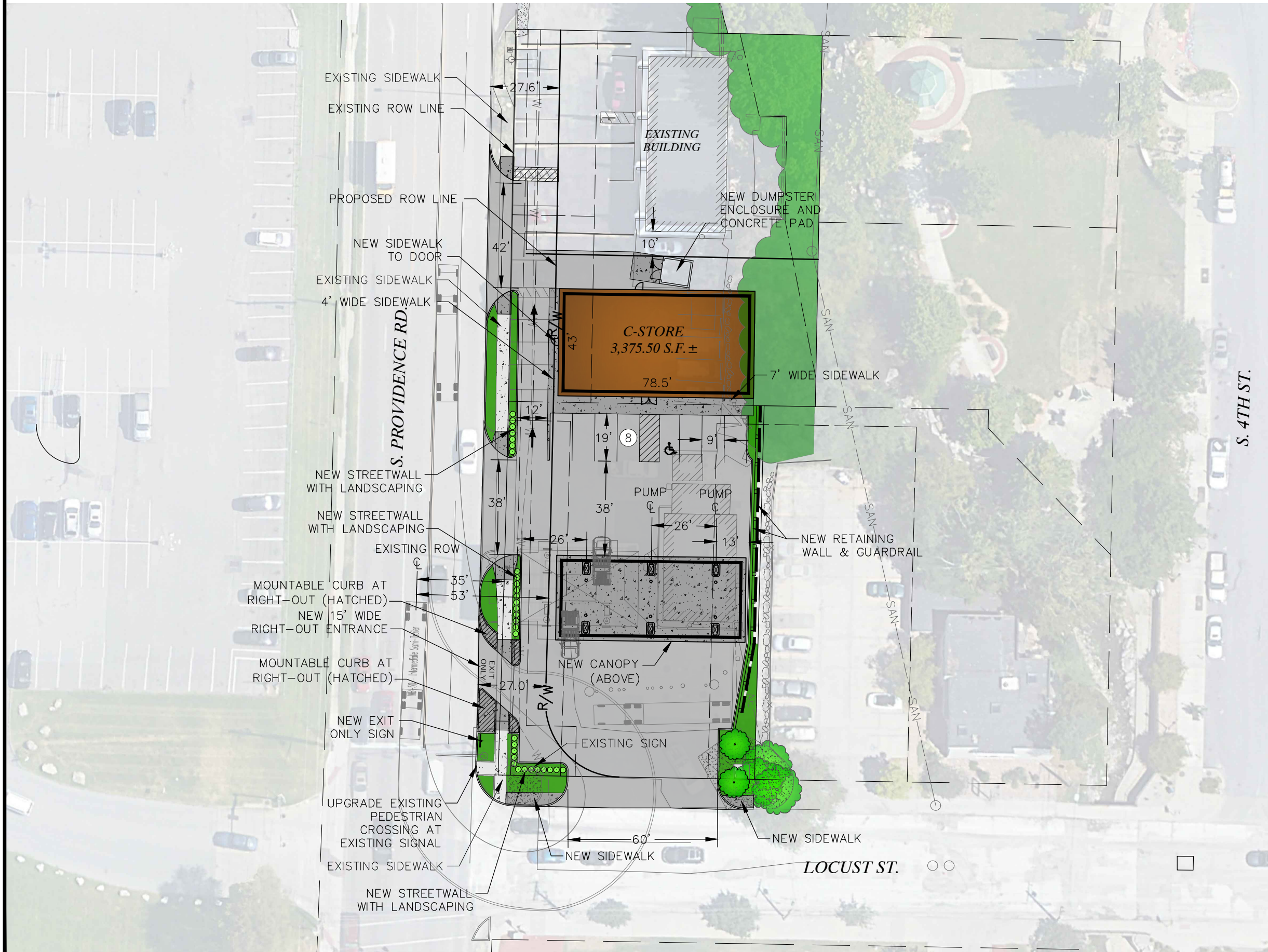

SITE DATA

NEW BUILDING	3,375.50 S.F. ±
NEW PARKING	8 SPACES
SITE	0.50 AC. ±
ZONED:	M-DT (MIXED USE-DOWNTOWN)
SETBACKS:	FRONT: 0' SIDE: 0' REAR: 0'

636-564-0540 (tel.)
636-564-0512 (fax)
malleochraneng.com

COCHRAN

- Civil Engineering
- Land Surveying
- Architecture
- Site Development
- General Consulting
- Master Planning

530A E. Independence Dr.
Union, Missouri 65084

Missouri State Certificate of Authority Numbers:
Survey : 000380
Engineering : 001655
Architecture : 2002014240

Three working days prior to the start of construction on this site, the contractor shall call 1-800-DIG-RIPE for utility location information.

All OSHA rules & regulations established for the type of construction required by these plans shall be strictly followed (e.g. trenching, blasting, etc.).

SITE IMPROVEMENTS

ZX STORE #94

COLUMBIA, MISSOURI

CONCEPTUAL SITE PLAN 5.9

DATE:	DATE:
REVISED:	REVISED:
DWN. BY:	APPR. BY:
JMM	JDF
DATE:	DATE:
SEP. 18, 2020	SEP. 18, 2020
SCALE:	SCALE:
1" = 40'	1" = 40'
PROJ. NO.:	PROJ. NO.:
19-7981	19-7981
DWG. NO.:	DWG. NO.:

5.9