

Hendren Hills Subdivison

A Minor Plat

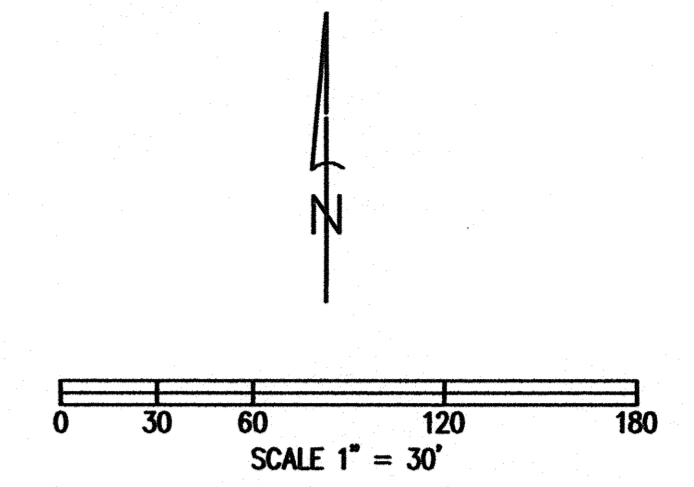

- LEGEND**
- O IRON PIPE
 - REBAR
 - S SET
 - OVERHEAD ELECTRIC LINE

A tract of land in the northeast 1/4 of Section 2, Township 48 North, Range 13 West, City of Columbia, Boone County, Missouri. Said tract of land, being that land shown by Boone County Survey #7793, and being that land described by Trustee's Deed recorded in book 1774, page 834 of the Boone County, Missouri records, is more particularly described as follows:

Starting at the northeast corner of Creasy Springs Ridge Plat 2 recorded in book 42, page 41, thence S 83°-46'-50" E, along the township line, 176.45 feet to the point of beginning being the northwest corner of Boone County Survey #7793.

From the point of beginning, thence along the lines of said Boone County survey #7793: S 83°-46'-50" E, along the township line, 176.05 feet, S 0°-20'-50" E 487.80 feet, N 87°-36'-50" W 175.50 feet, and N 0°-17'-50" W 499.60 feet to the point of beginning and containing 1.98 acres and 86,451 square feet.

I then divided said tract of land into Lots 1 and 2 as shown on this plat.

The results of the survey of this urban property, made for Peggy Hendren, and to the best of my knowledge executed in accordance with the current Missouri Minimum Standards for Property Boundary Surveys, are shown on this plat.

Basinger Surveying
 By: *[Signature]*
 Curtis E. Basinger
 Professional Land Surveyor
 PLS #1854

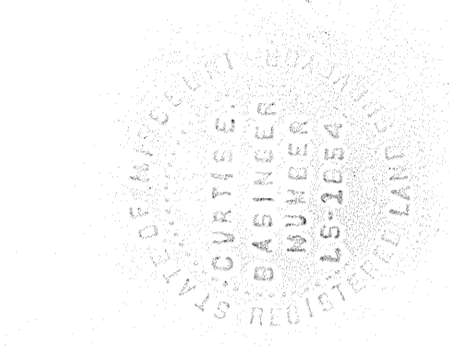

Subscribed and sworn to before me, a Notary Public in and for Boone County, Missouri, this 17 day of August, 2016.

My commission expires Aug. 22, 2017

- Notes:**
- 1) The name, width and location of all known easements have been shown on this plat. However this tract may be subject to easements, unknown to me, that are not shown on this survey.
 - 2) All monuments were set unless noted as existing.
 - 3) Bearings are referenced to Creasy Springs Ridge Plat 2.
 - 4) Per the Flood Insurance Rate Map Panel #29019C0280D, dated March 17, 2011, this tract is not within a FEMA-designated special flood hazard area.
 - 5) This site does not have any stream buffer requirements per Article X of Chapter 12A of the City of Columbia Code of Ordinances, per the "Columbia, Mo." USGS quadrangle map.

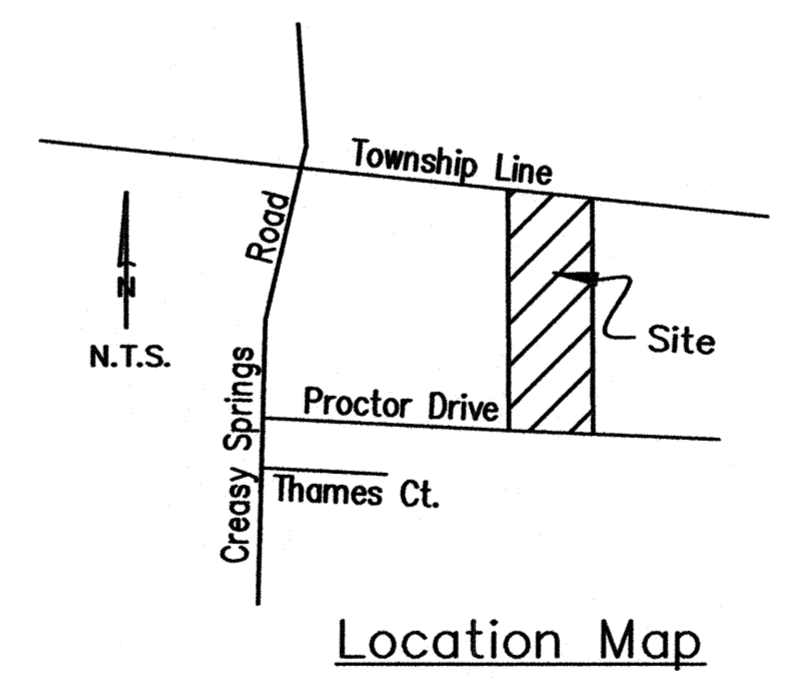

Approved by the Columbia Planning and Zoning Commission
 this 18 day of August, 2016.

[Signature]
 Rusty Strotman, Vice-Chairperson

[Signature]
 Jennifer Bennett, Notary Public

Know all persons by these presents:
 Peggy Hendren, being the sole owner of the herein described tract, has caused the same to be surveyed and divided as shown on this plat. The easement and right-of-way as shown, are hereby dedicated to the City of Columbia, for public use forever.

[Signature]
 Peggy Hendren

STATE OF MISSOURI)
) SS
 COUNTY OF BOONE)

On this 17 day of August, 2016 before me appeared Peggy Hendren to me personally known to be the person described in and who executed the foregoing instrument and acknowledged that she executed the same as her free act and deed. In testimony whereof, I have hereunto set my hand and affixed my official seal at my office in said county and state, the day and year first above written.

[Signature]
 Jennifer Bennett, Notary Public

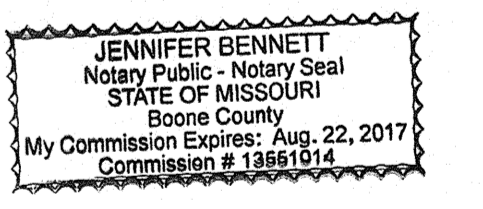

Received and accepted by the Columbia City Council
 this ___ day of ___, 2016.

Brian Treece, Mayor
 Sheila Amin, City Clerk