



#18-144 Renaissance - Plat 3 Final Plat



Roads	Columbia City Limit
City Zoning	CityViewparcels
Parcels	



Created by The City of Columbia - Community Development Department

Parcel Data Source: Boone County Assessor

2015 Imagery: Boone County Assessor's Office

Hillshade Data: Boone County GIS Office

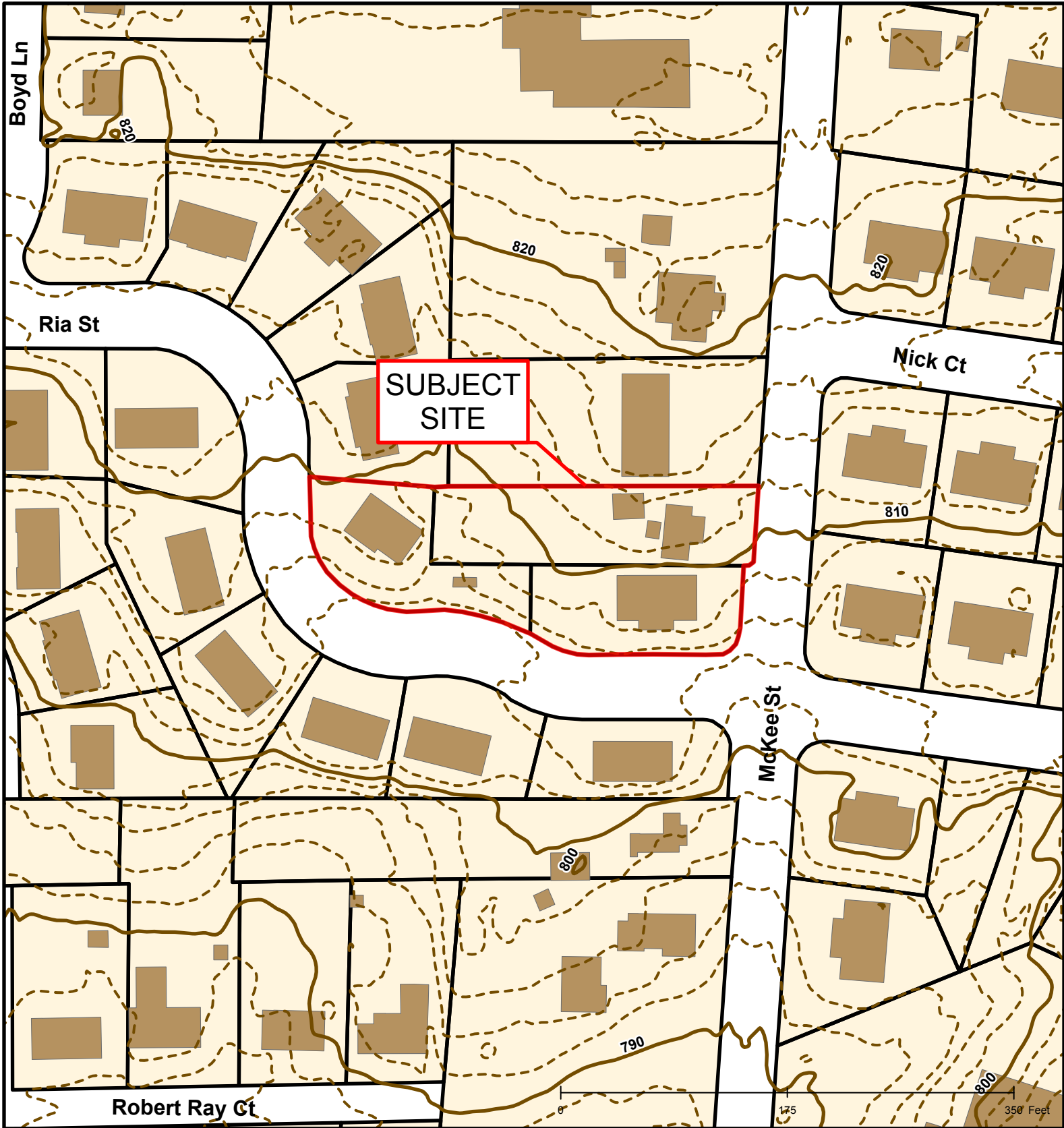

#18-144 Renaissance - Plat 3 Final Plat



<p>Roads</p> <p> Building Footprint</p>	<p> Parcels</p> <p> City Zoning</p>	<p>2015 Topo Lines</p> <p> 10 Foot Contour Lines</p> <p> 2 Foot Contour Lines</p>
---	-------------------------------------	---



Created by The City of Columbia - Community Development Department

Parcel Data Source: Boone County Assessor

2015 Imagery: Boone County Assessor's Office

Hillshade Data: Boone County GIS Office

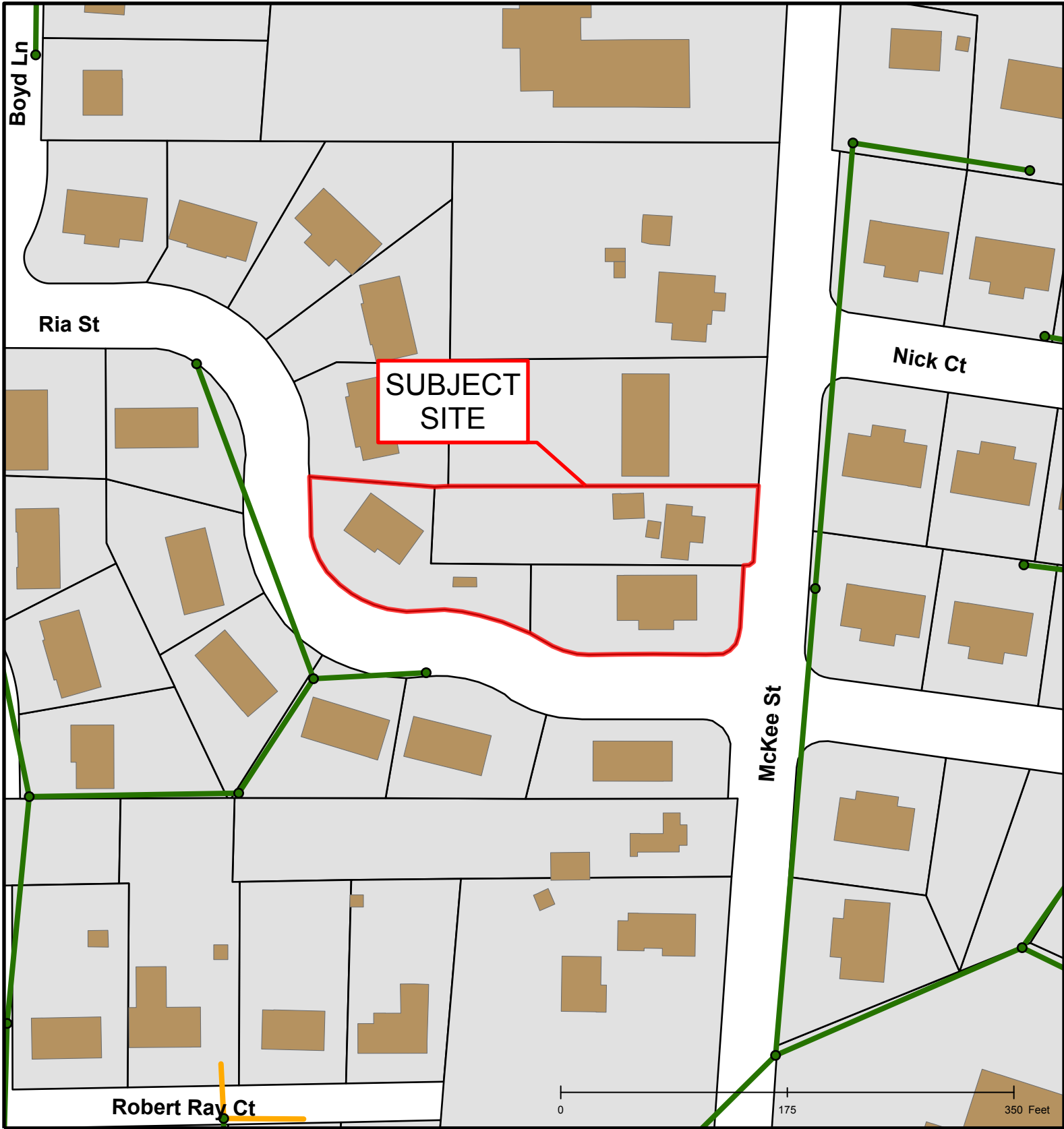

#18-144 Renaissance - Plat 3 Final Plat

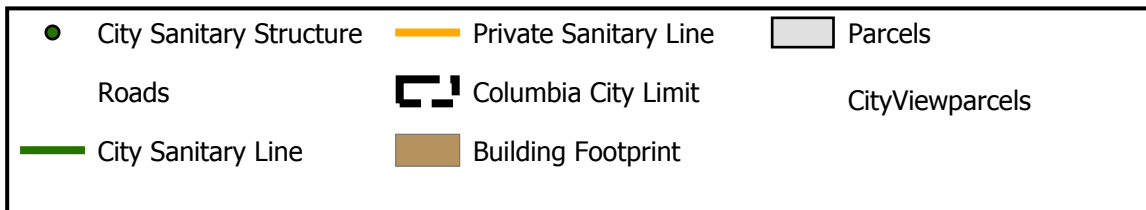

Created by The City of Columbia - Community Development Department

Parcel Data Source: Boone County Assessor

2015 Imagery: Boone County Assessor's Office

Hillshade Data: Boone County GIS Office