



March 28, 2023

Dear Neighbor,

Broadway Lodging Two LLC. Is constructing a new hotel located at 1104 E. Walnut Street. For the duration of the project, we are requesting a sidewalk and single parking meter closure along a portion of Walnut Street. Both eastbound and westbound lanes of Walnut Street will remain open.

Please see the attached traffic control plan showing the location of the closure.

If you have questions or concerns about this, please contact Melissa Severs with PARIC Corporation at 636-561-9500. Any other concerns may be presented in writing to the Director of Public Works, or be heard before the City Council.

The dates of the closure are June 1, 2023 through October 31, 2024 and will be from 12 A.M. to 12 P.M.

The anticipated City Council date at which this closure will be heard is April 17, 2023.

Sincerely,

*Melissa Severs*  
PARIC

Melissa Severs  
Project Manager

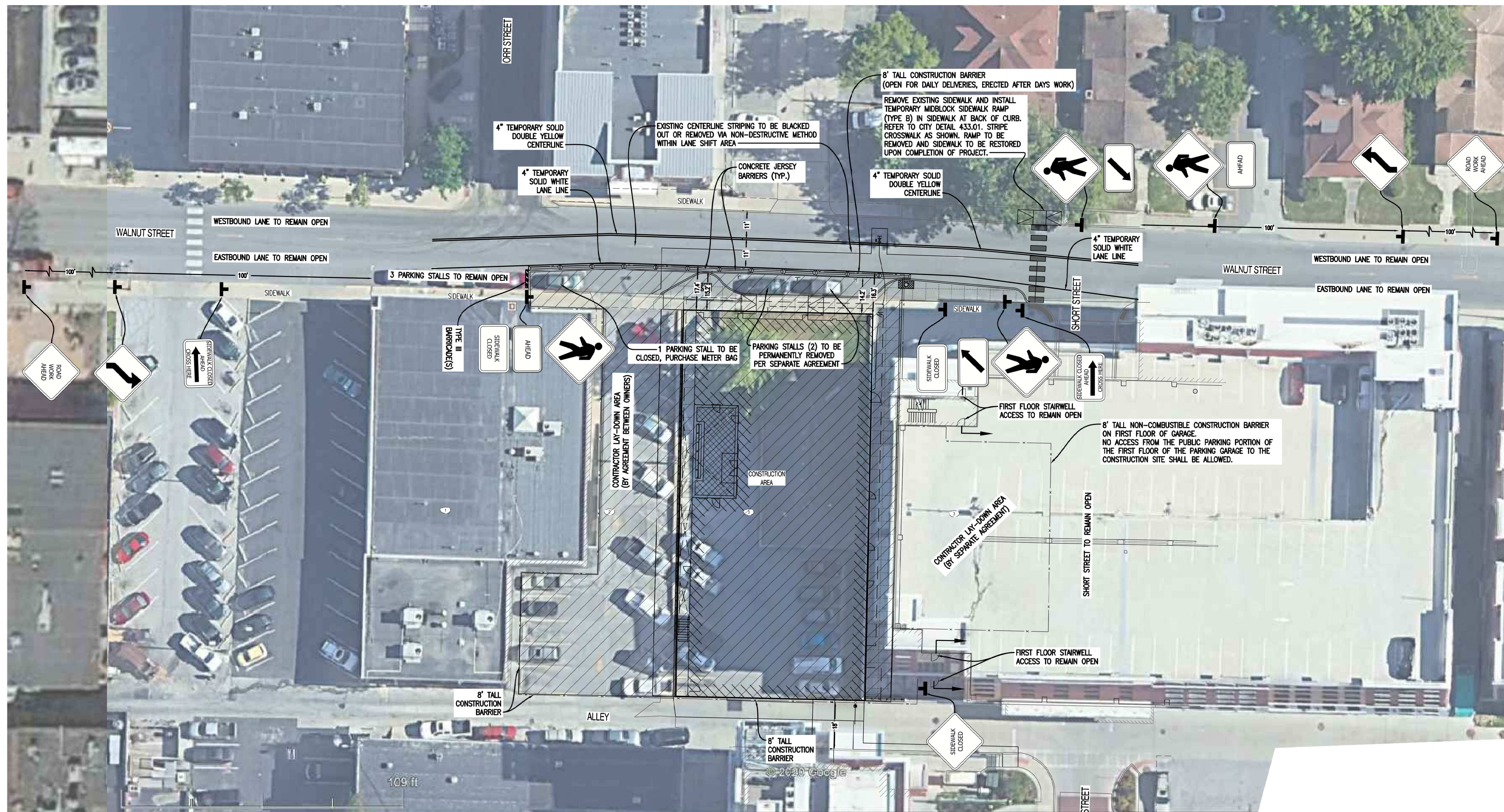

**GENERAL NOTES**

- TRAFFIC CONTROL DEVICES SHALL COMPLY WITH THE MUTCD.
- CONTRACTOR SHALL MAINTAIN A MINIMUM LANE WIDTH OF 11' AT ALL TIMES FOR ANY OPEN LANE OF TRAFFIC.
- CONTRACTOR SHALL REFER TO THE CURRENT EDITION OF THE MUTCD MANUAL OF TRAFFIC CONTROL FOR FIELD OPERATIONS FOR INFORMATION ON THE PROPER DEPLOYMENT OF TRAFFIC CONTROL DEVICES.
- ALL SIDEWALK CLOSURE DEVICES SHALL REMAIN IN PLACE FOR THE DURATION OF THE PROJECT (PHASE 1, PHASE 2, AND PHASE 3).
- CONTRACTOR SHALL KEEP ALL ADJACENT DRIVEWAYS OPEN AT ALL TIMES.
- CONTRACTOR SHALL REMOVE PARKING METER FOR THE TWO STALLS BEING REMOVED AND RETURN TO THE CITY OF COLUMBIA PARKING DEPT.
- WORK SHALL BE COMPLETED BETWEEN 7:00AM AND 7:00PM
- CONTRACTOR SHALL NOTIFY CITY OF COLUMBIA COMMUNITY DEVELOPMENT THREE WEEKS PRIOR TO ANY CLOSURE MADE ACCORDING TO THIS PLAN. ALL TIMES FOR CLOSURE SHALL BE APPROVED BY THE CITY OF COLUMBIA PRIOR TO IMPLEMENTATION OF THIS PLAN.
- CONTRACTOR IS RESPONSIBLE FOR NOTIFYING THE FOLLOWING AGENCIES, AS REQUIRED, IMMEDIATELY PRIOR TO CLOSURE OF STREET, DURING CONSTRUCTION FOR INSPECTIONS AND AGAIN WHEN WORK IS COMPLETE AND STREET IS REOPENED:
- SITE DEVELOPMENT (ROW INSPECTIONS) 874-7474
  - BUILDING SAFETY (PLUMBING/BUILDING INSPECTIONS) 874-7474
  - JOINT COMMUNICATIONS (EMERGENCY SERVICES) 874-8471
  - COLUMBIA TRANSIT (CITY BUSES) 874-7282
  - PARKING ENFORCEMENT (PARKING METERS) 874-7674
  - PUBLIC WORKS STREET DIVISION (STREET PATCHING) 874-6289

**TRAFFIC CONTROL DEVICE LEGEND**

	PLACE STANDARD HIGHWAY SIGN (MUTCD SIGN # R9-11L SHOULD READ "SIDEWALK CLOSED AHEAD CROSS HERE"). SIGN SHALL BE 24" X 18" MIN.		PLACE STANDARD HIGHWAY SIGN (MUTCD SIGN # W1-4(R) SHOULD INDICATE LANE SHIFT RIGHT). SIGN SHALL BE 24" X 24" MIN.
	PLACE STANDARD HIGHWAY SIGN (MUTCD SIGN # R9-11R SHOULD READ "SIDEWALK CLOSED AHEAD CROSS HERE"). SIGN SHALL BE 24" X 18" MIN.		PLACE STANDARD HIGHWAY SIGN (MUTCD SIGN # W1-4(L) SHOULD INDICATE LANE SHIFT LEFT). SIGN SHALL BE 24" X 24" MIN.
	PLACE STANDARD HIGHWAY SIGN (MUTCD SIGN # R9-9 SHOULD READ "SIDEWALK CLOSED"). SIGN SHALL BE 24" X 18" MIN.		PLACE STANDARD HIGHWAY SIGN (MUTCD SIGN # W11-2). SIGN SHALL BE 30" X 30" MIN.
	PLACE STANDARD HIGHWAY SIGN (MUTCD SIGN # W20-1 SHOULD READ "ROAD WORK AHEAD"). SIGN SHALL BE 24" X 24" MIN.		PLACE STANDARD HIGHWAY SIGN (MUTCD SIGN # W16-9P SHOULD READ "AHEAD"). SIGN SHALL BE 24" X 12" MIN.
			PLACE STANDARD HIGHWAY SIGN (MUTCD SIGN # W11-2). SIGN SHALL BE 30" X 30" MIN.
			PLACE STANDARD HIGHWAY SIGN (MUTCD SIGN # W16-7P SHOULD HAVE DIAGONAL ARROW). SIGN SHALL BE 24" X 12" MIN.

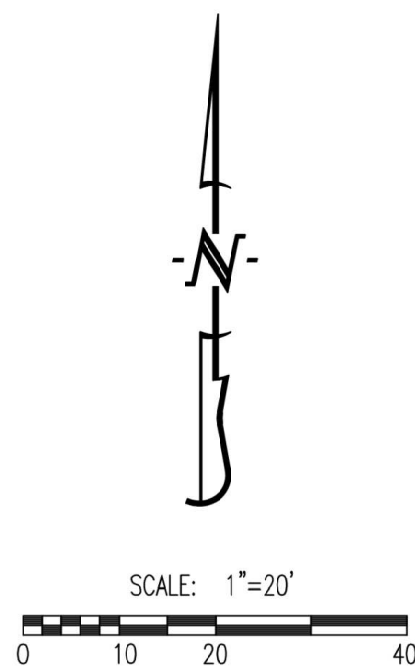

**REVISIONS:**

NO.	DATE
ORIGINAL	04/24/2020

THIS SHEET HAS BEEN SIGNED, SEALED AND DATED ELECTRONICALLY

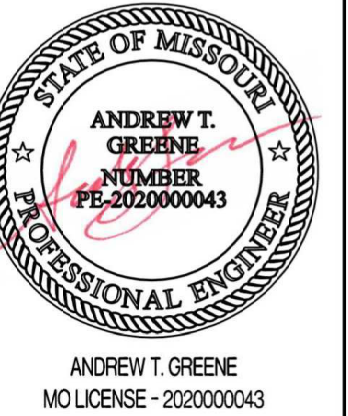

**SITE/CIVIL ENGINEER**  
**CROCKETT**  
 100 W. HARRIS STREET, SUITE 101  
 COLUMBIA, MISSOURI 65201  
 www.crockettengineering.com  
 (573) 447-0092  
 Crockett Engineering Consultants, LLC  
 Missouri Certificate of Authority  
 0420000043

**OWNER:**  
 BROADWAY LOGGING, LLC  
 1111 BROADWAY ST.  
 COLUMBIA, MO 65201

**COLUMBIA BROADWAY II**  
 SECTION 7, TOWNSHIP 48 NORTH, RANGE 12 WEST  
 COLUMBIA, BOONE COUNTY, MISSOURI

**DRAWING INCLUDES:**

TRAFFIC CONTROL PLAN  
 PHASE 1

DESIGNED: NTE

DRAWN: ATG

PROJECT NO.: 150415

SHEET:  
 TC1