

Case # 215-2021: 5170 S. Scott Boulevard Annexation

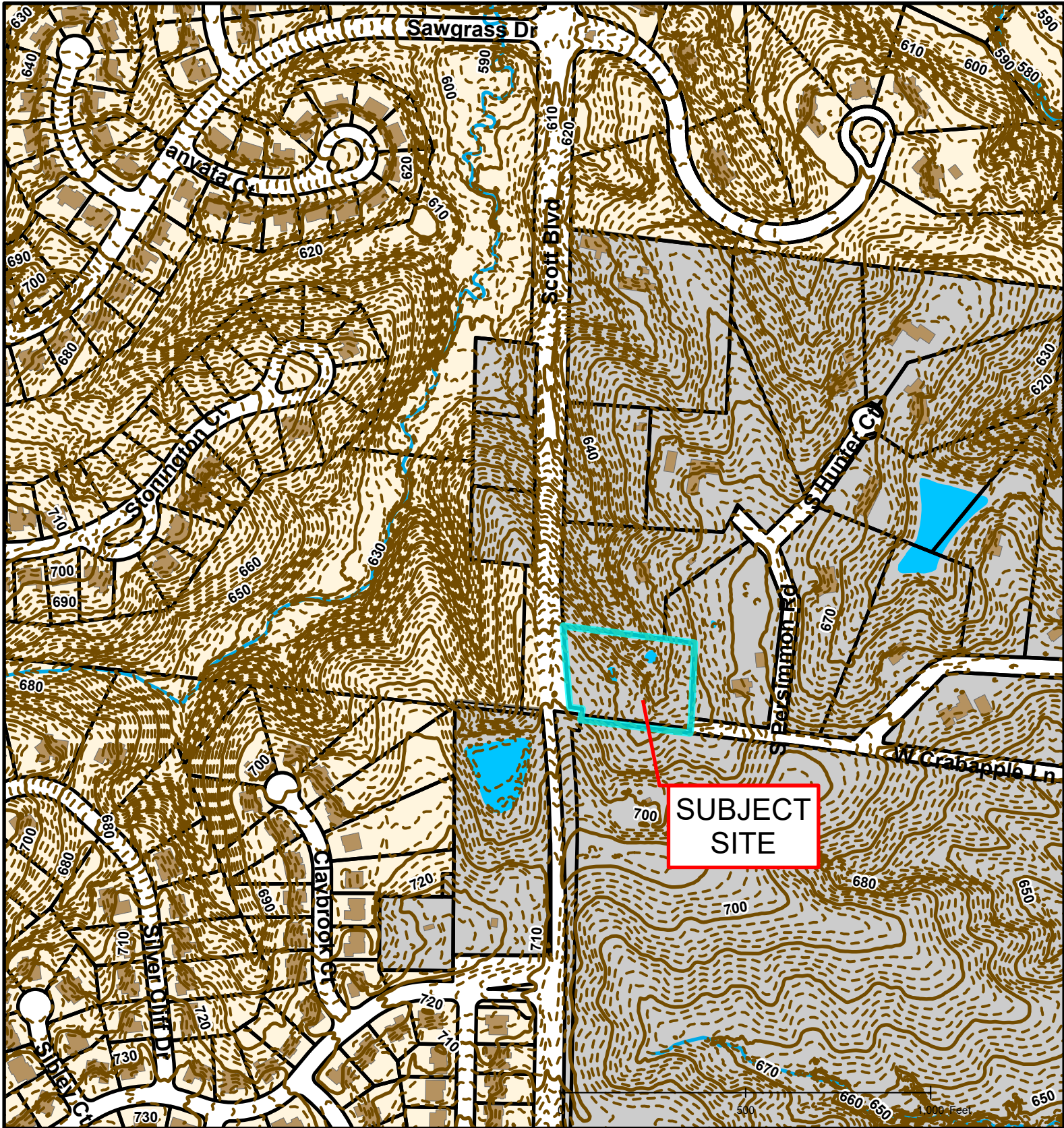

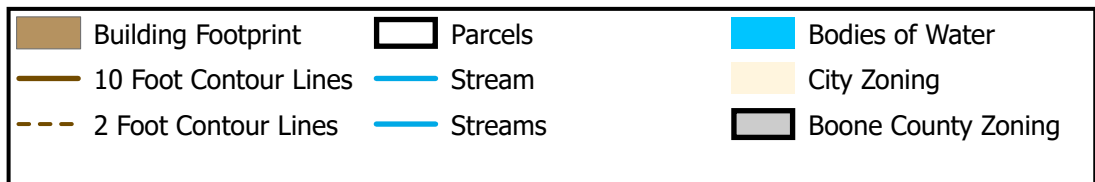

Case # 215-2021: 5170 S. Scott Boulevard Annexation



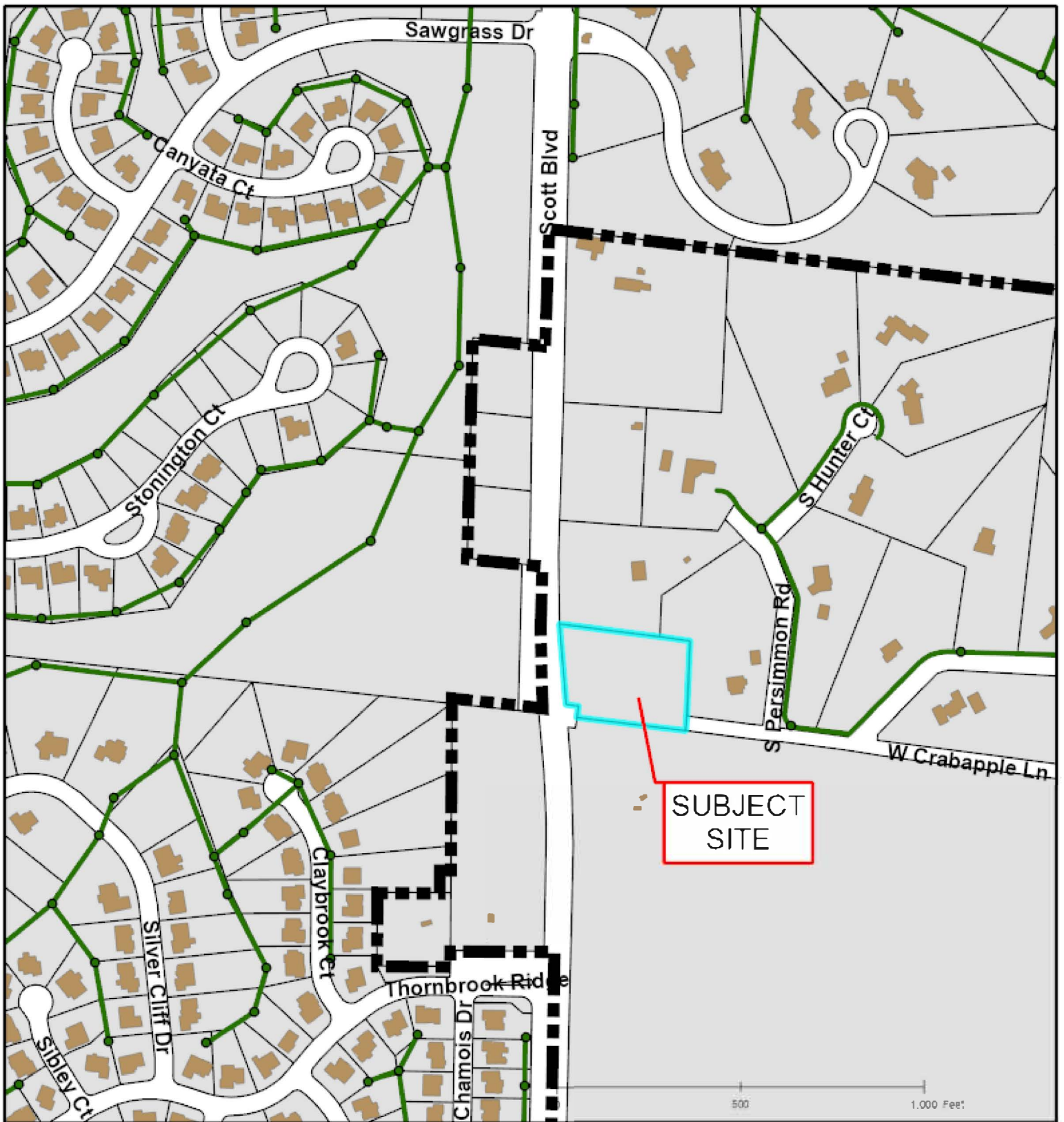

Case # 215-2021: 5170 S. Scott Boulevard - Annexation

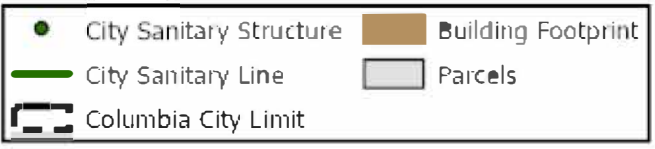

Created by The City of Columbia - Community Development Department

Parcel Data Source: Boone County Assessor

2017 Imagery: Boone County Assessor's Office

Hillshade Data: Boone County GIS