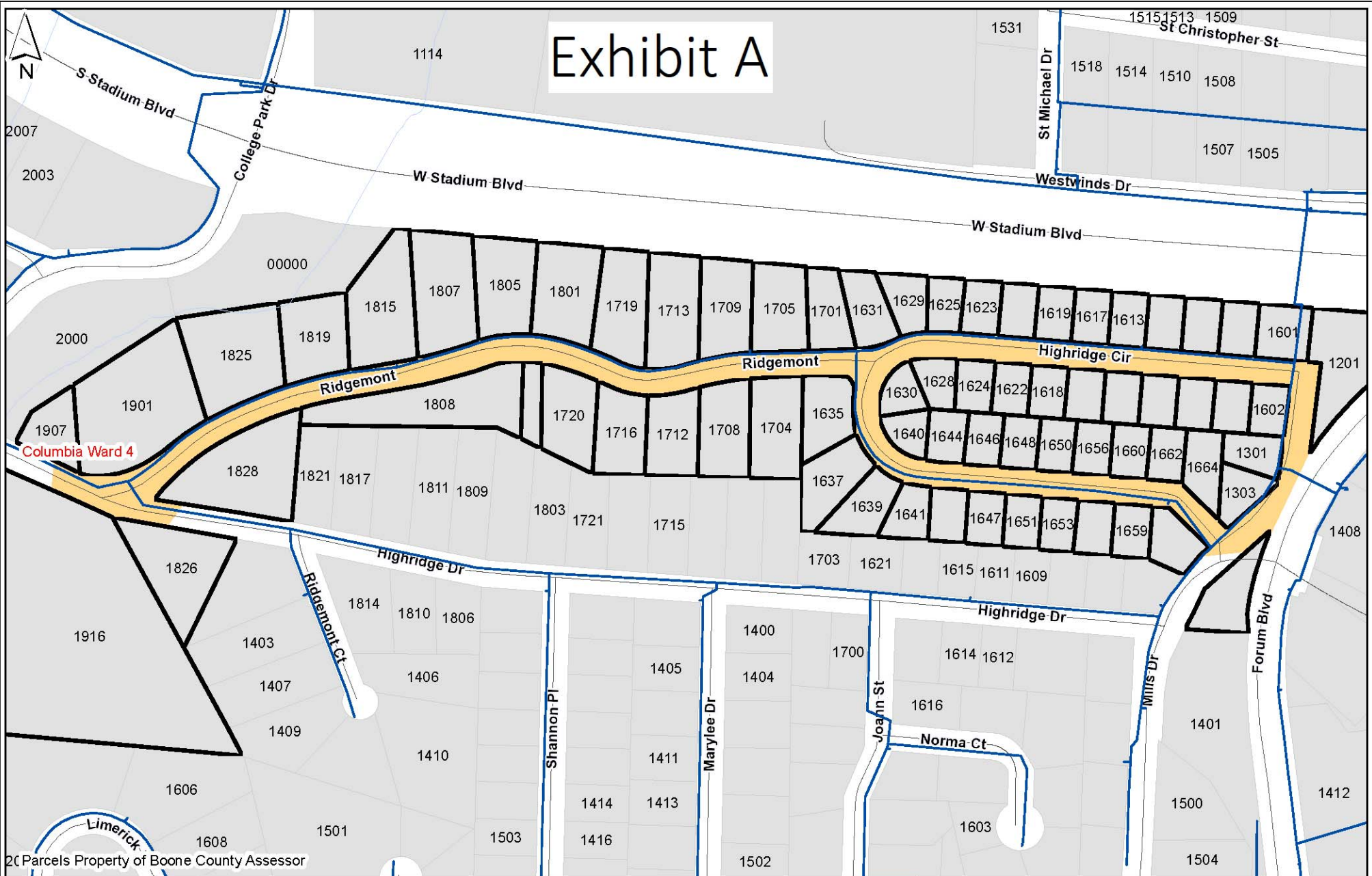

Exhibit A



Columbia Ward 4

© Parcels Property of Boone County Assessor

- Legend**
- Project Parcels
 - Existing Main
 - Project Area
 - Neighborhood Associations
 - Chapel Woods
 - College Park
 - Southwest Hills
 - Westwinds Park

Approx 3200' 6" Water Main Replacement
CIP# W0130

ALL IN COLUMBIA WATER & LIGHT
AND COLUMBIA CITY LIMITS

Ridgemont & Highridge Cir.

COLUMBIA UTILITIES

0 80 160 320 Feet

City of Columbia
Water & Light

Date: 2/15/2019