

DESCRIPTION OF OH SOUTHWEST REMNANT – REZONING M-N
 FOR BOONE DEVELOPMENT INC.
 JOB #2301325

OCTOBER 16, 2023

A TRACT OF LAND LOCATED IN THE NORTHEAST QUARTER OF SECTION 22, TOWNSHIP 48 NORTH, RANGE 12 WEST, COLUMBIA, BOONE COUNTY, MISSOURI AND BEING PART OF THE LAND DESCRIBED BY THE WARRANTY DEED RECORDED IN BOOK 3008, PAGE 125 AND THE SURVEY RECORDED IN BOOK 2591, PAGE 24 AND BEING MORE PARTICULARLY DESCRIBED AS FOLLOWS:

BEGINNING ON THE NORTHERLY RIGHT OF WAY LINE OF STATE ROUTE WW AT THE SOUTHWEST CORNER OF ROLLING HILLS ROAD AT OLD HAWTHORNE, RECORDED IN PLAT BOOK 42, PAGE 40 AND WITH SAID NORTHERLY RIGHT OF WAY LINE THEREOF, N 71°48'00"W, 67.89 FEET; THENCE N 87°15'00"W, 64.58 FEET; THENCE N 55°25'45"W, 111.66 FEET TO THE WEST LINE OF SAID SURVEY RECORDED IN BOOK 2591, PAGE 24; THENCE LEAVING SAID NORTHERLY RIGHT OF WAY LINE AND WITH THE WEST LINE OF SAID SURVEY THEREOF, N 1°06'40"E, 513.48 FEET; THENCE LEAVING THE WEST LINE OF SAID SURVEY, N 81°46'40"E, 144.00 FEET TO THE WEST LINE OF SAID ROLLING HILLS ROAD AT OLD HAWTHORNE; THENCE WITH THE WESTERLY RIGHT OF WAY LINES OF ROLLING HILLS ROAD, S 25°39'05"E, 88.95 FEET; THENCE 556.45 FEET ALONG A 709.00-FOOT RADIUS CURVE TO THE RIGHT, SAID CURVE HAVING A CHORD, S 3°10'05"E, 542.28 FEET TO THE POINT OF BEGINNING AND CONTAINING 3.06 ACRES.

BEARINGS ARE REFERENCED TO GRID NORTH OF THE MISSOURI STATE PLANE COORDINATE SYSTEM, CENTRAL ZONE.

David T. Butcher

DAVID T. BUTCHER, PLS-2002014095

10/18/2023

DATE

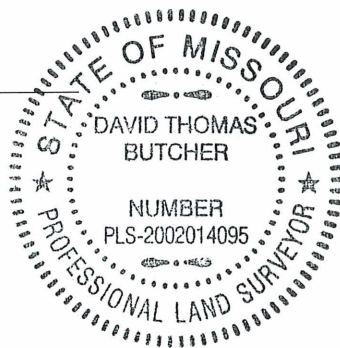

CROCKETT ENGINEERING CONSULTANTS 1000 W. Nifong Blvd. Building 1 Columbia, Missouri 65203 (573) 447-0292 www.crockettengineering.com	CORPORATE NUMBER 2000151304	DESCRIPTION OF OH SW REMNANT – M-C ZONE
	DATE: 10/18/2023	NE QUARTER, SECTION 22, TOWNSHIP 48 NORTH, RANGE 12 WEST, COLUMBIA, BOONE COUNTY, MISSOURI
	PROJECT: 991083	