

Introduced by Windman
First Reading 4-1-96 Second Reading 4-15-96
Ordinance No. 014813 Council Bill No. B 85-96

014813

Permanent Record
Filed in Clerk's Office

AN ORDINANCE

amending the Zoning District Map established and adopted by Section 29-4 of the Code of Ordinances of the City of Columbia, Missouri, by changing and amending the zoning map whereby property located on the south side of East Ash Street between North Garth Avenue and First Street will be rezoned and become a part of C-P (Planned Business District); amending the Land Use Plan; repealing all conflicting ordinances or parts of ordinances; approving the C-P development plan of Warren Funeral Chapel; and fixing the time when this ordinance shall become effective.

BE IT ORDAINED BY THE COUNCIL OF THE CITY OF COLUMBIA, MISSOURI, AS FOLLOWS:

SECTION 1. The Zoning District Map established and adopted by Section 29-4 of the Code of Ordinances of the City of Columbia, Missouri, is hereby amended and changed so that the following described property, to wit:

Part of Lots Fourteen (14), Fifteen (15) and Sixteen (16) in J.A. Stewart's Subdivision known as WORLEY PLACE according to plat thereof recorded in Plat Book 2 Page 6 of the Boone County Records, in Columbia, Missouri, described as follows: Beginning on the South line of Ash Street and the Northeast corner of Lot Fourteen (14), thence West along the South line of Ash Street Four (4) feet, thence South One Hundred Forty (140) feet, thence East Forty-Four (44) feet, thence North One Hundred Forty (140) feet, thence West along the South line of Ash Street Forty (40) feet to the point of beginning. ALSO, Twenty-Four and One-Half (24-1/2) feet off of the East Side of Lot Number Fifteen (15) and Four and One-Half (4-1/2) feet off of the West side of Lot Number Sixteen (16), all in J.A. Stewart's Subdivision known as WORLEY PLACE, Columbia, Missouri.

will be rezoned and become a part of C-P (Planned Business District) and taken away from R-3 (Medium Density Multiple-Family Dwelling District). Hereafter the property may be used for a funeral home and associated uses with no crematory.

SECTION 2. The property described in Section 1 is designated "Planned Commercial" on the Land Use Plan.

SECTION 3. All ordinances or parts of ordinances in conflict with the provisions of this ordinance are hereby repealed.

SECTION 4. The City Council hereby approves and adopts the Warren Funeral Chapel C-P development plan dated December 1995.

SECTION 5. This ordinance shall be in full force and effect from and after its passage.

PASSED this 15th day of April, 1996.

ATTEST:

Laura H. Daniel
City Clerk

Larvin Windman
Mayor and Presiding Officer

APPROVED AS TO FORM:

Fred Bushman
City Counselor

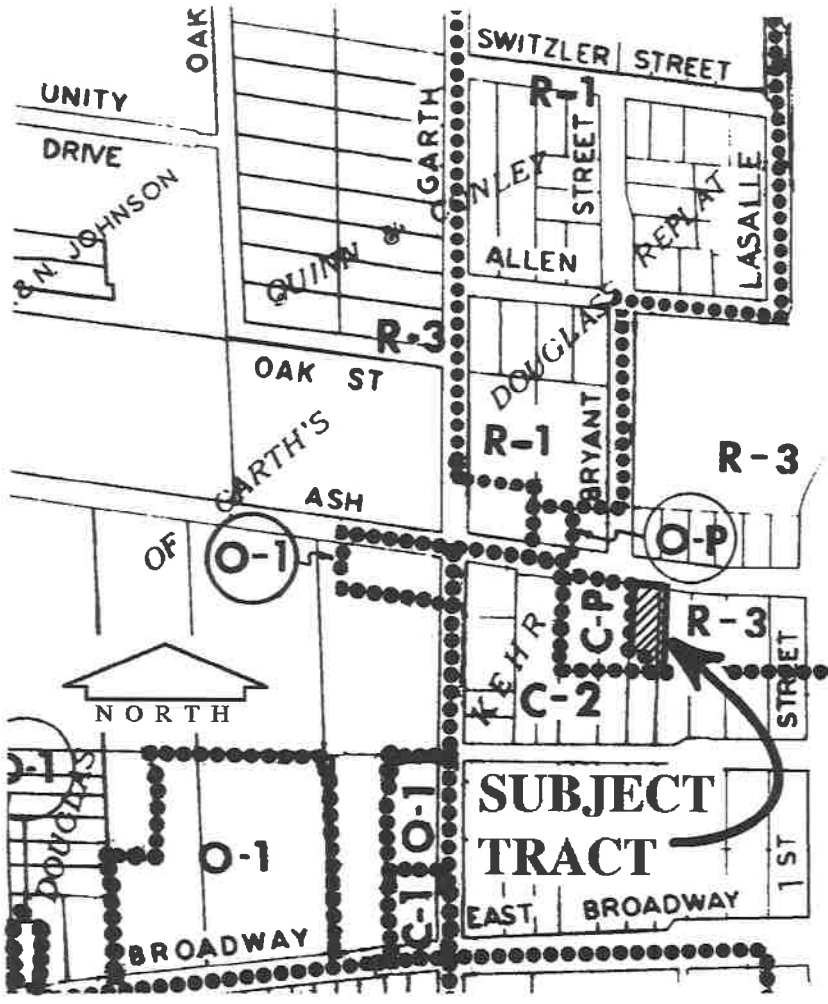

for file