

UTILITY Land Surveyor use (ONLY) (Measurement of Right-of-Way) SS 123 ALDEAH AND ASH STORM WATER (DAB) ALDEAH AND ASH ESM1.S.DWG, 9/25/2020 9:25:54.



ALDEAH AVENUE

N00°05'25"E
9.11'

P.O.C.

S00°05'25"W
45.80'

P.O.B. T.A.E.

Flower Bed

S80°57'40"E
81.23'

114

P.O.B.

S80°57'40"E
24.22'

PARCEL # 16-319-00-12-013.00 01

112

S09°02'20"W · Patio
9.00'

Flower Bed

N09°02'20"E
54.24'

PARCEL # 16-319-00-12-014.00 01
ELIZABETH ANN HARTWIG &
BARBARA KAY HARTWIG
W.D. BK. 1107, PG. 818
PART OF LOT 8 OF MCBAINES WESTERN ADDITION
TO THE CITY OF COLUMBIA RECORDED IN PLAT
BOOK 1 PAGE 3

S80°57'40"E
74.10'

Conc. Drive

N80°57'40"W
72.69'

N80°57'40"W
24.22'

S09°02'20"W
54.24'

Flower Bed

Garage

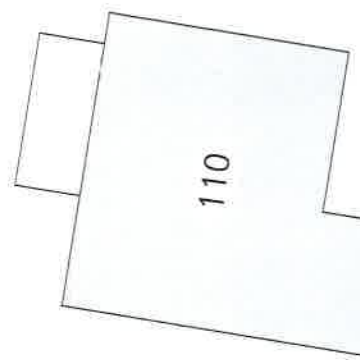

Deck

110

SHRUBS

PARCEL # 16-319-00-12-016.00 01

THILL 753

P.O.C. Point of Commencement
P.O.B. Point of Beginning



Temporary Access Easement 661 SQ.FT.



Temporary Construction Easement 1314 SQ.FT.



**ALDEAH & ASH
STORM PIPE REHAB**

Easements 112 Aldeah

Scale: 1"=20'

Drawn: D.A.B.

Date: 9/25/20