



#17-159: Stoney Creek Plat 2 Replat



Roads	Columbia City Limit
City Zoning	CityViewparcels
Parcels	



Created by The City of Columbia - Community Development Department

Parcel Data Source: Boone County Assessor

2015 Imagery: Boone County Assessor's Office

Hillshade Data: Boone County GIS Office

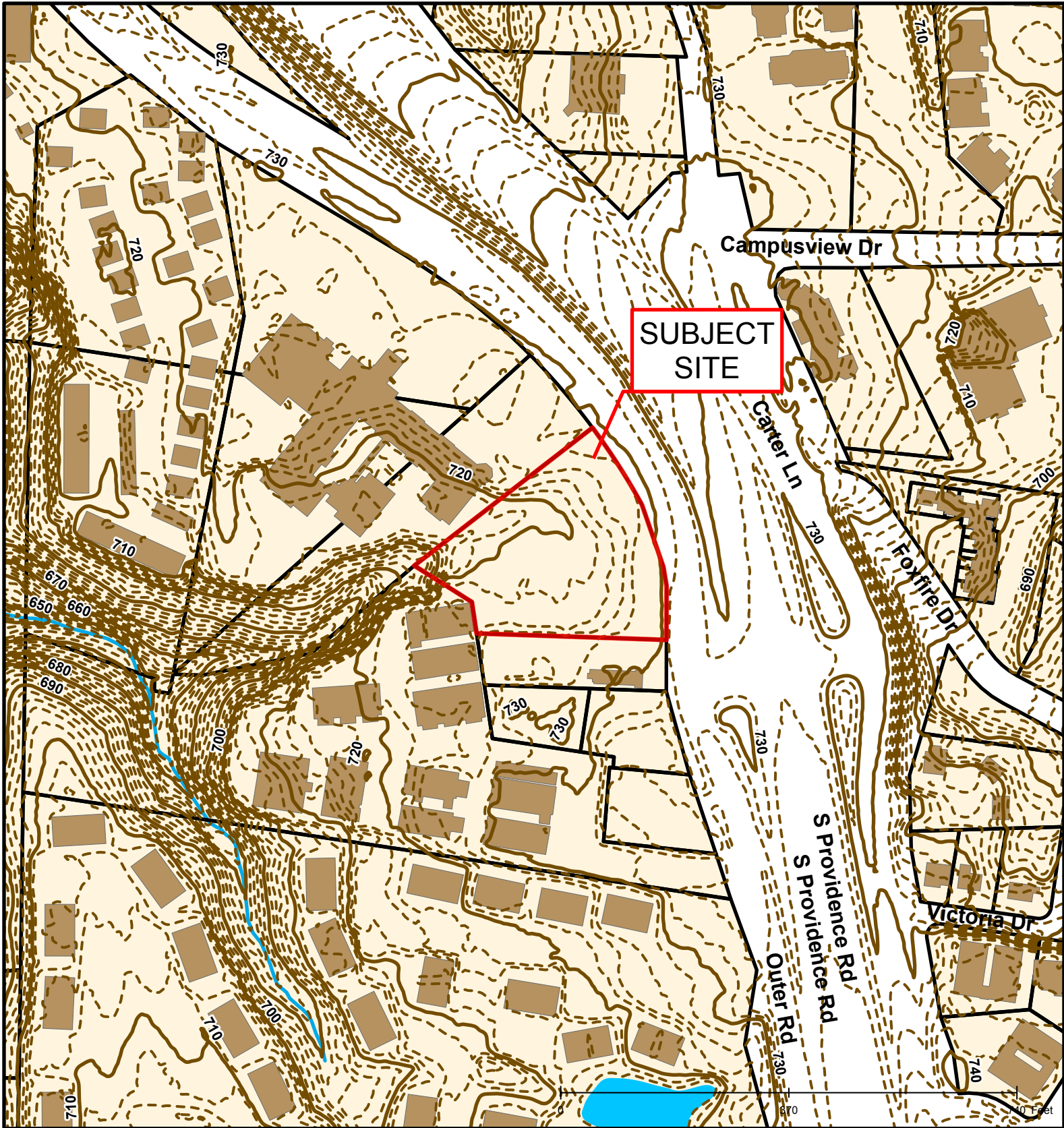

#17-159: Stoney Creek Plat 2 Replat

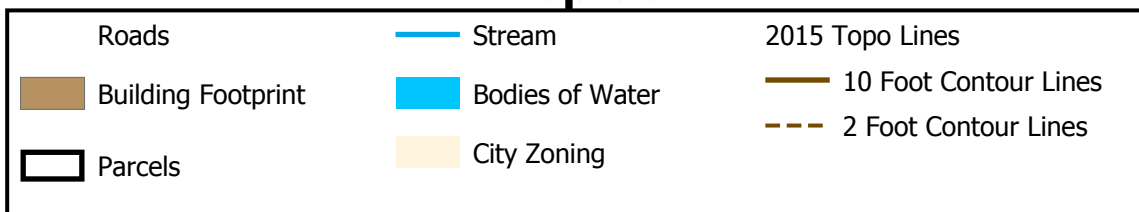

Created by The City of Columbia - Community Development Department

Parcel Data Source: Boone County Assessor

2015 Imagery: Boone County Assessor's Office

Hillshade Data: Boone County GIS Office

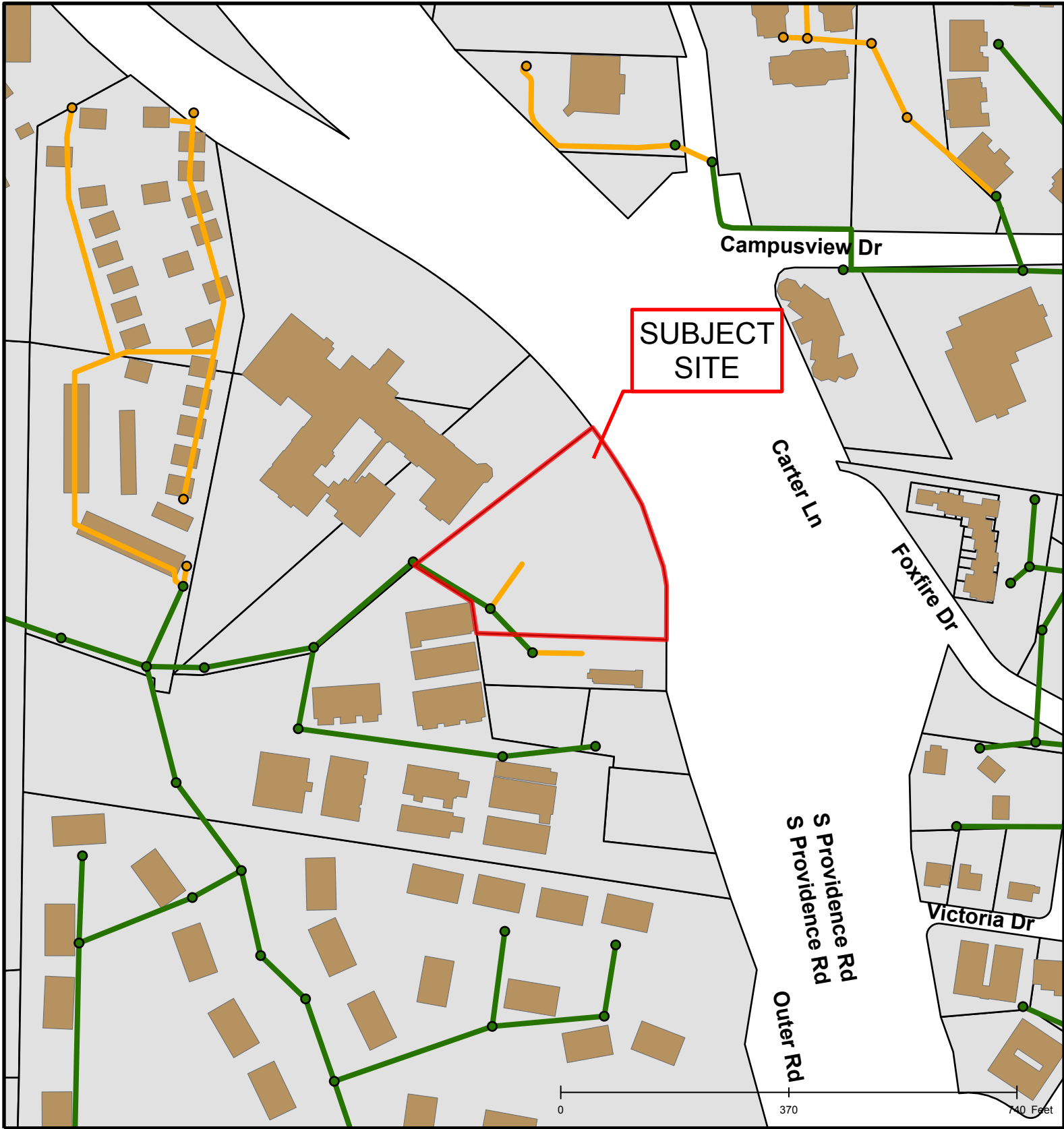

#17-159: Stoney Creek Plat 2 Replat

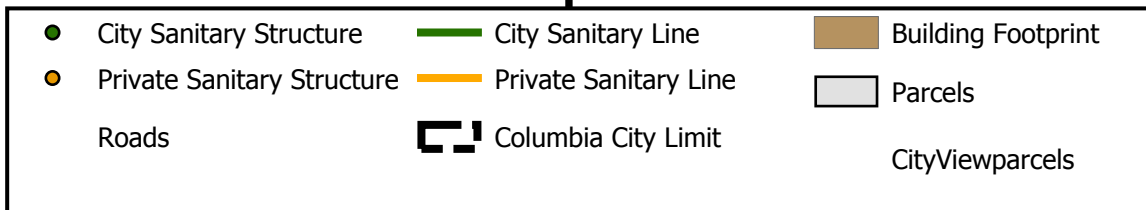

Created by The City of Columbia - Community Development Department

Parcel Data Source: Boone County Assessor

2015 Imagery: Boone County Assessor's Office

Hillshade Data: Boone County GIS Office