

City of Columbia, Missouri

Department of Public Works

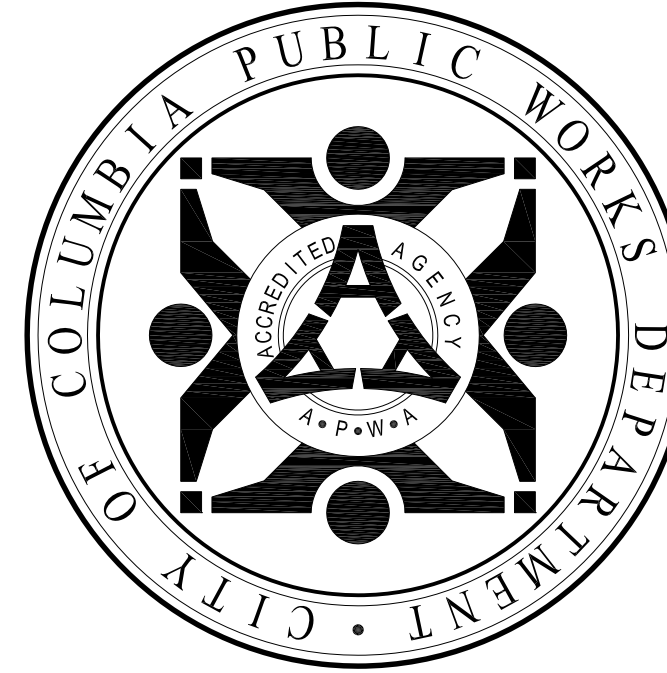

THIRD AVENUE ALLEY

RESTORATION PROJECT

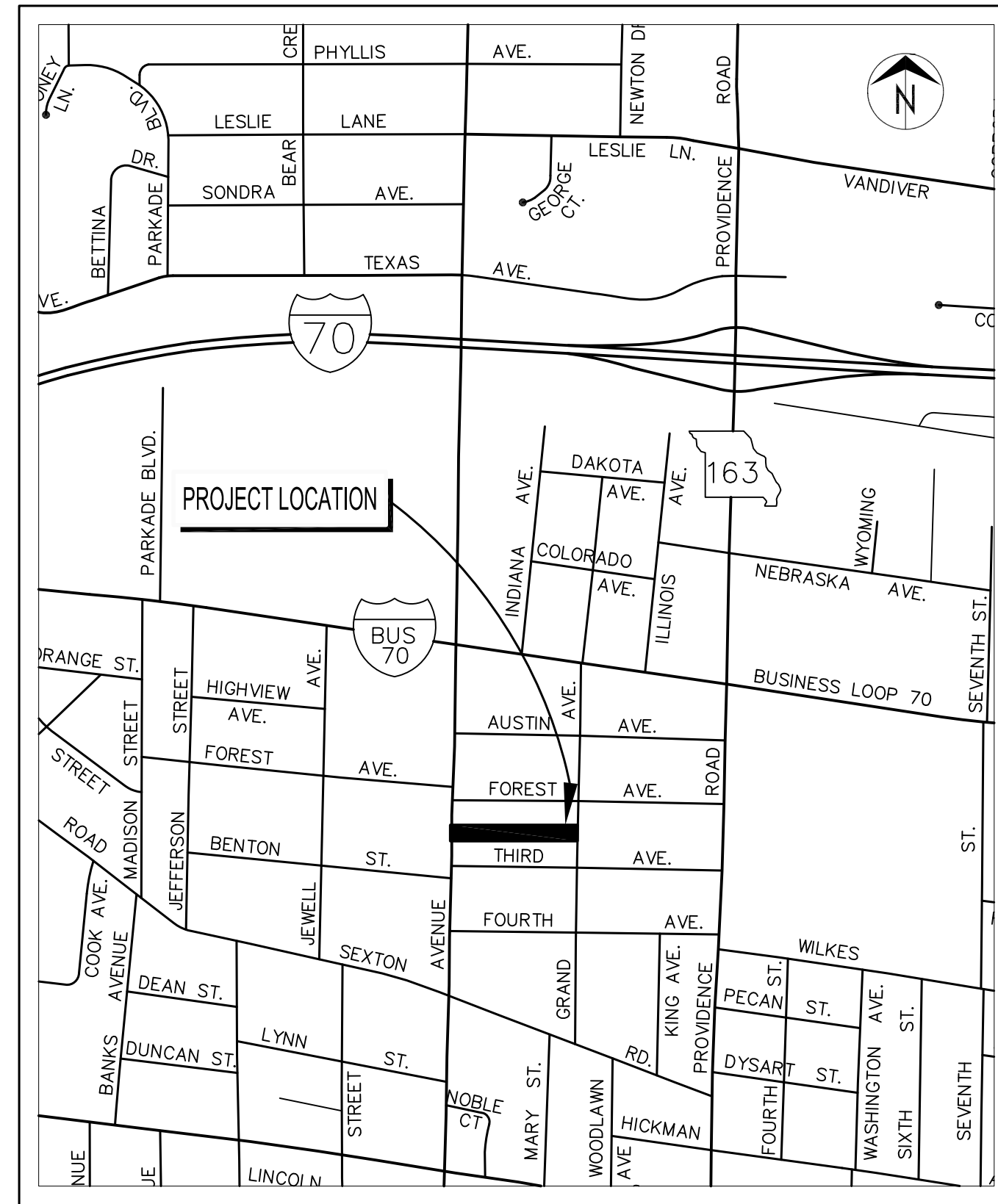

LOCATION MAP

LEGEND OF SYMBOLS

POWER POLE	
TELEPHONE POLE	
GUY ANCHOR	
GUY POLE	
STREET LIGHT POLE	
YARD LIGHT (SOLAR)	
WATER METER	
GAS METER	
GAS VALVE	
WATER VALVE	
FIRE HYDRANT	
PIPE BREAKLINE	
SANITARY MANHOLE	
SANITARY CLEANOUT	
SANITARY LATERAL CLEANOUT	
TRAVERSE POINT	
MoDOT ROW MARKER	
BENCHMARK	
SIGN	
MAIL BOX	
PROPERTY IRON	
BUSH	
STUMP	
TREE REMOVAL	
TREE	
TREE LINE	
SILT FENCE/TREE PROTECT	
EXISTING PUBLIC SANITARY SEWER	
EXISTING SANITARY SEWER LATERAL	
EXISTING SANITARY SEWER TO BE ABANDONED	
PROPOSED SEWER MAIN AND LATERALS	
FENCE	
CABLE TELEVISION	
TELEPHONE	
ELECTRIC	
TELEPHONE OR ELECTRIC MANHOLE	
WATER MAIN	
GAS MAIN	
FIBER OPTIC	
FLOW LINE	
PROPERTY LINE	
LOT LINE	
EXISTING RIGHT OF WAY LINE	
EXISTING EASEMENT	
PERMANENT UTILITY EASEMENT	
PROPOSED SANITARY SEWER EASEMENT	
PROPOSED PERMANENT DRAINAGE EASEMENT	
PROPOSED RIGHT OF WAY	
TEMPORARY ACCESS EASEMENT	
TEMPORARY CONSTRUCTION EASEMENT	
GRADING LIMIT	

GENERAL NOTES

- All construction to be in accordance with "City of Columbia Street, Storm and Sanitary Specifications" (Current edition).
- Known underground utilities are shown in their approximate locations. Other utilities may exist.
- All removal of driveway pavements should be verified by field engineer.
- All excavation to be in accordance with Sections 319.010-319.050, Revised Statutes of the State of Missouri. Such compliance shall not, however, excuse any person making any excavation from doing so in a careful and prudent manner, nor shall it excuse such person from liability for any damage or injury to underground utilities resulting from the excavation.
- All RCP is Class III unless otherwise indicated.
- All disturbed earth areas shall be restored as per TS-___ Seeding and TS-___ Erosion Control.
- Remove all pavement surfaces, inlets, pipes and sidewalks within the construction limits as per TS-___, except those noted to remain. The field inspector shall verify removal of all driveway pavement.
- Removal of trees and bushes shall be verified by field inspectors. Exercise caution when working near the construction limits to minimize disturbance to adjacent trees and shrubs that are not being removed by construction activities.
- Backfill of reinforced concrete pipe shall be 1 inch clean rock or soil compacted to 95 percent of standard proctor density as per TS-___.
- No open trenches will be allowed overnight outside of the "road closed" area. Asphaltic "cold mix" shall be used as a temporary patch overnight. Temporary patching shall be considered incidental to the work.

UTILITY COMPANIES:

TELEPHONE
CenturyLink
625 Cherry Street
Columbia, MO 65205
573-886-3500

NATURAL GAS
Ameren Missouri
2001 Maguire Boulevard
Columbia, MO 65201
573-876-3063

CABLE TELEVISION
Mediacom
901 N. College Avenue
Columbia, MO 65201
573-443-1536 ext 354

LOCATES
Missouri One Call Inc.
1022 B Northeast Drive
Jefferson City, MO 65109
1-800-344-7483

WATER
City of Columbia
P.O. Box 6015
City Utilities
Columbia, MO 65205
573-874-2489

ELECTRIC
City of Columbia
P.O. Box 6015
City Utilities
Columbia, MO 65205
573-874-2489

SANITARY SEWER
City of Columbia
P.O. Box 6015
City Utilities
Columbia, MO 65205
573-874-2489

TRAVERSE POINTS

#	NORTHING	EASTING	ELEVATION	DESCRIPTION
TP#1	1139424.962	1686931.708	760.263	TP PK
TP#4	1139405.256	1686731.383	753.393	TP 60D
TP#5	1139416.899	1686607.262	746.308	TP 60D
TP#6	1139389.414	1686475.582	739.391	TP 60D
TP#7	1139401.405	1686318.173	737.098	TP 60D

INDEX OF SHEETS

Description	Sheet No.
Cover Sheet	1
Plan Sheet	2
Detail Sheet	3
Storm Water	4
Cross Sections	5-7

City of Columbia, Missouri Department of Public Works			
No.	Date	By	Revision
File No. 00734	Des. A.A.A.	Sheet	David Allen Nichols Registered Professional Engineer E-24212
Scale: None	Dwn. C.N.S.	1 of 7	
Date: 06/10/2019	Chk. A.A.A.		
THIRD AVENUE ALLEY			
Approved By _____			
Director of Public Works		Date	

- ① CONSTRUCT RESIDENTIAL STREET ALLY PER DETAIL 1, SHEET 2.
- ② CONSTRUCT CONCRETE DRIVEWAY ENTRANCE PER DETAIL 2, SHEET 2.
- ③ CONSTRUCT 4.5'X3.5' SIDE OPENING INLET PER DETAIL 3, SHEET 2.
- ④ REMOVE TREE..
- ⑤ REMOVE STUMP.
- ⑥ REMOVE FENCE & REPLACE AT PDE.
- ⑦ REMOVE GARDEN.
- ⑧ REMOVE FENCE & TREE'S THEN REPLACE FENCE.

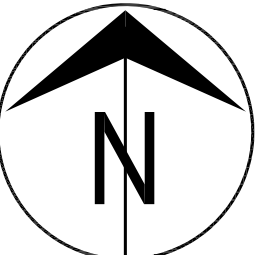

FOREST AVENUE
(ASPHALT SURFACE W/CONCRETE CURB)

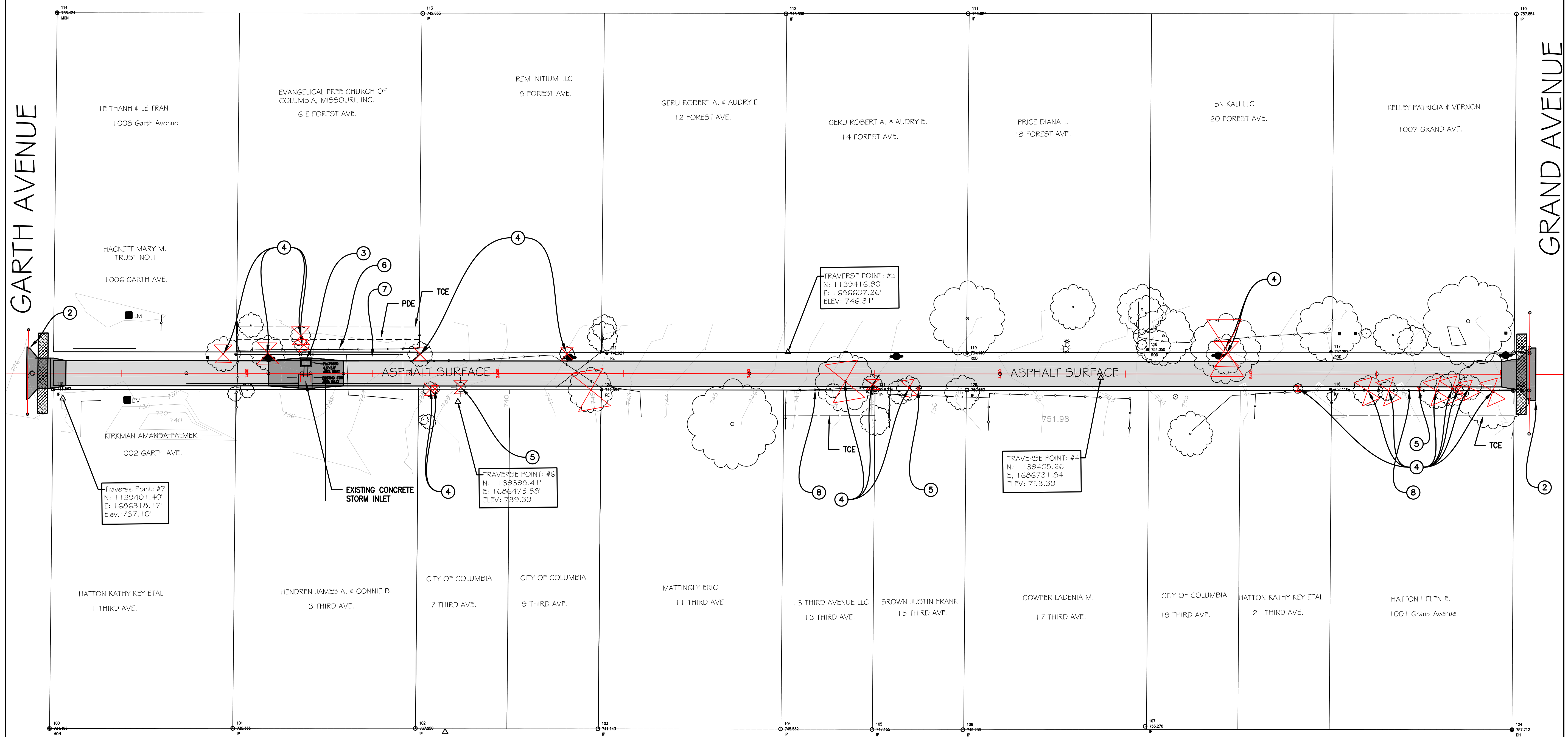

THIRD AVENUE
(ASPHALT SURFACE W/CONCRETE CURB)

Revision	By	Date	No.

THIRD AVENUE ALLEY
Plan Sheet

City of Columbia, Missouri
Department of Public Works

David Allen Nichols
Registered Professional
Engineer
E-24212

File No.	00734
Scale:	1" = 21'
Date:	6/10/2019
Des.	AAA.
Dwn.	C.N.S.
Chk.	AAA.

s:\cad\proj\1918\third avenue alley restoration\design\forest third avenue alley restoration storm flow2(8-18-19).dwg

2015 Orthophoto Source: Boone County Assessor

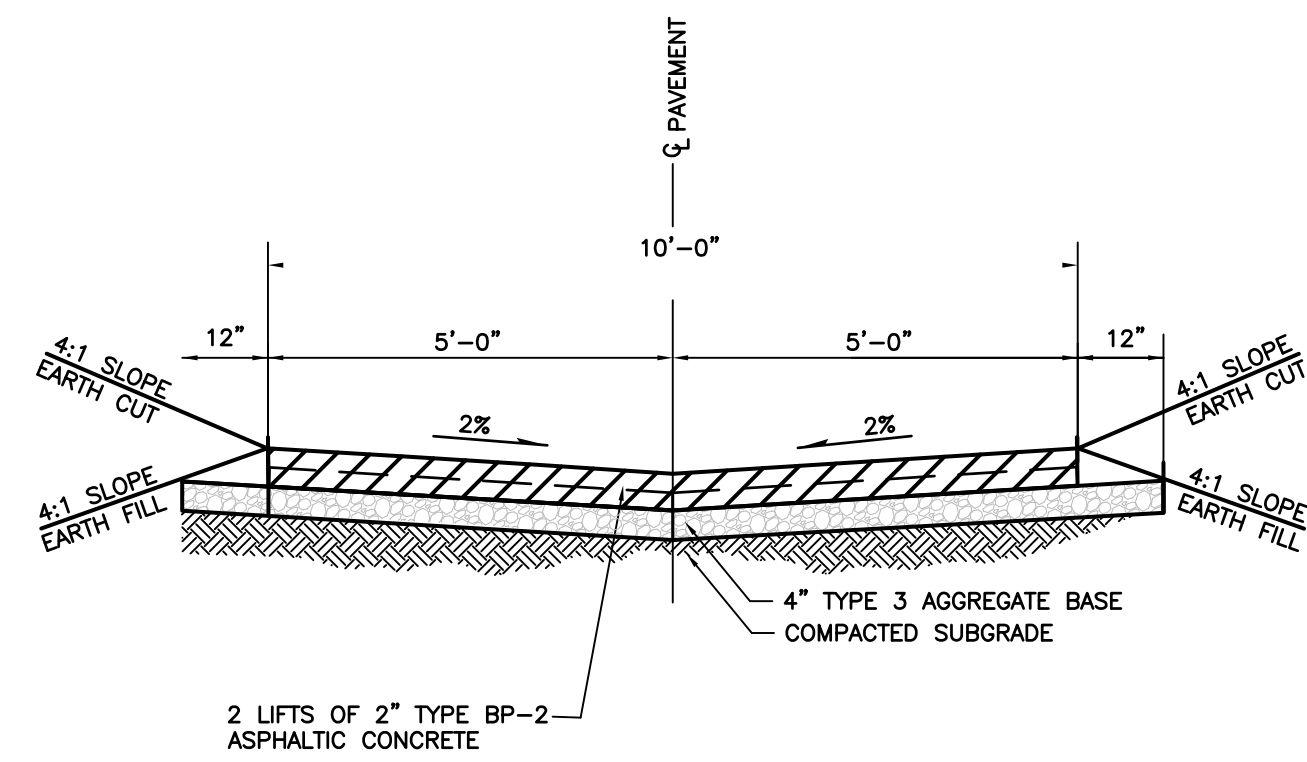

RESIDENTIAL STREET ALLEY
(Asphaltic Pavement)

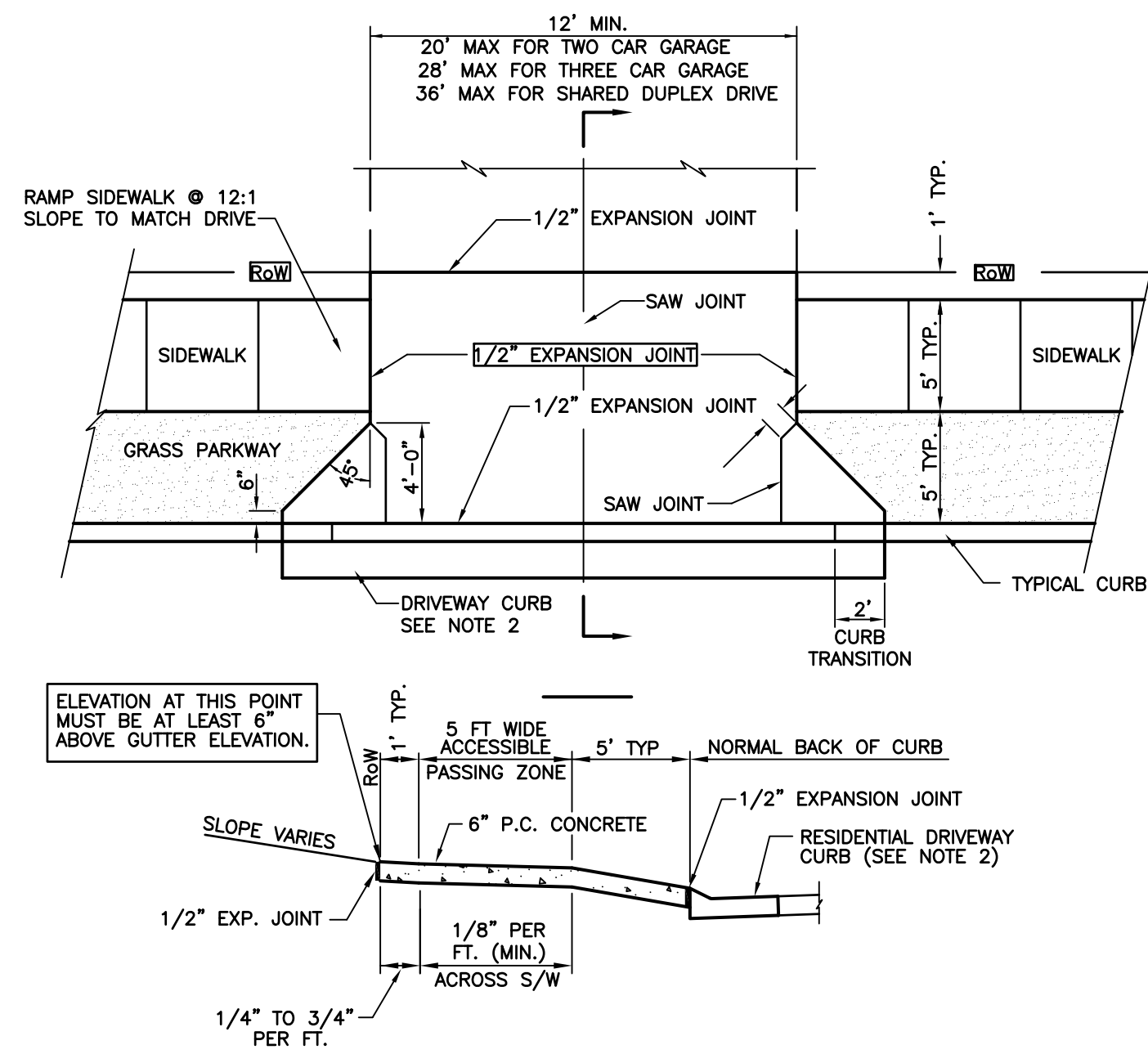

NOTE:

1. DRIVEWAY APPROACH SHALL BE 6" THICK M&DOT PAVEMENT CONCRETE ON COMPACTED SUBGRADE.
2. REPLACE STANDARD CURB & GUTTER SECTION WITH DRIVEWAY CURB SECTION. SEE DETAIL 400.02.
3. EXPANSION JOINT SHALL BE 1/2" PREFORMED CORK OR BITUMINOUS EXPANSION JOINT MATERIAL.
4. ALL DRIVEWAY APPROACHES SHALL SLOPE TOWARD THE STREET.
5. ALL DRIVEWAY APPROACHES SHALL BE CONSTRUCTED TO ACCOMMODATE SIDEWALKS. (EXISTING AND FUTURE) STANDARD SIDEWALK LOCATION IS 1 FT OFF OF ROW LINE
6. DRIVEWAY APPROACH SHALL PROVIDE A MINIMUM 5' WIDE ACCESSIBLE SIDEWALK PASSING ZONE.
7. DRIVEWAY SLOPE ACROSS ACCESSIBLE SIDEWALK PASSING ZONE IS 1/8" PER FT. CROSS SLOPE SHALL NOT EXCEED 2.00%.
8. MINIMIZE SIDEWALK WARPING ADJACENT TO DRIVEWAY APPROACH.
9. GREENSPACE SLOPE WITHIN RIGHT OF WAY SHALL NOT EXCEED 3/4" PER FOOT.
10. DRIVEWAY MAY BE REINFORCED AT OWNER'S OPTION. ON CITY BID PROJECTS DO NOT REINFORCE.
11. MEASURE FROM TOP OF CURB.

DRIVEWAY DETAIL-2
Sidewalk with Grass Parkway
NOT TO SCALE

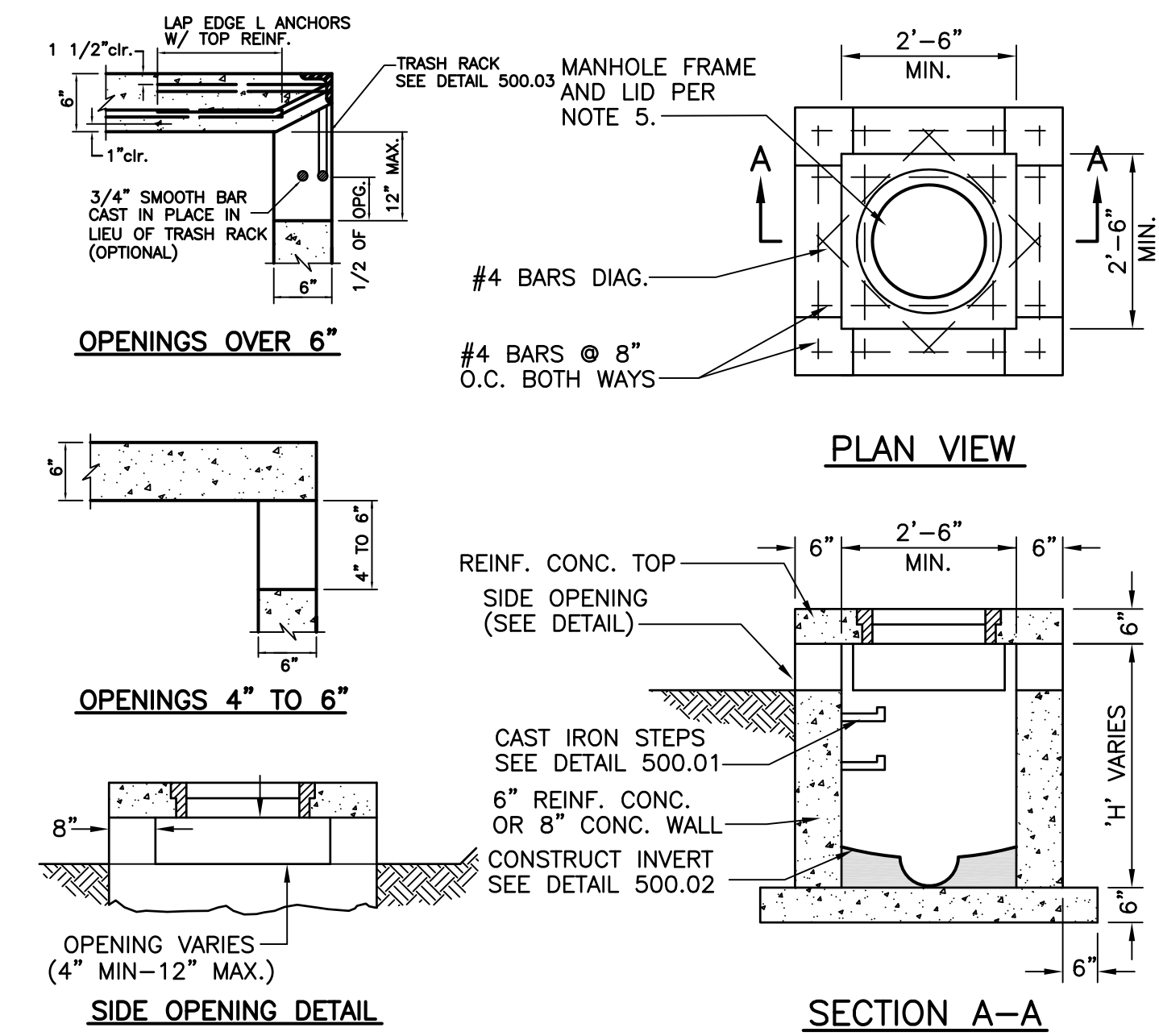

NOTES:

1. CONCRETE SHALL BE CLASS E FOR BASES AND D FOR WALLS AND TOP.
2. REINFORCING STEEL SHALL BE GRADE 60
3. INSTALL WEEP HOLES AS PER DETAIL 500.04
4. STRUCTURES WHERE H>8' SHALL BE REINFORCED CONCRETE (#4 BARS AT 12" CTRS, BOTH WAYS AND #4 BARS DIAGONAL AT PIPE OPENINGS)
5. FRAME AND LID SHALL BE NEENAH R-1960-A (TYPE C LID), DEETER 1180, OR APPROVED EQUAL. SEE DETAIL 500.01 FOR PLACEMENT.
6. SIDE OPENINGS TO BE ON ALL FOUR SIDES UNLESS NOTED OTHERWISE
7. INSTALL TRASH RACK ON OPENINGS OVER 6" SEE DETAIL 500.03

SIDE OPENING INLET

Revision	
By	
Date	
No.	

Third Avenue Alley
Details Sheet

City of Columbia, Missouri
Department of Public Works

David Allen Nichols
Registered Professional Engineer
E-24212

File No.	00734
Scale:	NONE
Date:	6/10/2019
Des.	A.A.A.
Dwn.	C.N.S.
Chk.	A.A.A.

o:\cadd\proj\street\third avenue alley restoration\storm\lsaz(6-18-19).dwg

2015 Orthophoto Source: Boone County Assessor

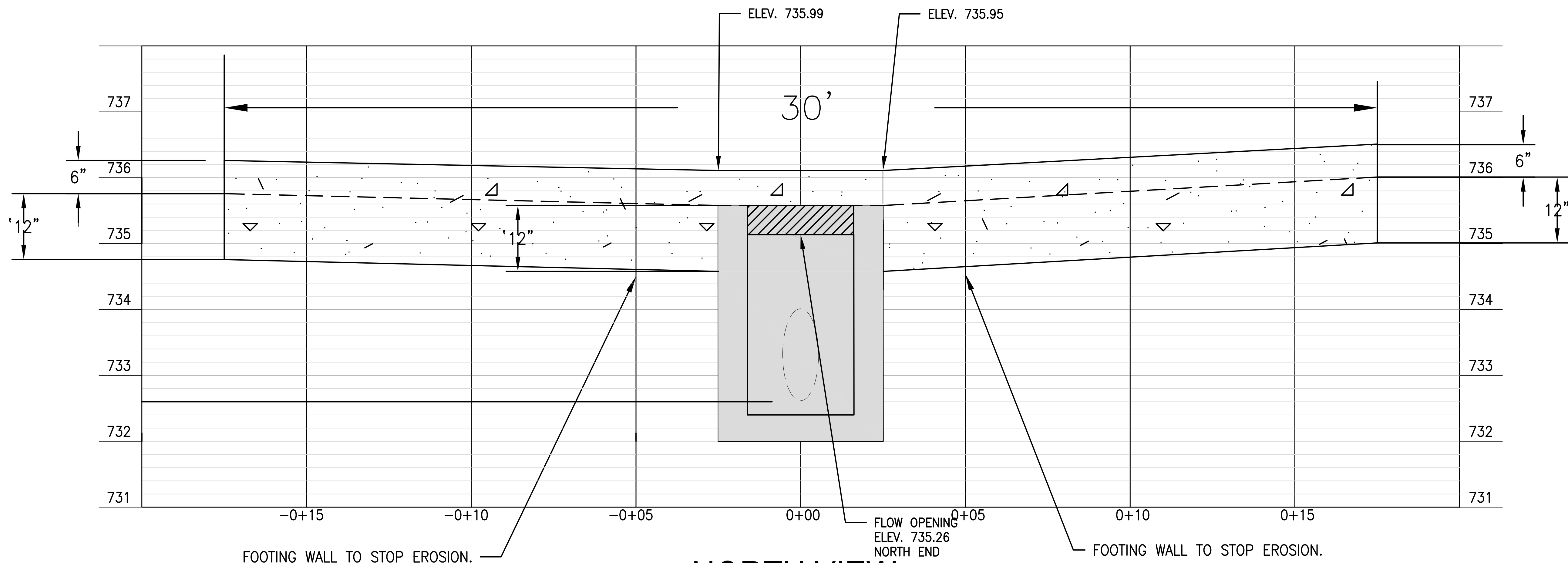

NORTH VIEW

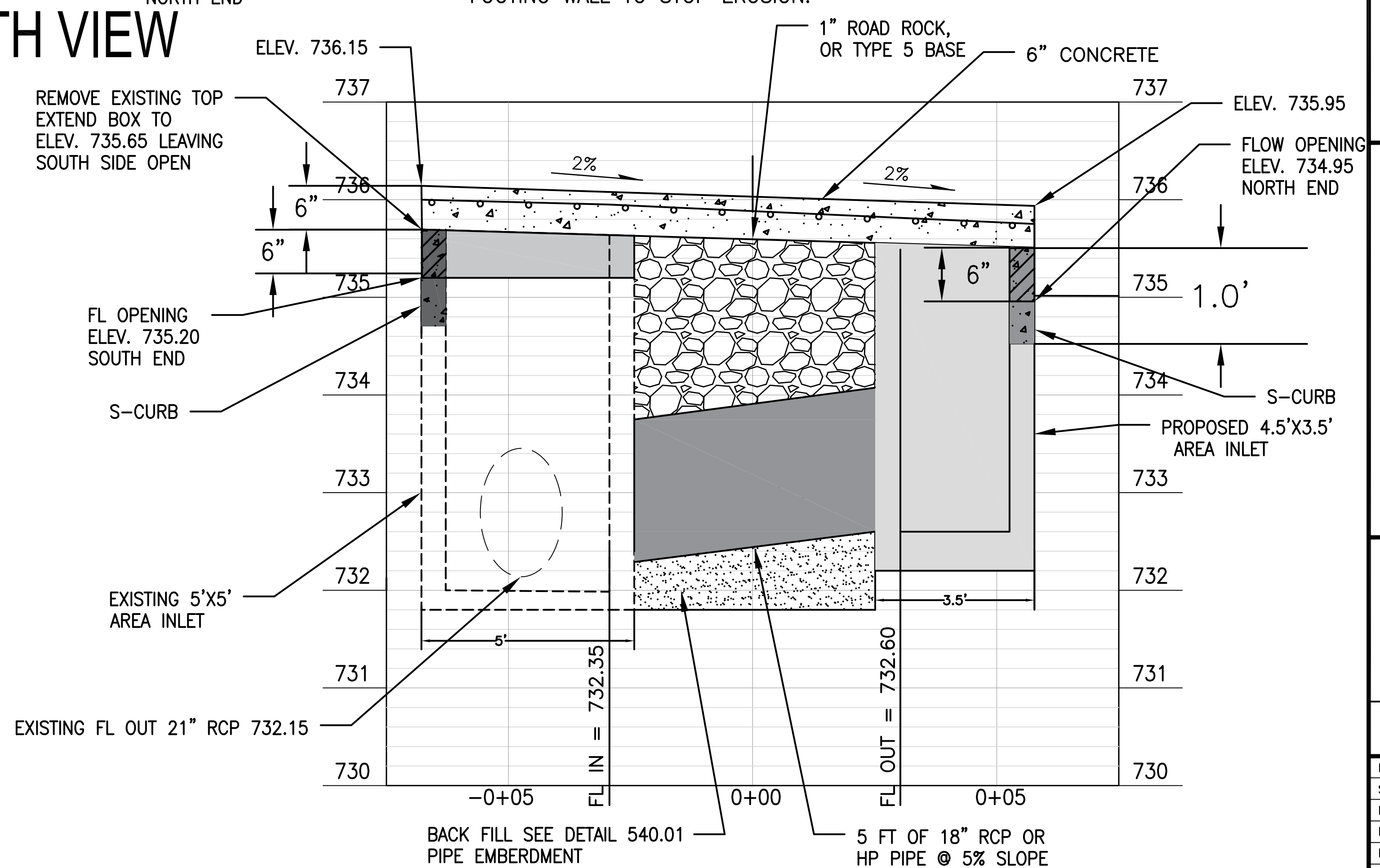
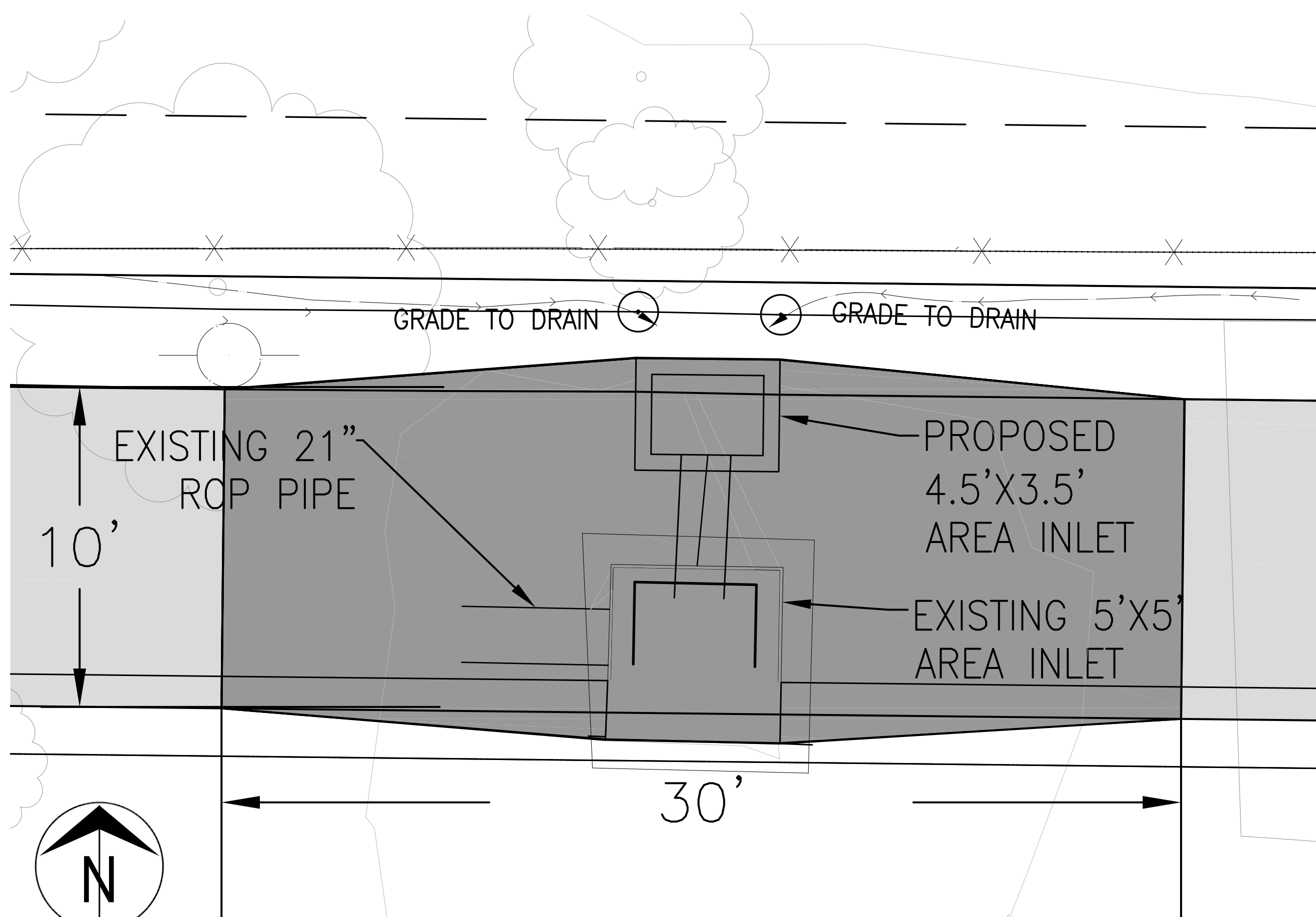

STORM PROFILE

Revision	By	Date	No.

THIRD AVENUE ALLEY
Storm Water Sheet

City of Columbia, Missouri
Department of Public Works

David Allen Nichols Registered Professional Engineer E-24212
File No. 00734
Scale: 1" = 3'
Date: 6/10/2019
Des. A.A.A.
Dwn. C.N.S.
Chk. A.A.A.

o:\cadd\proj\third avenue alley restoration\Design\third avenue alley restoration storm flow(6-18-19).dwg

2015 Orthophoto Source: Boone County Assessor

20 10 0 10 20

20 10 0 10 20

20 10 0 10 20

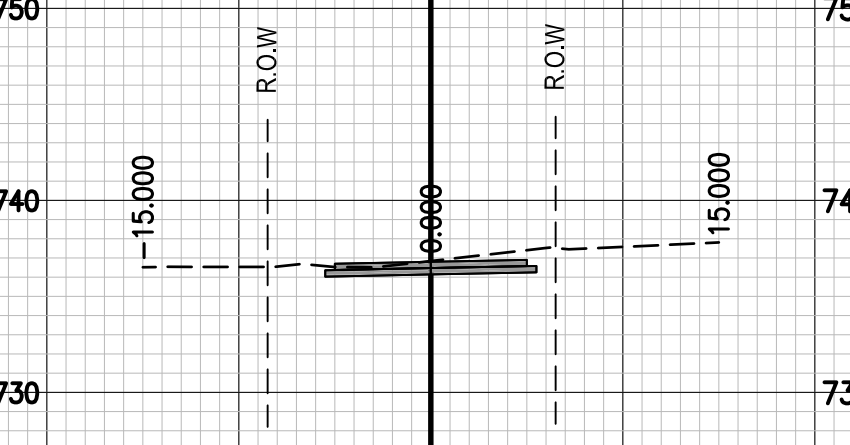
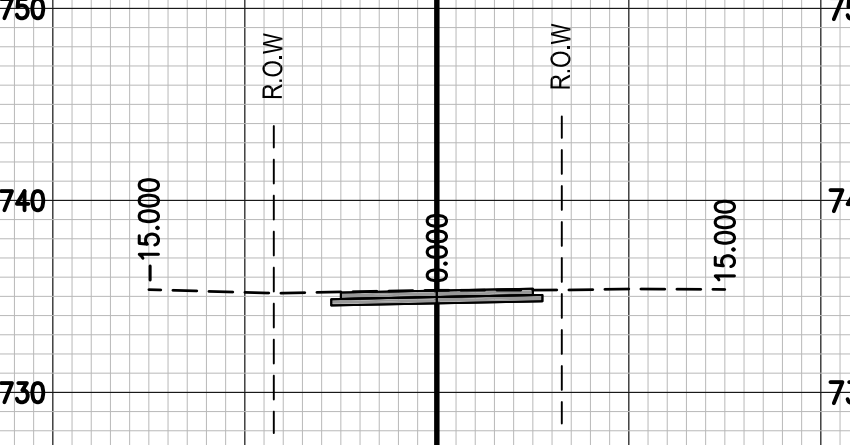
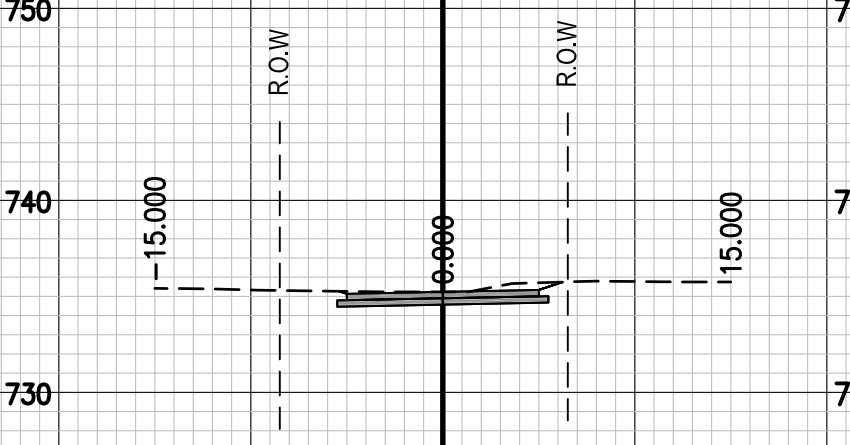
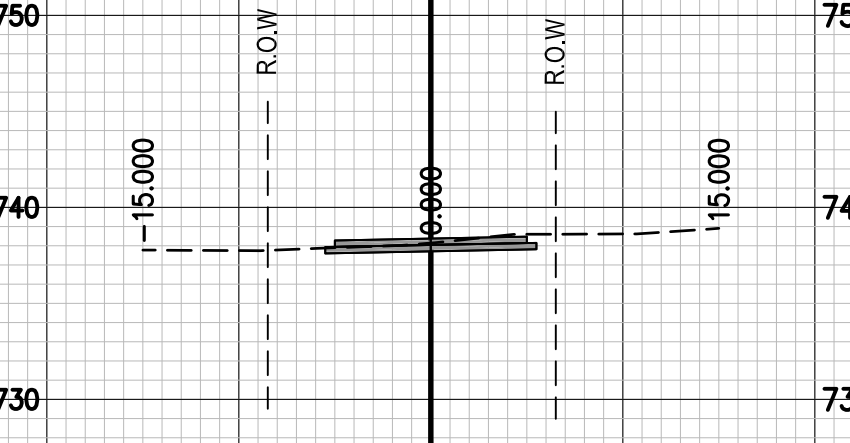
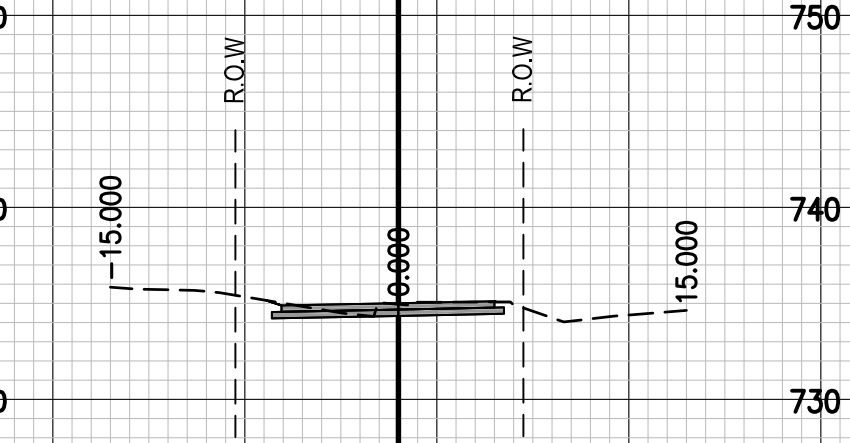
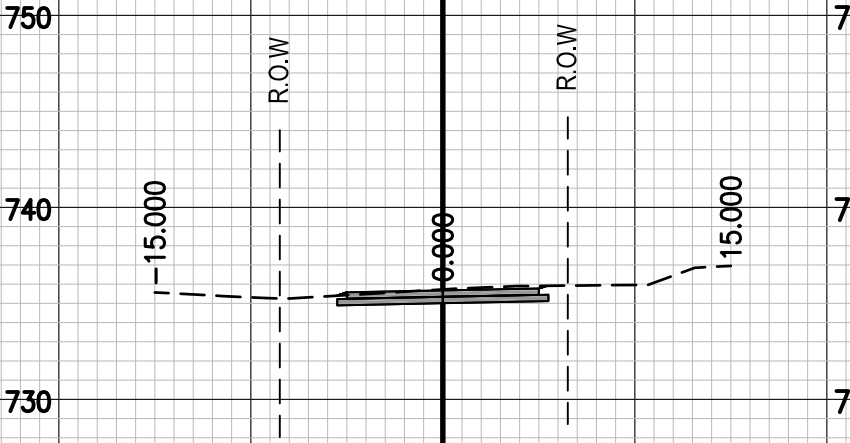
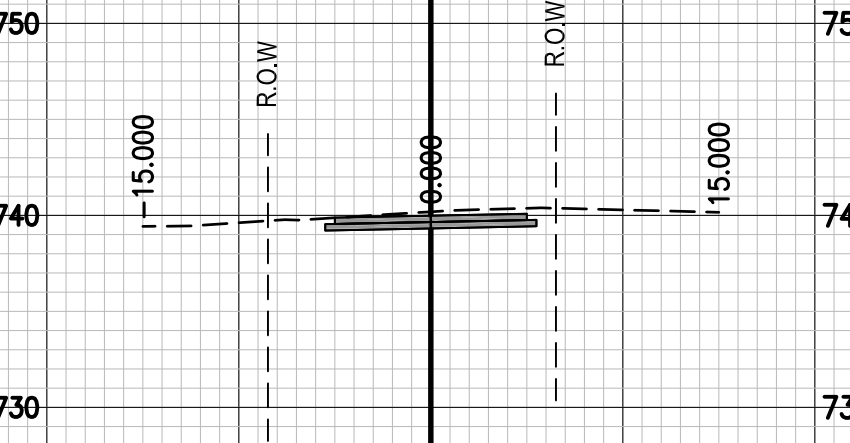
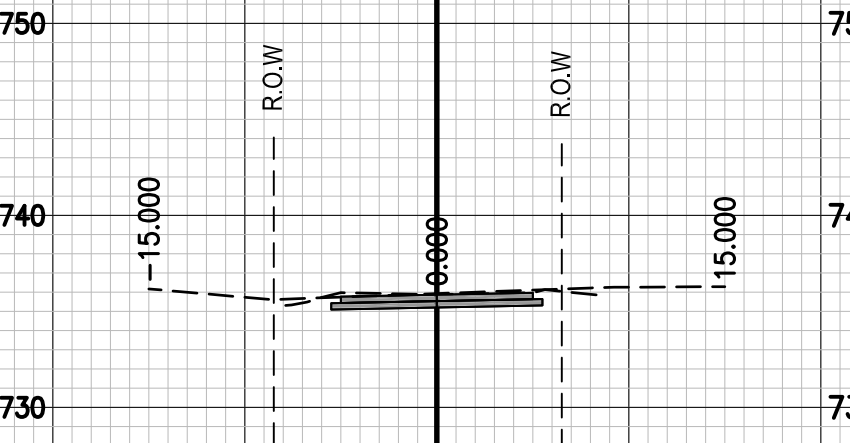
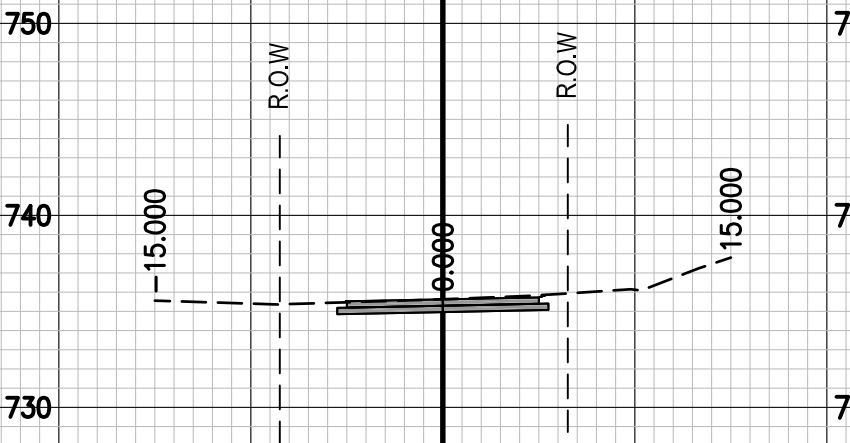

20 10 0 10 20

20 10 0 10 20

20 10 0 10 20

No.	Date	By	Revision

THIRD AVE. ALLEY RESTORATION
Cross Sections - Sta 0+00 to Sta 3+00

City of Columbia, Missouri
Department of Public Works

File No.	00734
Scale:	1"=10'
Date:	6/10/2019
Des.	AAA
Dwn.	C.N.S.
Chk.	AAA

c:\columbia\third_ave_alley_restoration\design\offset_third_ave_alley_restoration.dwg (Rev: 06-18-19) dwg

20 10 0 10 20

20 10 0 10 20

20 10 0 10 20

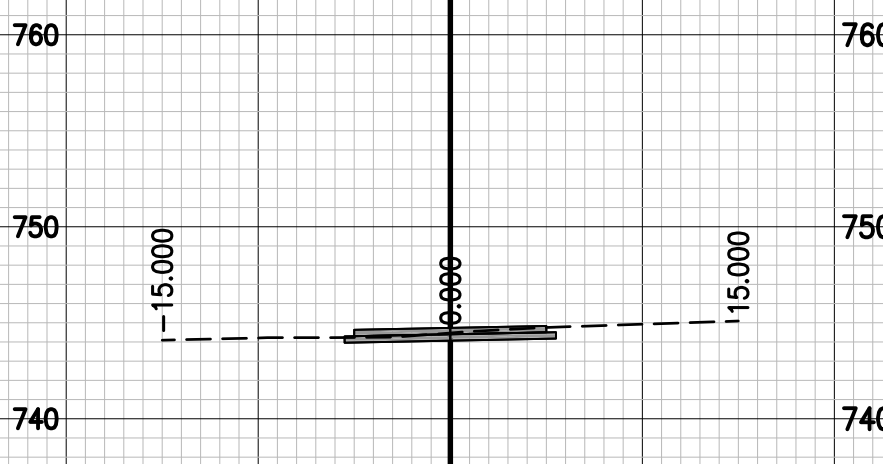

3+00

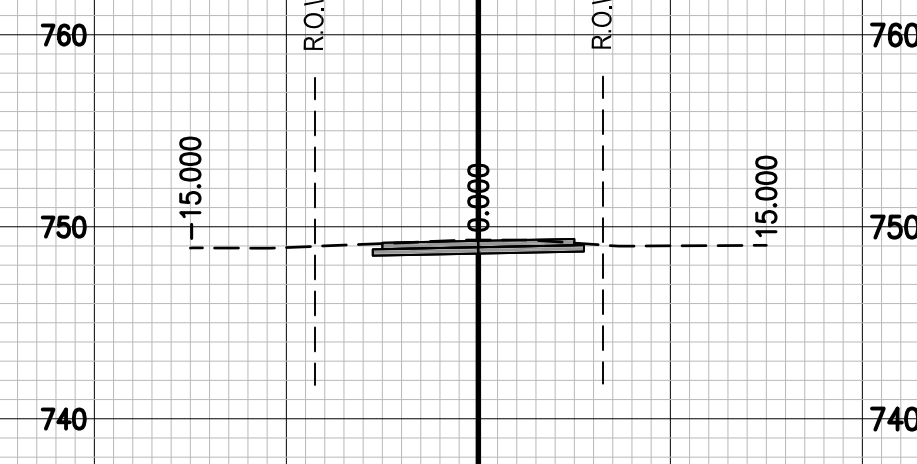

3+75

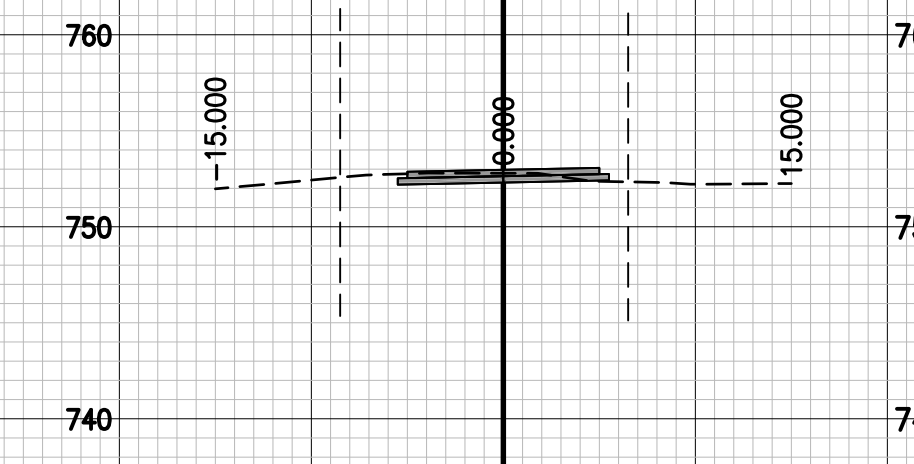

4+50

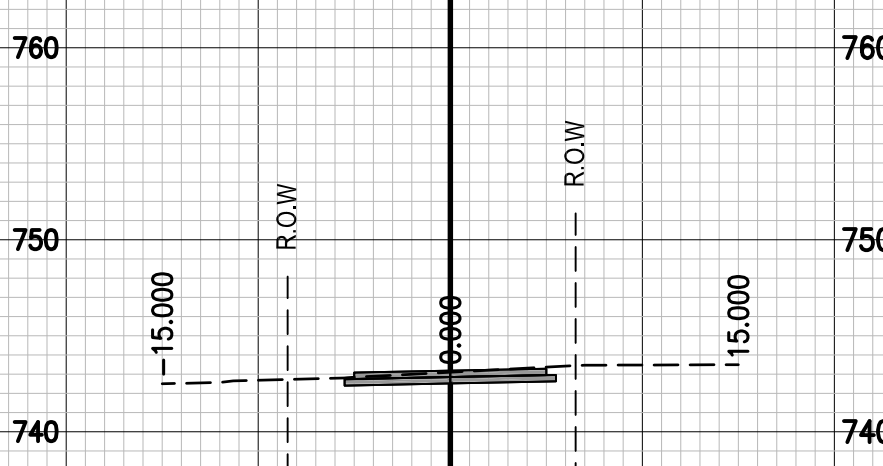

2+75

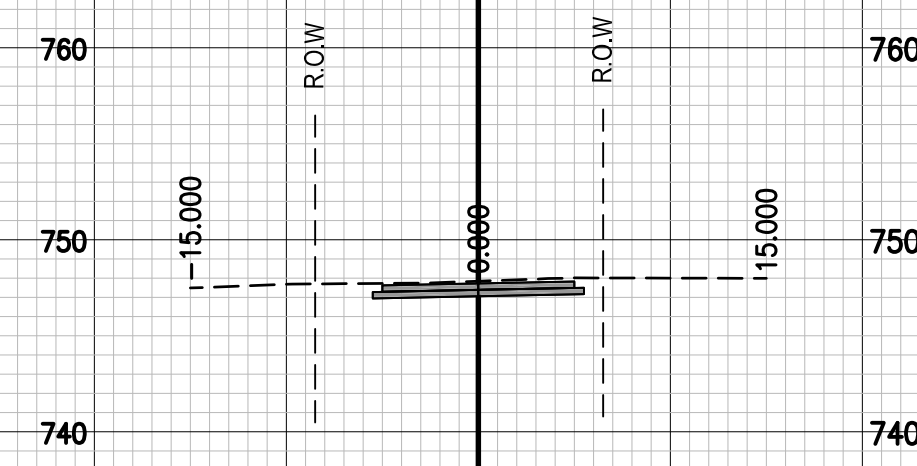

3+50

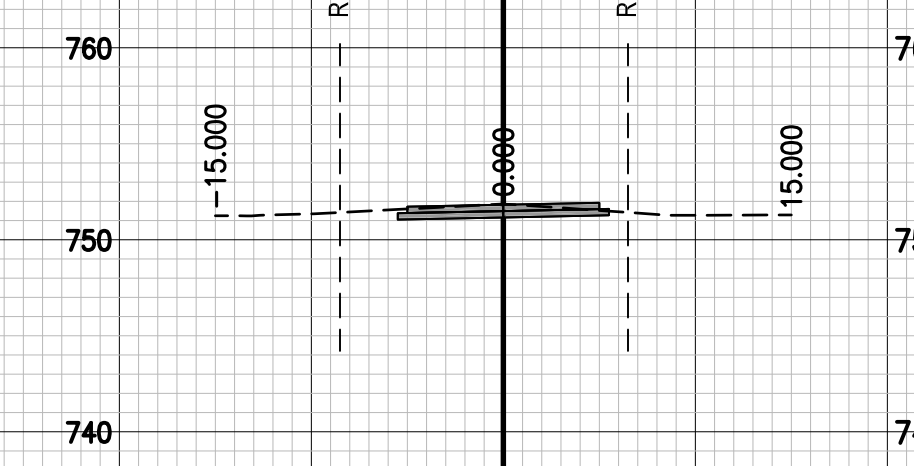

4+25

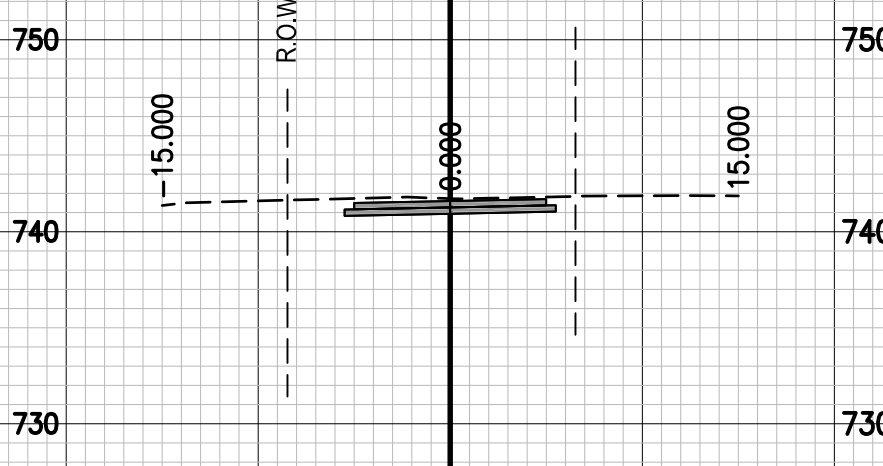

2+50

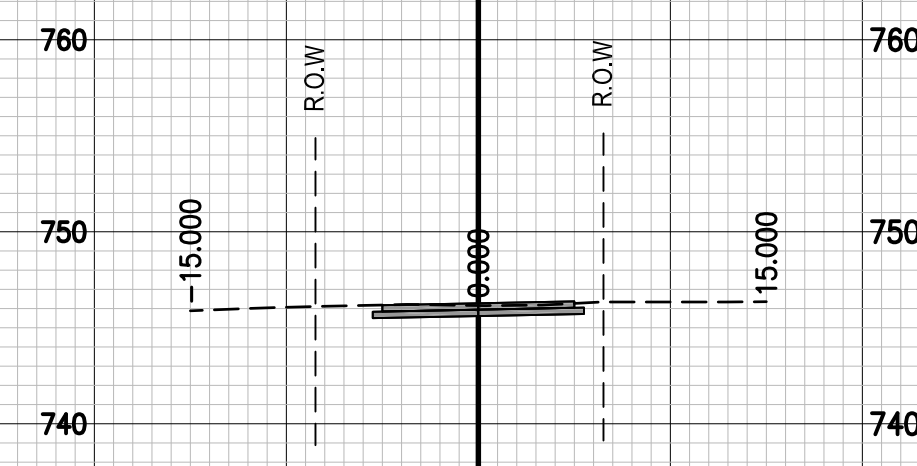

3+25

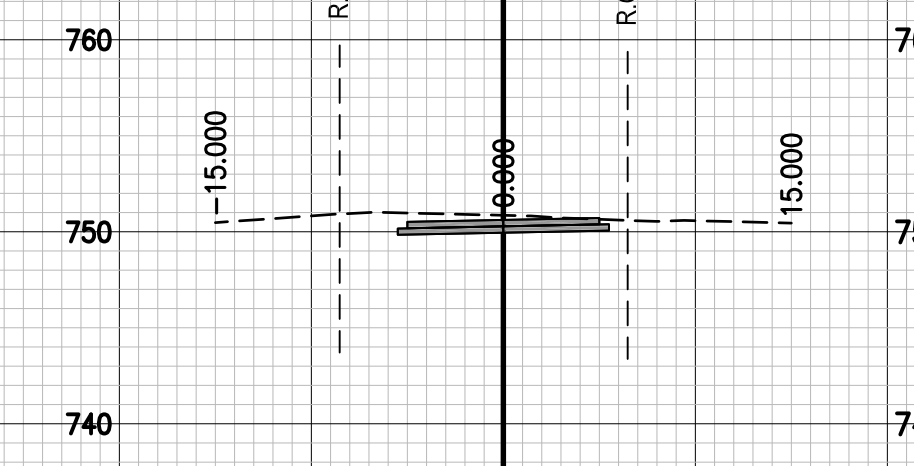

4+00

20 10 0 10 20

20 10 0 10 20

20 10 0 10 20

No.	Date	By	Revision

THIRD AVE. ALLEY RESTORATION
Cross Sections - Sta 2+50 to Sta 4+50

City of Columbia, Missouri
Department of Public Works

File No.	XX-XX-XX
Scale:	1"=10'
Date:	06/10/2019
Des.	AAA
Dwn.	C.N.S.
Chk.	AAA

c:\cadd\proj\third_ave_alley_restoration\design\offset_third_ave_alley_restoration.dwg (Thu 06-10-2019 10:48)

20 10 0 10 20

20 10 0 10 20

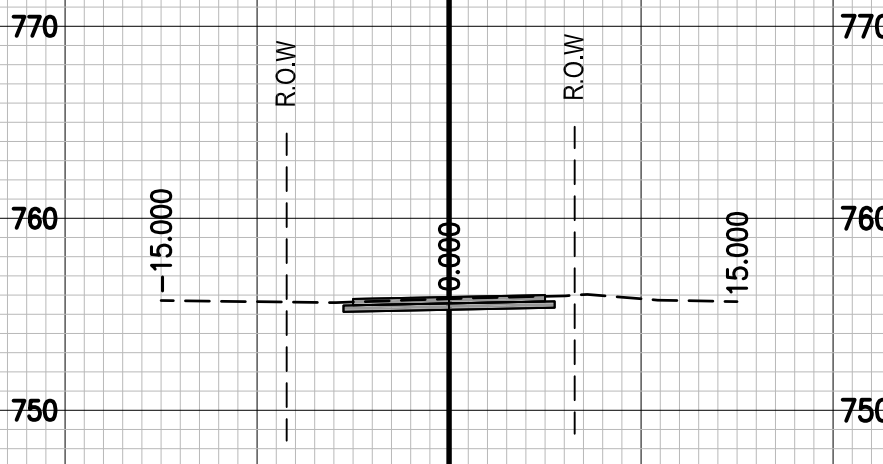

5+25

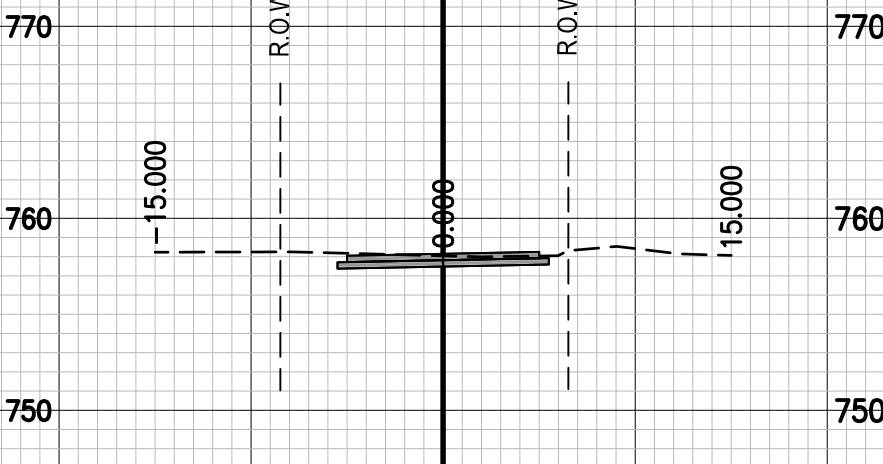

6+00

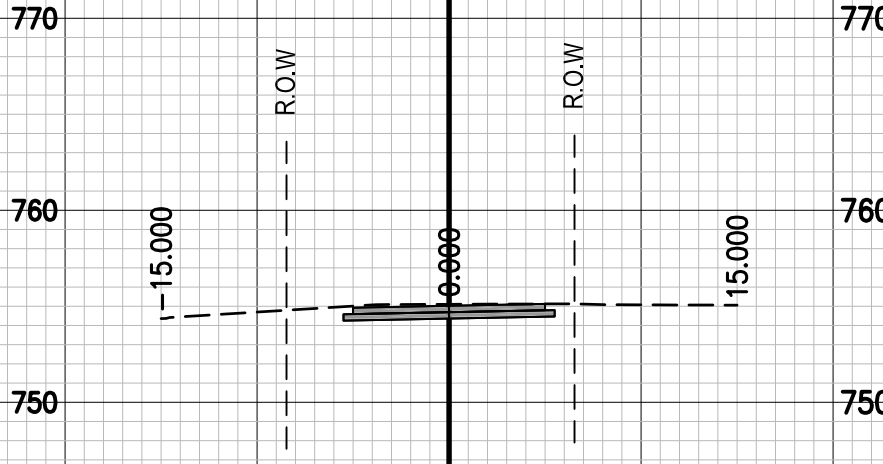

5+00

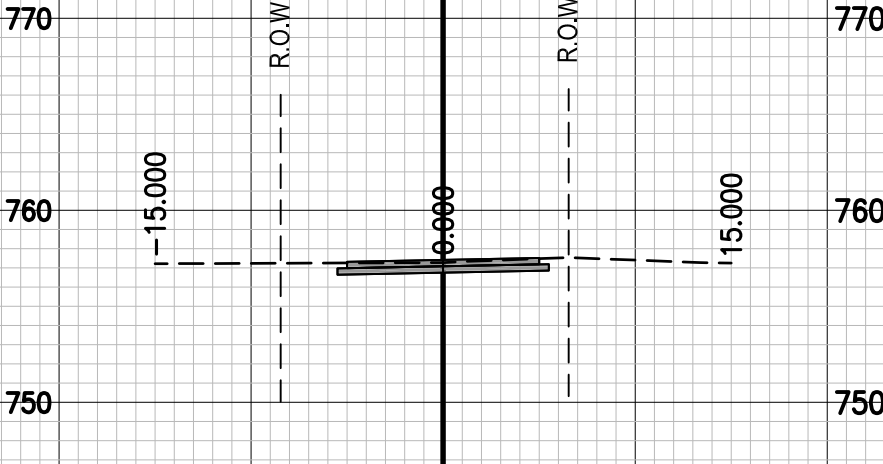

5+75

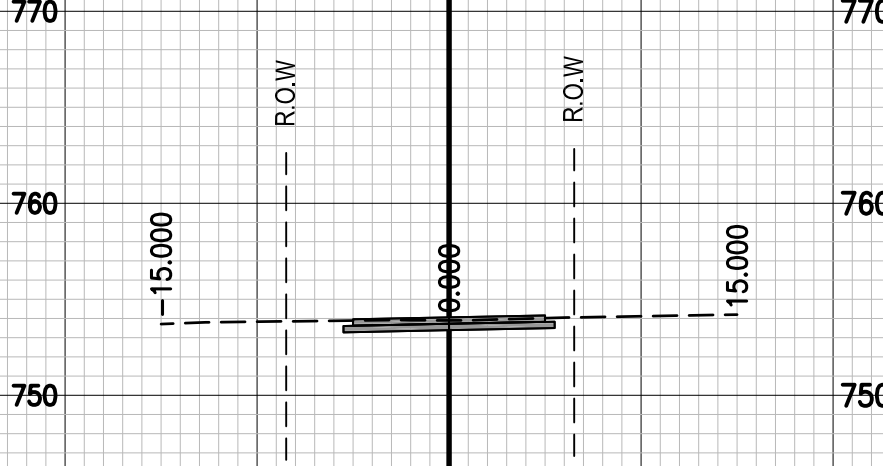

4+75

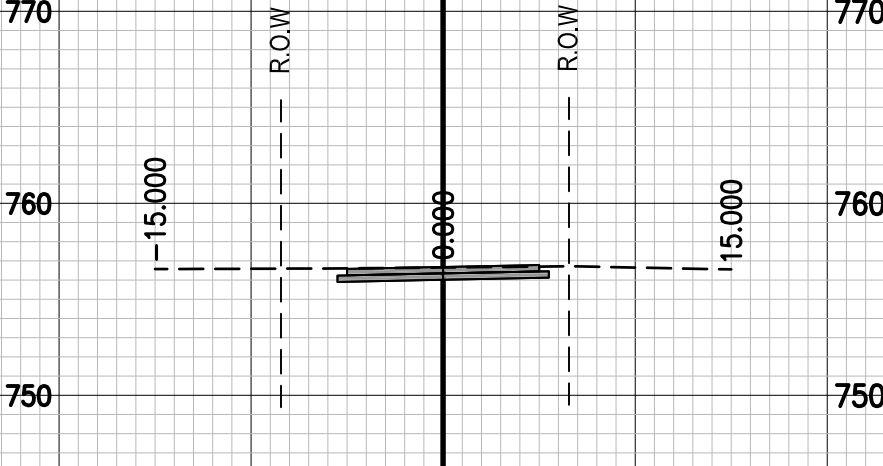

5+50

20 10 0 10 20

20 10 0 10 20

No.	Date	By	Revision

THIRD AVE. ALLEY RESTORATION
Cross Sections - Sta 4+75 to Sta 6+00

City of Columbia, Missouri
Department of Public Works

File No.	00734
Scale:	1"=10'
Date:	6/10/2019
Des.	A.A.A.
Dwn.	C.N.S.
Chk.	A.A.A.

c:\cadd\proj\third_ave_alley_restoration\design\offset_third_ave_alley_restoration.dwg (Thu 6/10/2019 10:49:13 AM)