

LOCATION MAP
Not To Scale

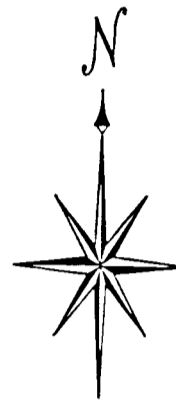

SCALE: 1"=40'

LEGEND

- S SET
- F FOUND
- DH DRILL HOLE
- PM PERMANENT MONUMENT
- 1/2" IRON ROD OR PIPE
- 5/8" OR LARGER IRON
- DRILL HOLE OR CHISEL +
- RIGHT OF WAY MARKER
- STONE MONUMENT
- CORNER POST
- FENCE LINE
- (91/387) BK/PG OF RECORD PLAT/SURVEY
- M MEASURED DISTANCE
- R RECORD DISTANCE

STREAM BUFFER STATEMENT

THIS TRACT DOES NOT INCLUDE ANY REGULATED STREAMS AS DEFINED BY THE CITY OF COLUMBIA STREAM BUFFER ORDINANCE AS DETERMINED BY THE USGS MAP FOR COLUMBIA QUADRANGLE, BOONE COUNTY, MISSOURI AND ARTICLE X OF CHAPTER 12A OF THE CITY OF COLUMBIA CODE OF ORDINANCES.

FLOOD PLAIN STATEMENT

NO PART OF THIS TRACT IS LOCATED WITHIN THE 1% ANNUAL CHANCE FLOOD PLAIN AS SHOWN BY THE FLOOD INSURANCE RATE MAP: COMMUNITY-PANEL #290019C0295E, DATED APRIL 19, 2017.

NOTES

1. THE BASIS OF BEARINGS IS THE WEST LINE OF LOT 501 OF DISCOVERY PARK SUBDIVISION PLAT 5 RECORDED IN PLAT BOOK 54, PAGE 47 OF THE BOONE COUNTY RECORDS.
2. THIS SURVEY WAS EXECUTED TO COMPLY WITH THE ACCURACY STANDARDS FOR AN URBAN CLASS PROPERTY OCTOBER 2020
3. ALL IRONS FOUND AND SET ARE 1/2" UNLESS NOTED.
4. ALL IRONS ARE TO BE SET AT THE END OF CONSTRUCTION OR WITHIN 12 MONTHS OF RECORDED SURVEY.
5. PER SECTION 29-17(d.8.a), ALL MAINTENANCE OF THE PRIVATE STREETS SHOWN ON THIS PLAT SHALL BE THE RESPONSIBILITY OF THE OWNERS ASSOCIATION OR ADJUTING PROPERTY OWNERS. NO PRIVATE STREETS SHALL BE DEDICATED TO NOR ACCEPTED BY THE CITY FOR MAINTENANCE UNTIL THEY HAVE BEEN IMPROVED TO MINIMUM CITY STANDARDS FOR PUBLIC STREETS.
6. ONLY THE RECORDED DOCUMENTS REFERENCED HEREON WERE PROVIDED TO OR DISCOVERED BY THE SURVEYOR. NO ABSTRACT, CURRENT TITLE POLICY/COMMITMENT/REPORT OR OTHER RECORD TITLE DOCUMENTATION WAS PROVIDED TO SURVEYOR.

KNOW ALL MEN BY THESE PRESENTS

"ENDEAVOR CENTER LLC", A LIMITED LIABILITY COMPANY, IS THE SOLE OWNER OF THE HEREON DESCRIBED TRACT AND THAT SAID LIMITED LIABILITY COMPANY HAS CAUSED SAID TRACT TO BE SURVEYED, SUBDIVIDED, AND PLATTED AS SHOWN HEREON; SAID LIMITED LIABILITY COMPANY DOES HEREBY ACKNOWLEDGE SAID INSTRUMENT TO BE THE FREE ACT AND DEED OF SAID CORPORATION.

ANY UTILITY EASEMENTS AND ADDITIONAL RIGHT OF WAY AT THE LOCATIONS SHOWN ON THE PLAT, ARE HEREBY DEDICATED TO THE CITY OF COLUMBIA FOR PUBLIC USE, FOREVER.

ENDEAVOR CENTER LLC.

TITLE: _____ (SIGNED)

JONATHAN OOLE _____ (PRINTED)

SUBSCRIBED AND SWORN BEFORE ME ON THIS 17th DAY OF November, 2020. MY COMMISSION EXPIRES December 17, 2021.

BRIAN PATRICK MAENNER
Notary Public, Notary Seal
State of Missouri
Boone County
Commission # 19220933
My Commission Expires 12-19-2022

NOTARY PUBLIC

SUBSCRIBED AND SWORN BEFORE ME ON THIS 17TH DAY OF NOVEMBER, 2020 MY COMMISSION EXPIRES MAY 30, 2021.

DEREK FORBIS
Notary Public, Notary Seal
State of Missouri
Howard County
Commission # 13803612
My Commission Expires 05-30-2021

DEREK FORBIS
NOTARY PUBLIC

THIS IS TO CERTIFY THAT AT THE REQUEST OF ENDEAVOR CENTER LLC, A SURVEY WAS EXECUTED UNDER MY PERSONAL SUPERVISION AND I HEREBY DECLARE THAT TO THE BEST OF MY KNOWLEDGE AND BELIEF, THIS SURVEY WAS EXECUTED IN ACCORDANCE WITH THE CURRENT MISSOURI STANDARDS FOR PROPERTY BOUNDARY SURVEYS. THE RESULTS ARE REPRESENTED ON THIS PLAT OF SURVEY.

ANTHONY DERBOVEN, P.L.S. 2016019005
Date: NOVEMBER 17, 2020.

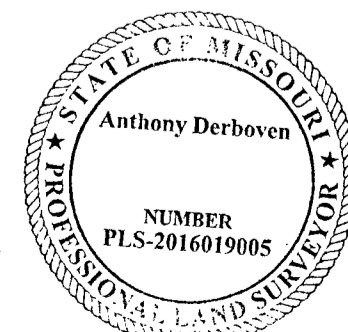

APPROVED BY THE CITY COUNCIL PURSUANT TO ORDINANCE # _____ ON THE _____ DAY OF _____, 20__

BRIAN TREECE, MAYOR

ATTEST:
SHEELA AMIN, CITY CLERK

FINAL PLAT OF
DISCOVERY PARK SUBDIVISION PLAT 5A
A REPLAT OF LOT 501 OF DISCOVERY PARK SUBDIVISION PLAT 5,
RECORDED IN PLAT BOOK 54, PAGE 47
LOCATED IN THE WEST HALF (W 1/2) OF SECTION 33 AND THE EAST HALF (E 1/2) OF SECTION 32, TOWNSHIP 48 NORTH, RANGE 12 WEST BOONE COUNTY, MISSOURI

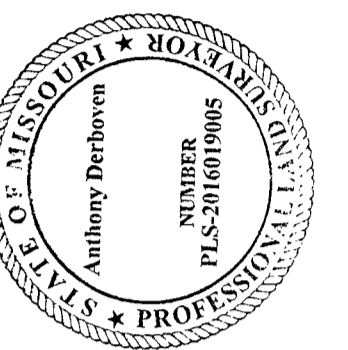

Anthony Derboven
ANTHONY DERBOVEN, P.L.S. 2016019005
Date: NOVEMBER 17, 2020.

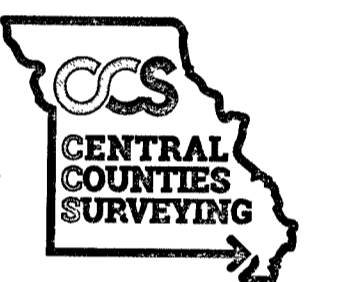

401 S. Cleveland St.
Fayette, MO 65248
Phone (650) 728-6028
Missouri Commission # 2014035993
Steven R. Proctor P.L.S. # 2000148666
Anthony Derboven P.L.S. # 2016019005

ENDEAVOR CENTER LLC.
3531 ENDEAVOR AVE.
Columbia, Boone County, MO

Plotted: 11/17/2020

SHT. 1 OF 01

