

# City of Columbia, Missouri

## Department of Public Works



# KEENE STREET & I-70 DRIVE SOUTHEAST ROUNDAABOUT

## INTERSECTION IMPROVEMENTS 30% PLANS

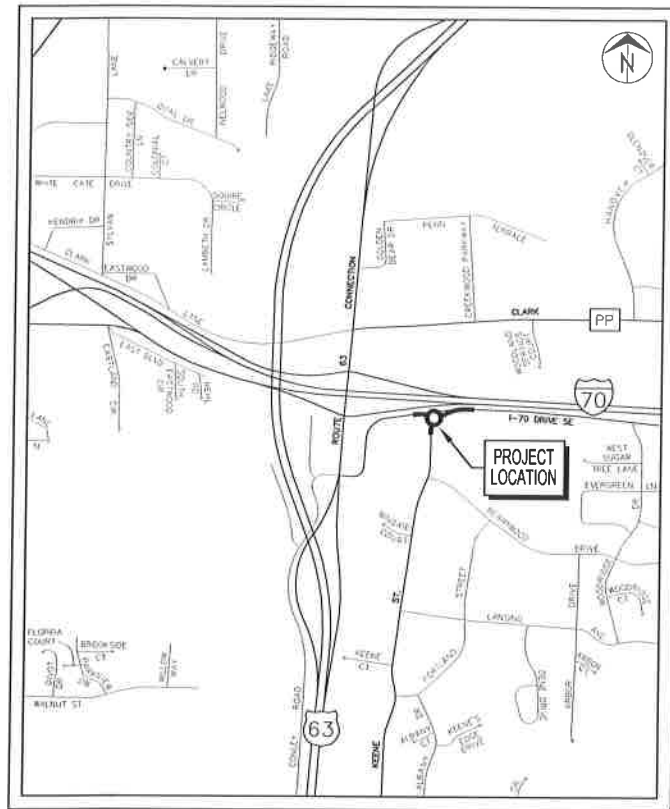

LOCATION MAP

### LEGEND OF SYMBOLS

POWER POLE	
TELEPHONE POLE	
GUY ANCHOR	
GUY POLE	
STREET LIGHT POLE	
YARD LIGHT (SOLAR)	
WATER METER	
GAS METER	
GAS VALVE	
WATER VALVE	
FIRE HYDRANT	
PIPE BREAKLINE	
SANITARY MANHOLE	
SANITARY CLEANOUT	
SANITARY LATERAL CLEANOUT	
TRAVERSE POINT	
MoDOT ROW MARKER	
BENCHMARK	
SIGN	
MAIL BOX	
PROPERTY IRON	
BUSH	
STUMP	
TREE REMOVAL	
TREE	
TREE LINE	
SILT FENCE/TREE PROTECT	
EXISTING PUBLIC SANITARY SEWER	
EXISTING SANITARY SEWER LATERAL	
EXISTING SANITARY SEWER TO BE ABANDONED	
PROPOSED SEWER MAIN AND LATERALS	
FENCE	
CABLE TELEVISION	
TELEPHONE	
ELECTRIC	
TELEPHONE OR ELECTRIC MANHOLE	
WATER MAIN	
GAS MAIN	
FIBER OPTIC	
FLOW LINE	
PROPERTY LINE	
LOT LINE	
EXISTING RIGHT OF WAY LINE	
EXISTING EASEMENT	
PERMANANT UTILITY EASEMENT	
PROPOSED SANITARY SEWER EASEMENT	
PROPOSED PERMANENT DRAINAGE EASEMENT	
PROPOSED RIGHT OF WAY	
TEMPORARY ACCESS EASEMENT	
TEMPORARY CONSTRUCTION EASEMENT	
GRADING LIMIT	

### GENERAL NOTES

- All construction to be in accordance with "City of Columbia Street, Storm and Sanitary Specifications" (Current edition).
- Known underground utilities are shown in their approximate locations. Other utilities may exist.
- All removal of driveway pavements should be verified by field engineer.
- All excavation to be in accordance with Sections 319.010-319.050, Revised Statutes of the State of Missouri. Such compliance shall not, however, excuse any person making any excavation from doing so in a careful and prudent manner, nor shall it excuse such person from liability for any damage or injury to underground utilities resulting from the excavation.
- All RCP is Class III unless otherwise indicated.
- All disturbed earth areas shall be restored as per TS-\_\_\_ Seeding and TS-\_\_\_ Erosion Control.
- Remove all pavement surfaces, inlets, pipes and sidewalks within the construction limits as per TS-\_\_\_, except those noted to remain. The field inspector shall verify removal of all driveway pavement.
- Removal of trees and bushes shall be verified by field inspectors. Exercise caution when working near the construction limits to minimize disturbance to adjacent trees and shrubs that are not being removed by construction activities.
- Backfill of reinforced concrete pipe shall be 1 inch clean rock or soil compacted to 95 percent of standard proctor density as per TS-\_\_\_.
- No open trenches will be allowed overnight outside of the "road closed" area. Asphaltic "cold mix" shall be used as a temporary patch overnight. Temporary patching shall be considered incidental to the work.

### UTILITY COMPANIES:

**TELEPHONE**  
CenturyLink  
825 Cherry Street  
Columbia, MO 65205  
573-886-3505

**NATURAL GAS**  
Ameren Missouri  
2001 Maguire Boulevard  
Columbia, MO 65201  
573-876-3063

**CABLE TELEVISION**  
Mediacom  
901 N. College Avenue  
Columbia, MO 65201  
573-443-1536 ext 354

**LOCATES**  
Missouri One Call Inc.  
1022 B Northeast Drive  
Jefferson City, MO 65109  
1-800-344-7483

**WATER**  
City of Columbia  
P.O. Box 6015  
Water & Light Department  
Columbia, MO 65205  
573-874-7301

**ELECTRIC**  
City of Columbia  
P.O. Box 6015  
Water & Light Department  
Columbia, MO 65205  
573-874-7301

**SANITARY SEWER**  
City of Columbia  
P.O. Box 6015  
Public Works Department  
Columbia, MO 65205  
573-874-7250

**ELECTRIC (county)**  
Boone Electric Cooperative  
1413 Range Line Street  
Columbia, MO 65201  
573-449-4181 ext 231

### INDEX OF SHEETS

Description	Sheet No.
Cover Sheet	1
Typical Sections	2
Plan / Profile Sheets	3-4

<b>City of Columbia, Missouri</b> Department of Public Works			
No.	Date	By	Revision
File No. 32-01-14	Des. A.N.H.	Sheet	David Allen Nichols Registered Professional Engineer E-24212
Scale: None	Dwn. J.L.H.	1 of 4	
Date: 6/09/17	Chk. A.A.A.		
<b>KEENE ST. &amp; I-70 DR. SE ROUNDAABOUT</b>			
Approved By _____			
Director of Public Works		Date	

C:\cadd\proj\11000\11000.dwg, 11-20-17, 11:44:00 AM, 11/20/17, 11:44:00 AM

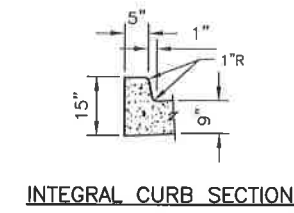
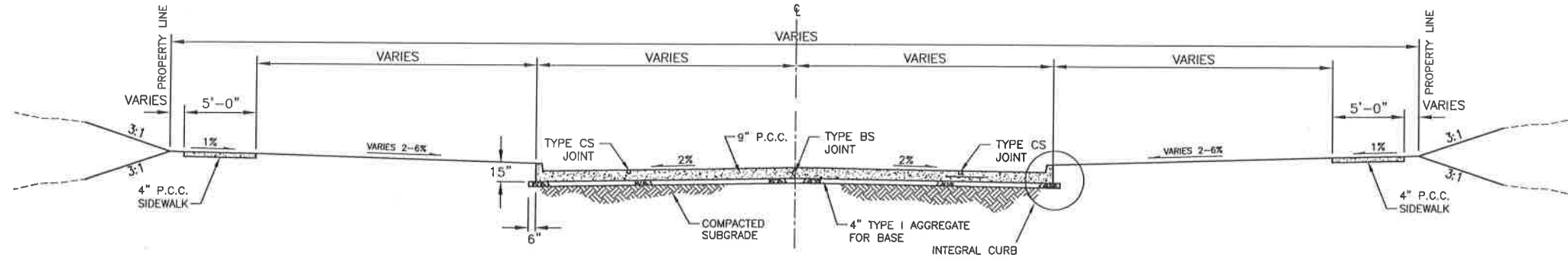

**KEENE STREET AND I-70 SE  
TYPICAL CROSS SECTION  
(NOT TO SCALE)**

**NOTE:**  
SEE PLAN AND CROSS SECTION SHEETS FOR SPECIFIC  
LOCATIONS OF PAVEMENT AND SIDEWALKS, AND VARIATIONS.

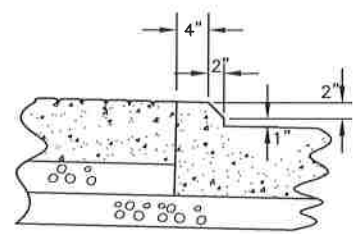
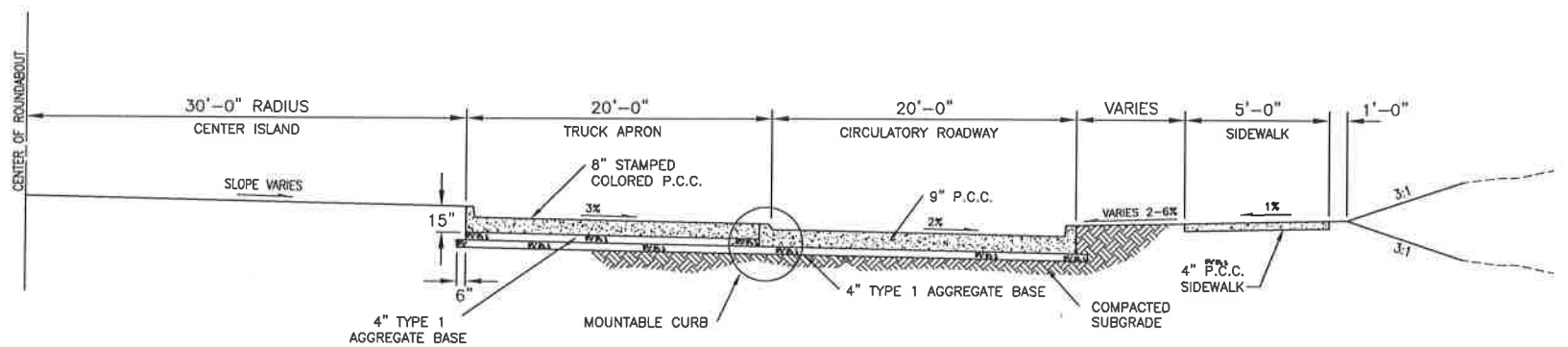

**ROUNDBOUT CIRCULATORY ROADWAY  
TYPICAL CROSS SECTION  
(NOT TO SCALE)**

**MOUNTABLE CURB DETAIL**

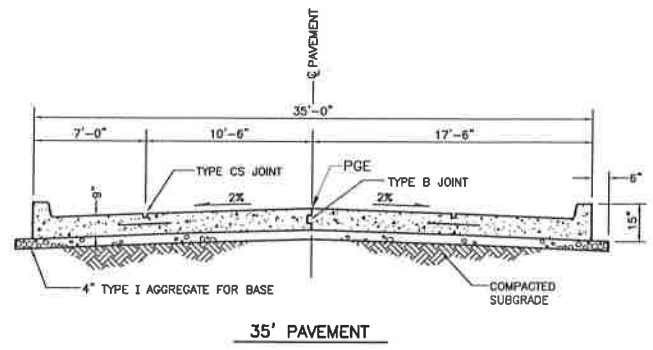

- NOTES:**
1. ALL P.C. CONCRETE SHALL BE CLASS A.
  2. INSTALL TYPE A EXPANSION JOINTS AT MAXIMUM 500 FT. SPACING AND AT INTERSECTIONS AS SHOWN ON THE JOINT DETAILS.
  3. SEE DETAIL 200.01 FOR JOINT DETAILS.

**9" P.C. CONCRETE PAVEMENT  
(NOT TO SCALE)**

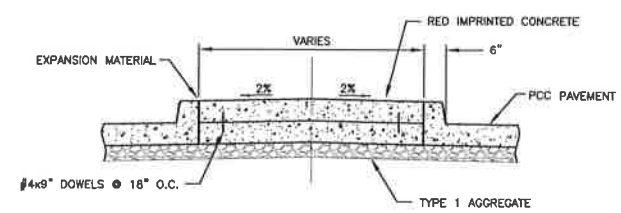

**SPLITTER ISLAND BARRIER CURB  
(NOT TO SCALE)**

Revision	
By	
Date	
No.	

**KEENE ST. & I-70 DR. SE ROUNDABOUT**  
Typical Sections

City of Columbia, Missouri  
Department of Public Works

David Allen Nichols  
Registered Professional Engineer  
E-24212

File No. 32-01-14  
Scale: 1" = 20'  
Date: 6/09/17  
Des. AN.H.  
Dwn. J.L.H.  
Chk. A.A.A.

o:\addbys\jlr\res\keene & i-70 drive & intersection 220114\aspc\img\img.dwg

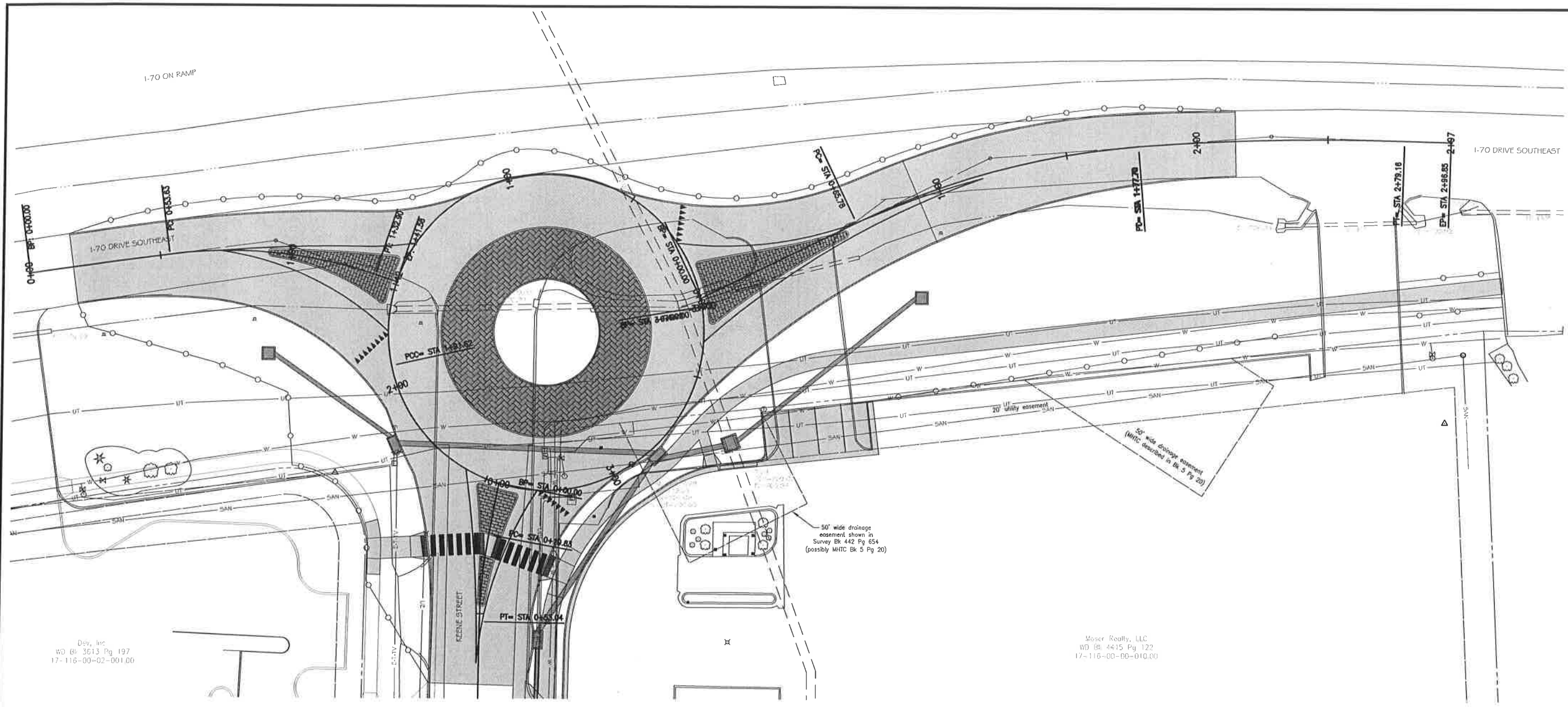

Dev, Inc  
 WD BK 3613 Pg 197  
 17-116-00-02-001.00

Moser Realty, LLC  
 WD BK 4415 Pg 122  
 17-116-00-00-010.00

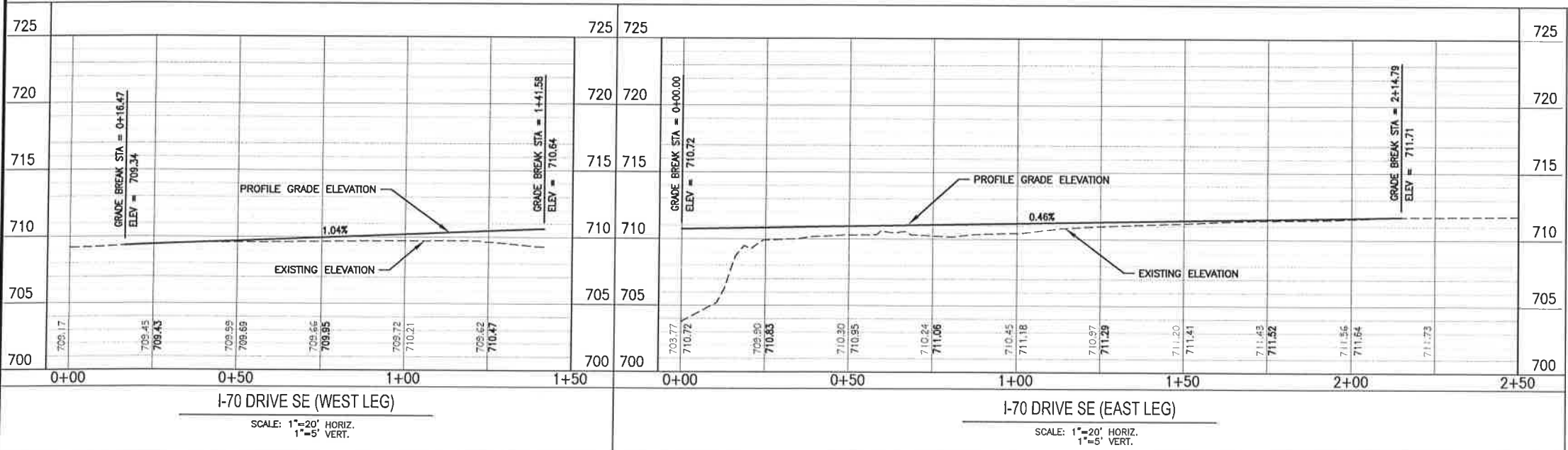

CONTRACTOR TO VERIFY  
 UNDERGROUND UTILITIES  
 DEPTH & LOCATION

ALL TREES, BUSHES AND SHRUBS LOCATED WITHIN THE GRADING LIMITS CAN BE REMOVED ONLY IF NECESSARY TO FACILITATE CONSTRUCTION. CHECK THE PLAN SHEETS FOR TREES AND SHRUBS SPECIFICALLY NOTED EITHER "DO NOT DISTURB" OR MARKED WITH A BOLD "X" TO BE REMOVED. THE CONTRACTOR SHALL USE CARE TO MINIMIZE THE IMPACT TO AND THE REMOVAL OF TREES. THE CONSTRUCTION INSPECTOR SHALL VERIFY ALL REMOVALS.

No.	Date	By	Revision

**KEENE ST. & I-70 DR. SE ROUNDABOUT**  
 Plan & Profile - Sta. XX+XX to Sta. XX+XX

City of Columbia, Missouri  
 Department of Public Works

David Allen Nichols  
 Registered Professional Engineer  
 E-24212

File No. 32-01-14  
 Scale: 1" = 20'  
 Date: 6/09/17  
 Des. A.N.H.  
 Dwn. J.L.H.  
 Chk. A.A.A.

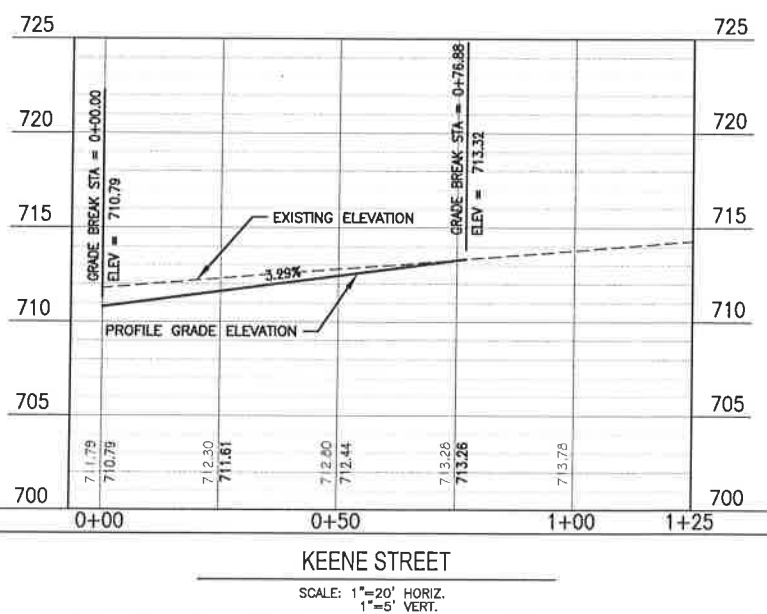
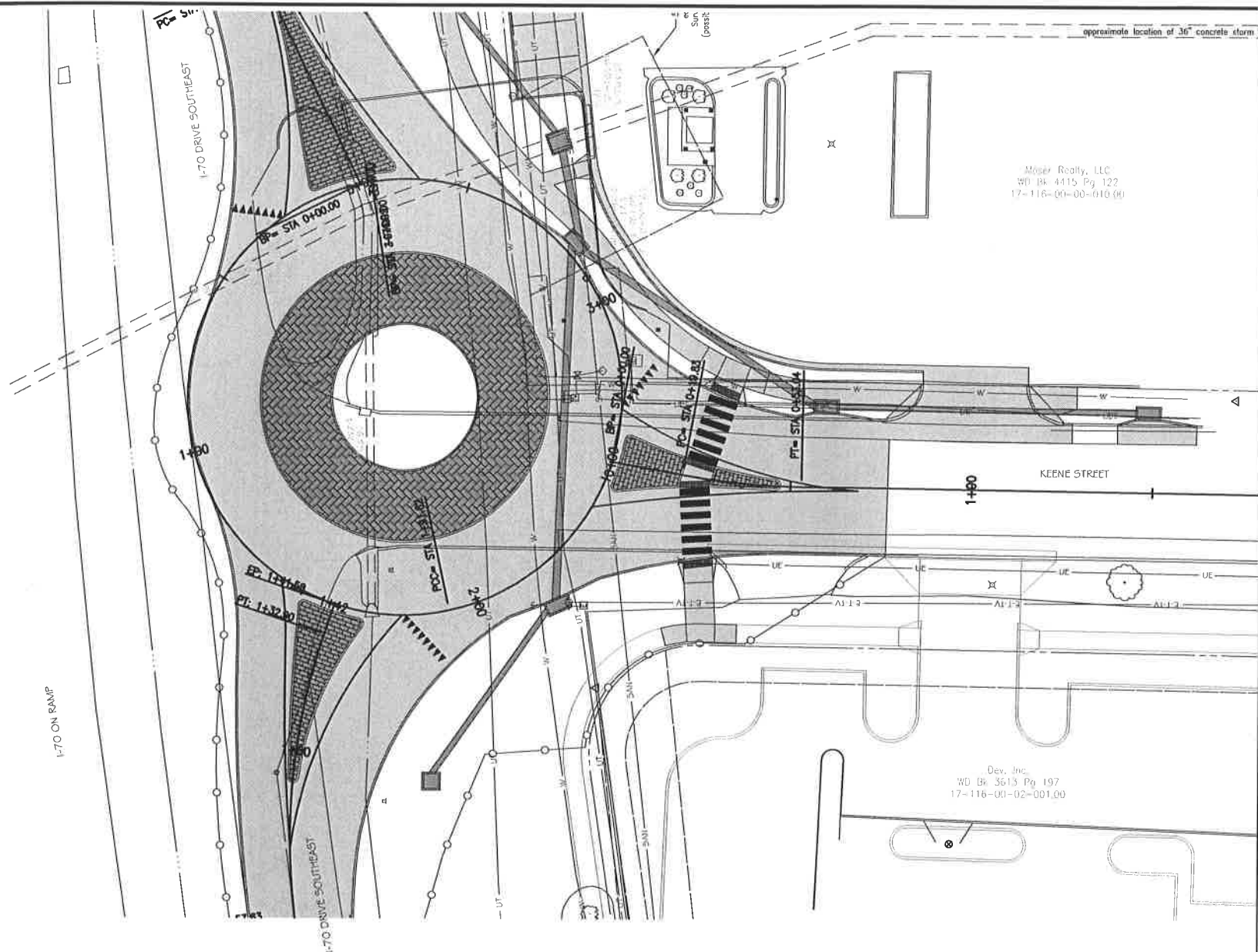

KEENE STREET  
 SCALE: 1" = 20' HORIZ.  
 1" = 5' VERT.

**KEENE ST. & I-70 DR. SE ROUNDABOUT**  
 Plan & Profile - Sta. XX+XX to Sta. XX+XX

City of Columbia, Missouri  
 Department of Public Works

David Allen Nichols  
 Registered Professional Engineer  
 E-24212  
 File No. 32-01-14  
 Scale: 1" = 20'  
 Date: 6/09/17  
 Des. A.N.H.  
 Dwn. J.L.H.  
 Chk. AAA.

No.	Date	By	Revision