

FILED FOR RECORD, BOONE COUNTY MISSOURI  
BETIE JOHNSON, RECORDER OF DEEDS

STARTING POINT QUARTER SECTION LINE FOUND  
STONE AT CENTER OF SECTION 15-48-12.  
REF: SLA DOCUMENT #600-6489; SURVEY  
RECORDED IN BOOK 2591, PAGE 24; PLAT  
BOOK 40, PAGE 86

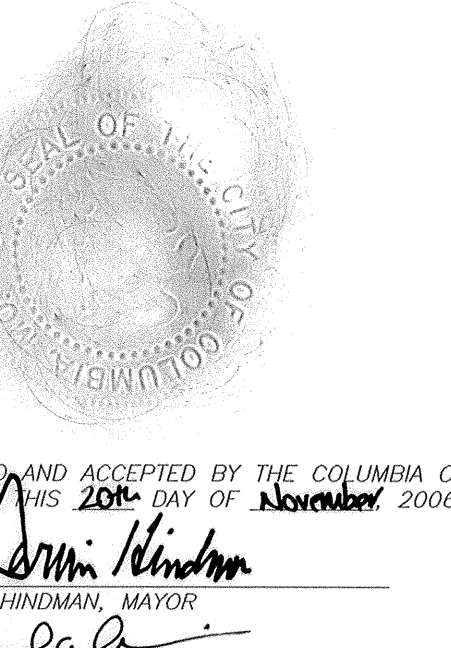

RECEIVED AND ACCEPTED BY THE COLUMBIA CITY  
COUNCIL THIS 20th DAY OF November 2006.  
Darwin Hindman, Mayor  
Sheela Amin, City Clerk

BEARINGS ARE REFERENCED TO THE WEST LINE  
OF LOT 7 AS SHOWN BY OLD HAWTHORNE  
PLAT 1 RECORDED IN PLAT BOOK 40, PAGE 86  
BEING N 01°42'50\"

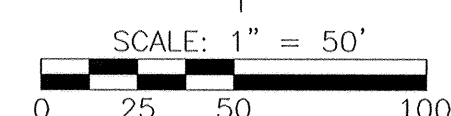

# FINAL PLAT

## VISTAS AT OLD HAWTHORNE PLAT 1

A REPLAT OF A PORTION OF LOT 7 OLD HAWTHORNE PLAT 1, PLAT BOOK 40, PAGE 86

OCTOBER 27, 2006

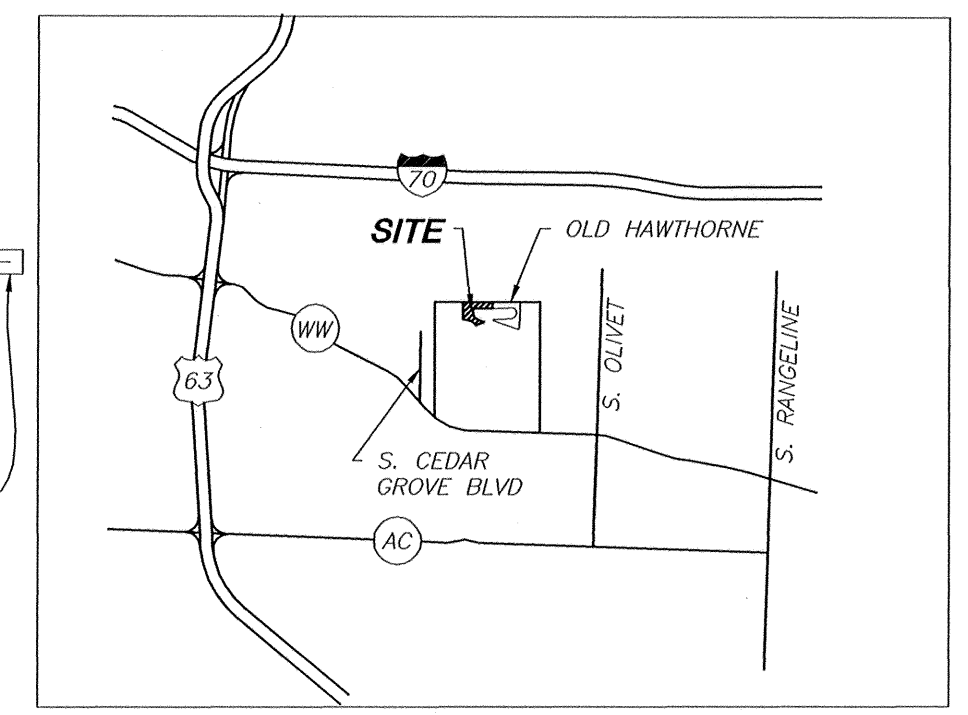

LOCATION MAP  
NOT TO SCALE

### KNOW ALL MEN BY THESE PRESENTS

WELEK CONSTRUCTION COMPANY, A MISSOURI CORPORATION, BEING SOLE OWNER OF  
THE BELOW DESCRIBED TRACT, HAS CAUSED THE SAME TO BE SUBDIVIDED AS  
SHOWN ON THIS PLAT.

IN WITNESS WHEREOF, JOHN WELEK HAS CAUSED THESE PRESENTS TO BE SIGNED.

EASEMENTS, OF THE TYPES AND AT THE LOCATIONS AS SHOWN, ARE HEREBY  
DEDICATED TO THE CITY OF COLUMBIA, FOREVER.

SUNSTONE LANE AND IVORY LANE ARE HEREBY DEDICATED FOR PUBLIC USE  
FOREVER.

JOHN M. WELEK, PRESIDENT OF WELEK CONSTRUCTION COMPANY

STATE OF MISSOURI } SS  
COUNTY OF BOONE }  
ON THIS 26th DAY OF October, IN THE YEAR 2006, BEFORE ME, SUZANNE  
M. GEBHARDT, A NOTARY PUBLIC IN AND FOR SAID STATE, PERSONALLY APPEARED  
JOHN M. WELEK, KNOWN TO ME TO BE THE PERSON WHO EXECUTED THE WITHIN  
FINAL PLAT AND ACKNOWLEDGED TO ME THAT HE EXECUTED THE SAME FOR THE  
PURPOSES THEREIN STATED.

Suzanne M. Gebhardt, NOTARY PUBLIC  
SUZANNE M. GEBHARDT, MY COMMISSION EXPIRES JUNE 18, 2007.

### CERTIFICATION

A TRACT OF LAND LOCATED IN THE SOUTHWEST QUARTER OF SECTION 14, BOTH IN TOWNSHIP 48 NORTH, RANGE 12 WEST,  
CITY OF COLUMBIA, BOONE COUNTY, MISSOURI, BEING PART OF LOT SEVEN OF OLD HAWTHORNE PLAT 1 AS RECORDED IN  
PLAT BOOK 40, PAGE 86 OF THE BOONE COUNTY RECORDS AND BEING MORE PARTICULARLY DESCRIBED AS FOLLOWS:

BEGINNING AT THE NORTHWEST CORNER OF SAID LOT SEVEN, THENCE ALONG THE QUARTER SECTION LINE N89°05'25\"

I HEREBY CERTIFY THAT I SURVEYED THE DESCRIBED PROPERTY AND SUBDIVIDED IT AS SHOWN ON THE PLAT IN  
ACCORDANCE WITH THE CURRENT MISSOURI MINIMUM STANDARDS FOR PROPERTY BOUNDARY SURVEYS.

SURVEY AND PLAT BY  
A CIVIL GROUP

Matthew P. Thomas, P.L.S. 2000148668  
DATE: 10/26/06

STATE OF MISSOURI } SS  
COUNTY OF BOONE }  
SUBSCRIBED AND AFFIRMED BEFORE ME THIS 26th DAY OF October, 2006.

Suzanne M. Gebhardt, NOTARY PUBLIC MY  
SUZANNE M. GEBHARDT, COMMISSION EXPIRES JUNE 18, 2007.

NUMBER	RADIUS	ARC LENGTH	DELTA ANGLE	CHORD DIRECTION	CHORD LENGTH
C1-@	100.00	83.86	48°02'50\"	S 04°00'15\" E	81.42
C2-@	100.00	54.23	31°04'25\"	N 12°29'30\" W	53.57
C3-@	450.00	123.42	15°42'55\"	N 04°48'40\" W	123.04
C4-@	300.00	473.27	90°23'15\"	N 32°31'30\" E	425.70
C5-@	400.00	86.14	12°20'20\"	N 83°53'15\" E	85.98
C6-@	100.00	14.51	08°18'40\"	S 85°54'05\" W	14.49
C7-@	400.00	63.00	09°01'30\"	S 86°15'30\" W	62.94
C8-@	62.00	181.36	167°36'00\"	N 03°52'10\" W	123.27
C9-@	74.00	266.15	206°04'40\"	S 28°53'40\" W	144.18
C10	20.00	39.81	114°03'00\"	N 41°59'15\" E	33.56
C11	20.00	23.65	67°45'40\"	S 27°03'10\" E	22.30
C12	20.00	25.94	74°18'30\"	N 48°49'40\" W	24.16
C13	20.00	27.21	77°57'25\"	N 35°49'55\" E	25.16
C14	20.00	25.09	71°52'25\"	S 26°41'00\" E	23.48
C15	20.00	25.09	71°52'25\"	N 84°28'15\" E	23.48

### NOTES

- THIS IS AN URBAN CLASS SURVEY.
- PERMANENT MONUMENTS ARE TO BE SET AFTER STREET CONSTRUCTION IS COMPLETE.
- ALL IRONS ARE TO BE SET AFTER CONSTRUCTION UNLESS OTHERWISE NOTED.
- ALL CURVE DIMENSIONS ARE ARC MEASUREMENTS UNLESS OTHERWISE NOTED AS CH. FOR CHORD DIMENSIONS.
- SQUARE FOOTAGES ARE CALCULATED VALUES AND ARE NOT INTENDED TO REPRESENT THE PRECISION OF THE SURVEY.
- SUNSTONE LANE IS TO CHANGE TO IVORY LANE AT THE LOTLINE OF 108/109.

### FLOOD PLAIN STATEMENT

THIS TRACT IS NOT LOCATED WITHIN THE 100-YEAR FLOOD PLAIN AS SHOWN BY FIRM MAP #290034 0150 B DATED: JUNE 15, 1983

### LEGEND

- IRON PIPE CAP #2001006115
- EXISTING
- SET
- PM, PERMANENT MONUMENT
- RADIAL LINE
- REC. RECORD
- DH, DRILL HOLE WITH CHISELED \"X\"
- CENTERLINE
- 10,000 SQUARE FEET
- 1.50 AC. ACRES
- EXISTING FENCE
- EXISTING STONE
- IP, IRON PIPE
- RB, REBAR
- C100 CURVE NUMBER

A CIVIL GROUP  
CIVIL ENGINEERING, PLANNING, SURVEYING  
1123 WILKES BLVD., SUITE 450  
COLUMBIA, MO 65201  
PHONE: (314)881-9150, FAX: (314)881-8711

Plotted by: spencer; Oct 25 2006 - 2:22pm

Recorded in Boone County, Missouri  
Date and Time: 11/21/2006 at 01:29:03 PM  
Instrument #: 2006032124 Book:40 Page:108

Grantor: WELEK CONSTRUCTION CO  
Grantee: VISTAS AT OLD HAWTHORNE PLAT 1

Instrument Type: PLAT  
Recording Fee: \$89.00  
No. of Pages: 1  
Bettie Johnson, Recorder of Deeds

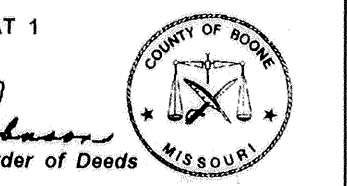
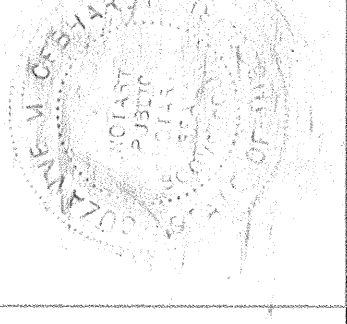
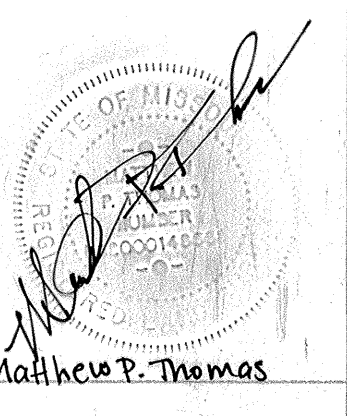
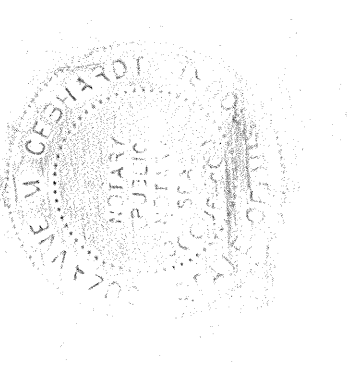

JOB NUMBER WELEK06.04  
FINAL PLAT - VISTAS AT OLD HAWTHORNE PLAT 1  
X:\Project\WV\OLD HAWTHORNE\WELEK-VISTAS PLAT 108.DWG

# FINAL PLAT OLD HAWTHORNE, PLAT No. 9

A MAJOR SUBDIVISION LOCATED IN THE SOUTHWEST QUARTER OF  
SECTION 14, TOWNSHIP 48 NORTH, RANGE 12 WEST  
COLUMBIA, BOONE COUNTY, MISSOURI  
OCTOBER 15, 2012



CURVE TABLE				
CURVE	L	R	Δ	CHDIST
1	145.20'	1000.00'	8°19'10"	145.08'
2	172.77'	1000.00'	9°53'55"	172.55'
3	95.11'	1000.00'	5°27'00"	95.08'
4	107.23'	1000.00'	6°08'40"	107.18'
5	31.57'	20.00'	90°26'45"	28.39'
6	31.26'	20.00'	89°33'10"	28.17'

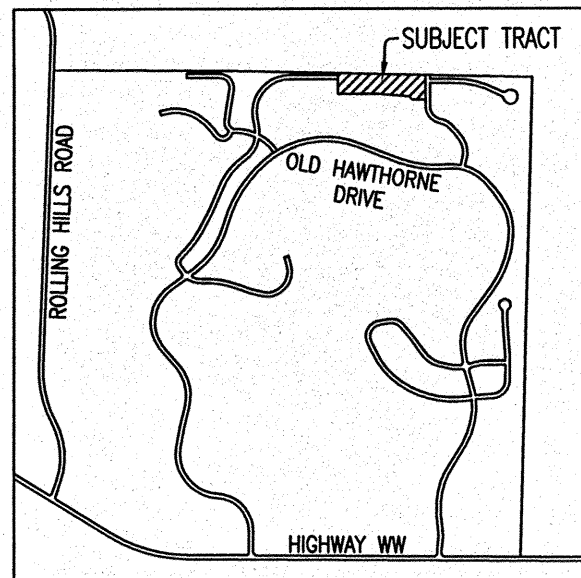

LOCATION MAP

NOT TO SCALE

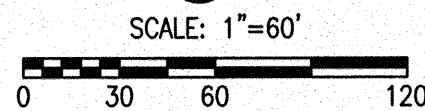

BEARINGS ARE REFERENCED TO GRID NORTH, OF THE MISSOURI STATE PLANE COORDINATE SYSTEM (CENTRAL ZONE), OBTAINED FROM GPS OBSERVATION.

**LEGEND:**

- E EXISTING
- SET 1/2" IRON PIPE (UNLESS NOTED OTHERWISE)
- STONE
- PERMANENT MONUMENT
- (M) MEASURED DISTANCE
- (REC) RECORDED DISTANCE
- (R) RADIAL LINE
- DH x DRILL HOLE
- W/ CHISELED X

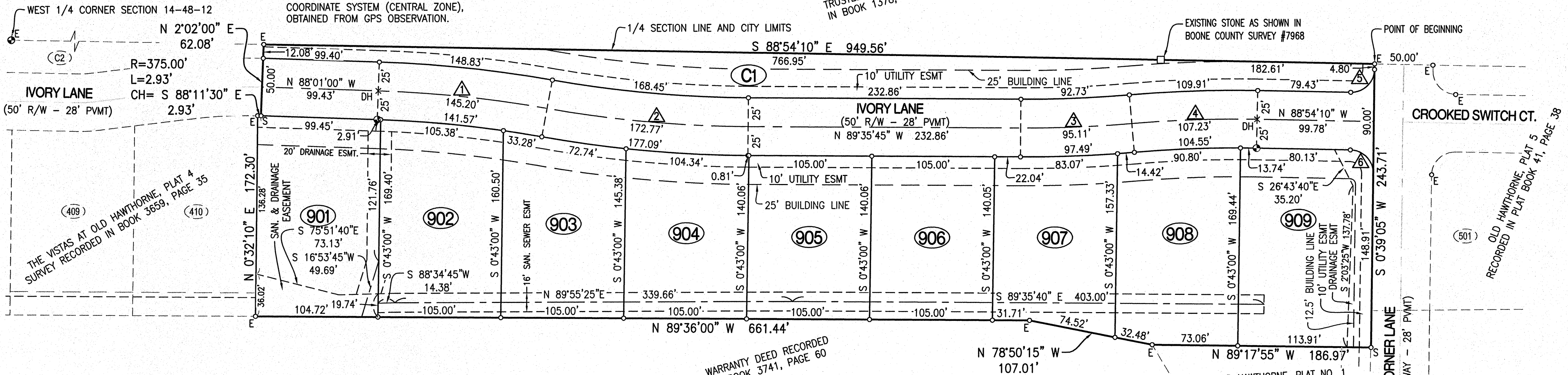

- NOTES:**
- THIS TRACT IS NOT LOCATED IN THE 100-YEAR FLOOD PLAIN AS SHOWN BY BOONE COUNTY FLOOD PLAIN MAPS, PANEL NUMBER 29019C 0325D, DATED MARCH 17, 2011.
  - THIS SURVEY CONFORMS TO THE ACCURACY STANDARDS FOR URBAN PROPERTY AS DEFINED BY MISSOURI STATUTE 20 CSR 2030-16.040(2)(A).
  - A CURRENT TITLE COMMITMENT WAS NOT PROVIDED FOR THIS SURVEY.
  - LOT C1 IS TO BE USED AS COMMON AREA AND NOT FOR RESIDENTIAL USE.
  - THIS TRACT IS NOT REGULATED BY THE STREAM BUFFER REQUIREMENTS IN SECTION 12A-230A ARTICLE X OF THE CITY OF COLUMBIA CODE OF ORDINANCES.

**CERTIFICATION:**

I HEREBY CERTIFY THAT IN SEPTEMBER OF 2012, I COMPLETED A SURVEY AND SUBDIVISION FOR OLD HAWTHORNE DEVELOPMENT, LLC., OF A TRACT OF LAND LOCATED IN THE SOUTHWEST QUARTER OF SECTION 14, TOWNSHIP 48 NORTH, RANGE 12 WEST, COLUMBIA, BOONE COUNTY, MISSOURI AND BEING PART OF LOT 7 OF OLD HAWTHORNE, PLAT 1, RECORDED IN PLAT BOOK 40, PAGE 86 AND DESCRIBED BY THE WARRANTY DEED RECORDED IN BOOK 4087, PAGE 17 AND BEING MORE PARTICULARLY DESCRIBED AS FOLLOWS:

BEGINNING ON THE NORTH LINE OF THE SOUTHWEST QUARTER OF SECTION 14, TOWNSHIP 48 NORTH, RANGE 12 WEST AT THE NORTHWEST CORNER OF OLD HAWTHORNE, PLAT 5 RECORDED IN PLAT BOOK 41, PAGE 38 AND BEING THE WEST RIGHT-OF-WAY LINE OF CUTTERS CORNER LANE THENCE WITH SAID WEST LINE OF PLAT 5 AND THE WEST RIGHT-OF-WAY LINE OF CUTTERS CORNER LANE, S 0°39'05"W, 243.71 FEET; THENCE LEAVING SAID WEST RIGHT-OF-WAY LINE, N 89°17'55"W, 186.97 FEET TO THE LINES OF A TRACT DESCRIBED IN THE WARRANTY DEED RECORDED IN BOOK 3741, PAGE 60; THENCE WITH THE LINES OF SAID TRACT, N 78°50'15"W, 107.01 FEET; THENCE N 89°36'00"W, 661.44 FEET TO THE SOUTHEAST CORNER OF THE VISTAS AT OLD HAWTHORNE, PLAT 4 RECORDED IN BOOK 3659, PAGE 35; THENCE LEAVING THE LINES OF THE TRACT DESCRIBED IN THE WARRANTY DEED RECORDED IN BOOK 3741, PAGE 60 AND WITH THE LINES OF SAID VISTAS AT OLD HAWTHORNE, PLAT 4, N 0°32'10"E, 172.30 FEET TO THE SOUTH RIGHT OF WAY LINE OF IVORY LANE; THENCE CONTINUING WITH SAID VISTAS AT OLD HAWTHORNE, PLAT 4 AND WITH SAID SOUTHERLY RIGHT-OF-WAY, 2.93 FEET ALONG A 375.00-FOOT RADIUS NON-TANGENT CURVE TO THE RIGHT, SAID CURVE HAVING A CHORD, S 88°11'30"E, 2.93 FEET; THENCE LEAVING SAID SOUTHERLY RIGHT-OF-WAY LINE, N 2°02'00"E, 62.08 FEET TO THE NORTH LINE OF THE SOUTHWEST QUARTER OF SAID SECTION 14; THENCE LEAVING THE EASTERLY LINES OF SAID VISTAS AT OLD HAWTHORNE, PLAT NO. 4 AND WITH SAID NORTH LINE, S 88°54'10"E, 949.56 FEET TO THE POINT OF BEGINNING AND CONTAINING 5.11 ACRES.

I FURTHER CERTIFY THAT I SURVEYED THE ABOVE DESCRIBED PROPERTY AND SUBDIVIDED IT AS SHOWN ON THE PLAT IN ACCORDANCE WITH THE CURRENT MISSOURI MINIMUM STANDARDS FOR PROPERTY BOUNDARY SURVEYS.

SURVEY AND PLAT BY:  
CROCKETT ENGINEERING CONSULTANTS, LLC  
2608 NORTH STADIUM BLVD.  
COLUMBIA, MO 65202  
CORPORATE NUMBER: 2000151304

DAVID T. BUTCHER, PLS-2002014095  
1/13/2013  
DATE

**KNOW ALL MEN BY THESE PRESENTS:**

THAT OLD HAWTHORNE DEVELOPMENT, LLC. IS THE SOLE OWNER OF THE HEREON DESCRIBED TRACT AND THAT SAID COMPANY HAS CAUSED SAID TRACT TO BE SURVEYED, SUBDIVIDED, AND PLATTED AS SHOWN ON THE ABOVE DRAWING. THE STREET RIGHT OF WAY SHOWN BY THE ABOVE DRAWING IS HEREBY DEDICATED TO THE CITY OF COLUMBIA FOR THE PUBLIC USE FOREVER. THE EASEMENTS AS SHOWN, ARE HEREBY DEDICATED TO THE PUBLIC USE FOREVER. THE ABOVE DRAWING AND DESCRIPTION SHALL HEREAFTER BE KNOWN AS "OLD HAWTHORNE, PLAT NO. 9"

IN WITNESS WHEREOF, OLD HAWTHORNE DEVELOPMENT, LLC. HAS CAUSED THESE PRESENTS TO BE SIGNED BY ITS MANAGER THIS 7<sup>th</sup> DAY OF January, 2013.

ACCEPTED BY ORDINANCE OF THE CITY COUNCIL OF COLUMBIA, MISSOURI, THIS 4<sup>th</sup> DAY OF February, 2013.

OLD HAWTHORNE DEVELOPMENT, LLC.  
BILLY G. SAPP, MANAGING MEMBER

ROBERT McDAVID, MAYOR  
SHEELA AMIN, CITY CLERK

STATE OF MISSOURI } SS  
COUNTY OF BOONE }

SUBSCRIBED AND AFFIRMED BEFORE ME THIS 3<sup>rd</sup> DAY OF January, 2013.

TIMOTHY CROCKETT  
NOTARY PUBLIC  
MY COMMISSION EXPIRES  
JANUARY 25, 2013  
COMMISSION NUMBER 09407103

TIMOTHY CROCKETT  
Notary Public - Notary Seal  
STATE OF MISSOURI  
Boone County  
My Commission Expires: 1/25/2013  
Commission #09407103

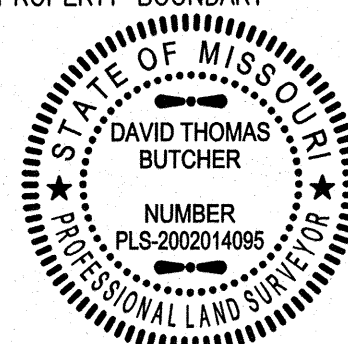

TIMOTHY CROCKETT  
Notary Public - Notary Seal  
STATE OF MISSOURI  
Boone County  
My Commission Expires: 1/25/2013  
Commission #09407103

STATE OF MISSOURI } SS  
COUNTY OF BOONE }

SUBSCRIBED AND AFFIRMED BEFORE ME THIS 7<sup>th</sup> DAY OF January, 2013.

TIMOTHY CROCKETT  
NOTARY PUBLIC MY COMMISSION  
EXPIRES JANUARY 25, 2013  
COMMISSION NUMBER 9407103

Recorded in Boone County, Missouri  
Date and Time: 02/05/2013 at 02:37:49 PM  
Instrument #: 2013002949 Book:47 Page:5

Grantor: OLD HAWTHORNE DEVELOPMENT LLC  
Grantee: OLD HAWTHORNE PLAT NO 9

Instrument Type: PLAT  
Recording Fee: \$44.00 S  
No. of Pages: 1

Bettie Johnson, Recorder of Deeds