

PETITION REQUESTING ANNEXATION TO THE CITY OF COLUMBIA

De'Carlon Seewood, City Manager and authorized agent for the City of Columbia, Missouri, a Missouri corporation, hereby petitions the City Council of the City of Columbia to annex the land described below into the corporate limits of Columbia and, in support of this petition, states the following:

1. The City of Columbia, Missouri corporation, is the owner of all fee interests of record in the real estate in Boone County, Missouri, described as follows:

(Attach Legal Description)

2. This real estate is not now a part of any incorporated municipality.
3. This real estate is contiguous and compact to the existing corporate limits of the City of Columbia, Missouri.
4. De'Carlon Seewood, City Manager and authorized agent for the City of Columbia, Missouri requests that this real estate be annexed to, and be included within the corporate limits of the City of Columbia, Missouri, pursuant to Section 71.012, RSMo 1994.
5. Petitioner requests that the property be zoned R-1 (One-family Dwelling) at the time of annexation.

Dated this 20th day of January, 2026.

STATE OF MISSOURI)
) ss.
COUNTY OF BOONE)

RECEIVED
JAN 21 2026
PLANNING DEPT.

VERIFICATION

The undersigned, De'Carlon Seewood, City Manager and authorized agent for the City of Columbia, Missouri, being of lawful age and after being duly sworn states and verifies that the undersigned has reviewed the foregoing Petition for Voluntary Annexation, and that the undersigned is duly authorized to execute the foregoing instrument on behalf of the City of Columbia, Missouri, a Missouri municipal corporation, and acknowledges the requests, matters and facts set forth therein are true and correct to the best of the undersigned's information and belief.

De'Carlon Seewood, City Manager

Subscribed and sworn to before me this 20th day of January, 2026.

Notary Public

My commission expires: 9/2/29



A TRACT LOCATED IN SECTION 16, TOWNSHIP 48 NORTH, RANGE 12 WEST, BOONE COUNTY MISSOURI BEING THE TRACT DESCRIBED BY THE DEED IN BOOK 5763, PAGE 25 AND BEING, LOTS 1 AND 2 OF EL CHAPARRAL PLAT NO. 8 AS SHOWN BY PLAT BOOK 13, PAGE 23, ALSO BEING THE TRACT DESCRIBED BY THE SURVEY IN BOOK 6085 PAGE 136, ALL OF THE BOONE COUNTY RECORDS.

THIS DOCUMENT HAS BEEN
SIGNED AND SEALED
ELECTRONICALLY

OWNER: CITY OF COLUMBIA
PROJECT: FIRE STATION # 10
PARCEL: 17-510-16-01-014.00 01
ANNEXATION AND ZONING DESCRIPTION

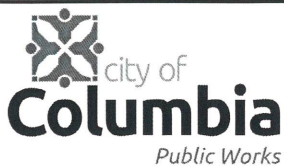

701 E. BROADWAY,
P.O. BOX 6015
COLUMBIA, MO. 65205
573-874-7266

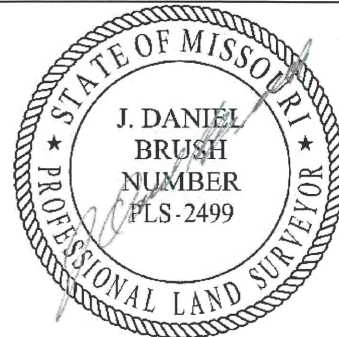

Date: 2025.12.17 12:03:40-06'00'

J.DANIEL BRUSH PLS 2499