

It shall be unlawful for any person to violate any provision or fail to comply with any of the requirements of these regulations. A violation of or failure to comply with any of the requirements of these regulations shall constitute a misdemeanor and shall be upon conviction punished as provided by law. In addition, any person permitting, aiding, abetting or concealing a violation of this ordinance shall be deemed guilty of a misdemeanor and shall be upon conviction punished as provided by law. Each day a violation of these regulations continues shall constitute a separate offense. The penalty provided in this section shall not be construed to be exclusive but is intended to be supplemental and in addition to any other remedy provided by law or at equity. The County may institute in the circuit court of the County any appropriate action or other proceedings to prevent any unlawful activity proscribed in this ordinance or to correct any violations of this ordinance.

#### 26.9 Conflict with Other Regulations

Where the standards and management requirements of this buffer ordinance are in conflict with other laws, regulations, and policies regarding streams, steep slopes, erodible soils, wetlands, floodplains, timber harvesting, land disturbance activities, or other environmental protective measures, the more restrictive shall apply.

#### 26.10 Severability

If any part or parts of this Ordinance shall be held unconstitutional, invalid, or otherwise unenforceable by any court of competent jurisdiction, such decision shall not affect the validity of the remaining provisions of this Ordinance.

## **SECTION 27 ADDRESSING AND ROAD NAMING REGULATIONS**

#### 27.1 Applicability and Authority.

Applies to all divisions of land and related addressing and road naming. These regulation are adopted pursuant to the authority granted under the provisions of RSMo 64.825-64.885, RSMo 67.318 and the provisions of the adopted International Fire Code and International Residential Code which have been adopted by the County pursuant to the authority granted in RSMo 64.170.

#### 27.2 Definitions. For purposes of this section, the following terms are hereby defined:

27.2.1 Addressable Structures. Structures eligible for addresses. See Section 27.11.

27.2.2 Alias Road Names. An alias road name is the name, other than the official name, commonly used for the road (See Section 27.9.15).

27.2.3 Boone County Addressing Grid System. The system used in unincorporated Boone County to assign address numbers (See Section 27.5).

27.2.4 Address Directional Prefix. An abbreviation of the main cardinal direction which precedes the official road name. There are four address directional prefix quadrants with north designated as N, south designated as S, east designated as E, and west designated as W.

27.2.5 Bulb / Bumpout. In context of roads, a condition where the right of way for a road is widened to allow for more frontage for additional lots and continues the numbering pattern, interval, and direction as a continuation from the main road (See Canterbury Dr, 27.7 Figure 1).

27.2.6 Circle. In context of roads, a road that has only one connection to the main road that acts as both the entrance and exit, and only intersects with itself which also contains parcels located in the interior of the circle (See Franklin Cir, 27.7 Figure 2).

27.2.7 Court. In context of roads, a uniquely named dead-end road with no other roads intersecting the main road and terminates in a permanent cul-de-sac.

27.2.8 Connector. In context of roads, a segment of road between two officially named roads created by a road realignment project.

27.2.9 Official Legal Road Names. The road name listed in the Boone County Road Directory as administered by Boone County Planning and Building Inspection is the official road name.

27.2.10 Vanity. In context of roads and/or addresses, an address requested by a business, organization, or individual that is not related to the Boone County Addressing Grid System.

### 27.3 Administration.

27.3.1 Addressing Authority. The Boone County Planning and Building Inspection Director is the Boone County addressing authority.

27.3.2 Administrative Review. If, under application of the provisions of these regulations, any existing road name or address number is required to be changed, then any person aggrieved by such a decision by the Planner or other duly-qualified employee of the County Planning and Building Inspection department assigned to make decisions about a road name or address designation under the provisions of this ordinance may file a request to review that decision with the Director of Planning and Building Inspection for Boone County by making a written request for said review within fifteen (15) days of the date of the written decision of the Planner. Said request must be on the form(s) provided by the Director of Planning's office and shall include a copy of the written decision of the Planner.

27.3.3 Appeals to Board of Zoning Adjustment. The aggrieved person, if dissatisfied with the decision of the Director, may further appeal the decision of the Director to the Board of Zoning Adjustment in the same manner as appeals from the decisions of administrative officers in applying the Zoning Ordinance for Boone County.

27.4 Purpose and Intent. The Boone County addressing and road naming regulations are to establish standards for naming public and private roads, posting official road signs, and assigning official address numbers to all addressable structures; and to assist emergency management agencies, the United States Postal Service, and the public in the timely and efficient provision of services to residents and businesses within unincorporated Boone County.

These regulations are designed to eliminate addressing confusion and to create a standard system by which addresses shall be assigned, displayed, and maintained from this time forward. These regulations are further designed to establish an official master address database and road name directory in Boone County to be maintained by Boone County Planning and Building Department. It is not the objective of these regulations to change all previously official addressed structures or to change all previously officially named duplicate road names. Changes to existing official addresses and road names will only be made when non-conformity could interfere with the accurate dispatch of emergency vehicles, postal delivery, and provision of County services.

27.5 Basis of the Boone County Addressing Grid System. The unincorporated Boone County addressing grid system shall originate at the intersection of Broadway and Garth Ave in the City of Columbia and continue to increase in all directions as they radiate outward from the origin point. Other municipalities in Boone County use the same type of numbering grid system but begin at their own origin point.

27.6 Components of an Address. An address shall contain the following components as applicable:

- Address number
- Directional prefix
- Street name
- Street type
- Directional suffix \*
- Unit type \*\*
- Unit number \*\*
- City
- State
- Zip

\* Historical component

\*\* If applicable

27.7 Standards for Address Number Assignment. Addresses are assigned based off the primary access to the property. The standards for address number assignment are that the address number is a unique numerical identifier based on the Boone County addressing grid system and that the number can range from one to five digits depending on the location within the grid. The address numbers continue to increase in all directions as they radiate outward from the origin point.

27.7.1 Address Directional Prefix. Assignment of an address directional prefix is based on the position and orientation of the underlying road being addressed as it relates within the address grid. (See Section 27.8 for additional information).

27.7.2 Address Numbers. New address numbers shall consist entirely of numbers. Characters such as hyphens, decimals, or fractions shall not be allowed. If a structure is legally subdivided into more than one occupancy, a unit type and unit number shall be required. For example, instead of 2456.5 or 2456 ½ being issued as an address number, 2456 APT A and B, or 2456 STE 101 and 102 would be the correct issued address number, see Section 27.11 for additional information.

27.7.3 Vanity Address Numbers. Vanity address numbers shall not be allowed. All numbers shall be consistent with the address grid. For example, a business named Acme Five Company in the 1800 address grid range will not be assigned “1 Acme Dr” or “5 Acme Dr” as its address. The address

shall be assigned an official address number according to the established address grid range.

- 27.7.4 Address Ranges. The possible address range of a road shall be identified using the Boone County address grid system to determine which addresses are eligible to be assigned along the length of a road segment. For example, an address number of 220 cannot be assigned on a block with an address range of 1000-1099.
- 27.7.5 Address Parity. In Boone County even numbers shall be located on the south and east sides of the road and odd numbers shall be located on the north and west sides of the road. Addresses across the road from one another should be comparable. If 645 is used on the odd-numbered side of a road, numbers close to 644 or 646 should be used on the even side.
- 27.7.6 Numerical Sequence. Assignment of addresses shall be done in numerical sequence along a road. Address numbers shall increase as they move away from the origin point of the address grid and they shall not be assigned out of order. For instance, 1789 should not fall between 1735 and 1741.
- 27.7.7 Address Intervals. When assigning address numbers the Director shall consider both current and future development. Address assignment shall include a large enough numbering interval to allow for expansion and growth. In most residential areas an interval of at least four addresses (310, 314, 318, etc.) should be adequate. An interval of at least eight numbers is recommended as the minimum for commercial or industrial sites. Sufficient interval shall be allowed in large lot developments to provide adequate sequential numbers in case the parcel is subdivided for new construction at a later time.
- 27.7.8 Duplicate Numbers. Duplicate address numbers on the same road or similarly named roads shall be avoided when at all possible especially where the road spans address directional quadrants. This includes addresses on courts or circles. For example, if there is a 5003 E Liberty Ln, then 5003 E Liberty Woods Ct should be avoided.
- 27.7.9 Long Blocks. New subdivision developments may have long blocks with no intersecting roads. Addresses shall correspond with the appropriate address range for each road segment of the long block. The long block numbers shall change in mid-block even if there is no separating road. This will result in two homes side-by-side numbered in two different blocks even though there is no separating road.

27.7.10 Corner Parcels. Addresses shall be numbered off a road on which the parcel has frontage and where the property is primarily accessed. A request for an address number to be assigned off of a major road shall not be allowed unless the major road physically borders that property and provides primary access.

27.7.11 Bulb / Bumpout. Bulb / Bumpout shall be addressed as if the bulb did not exist within the design of the road provided that the bulb of the main road is less than 300 feet in length or platted with six or less lots (including the corner lots) (See Canterbury Dr, 27.7 Figure 1).

27.7.12 Courts. Courts shall be addressed as if the centerline of the road bisects the cul-de-sac with odd numbers on the north or west and even numbers on the south or east. The numbers meet at the far end of the center area. In addition, if the road that the court intersects is designated as an east/west directional road, the court shall be addressed as a north/south directional road even if the two are not perpendicular (See Highland Ct, 27.7 Figure 2).

27.7.13 Circles. Circles shall be addressed with the road name, numbering pattern, interval and direction shall be flowing with the traffic direction or to the right when there is no clear traffic flow due to the road design and/or location (See Franklin Cir, 27.7 Figure 2).

27.7.14 Roads that Change Direction. There shall be two ways to contend with roads that change direction or curve significantly. For purposes of this section the Boone County Planning and Building Inspection Director has sole discretion in determining significance (See N Boone Rd, 27.7 Figure 3).

27.7 Figure 1 Bulb – Bumpout

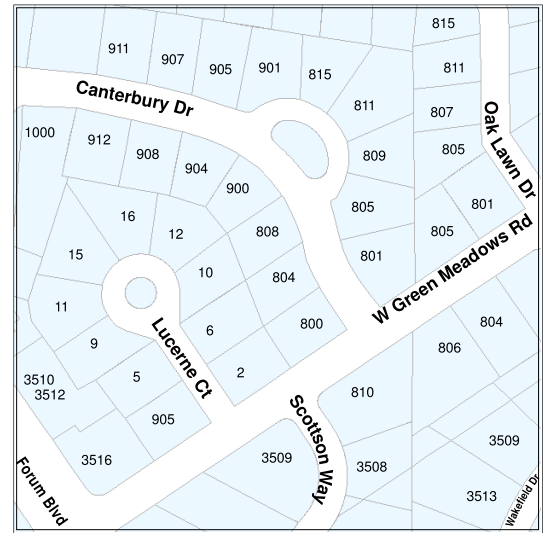

27.7 Figure 2 – Courts and Circles

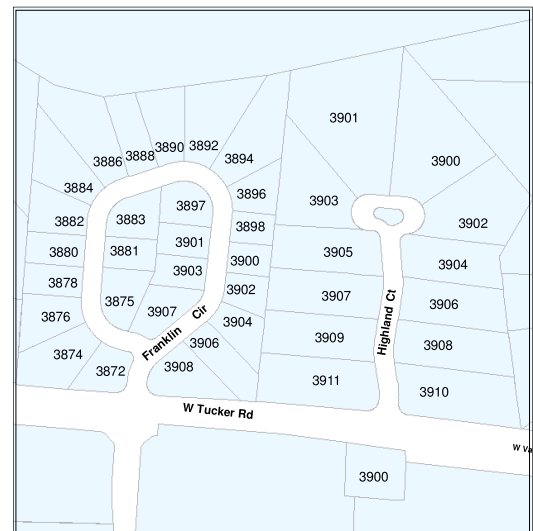

27.7.14.1 Insignificant Change of Direction. The road will retain its original address grid and range throughout its entire length no matter how many times the road turns or bends. This means the address numbers do not change direction with the road (See N Reams Rd, 27.8 Figure 1).

**27.7 Figure 3 – Significant Change of Direction**

27.7.14.2 Significant Change of Direction. Where overall road alignment involves a single significant change in direction and the road continues for a significant distance after the change, in relationship to its overall length, a new road name shall be assigned in the middle of the curve. This option is most appropriate where the curve is approximately a 90-degree angle changing the major direction of the road (See N Boone Rd, 27.7 Figure 3).

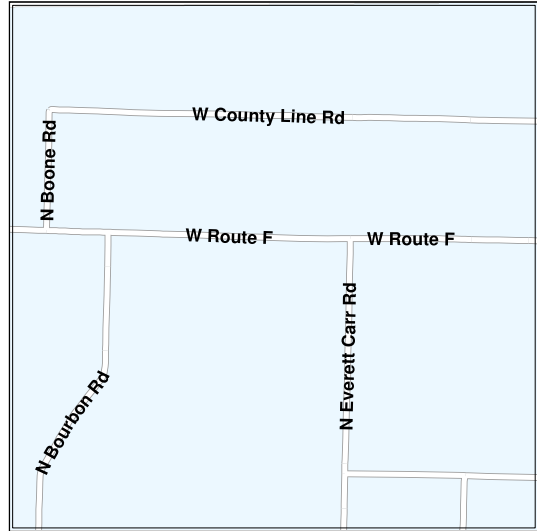

27.8 Standards for Directional Prefixes & Suffixes. Directional prefixes shall be abbreviated, capitalized, and contain no punctuation such as periods. Directional suffixes shall not be used. Standard directional prefix abbreviations include the following:

<u>Example</u>	<u>Abbreviation</u>
North	N
South	S
East	E
West	W

27.8.1 Directional Prefix. A directional prefix is mandatory on all roads but is not part of the official road name. Roads that cross a grid base line may have duplicate address ranges. For example, 301 W Williams Rd and 301 E Williams Rd, the W and E are crucial in distinguishing between the two blocks.

**27.8 Figure 1 – Retain Directional Prefix**

**27.8.1.1 Retain Directional Prefix.**

A diagonal or curving road, having one road name for its entire length, shall be determined to be either a north/south or an east/west road and shall be assigned a single directional prefix. (See N Reams Rd, 27.8 Figure 1)

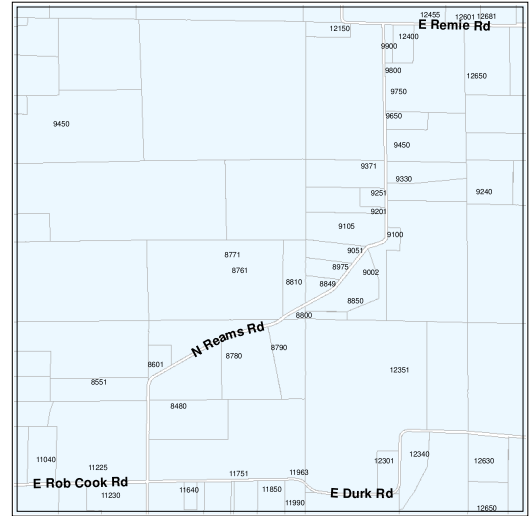

**27.8.1.2 Change Directional Prefix.**

Two roads that meet at or near a 90-degree curve with no physical feature to indicate a road name change shall be dealt with as two separate roads with different names and different directional prefixes in accordance to Section 27.7.14.2.

**27.9 Standards for Official Name Assignment.**

**27.9.1 Pronunciation.** Road names shall be easy to read, pronounce, and spelled so the public, children in particular, can say the name in an emergency situation.

**27.9.2 Inappropriate Road Names.** Roads names shall not be names that are generally considered inappropriate or offensive.

**27.9.3 Confusing, Common, or Generic Road Names.** Road names that are confusing, common, or generic shall not be used. Proposed names shall also be rejected if one of the principal words in the name has already been used several times. In an effort to keep road names distinct and short, roads named after seasons, weather, tree species, common animal names, colors, or geographic features shall not be used, even within a compound road name.

<b>Confusing Road Names</b>	<b>Common Road Names</b>	<b>Generic Road Names</b>
Nub Buck Ln	Autumn Dr	Dead End Rd
Jay Jay Rd	Scenic Dr	Gravel Rd
Cross Rd	White Oak Dr	Nameless Rd
Waterfront Dr*	Spring Valley Dr	Private St

\* Compound road name



27.9.4 Similar Sounding Road Names. Roads names shall not sound similar or duplicate, even if the spelling is different, to any other official road name found in Boone County, either incorporated or unincorporated areas.

27.9.4.1 Roads with Similar Sounding Names. Road names with similar sounding names shall not be accepted. Pearce and Pierce are not acceptable, nor will Wild and Wilde be allowed.

27.9.4.2 Similar Road Names with Different Road Types. It is not acceptable to merely change the road type if the root road name is the same, with the special exceptions of Court, Circle, or Connector provided they meet at an intersection. St James Drive and St James Court cannot both be used unless they meet at an intersection as defined in Section 27.9.11 Road Name Continuity. Further explanation of the proper use of Court, Circle, and Drive is covered in Section 27.7.

27.9.5 Road Name Length. Road names shall be eighteen characters (including spaces) or less in length. The Boone County Planning and Building Inspection Director or his designee may allow an existing official road name, exceeding eighteen characters, to be used as the official name provided the new road segment is an extension of the existing road to comply with Section 27.9.11, to maintain road name continuity.

27.9.6 Root Road Name Spacing. Root road names shall be no more than two words to eliminate unnecessary spacing. For example, Nighthawk Dr would be preferred as opposed to Night Hawk Dr since the compression does not cause confusion.

27.9.7 Numeric Road Names. Numeric road names through tenth shall be spelled out. Roads higher than tenth shall be named with numbers and include the appropriate suffix: th, rd, st, or nd. For example, 14th shall be used instead of Fourteenth or 14.

27.9.8 Abbreviations and Punctuation of Road Names. The following is a list of the only accepted abbreviations: I, HWY, RTE, or St. No other words shall be abbreviated in a road name and no punctuation, including possessives such as Scott's Blvd, is to be used as otherwise specified in these regulations.

Example Abbreviation

Interstate Highway 70 I 70

US Highway 63 HWY 63

Old Highway 63 Old HWY 63

State Highway 124 HWY 124  
 State Route E RTE E  
 State Highway EE HWY EE  
 Saint Charles St Charles

27.9.9 Geographic Directions as Part of Road Names. Geographic directions shall not be used as part of the road name. While these do exist, such as Southgate St, North Shore Dr, South Cedar Lake Dr, Waterfront Dr South, or Southwest Way, this practice shall be avoided in future developments. To eliminate confusion, the use of north, south, east, west, and any variations shall be reserved for prefix use only. For example, when verbally giving an address, it would be impossible to distinguish between Northshore Dr and N Shore Dr.

27.9.10 Road Types as Part of Road Names. A road type shall not be used as part of the root road name even if included in a proposed compound root road name. For example, a road named Dustytrail Dr shall not be allowed since Trail and Drive are both road types. Section 27.10 covers the standard for road abbreviations types for Avenue, Court, Ridge, and Boulevard.

27.9.11 Road Name Continuity. Road name continuity is the consistent retention of one road name for the length of the road. This is not to be confused with road name duplication. Road name continuity shall be used when possible. A road with a gap should maintain the same name across the gap, as long as the road continues on the same alignment after the gap. (See E Ash St, 27.9 Figure 1).

**27.9 Figure 1 – Road Name Continuity**

If the road shifts off-alignment by more than 200 feet, a new road name shall be assigned. Roads that continue beyond an intersection and dead-end as courts shall be named with the same root name as the main road but designated as a Court (See St James Dr and St James Ct, 27.9 Figure 1).



27.9.12 Intersecting Road. Roads shall not cross or meet more than twice.

27.9.13 Consistent Road Name Spelling. Any new segment to an existing road shall be spelled consistent with the road name being extended provided the existing road name is in compliance with this section.

27.9.14 Official Legal Road Name Changes. When a road name is officially renamed, the new road name becomes the official road name and replaces the old official road name and is the only acceptable name for the renamed road.

27.9.15 Unofficial or Alias Road Names. Different entities sometimes refer to the same road using several different unofficial road names for the same segment of road. The road name shown on a road sign is not the official road name unless it matches the road name listed in the Boone County Road Directory. For example, Range Line St is also referenced as HWY 763.

27.9.16 Private Roads. All roadways used for access or the possibility of access to seven or more addressable structures must be named and all structures must be numbered off that roadway. All other roadways with less than seven addressable structures shall be considered private driveways or ingress/egress easements and shall not be officially named. Initiating road naming or road name changes are the responsibility of the property owner(s). The name must then be submitted for approval by the addressing authority and must adhere to the same naming standards for official public road names. Private road names must adhere to the same naming standard for public roads; approval will not be given for duplicate or confusing private road names, for example Golfview Dr and Golfview Ln, as outlined in Section 27.9.3.

27.10 Standards for Road Type Assignment. All road segments shall have a standard road type assigned by the addressing authority.

27.10.1 Correct Use of Road Types. All roads shall have a road type which shall be assigned by the addressing authority from the following list. The addressing authority reserves the right to put priority in assigning road types highlighted in grey in the following list. For example, Wagon Ridge Rd shall not be assigned as it would go against the directive that road types shall not be part of the root road name. Likewise, if a court extends off Wagon Ridge it will be assigned Wagon Ct, not Wagon Ridge Ct.

Road type	Abbreviation
Alley	Alley
Avenue	Ave
Boulevard	Blvd
Bridge	Br

Road type	Abbreviation
Meadow	Mdw
Meadows	Mdws
Park	Park
Parkway	Pkwy

Bypass	Byp
Causeway	Cswy
Circle	Cir
Connector	Conn
Court	Ct
Cove	Cv
Crossing	Xing
Drive	Dr
Establishment	Est
Expressway	Expy
Extention	Ext
Freeway	Fwy
Glen	Gln
Green	Grn
Heights	Hts
Highway	Hwy
Hill	Hl
Hills	Hls
Lane	Ln
Loop	Loop

Pass	Pass
Place	Pl
Plaza	Plz
Point	Pt
Ramp	Ramp
Ridge	Rdg
Road	Rd
Route	Rte
Run	Run
Spur	Spur
Square	Sq
Station	Sta
Street	St
Terrace	Ter
Trace	Trce
Trail	Trl
Turnpike	Tnpk
Valley	Vly
View	Vw
Village	Vlg
Walk	Walk
Way	Way

27.10.2 Root Road Names Assigned Only One Road Type. Once a root road name is assigned it must not be used again with a different road type except in the case of a Court, Circle, or Connector as shown in Section 27.9.4. For example, the use of both Maple Lane and Maple Trail shall not be acceptable.

27.11 Standards for Address Assignment. All addressable structures shall have an address number assigned by the addressing authority.

27.11.1 Addressable Structures. Only the following types of structures are eligible for official addressing. Accessory structures and non-dwelling units shall not be assigned addresses unless otherwise specified by this ordinance.

27.11.1.1 Single Family Dwellings, 2-Family, Triplexes, Multi-Family, and Condominiums. Single Family Dwellings, 2-Family, Triplexes, and Multi-Family shall be assigned separate address numbers. Buildings containing condominiums shall be assigned addresses in the same manner that is appropriate for the type of structure constructed within which the condominium is located.

27.11.1.2 Mobile Home Parks. Mobile home parks are designated by sequential, non-duplicated lot numbers with a single site address for the entire park. If additional road names are unavoidable inside a mobile home park, then they shall be addressed in the same manner as a platted subdivision.

27.11.1.3 Commercial or Industrial Buildings.

27.11.1.3.1 Contained Within a Single Structure. Businesses in shopping centers or strip malls contained within a single structure shall be assigned an address consisting of the structure address and a unique individual suite number in compliance with Section 27.11.4 with sufficient suite numbering interval to allow for one suite to be split into several future suites.

27.11.1.3.2 Contained Within a Development Complex. Businesses in shopping centers or strip malls contained within a development complex of multiple structures shall be assigned separate site address for each structure with sufficient numbering interval to allow for additional structures. Businesses contained within a given structure will be assigned individual suite numbers in compliance with Section 27.11.4 with sufficient numbering interval to allow for one suite to be split into several future suites.

27.11.2 Address Number Assignment. Addressable structures shall be numbered off a road on which they have frontage and where the property is primarily accessed. In cases where an addressable structure is located on a property that does not have road frontage on an officially named road, the structure shall be numbered off of the officially named road where the property is primarily accessed. A request for an address number to be assigned off of a major road shall not be allowed unless the major road physically borders that property and provides primary access.

27.11.3 Unit Type Assignment. In structures with a single type of use, multiple unit types per address shall be avoided. The unit type "Apartment" shall be used to designate residential dwellings. If mixed uses are anticipated or proposed within a structure, then the unit type "Unit" shall be used. The unit type "Suite" shall be used for all other applications unless otherwise specified by this ordinance.

Unit types shall be limited to four characters. The standard abbreviations for unit types are:

Example Abbreviation

- Apartment Apt
- Building Bldg
- Department Dept
- Floor Flr
- Lot Lot
- Room Rm
- Suite Ste
- Unit Unit

**27.11 Figure 1 – Unit Numbering**

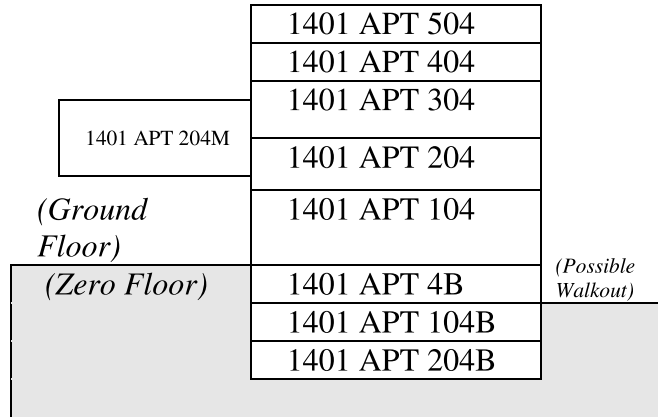

**27.11.4 Unit Number Assignment.** Unit

types are used to further define a space such as an apartment, a lot in a mobile home park, or an office suite in a large building. When assigning unit numbers, a numerical value is required. In a multi-level structure, the unit number shall reflect the floor on which it is located. For example, Apt 304 would be the fourth apartment located on the third floor or Suite 512 would be the twelfth suite on the fifth floor (See 27.11 Figure 1). The only time an alphanumeric value is allowed is to designate sub-basement floors and mezzanine levels and these are suffixed by the letter abbreviations B or M (See 27.11 Figure 1). The first floor below the floor designated as the ground floor even if it is a walkout basement is considered floor zero. Additional floors below floor zero are numbered based on the number of levels below zero floor.

**27.12 Signage Usage and Display.** Only officially approved road name and address signage shall be allowed.

**27.12.1 Address Signage.** Use of assigned official address is mandatory. Within sixty (60) days after written notice of the assignment of or change of an address number, the owner of such property shall be required to post the number so assigned in accordance with the following standards:

**27.12.1.1 Display of Official Address.** All addressable structures, see Section 27.11, shall clearly display an address number, even during construction. The owner and/or occupant of each addressable structure shall be required to clearly display an

address number on each addressable structure so that the location can be identified from the road.

**27.12.1.2 Placement of Official Address.** The official address number must be displayed at the main entrance of an addressable structure. If the main entrance of the addressable structure is not visible from the road, the official address number shall also be on the side of the addressable structure which is most visible from the road during both day and night. When an addressable structure is seventy-five (75) feet or more from a public road or driveway on which it fronts or the lot on which the building is located is landscaped such that numbers cannot be seen from the road or driveway entrance the assigned number shall also be posted at the end of the driveway or easement nearest the road which provides access to the building. Manufactured homes in mobile home parks shall display the assigned address and lot number on the side of the manufactured home closest to the road/driveway which serves the lot so that the number is clearly visible from the road/driveway at all times.

#### **27.12 Figure 1 – Directional Address Signage**

**27.12.1.3 Directional Address Signage.** Directional address signage shall be required for any addressable structure located off the main road or that requires specific knowledge to locate. This also applies to any driveway or private road that services multiple structures or owners. A directional sign shall be placed so that it is visible from the intersection of the driveway or private road and public road. Directional sign shall be blue with white numbers that are a minimum of four (4) inches in height and placed on a standard street sign post (See 27.12 Figure 1).

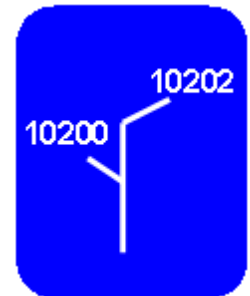

**27.12.1.4 Address Signage Sizing.**

**27.12.1.4.1 Address Number Visibility.** Address numbers shall be in a contrasting color to the color scheme of the addressable structure so that they are clearly visible and shall be maintained in a clearly

visible manner. Reflective numbers are desirable but not required.

27.12.1.4.1.1 Single Family Dwelling. Single family dwelling address numbers shall be a minimum of four (4) inches in height and shall be posted so as to be legible from the road.

27.12.1.4.1.2 Multiple Dwelling Units. Multiple dwelling building address numbers shall be at least six (6) inches in height.

27.12.1.4.1.3 Manufactured Home Parks. Manufactured home parks shall erect a sign at the entrance to the park displaying the name of the park and the assigned road address with numbers at least six (6) inches in height.

27.12.1.4.1.4 Manufactured Homes in a Mobile Home Park. Manufactured homes in a mobile home park address numbers shall be a minimum of four (4) inches in height.

27.12.1.4.1.5 Commercial or Industrial Structures. Commercial/Industrial structure address numbers shall be at least six (6) inches in height.

27.12.1.4.2 Address Signage Maintenance. Following the posting of the assigned number as required, the owner or occupant shall maintain such house or building numbers at all times in compliance with the above referenced standards. Address numbers shall not be obstructed from view by shrubs or vegetation as viewed from the public road.

## 27.12.2 Road Name Signage and Sign Sizing.

27.12.2.1 Public Road Name Signage. Signs are to be green with white letters and adhere to the Boone County Public Works Department road name signage standards and comply with all abbreviation and naming standards found within this section. The sign shall include both N-S and E-W address coordinate numbers, root road name, and suffix (See 27.12



Figure 2). Furthermore, the cross-street address coordinate number shall be located on the first line in the upper right and the through-street coordinate number shall be located directly below the cross-street address coordinate.

**27.12 Figure 2**

27.12.2.2 Public Road Name Sign Sizing. Public road name sign sizing shall adhere to the Boone County Public Works Department road name sign sizing standards.



27.12.2.3 Private Road Name Signage. Signs are to be white with black letters and adhere to the Boone County Public Works Department road name signage standards and comply with all abbreviation and naming standards found within this section. The sign shall include both N-S and E-W address coordinate numbers, root road name, and suffix (See 27.12 Figure 2). Furthermore, the cross-street address coordinate number shall be located on the first line in the upper right and the through-street coordinate number shall be located directly below the cross-street address coordinate.

Private road name signs located along public roads are the responsibility of the Public Works Department or designated entity. Private road name signs located within the development are the responsibility of the owners residing on the private road, and the road name signs shall match placement and height of official road name signs, and shall display the road name on both sides.

27.12.2.4 Private Road Name Sign Sizing. Private road name sign sizing shall adhere to the Boone County Public Works Department road name sign sizing standards.

27.12.3 Non-compliant Signs. Non-compliant signs within the right-of-way shall be removed by Boone County Public Works Department staff.

27.13 Penalties and Remedies. Any owner, lessee, tenant, occupier of land or other person who violates any provision of these regulations shall be deemed guilty

of a misdemeanor and shall be upon conviction punished as provided by law. Each day a violation of these regulations continues shall constitute a separate offense. The penalty provided in this section shall not be construed to be exclusive but is intended to be supplemental and in addition to any other remedy provided by law or at equity. The County may institute any appropriate action or proceeding to prevent any unlawful activity proscribed in this ordinance or to correct any violation of this ordinance.

27.14 Severability. If any part or provision of these regulations is declared invalid or unconstitutional then the remainder of these regulations shall not be declared invalid or unconstitutional but shall remain in full force and effect to the greatest extent permitted by law.

27.15 Jurisdiction. These regulations shall be applicable to all unincorporated areas within Boone County, Missouri.

## **SECTION 28 STORM WATER ORDINANCE**

\*The Storm Water Ordinance was amended as Section 28 on the latest re-adoption date of March 7, 2017. Some section and sub-section references in the content of the Storm Water Ordinance were not updated. Section 28. should be added to the beginning of referenced sections and sub-sections.

### 28.1. General Provisions

#### 28.1.1.FINDINGS OF FACT

It is hereby determined that:

- (1) Land development activities and associated increases in site impervious cover alter the hydrologic response of local watersheds and increase stormwater runoff rates and volumes, flooding, stream channel erosion, sediment transport and deposition;
- (2) This stormwater runoff contributes to increased quantities of water-borne pollutants;
- (3) Illicit and non-stormwater discharges to the storm drain system can contribute a wide variety of pollutants to waterways, and the control of these discharges is necessary to protect public health and safety and water quality;