

Case # 182-2023 - OPR SUBDIVISION PLAT 2

Zoning Map Amendment



- Columbia City Limit
- City Property
- City Zoning
- Parcels



Parcel Data Source: Boone County Assessor

Created by The City of Columbia - Community Development Department

2022 Imagery: NearMap

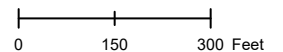

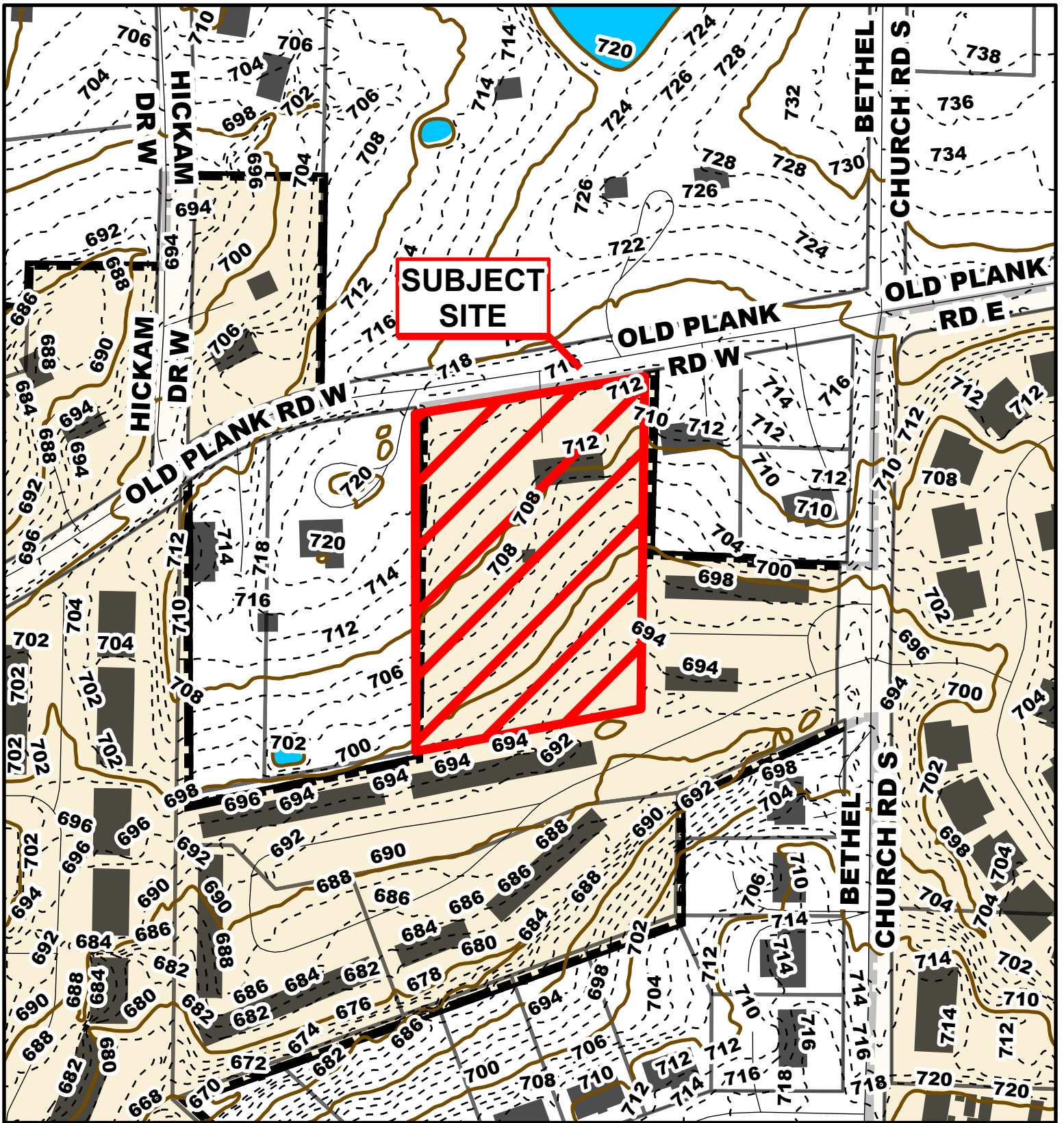

Case # 182-2023 - OPR SUBDIVISION PLAT 2

Zoning Map Amendment



- 10 Foot Contour Lines
- 2 Foot Contour Lines
- City of Columbia
- Parcels

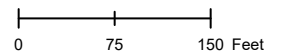

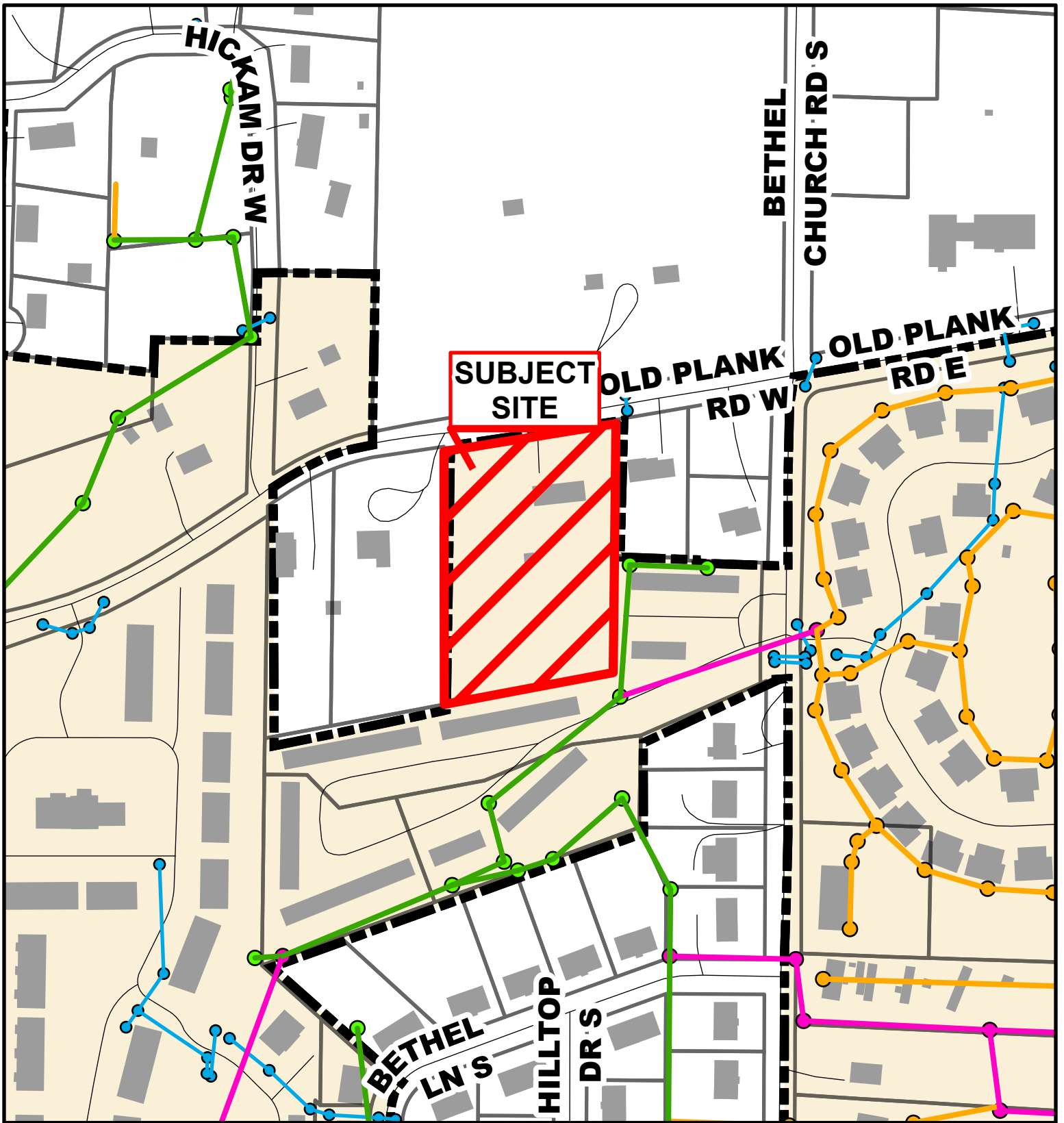

Case # 182-2023 - OPR SUBDIVISION PLAT 2

Zoning Map Amendment



- City Sanitary Line
- BCRSD Sanitary Line
- Private Sanitary Line
- City Storm Lines
- Parcels
- Columbia City Limits

