

Source: Nearmap. <https://www.nearmap.com/us/en/>

Case # 218-2023 - NW Corner Rolling Hills Road & Highway WW Rezoning



- Columbia City Limit
- City Zoning
- City Property
- Parcels



Parcel Data Source: Boone County Assessor

Created by The City of Columbia - Community Development Department

2022 Imagery: NearMap

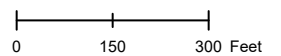

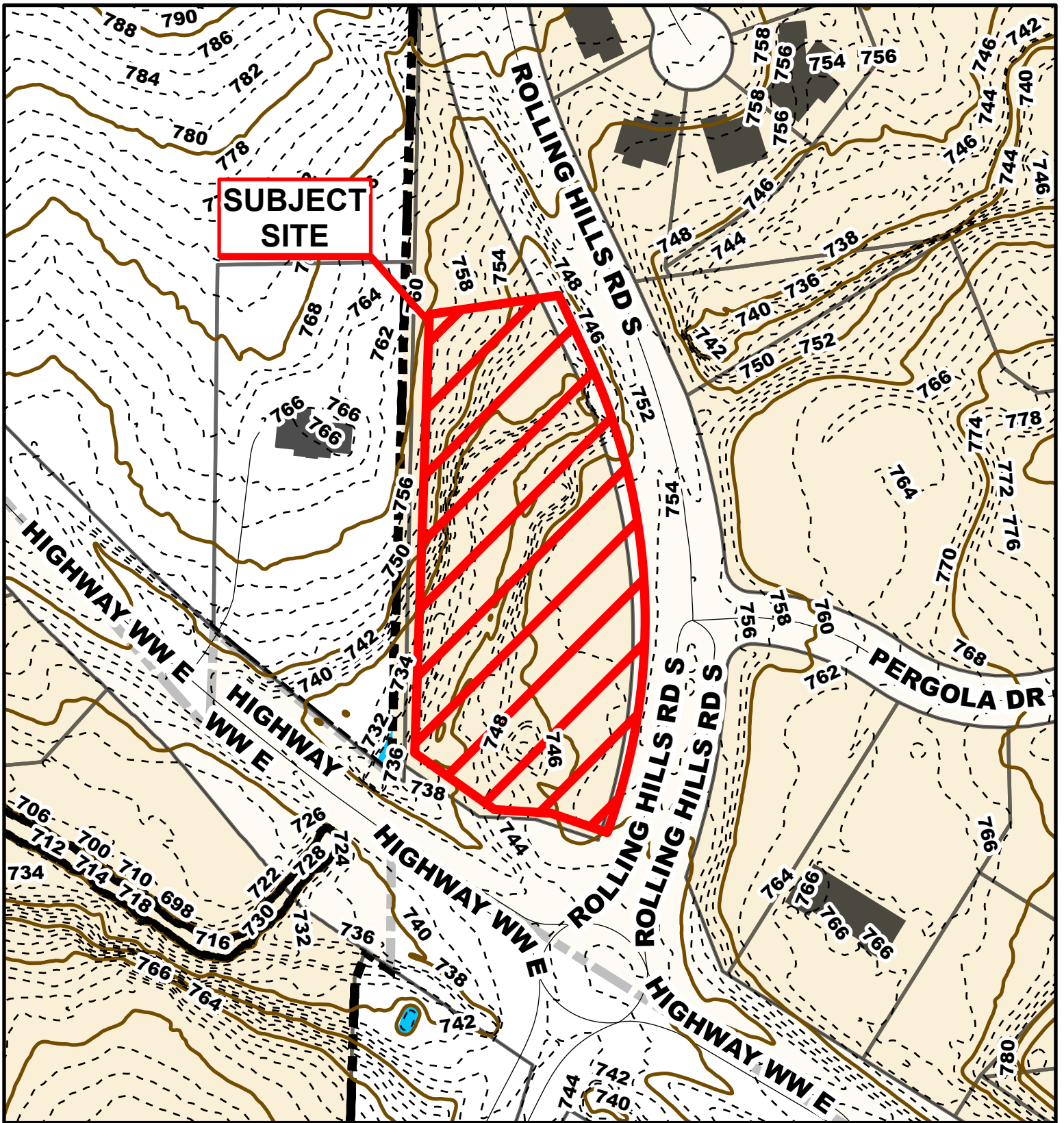

Case # 218-2023 - NW Corner Rolling Hills Road & Highway WW E Rezoning



- 10 Foot Contour Lines
- 2 Foot Contour Lines
- City of Columbia
- Parcels

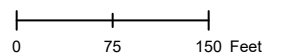

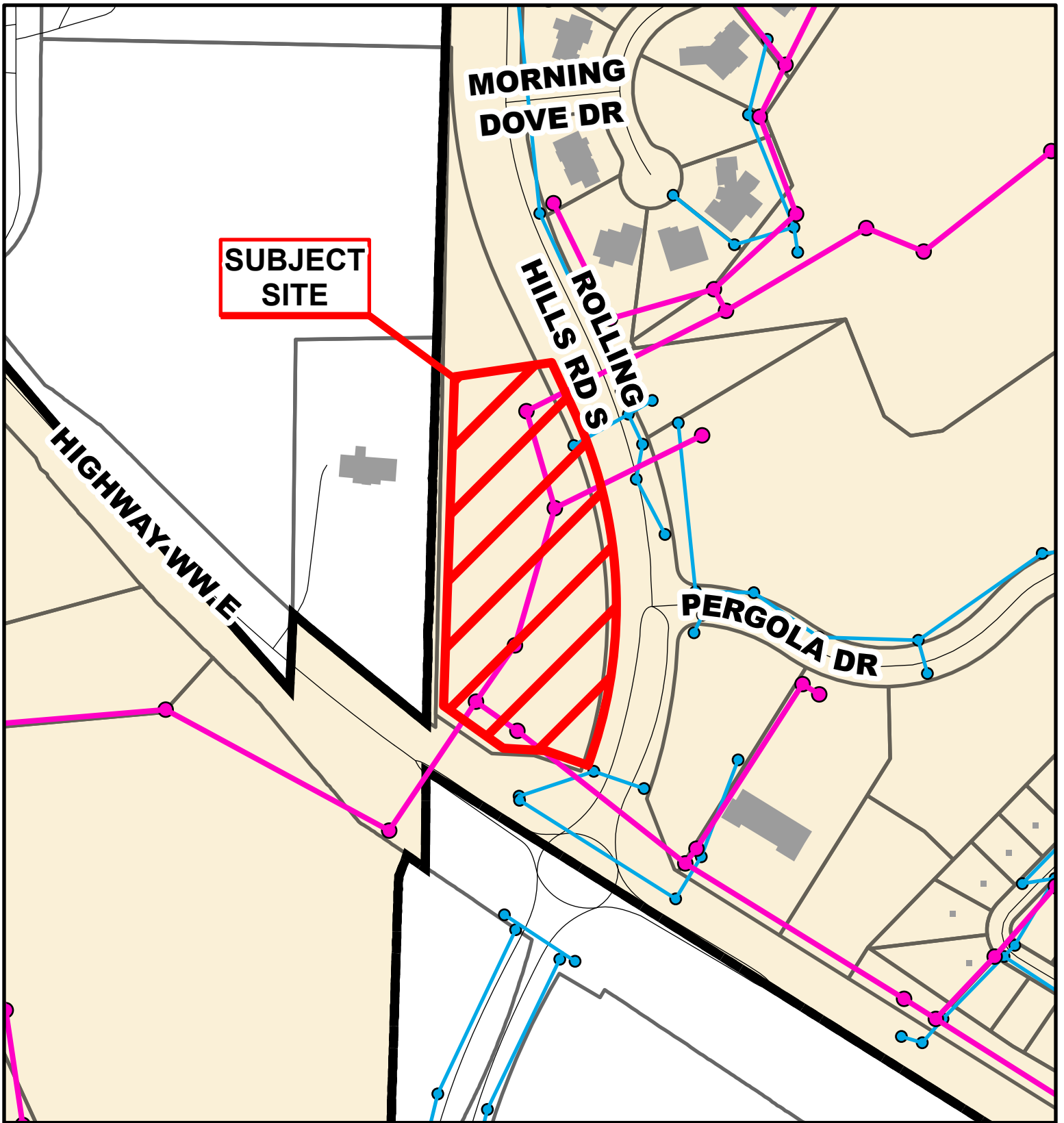

Case # 218-2023 - NW Corner Rolling Hills Road & Highway WW Rezoning



- City Sanitary Line
- City Storm Lines
- Parcels
- Columbia City Limits

