

Case # 180-2024 - 551 Veterans United Dr Easement Vacation



City Zoning
 Parcels



Parcel Data Source: Boone County Assessor

Created by The City of Columbia - Community Development Department

2022 Imagery: NearMap

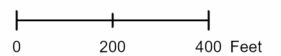

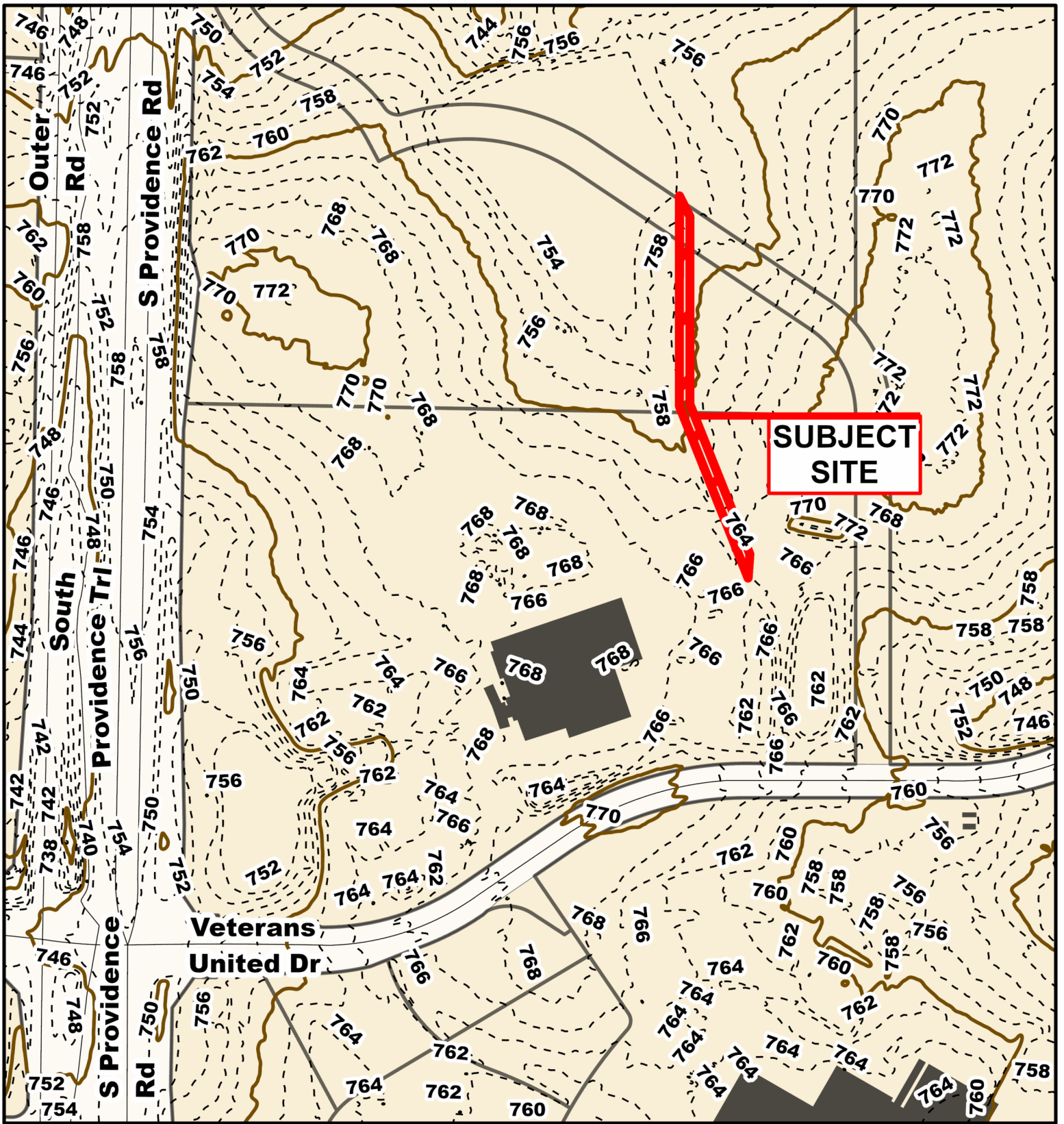

Case # 180-2024 - 551 Veterans United Dr Easement Vacation



- 10 Foot Contour Lines
- 2 Foot Contour Lines
- Parcels

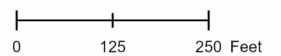

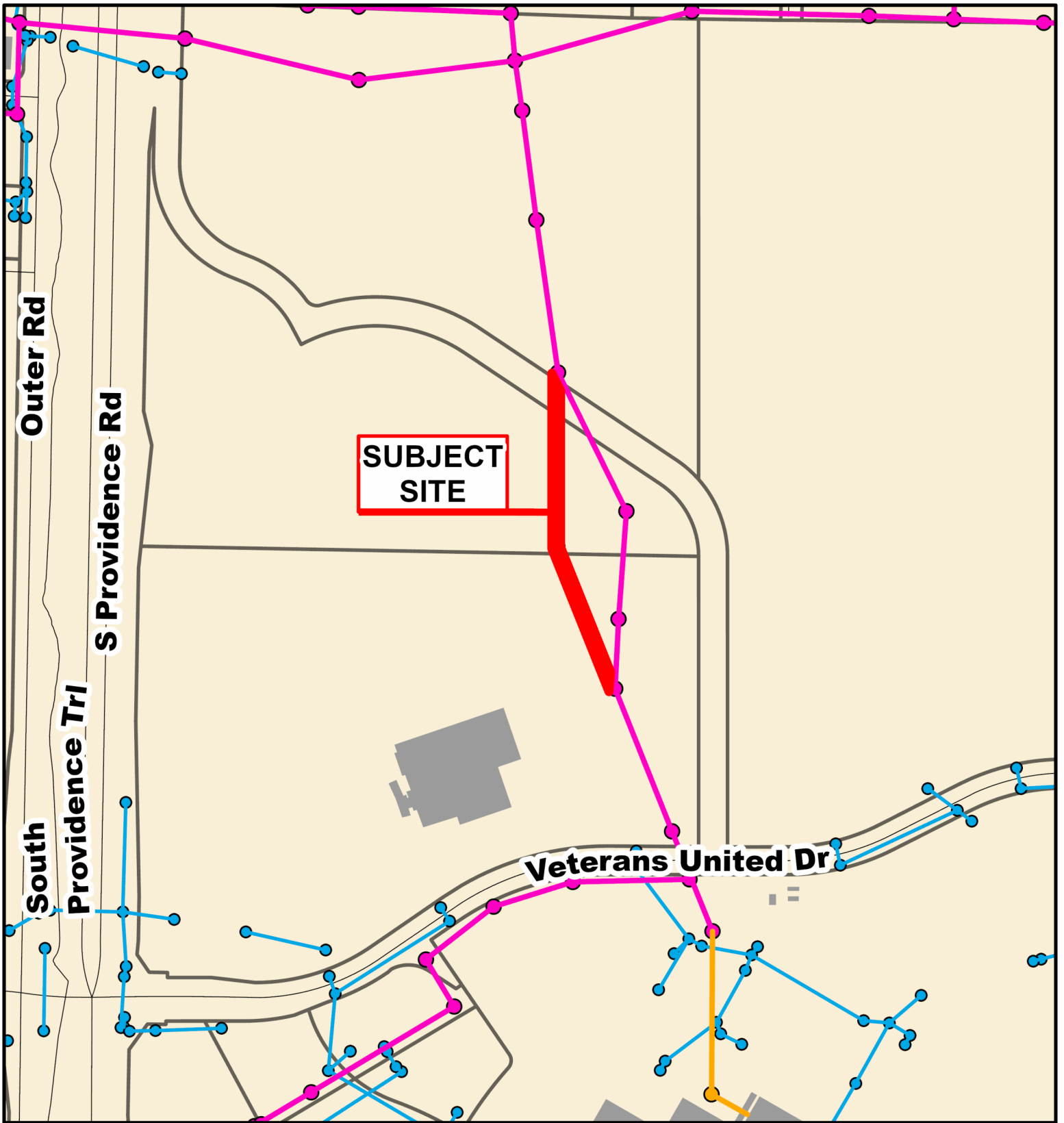

Case # 180-2024 - 551 Veterans United Dr Easement Vacation



- City Sanitary Line
- City Storm Lines
- Private Sanitary Line
- Parcels

