

PETITION REQUESTING ANNEXATION TO THE CITY OF COLUMBIA

Club Car Wash Prathersville, LLC, a Delaware limited liability company, hereby petitions the City Council of the City of Columbia to annex the land described below into the corporate limits of Columbia and, in support of this petition, states the following:

1. Club Car Wash Prathersville, LLC is the owner of all fee interests of record in the real estate in Boone County, Missouri, described as follows:

Legal Description – See attached

- 2. This real estate is not now a part of any incorporated municipality.
- 3. This real estate is contiguous and compact to the existing corporate limits of the City of Columbia, Missouri.
- 4. Club Car Wash Prathersville, LLC requests that this real estate be annexed to, and be included within the corporate limits of the City of Columbia, Missouri, pursuant to Section 71.012, RSMo 1994.
- 5. Petitioner requests that the property be zoned IG at the time of annexation. If the requested zoning is not granted by the proposed ordinance annexing the property, petitioner reserves the right to withdraw this petition requesting annexation.

Dated this 2 day of December, 2024.

STATE OF MISSOURI)
) ss.
COUNTY OF BOONE)

RECEIVED
DEC 02 2024
PLANNING DEPT.

VERIFICATION

The undersigned, Collin BARTELS, being of lawful age and after being duly sworn states and verifies that the undersigned has reviewed the foregoing Petition for Voluntary Annexation, and that the undersigned is duly authorized to execute the foregoing instrument on behalf of Club Car Wash Prathersville, LLC and acknowledges the requests, matters and facts set forth therein are true and correct to the best of the undersigned's information and belief.

Collin Bartels

Subscribed and sworn to before me this 2nd day of December, 2024.

Tiffany Boyd
Notary Public

My commission expires: 12-12-2026

Tiffany Boyd
Notary Public-Notary Seal
STATE OF MISSOURI
Commissioned for Boone County
My Commission Expires: 12/12/2026
ID. #22587451

A TRACT OF LAND LOCATED IN THE NORTHWEST QUARTER OF SECTION 19, TOWNSHIP 49 NORTH, RANGE 12 WEST, BOONE COUNTY, MISSOURI AND BEING ALL OF LOT 1, CENTRAL BRIDGE SUBDIVISION, PLAT NO. 2, RECORDED IN PLAT BOOK 55, PAGE 63 AND DESCRIBED BY WARRANTY DEED RECORDED IN BOOK 5448, PAGE 157.

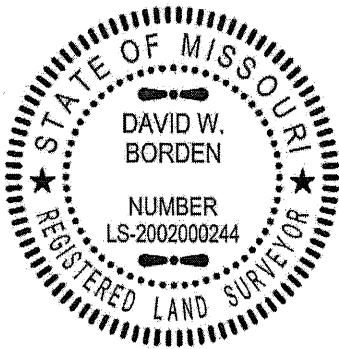

David W. Borden

DAVID W. BORDEN, PLS-2002000244

11/7/24
DATE

| | | |
|--------------------------------------------------------------------------------------------------------------------------------------------------------------------------------------------------------------------|-----------------------------------|------------------------------------------------------------------------------------------------------------------------------|
| CROCKETT ENGINEERING CONSULTANTS 1000 W. Nifong Blvd. Building 1 Columbia, Missouri 65203 (573) 447-0292 www.crockettengineering.com | CORPORATE NUMBER 2000151304 | LOT 1 DESCRIPTION CENTRAL BRIDGE SUBDIVISION, PLAT NO. 2 LOCATED IN S19-T49N-R12W BOONE COUNTY, MISSOURI |
| | DATE: 11/7/2024 | |
| | PROJECT: 210032 | |