

Source: Nearmap. <https://www.nearmap.com/us/en>

Case # 263-2023 - Lot 14B & 14C Woodrail Terrace

Final Plat



City Zoning Parcels



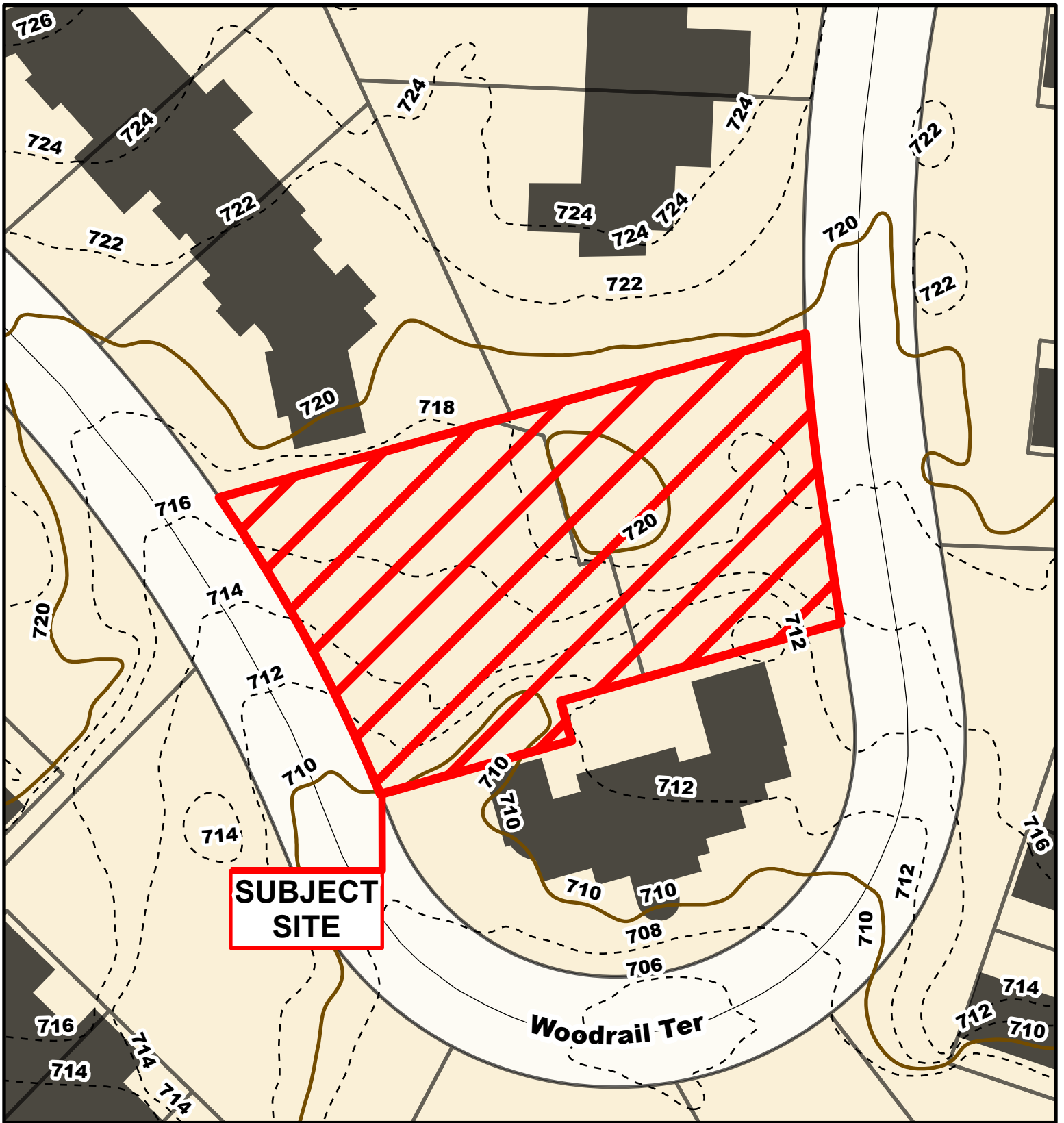

Case # 263-2023 - Lot 14B & 14C Woodrail Terrace

Final Plat



Parcel Data Source: Boone County Assessor
 Created by The City of Columbia - Community Development Department

- 10 Foot Contour Lines
- 2 Foot Contour Lines
- Parcels

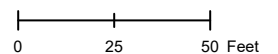

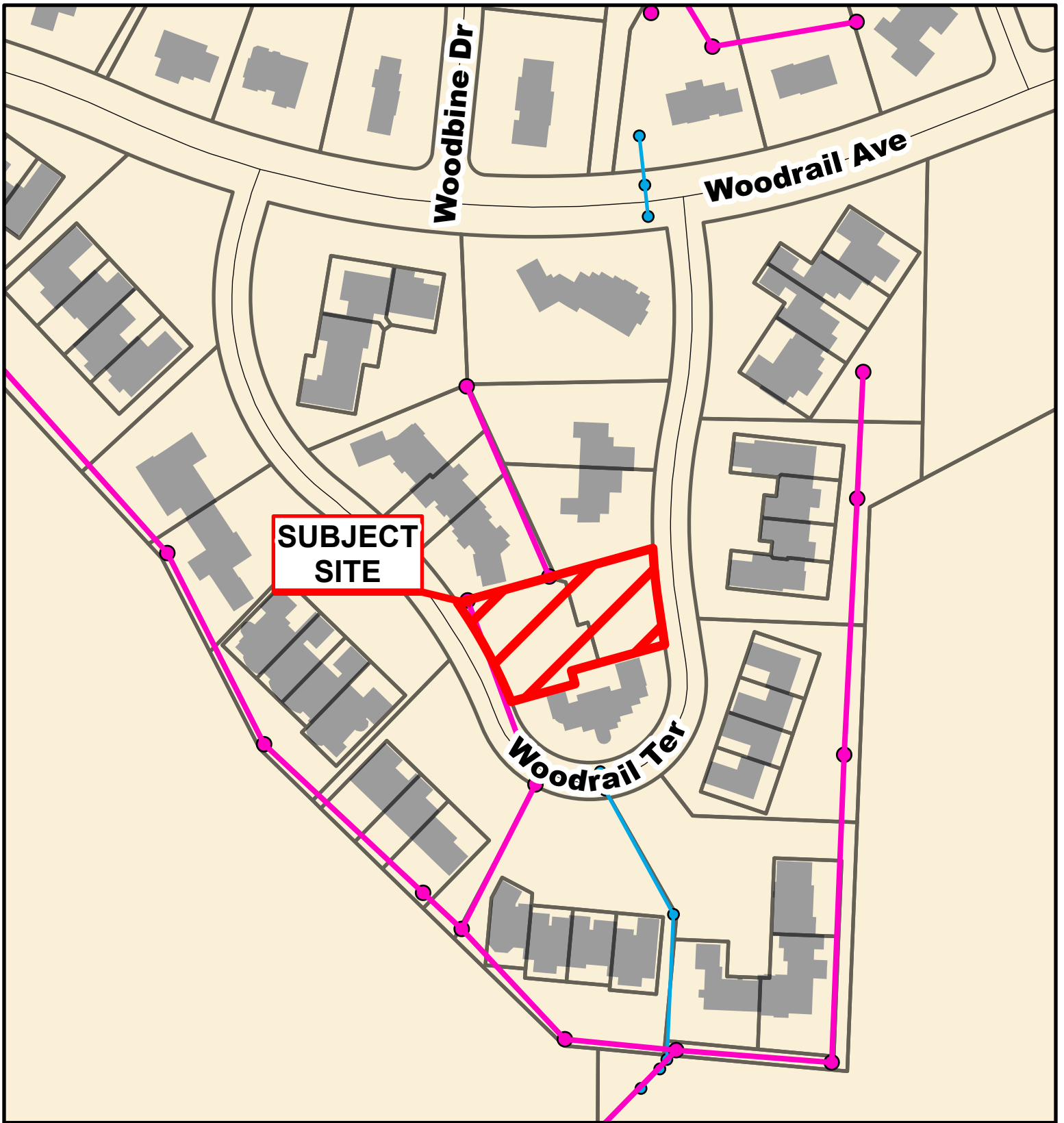

Case # 263-2023 - Lot 14B & 14C Woodrail Terrace

Final Plat



- City Sanitary Line
- City Storm Lines
- Parcels

