

Case # 100-2025 - 1710 Chapel Hill Road Rezoning



- Columbia City Limit
- City Property
- City Zoning
- Parcels



Parcel Data Source: Boone County Assessor

Created by The City of Columbia - Community Development Department

2024 Imagery: NearMap

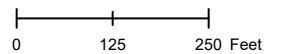

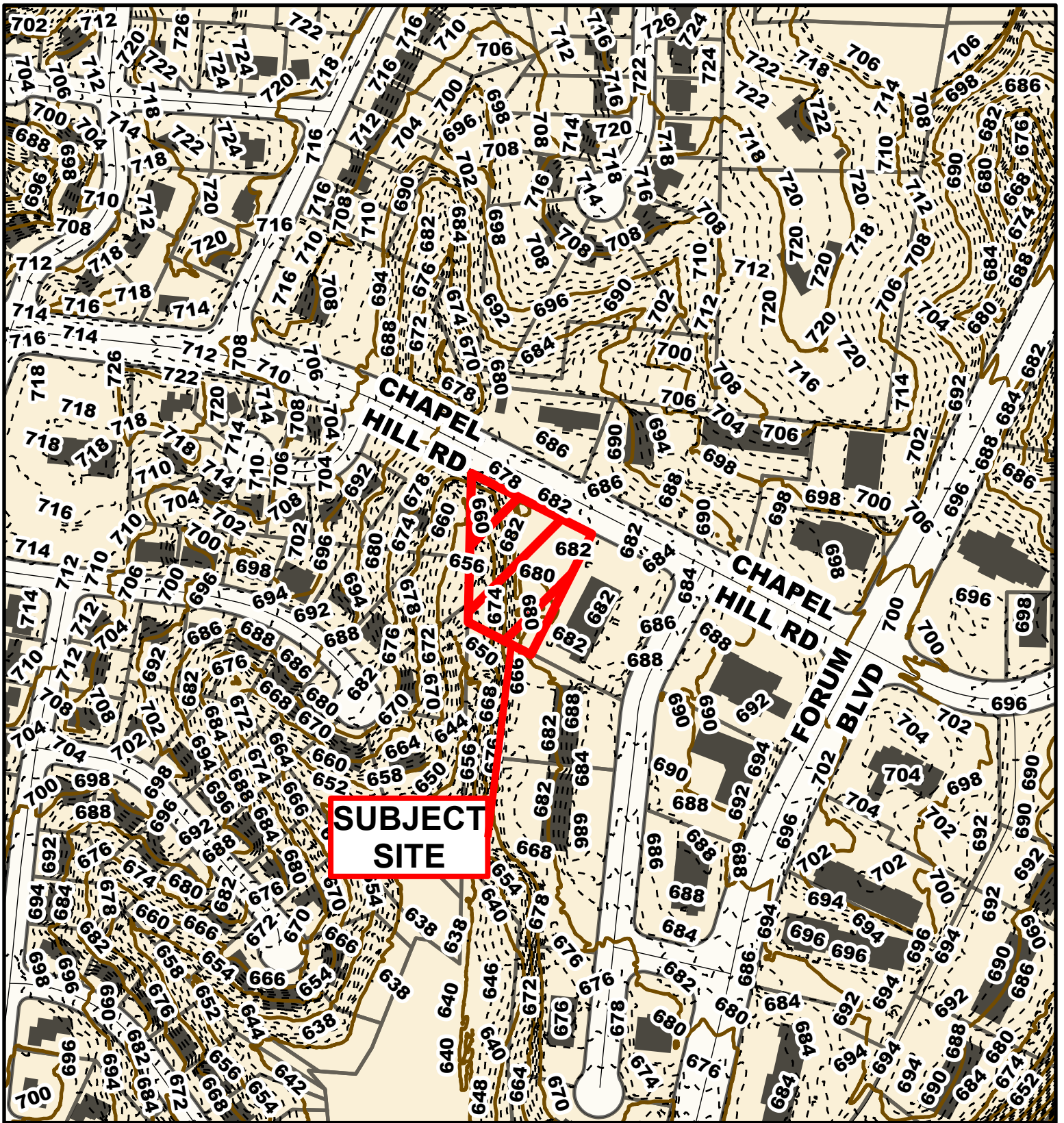

Case # 100-2025 - 1710 Chapel Hill Road Rezoning



- 10 Foot Contour Lines
- City of Columbia
- 2 Foot Contour Lines
- Parcels

N



Parcel Data Source: Boone County Assessor

Created by The City of Columbia - Community Development Department

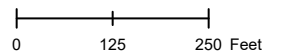

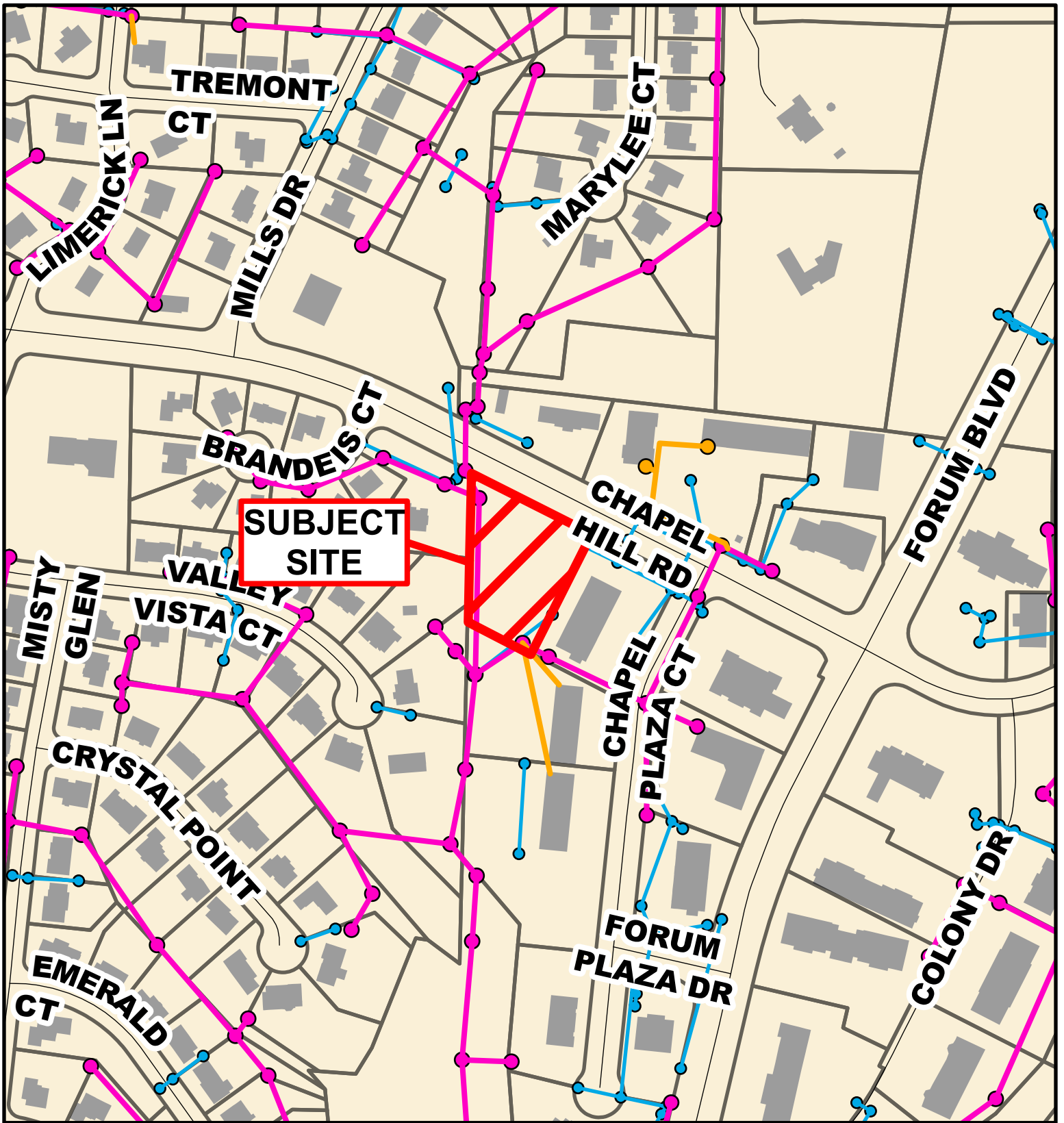

Case # 100-2025 - 1710 Chapel Hill Road

Rezoning



- City Sanitary Line
- City Storm Lines
- Private Sanitary Line
- Parcels
- Columbia City Limit

