

**RIGHT OF USE PERMIT**

KNOW ALL MEN BY THESE PRESENT that on this \_\_\_\_\_ day of \_\_\_\_\_, 2026 the City of Columbia, a municipal corporation, in consideration of the sum of fifty dollars (\$50.00) and other considerations to it paid, does hereby permit **The Curators of the University of Missouri** (hereinafter referred to as “Permittee”) to enter upon the following described lands owned by the City of Columbia and located within the right-of-way of S. 6<sup>th</sup> Street, Columbia, County of Boone, State of Missouri, and more particularly described as follows, to-wit:

The right-of-way from the intersection of E. Stewart Road and S. 6<sup>th</sup> Street 600 feet north within the limits of the City of Columbia, further shown on the diagram attached to this right-of-use permit as Exhibit 1.

**This permit is subject to the following conditions and stipulations:**

1. This permit is for the exclusive purpose of construction by Permittee of new hot water distribution pipe, steam pipe, chilled water distribution pipe, storm sewer, control conduit, domestic water pipe, electric duct bank and/or electric manhole (collectively the “Facilities” or each a “Facility”) in the road right-of-way identified above.
2. This permit does not grant Permittee or any of its officers, agents or employees the right to cut, break, excavate or damage the street surface of S. 6<sup>th</sup> Street without City consent.
3. Permittee will be responsible for the costs of any future repairs, maintenance or replacements which result from Permittee’s use under this right-of-use permit.
4. Permittee agrees that the new Facility to be installed pursuant to this right-of-use permit shall be installed with at least a 24-inch separation when running parallel to any gas lines operated by Ameren Missouri. All areas where the gas line crosses the new Utilities will be coordinated with Ameren Missouri.
5. Prior to exercising its right granted herein, the Permittee shall present its construction plans or diagrams locating the proposed Facilities to the City Public Works Department and City Water and Light Department and any other utility existing in the rights-of-way to insure that the proposed plans will not interfere with any existing utility. The Permittee will relocate its improvement if requested to do so by an existing utility.
6. Prior to exercising its rights hereunder, Permittee agrees to obtain all necessary permits required by the City of Columbia pertaining to the work being done in the rights-of-way and to submit a traffic-routing plan to be approved by the City Public Works Department.
7. If a the Facilities are abandoned, all rights herein granted to such abandoned Facility shall cease and terminate and Permittee shall have no further right of interest therein or thereto.

8. If, at any time, the construction, repair, modification or relocation of a Facility by City or another permittee for a public purpose requires the relocation of Permittee's Facility, the Permittee shall relocate the affected Facility at its expense.
9. The Permittee agrees by exercising its rights under this permit that if its underground Facilities are damaged by City or another permittee due to negligence, Permittee will release and, to the extent permitted by Missouri law and without waiving sovereign immunity, hold harmless City for any of the cost associated with the repair or replacement and any other costs associated with the damage to the Facilities.

This permit shall remain in effect until canceled by the City of Columbia, which shall be obligated to notify Permittee one (1) year in advance of the cancellation.

IN WITNESS WHEREOF, the said party of the First Part has caused these presents to be signed by its officers the day and year first written above.

CITY OF COLUMBIA, MISSOURI

BY: \_\_\_\_\_  
De'Carlton Seewood, City Manager

SSC

ATTEST:

\_\_\_\_\_  
Sheela Amin, City Clerk

APPROVED AS TO FORM:

\_\_\_\_\_  
Nancy Thompson, City Counselor/ AK

THE CURATORS OF THE UNIVERSITY  
OF MISSOURI:

\_\_\_\_\_

# Exhibit 1

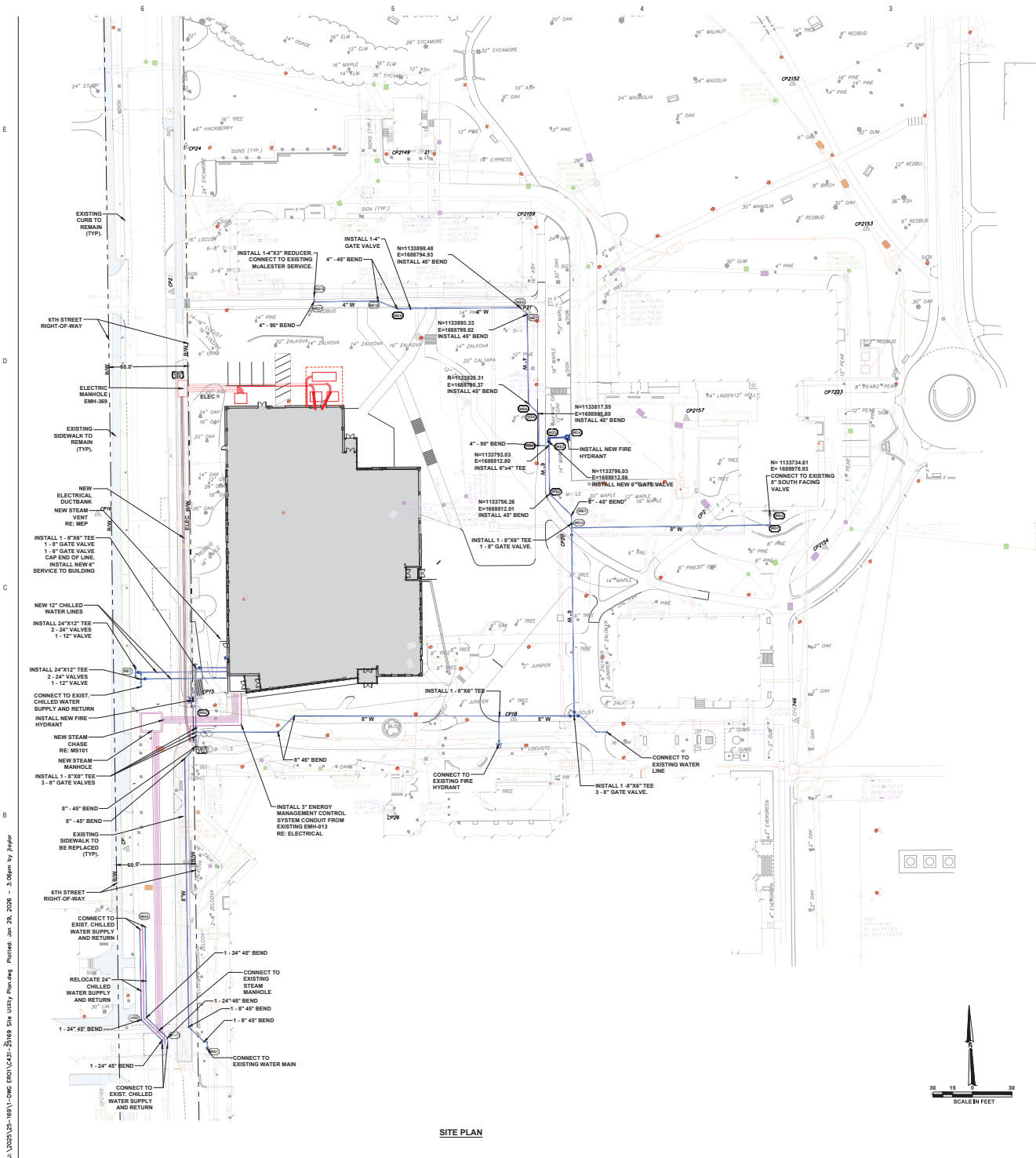

**EXISTING UTILITY LEGEND**

LEGEND	
---	UNDERGROUND ELECTRIC LINE
---	HIGH VOLTAGE ELECTRIC LINE
---	UNDERGROUND TELECOMMUNICATIONS LINE
---	SANITARY SEWER LINE
---	STORM SEWER LINE
---	STEAM LINE
---	WATER LINE
---	CHILLED WATER LINE
---	FASE
---	EXISTING CONTOUR
---	CONTROL POINT
---	CAST IRON PIPE
---	CEMENT
---	CEMENT WATER PULL BOX
---	DUCTILE IRON PIPE
---	ELECTRIC MANSION
---	ELECTRIC TRANSFORMER
---	FIRE HYDRANT
---	FIRE LINE
---	FIRE OPTIC FIBERBURY
---	HIGH DENSITY POLYETHYLENE PIPE
---	PARKING WATER
---	POLYETHYLENE GLYCOL PIPE
---	REINFORCED CONCRETE PIPE
---	ROOF DRAIN
---	TOP OF WALL
---	UTILITY POLE
---	UNDERGROUND ROOF DRAIN
---	WATER VALVE

**LEGEND:**

[Symbol]	NEW BUILDING
[Symbol]	NEW CONCRETE SIDEWALK
[Symbol]	EXISTING CONCRETE SIDEWALK TO REMAIN
[Symbol]	W NEW WATER SERVICE
[Symbol]	CW NEW CHILLED WATER SERVICE
[Symbol]	ELEC NEW ELECTRICAL DUCT/PIPE
[Symbol]	STM NEW STEAM PIPE CHASE

**PGAV ARCHITECTS**  
 ARCHITECTS  
 601 Second Avenue, Suite 501  
 Columbia, Missouri 65201  
 314.435.3400  
 www.pgav.com

**LMN**  
 ARCHITECTS  
 1001 North 1st Street  
 Columbia, Missouri 65201  
 314.435.3400  
 www.lmn.com

**SK**  
 SR Design Group, Inc.  
 400 North 1st Street  
 Columbia, Missouri 65201  
 314.435.3400  
 www.skdesign.com

**HORNER SHIFFRIN**  
 ARCHITECTS  
 1001 North 1st Street  
 Columbia, Missouri 65201  
 314.435.3400  
 www.horner-shiffrin.com

DATE: 01/16/2026  
 PROJECT: 5307-00  
 DRAWING: C-431

**ENERGY INNOVATION CENTER**  
 UNIVERSITY OF MISSOURI  
 408 SOUTH 6TH STREET  
 COLUMBIA, MISSOURI  
 MUEC ERO #1  
 50% CD

**SITE UTILITY PLAN**

**C-431**

1/16/2026 10:27:26AM  
 U:\30023-25-101\CD\5307-00\5307-00-01\Energy\mucic\ero\5307-00-01.dwg  
 1/16/2026 10:27:26AM  
 U:\30023-25-101\CD\5307-00\5307-00-01\Energy\mucic\ero\5307-00-01.dwg  
 1/16/2026 10:27:26AM  
 U:\30023-25-101\CD\5307-00\5307-00-01\Energy\mucic\ero\5307-00-01.dwg  
 1/16/2026 10:27:26AM  
 U:\30023-25-101\CD\5307-00\5307-00-01\Energy\mucic\ero\5307-00-01.dwg  
 1/16/2026 10:27:26AM  
 U:\30023-25-101\CD\5307-00\5307-00-01\Energy\mucic\ero\5307-00-01.dwg