

**Case # 106-2024 - 208 St. Joseph Street**  
**Final Plat**



City Zoning Parcels

Parcel Data Source: Boone County Assessor

Created by The City of Columbia - Community Development Department

2022 Imagery: NearMap

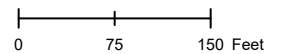



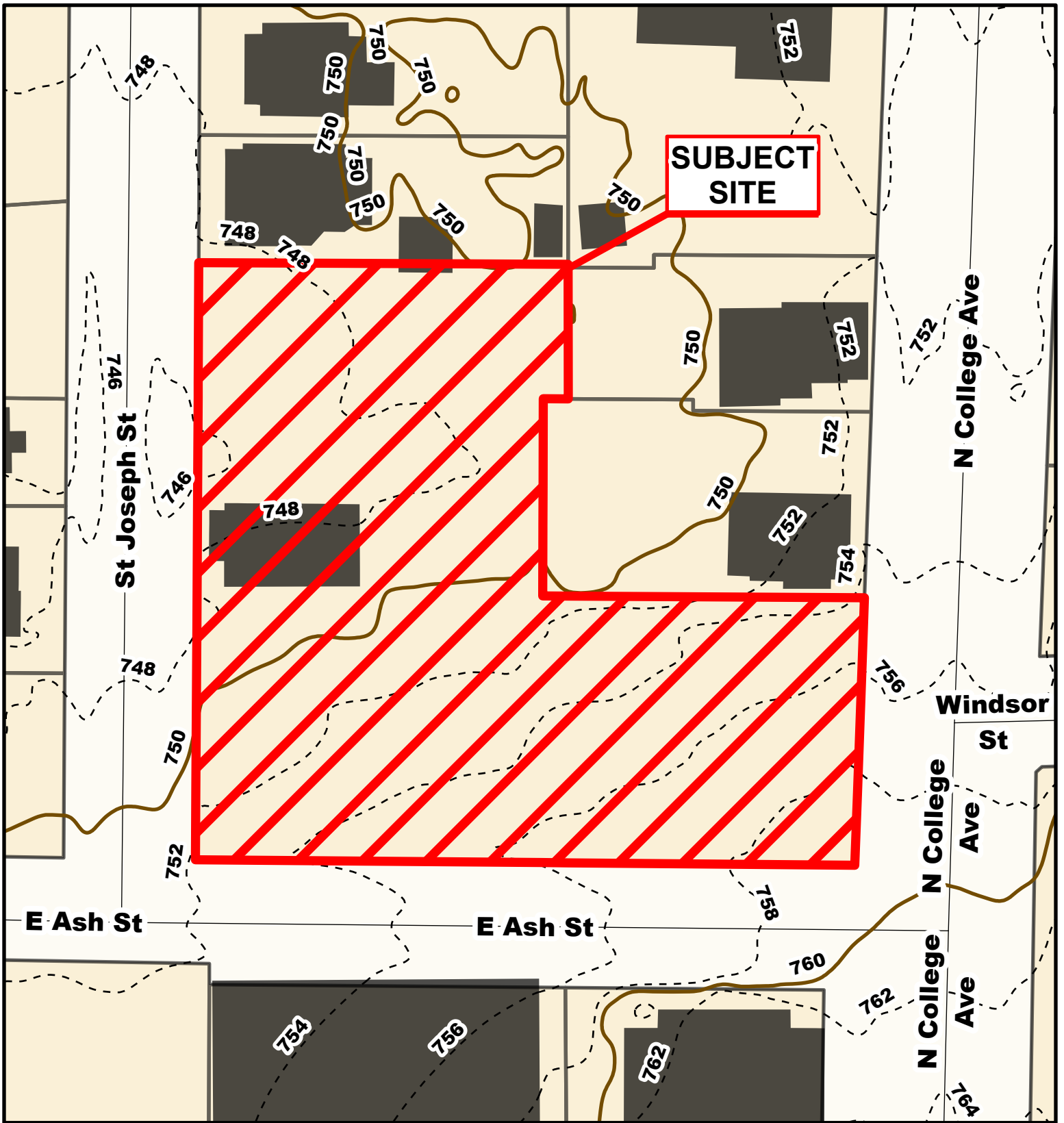

**Case # 106-2024 - 208 St. Joseph Street**  
**Final Plat**



— 10 Foot Contour Lines    □ Parcels  
 - - - 2 Foot Contour Lines



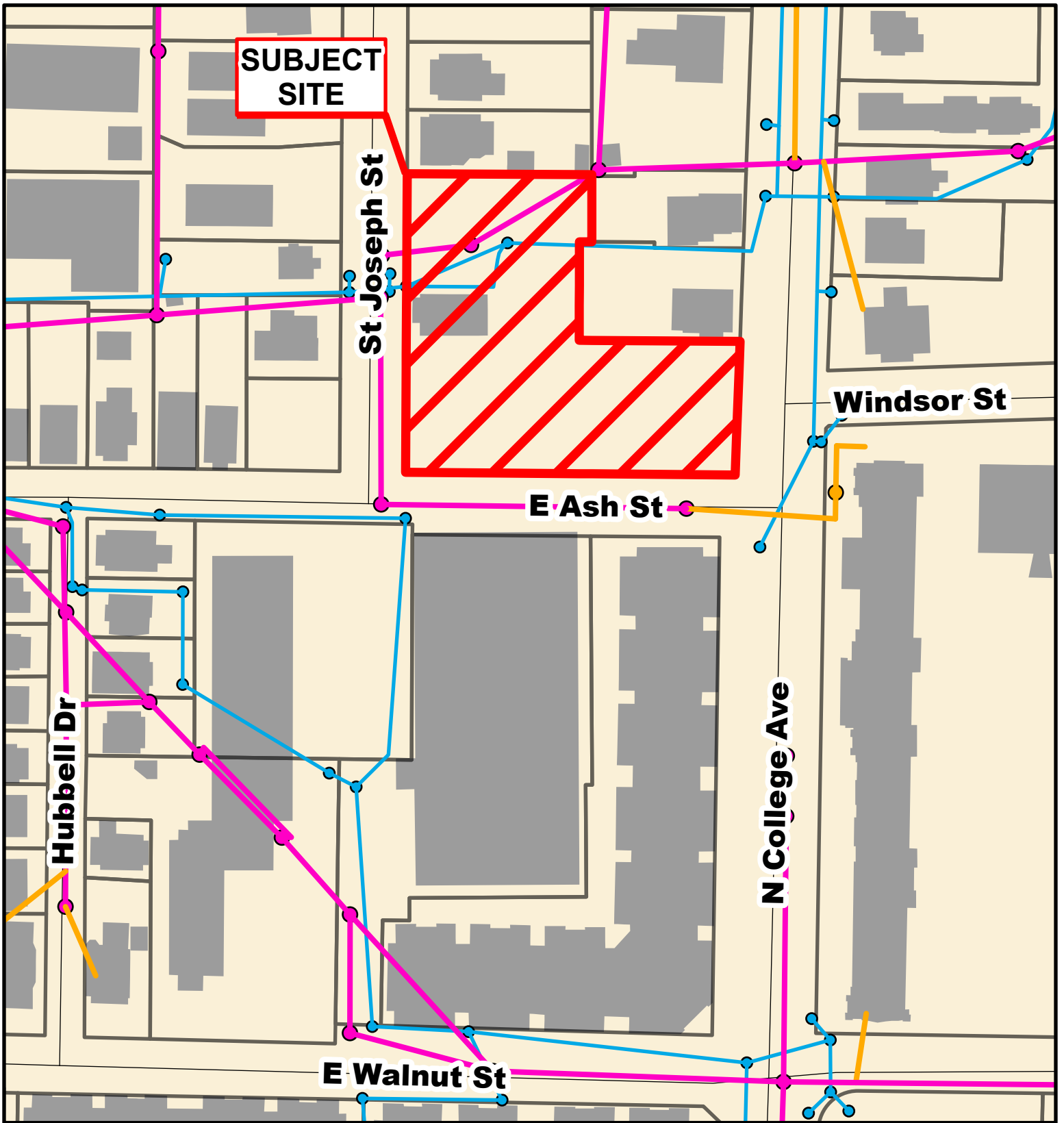

**Case # 106-2024 - 208 St. Joseph Street**  
**Final Plat**



- City Sanitary Line
- City Storm Lines
- Private Sanitary Line
- Parcels

