

Case # 142-2023 - 1605 Westwinds Drive Rezoning



City Zoning Parcels

Parcel Data Source: Boone County Assessor

Created by The City of Columbia - Community Development Department

2022 Imagery: NearMap

0 200 400 Feet

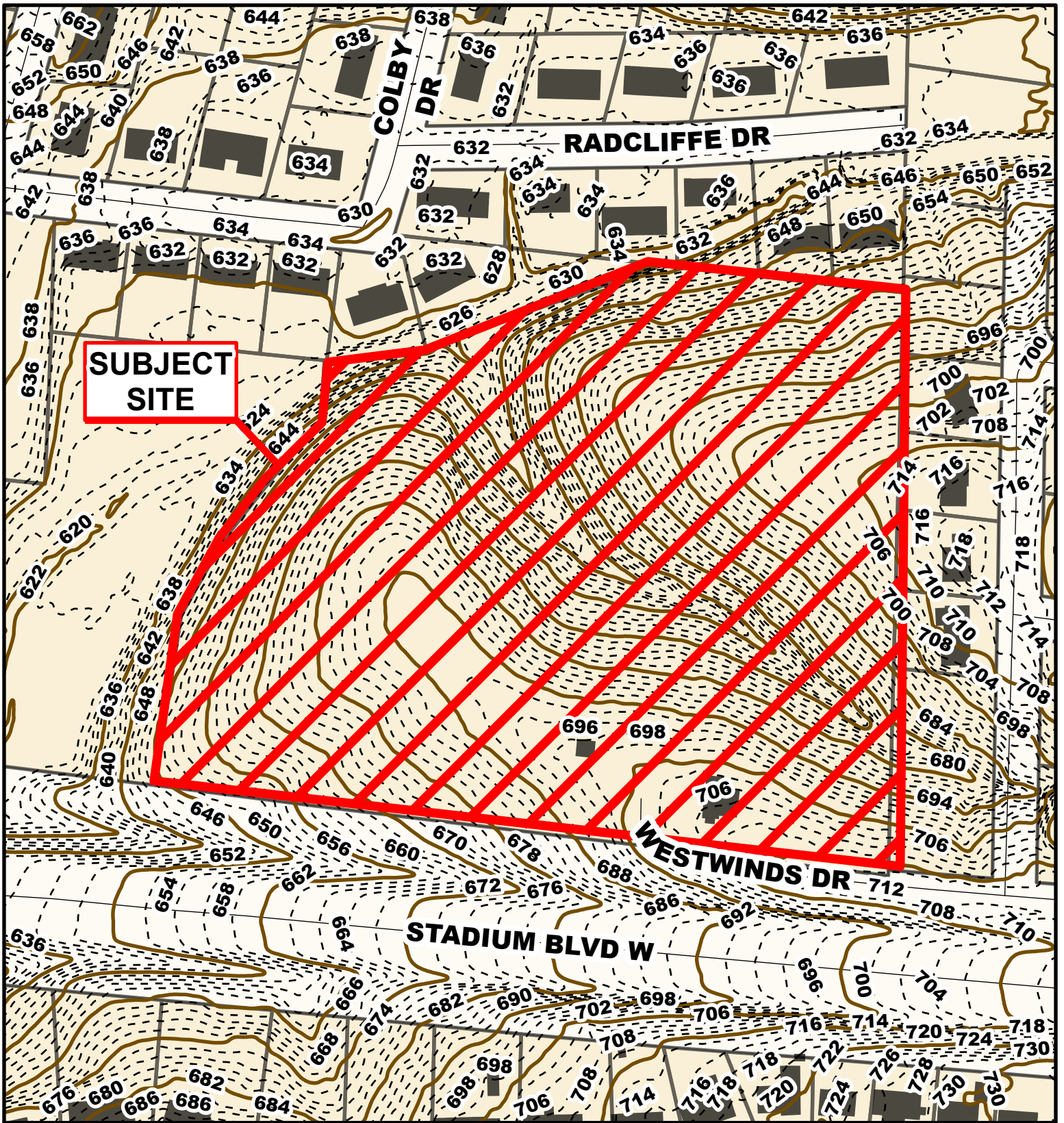

Case # 142-2023 - 1605 Westwinds Drive

Rezoning



- 10 Foot Contour Lines
- 2 Foot Contour Lines
- City of Columbia
- Parcels



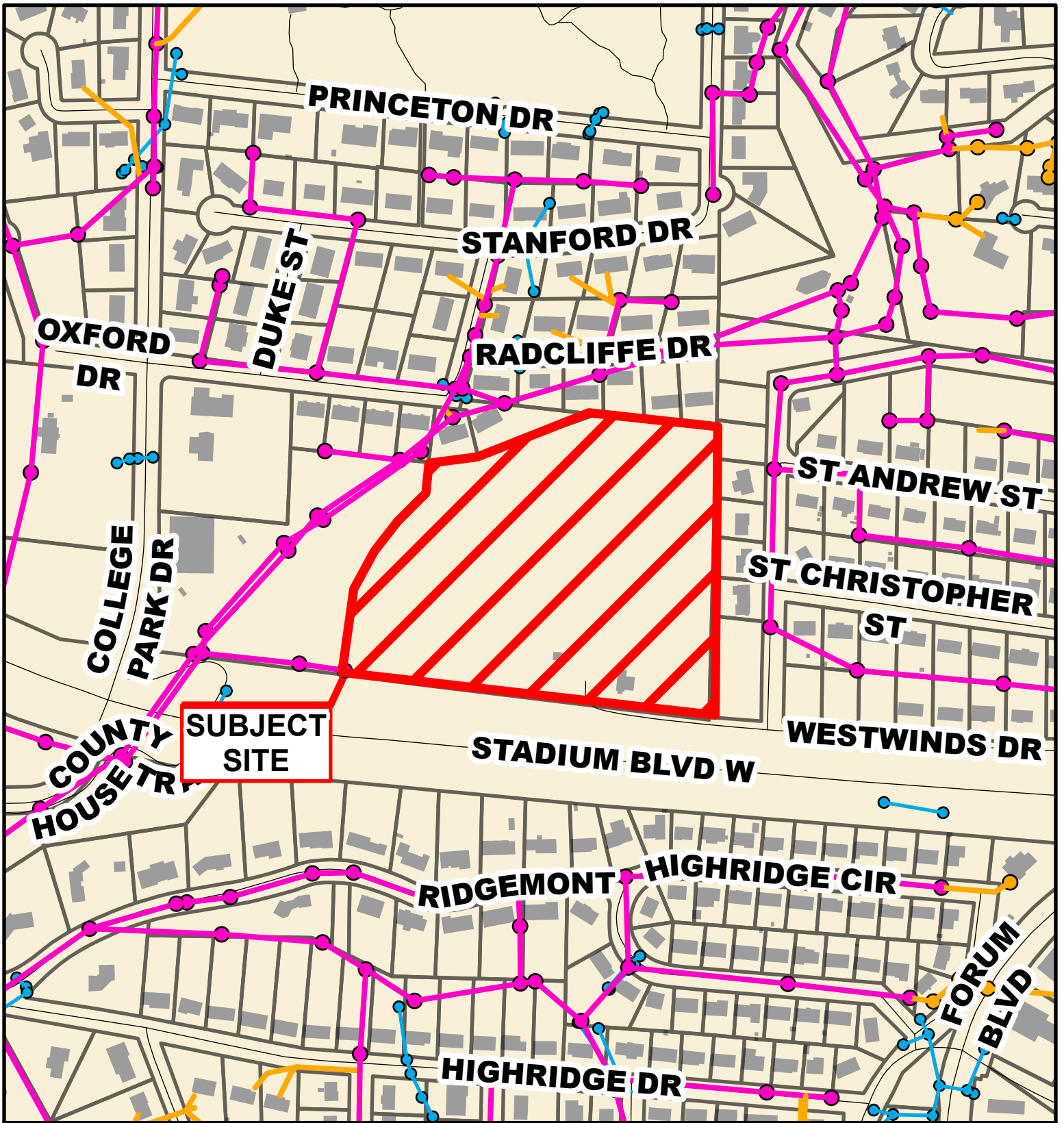

Case # 142-2023 - 1605 Westwinds Drive

Rezoning



- City Sanitary Line
- City Storm Lines
- Private Sanitary Line
- Parcels

