

Source: Nearmap, <https://www.nearmap.com/us/en>

# Case # 49-2023 - 3300 New Haven Road Rezoning



- Columbia City Limit
- City Zoning
- City Property
- Parcels



Parcel Data Source: Boone County Assessor

Created by The City of Columbia - Community Development Department

2022 Imagery: NearMap

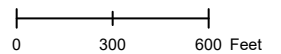

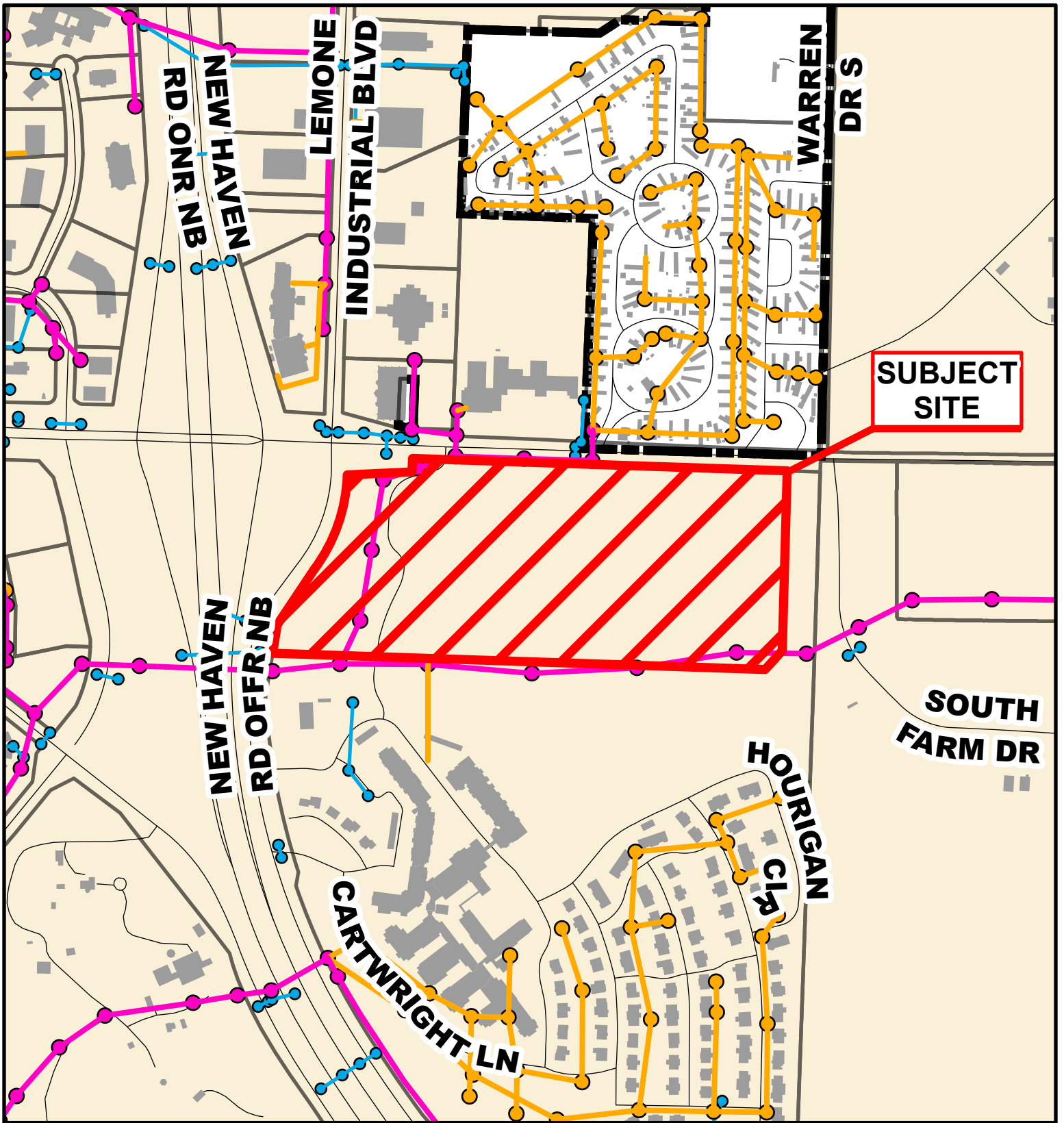

## Case # 49-2023 - 3300 New Haven Road

### Rezoning



- City Sanitary Line
- City Storm Lines
- Private Sanitary Line
- Parcels
- Columbia City Limits



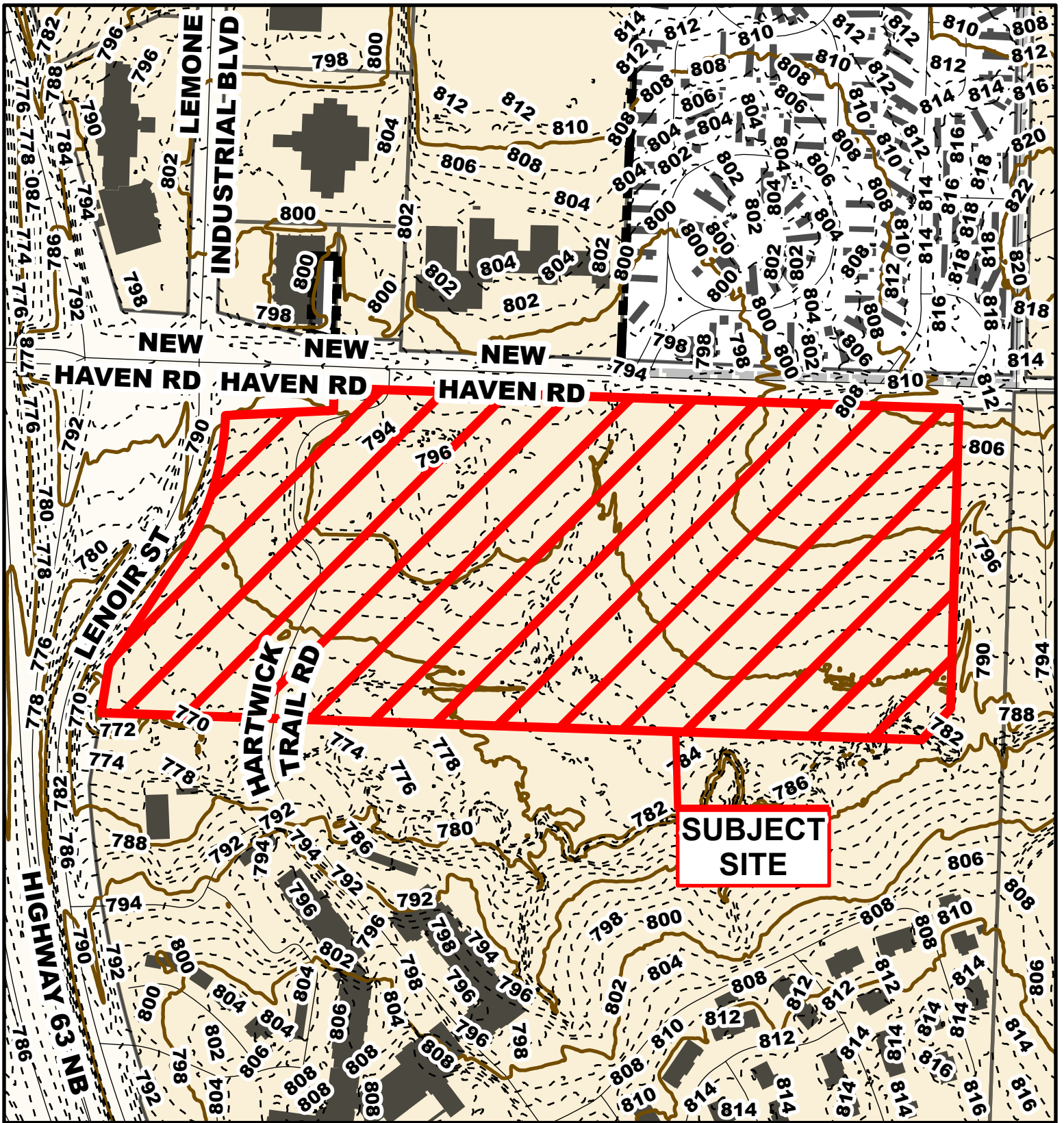

# Case # 49-2023 - 3300 New Haven Road Rezoning



- 10 Foot Contour Lines
- 2 Foot Contour Lines
- City of Columbia
- Parcels



Parcel Data Source: Boone County Assessor

Created by The City of Columbia - Community Development Department

