

EXHIBIT

OWNER:
MICHAEL F ALDEN
111 E RIDGELEY RD

OWNER: CHARLES
CHRISTOPHER
TEETER AND DONNA
CHECKETT

OWNER: CHARLES
CHRISTOPHER
TEETER AND DONNA
CHECKETT

105 E RIDGELEY RD

107 E RIDGELEY RD

OWNER:
MARK P
ALEXIOU
101 E
RIDGELEY RD

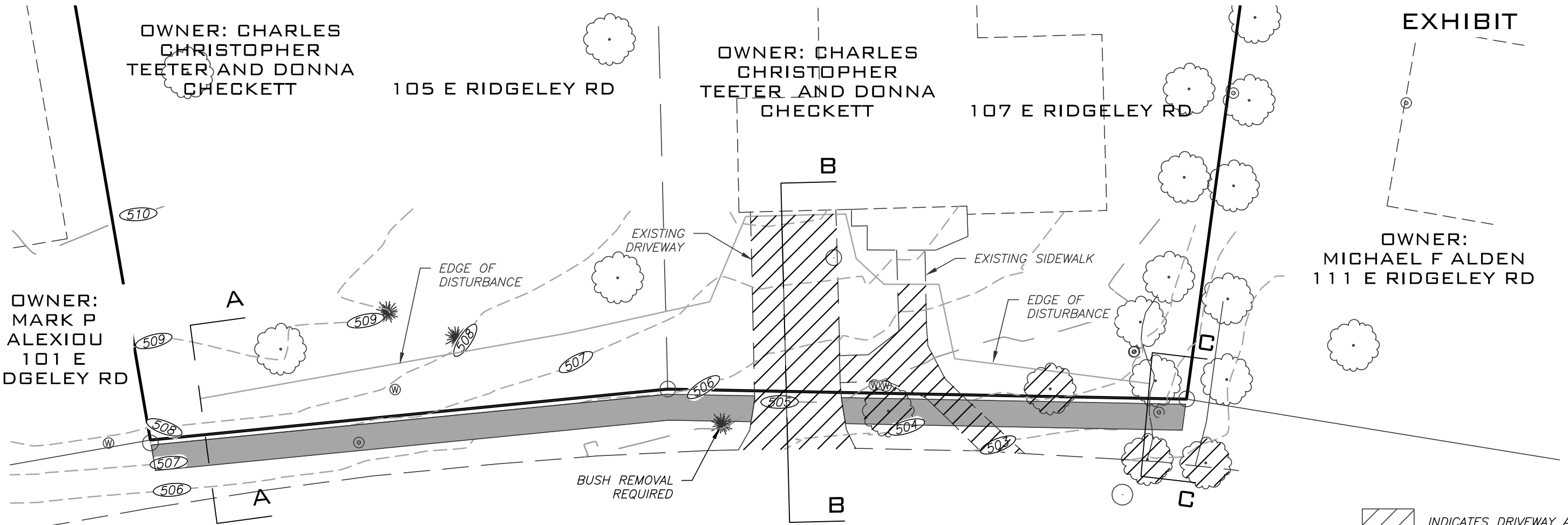

 INDICATES DRIVEWAY AND VEGETATION THAT WILL REQUIRE REMOVAL

EDGE OF LAND DISTURBANCE

34.78'

10.87'

RIGHT OF WAY LINE

0.78'

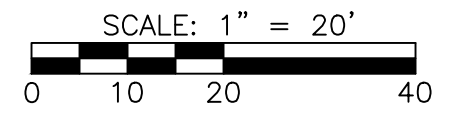

SECTION "B-B"

EDGE OF LAND DISTURBANCE

7.00'

RIGHT OF WAY LINE

12.39'

1.68'

SECTION "A-A"

EDGE OF LAND DISTURBANCE

2.90'

RIGHT OF WAY LINE

12.23'

0.80'

SECTION "C-C"

